

STORAGE LEGEND:		Storage Internals:
	800 w or 1000 w x 430 d x 715 h Side Opening Tambour Unit	LF Lateral Filing Frame S Fixed Shelf
	800 w or 1000 w x 430 d x 1200 h Side Opening Tambour Unit	
	800 w or 1000 w x 430 d x 1700 h Side Opening Tambour Unit	
	800 w or 1000 w x 430 d x 2000 h Side Opening Tambour Unit	
STORAGE LEGEND:		
	1000 w x 450 d x 715 h Double door cabinet	
	1000 w x 450 d x 1200 h Double door cabinet	
	1000 w x 450 d x 1700 h Double door cabinet	
	1000 w x 450 d x 1980 h Double door cabinet	

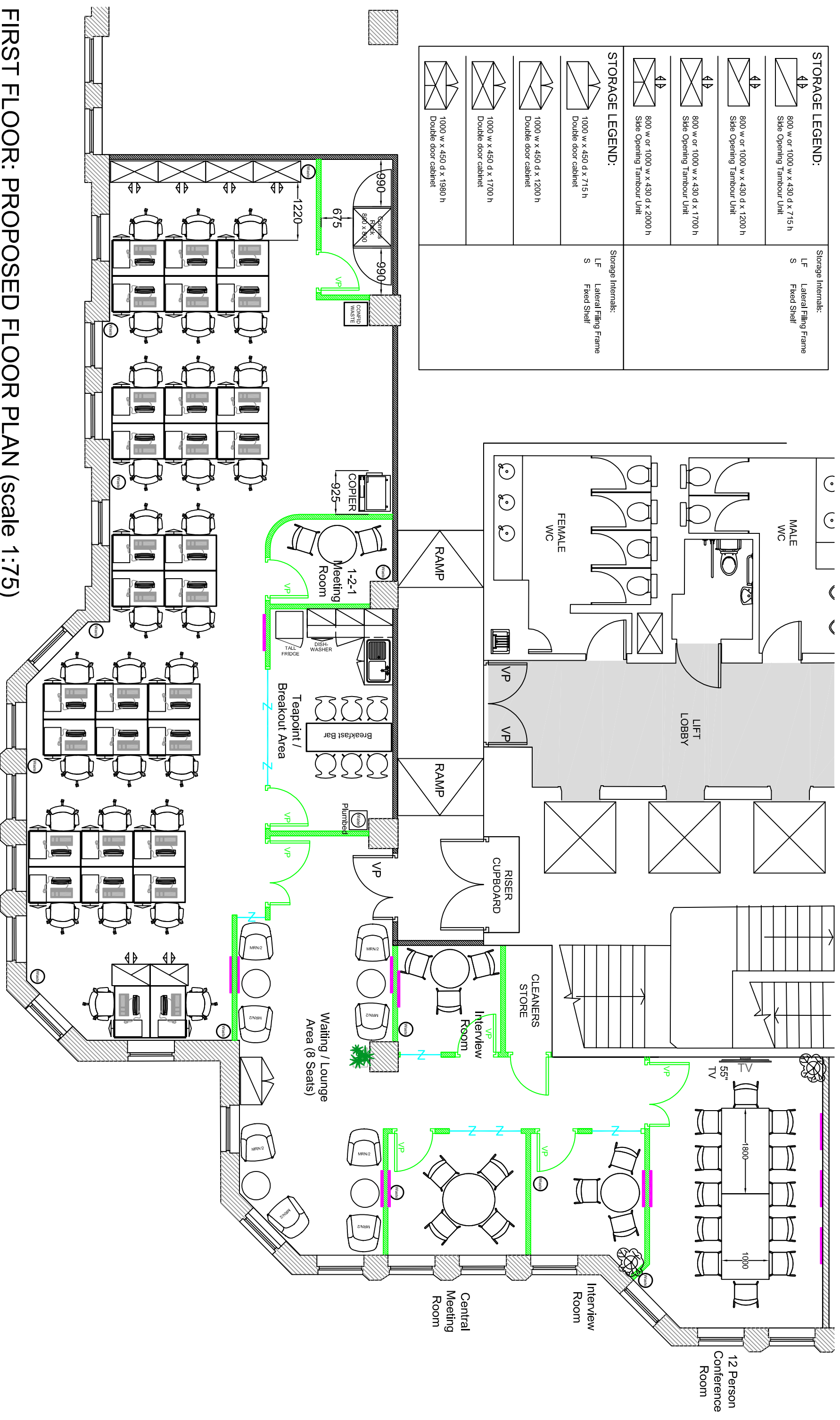

FIRST FLOOR: PROPOSED FLOOR PLAN (scale 1:75)

<p>marchmont Chartered Surveyors</p>		<p>20a Hanson Street London W1W 6UF Tel: 020 7409 5470</p>	
<p>emai: info@marchmont.co.uk www.marchmont-surveyors.co.uk</p>		<p>Revision Details: Revision _ (01/11/22) PRELIMINARY ISSUE Revision A (02/11/22) Minor updates to detail only</p>	
<p>THIS DRAWING MUST NOT BE SCALED. ALL DIMENSIONS ARE TO BE CHECKED ON-SITE PRIOR TO WORK COMMENCING</p>			
<p>ISSUED FOR APPROVAL</p>		<p>Client: MANPOWER (LEEDS BRANCH) Project: FIRST FLOOR, TORONTO SQUARE, LEEDS Title: GENERAL ARRANGEMENT : PROPOSED LAYOUT - OPTION 01</p>	
<p>Drawing no. 2095/01/GA/01</p>	<p>Revision Code A</p>	<p>Drawing Scale As Shown@A3</p>	<p>Date 01.11.22</p>
			<p>Drawn By AR</p>