



# FAREHAM REACH

# TO LET

**PROMINENT MODERN  
TRADE COUNTER / WAREHOUSE / INDUSTRIAL UNIT  
TO LET**



## Unit 810

**AVAILABLE SOON\***

**8,647 sq ft** (723.3 sq m)



### Features:

- Main roadside frontage
- Could suit trade counter
- Ground and first floor offices road facing
- Secure site / 24hr security
- Ample parking and yard
- 6.5m Eaves Height

*\*Contact the sales agents for more information.*

**Fareham Reach Business Park**  
Fareham Road, Gosport PO13 0FW

[www.farehamreach.co.uk](http://www.farehamreach.co.uk)



**HELLIER  
LANGSTON**  
**01329 220 111**  
**02382 022 111**  
[www.hlp.co.uk](http://www.hlp.co.uk)

**Lambert  
Smith  
Hampton**

**01489 579579**  
[www.lsh.co.uk](http://www.lsh.co.uk)



# FAREHAM REACH

## Unit 810

### Location

Fareham Reach is an established commercial area situated approximately 1 mile to the south of Fareham Town Centre, midway between Southampton and Portsmouth. There is excellent motorway access onto the M27 at Junction 11.

### Description

The unit is a semi-detached light industrial building of steel portal frame construction, under a profile clad roof with roof lighting. Internally, the building is sub-divided to provide ground and first floor offices with windows down the southern elevation and with the main warehouse having the benefit of an eaves height of 6.5 metres with ample car parking available on site.

### Accommodation

The property has been measured on a GIA basis.

<b>Total</b>	<b>8,647 sq ft</b>	<b>(723.3 sq m)</b>
--------------	--------------------	---------------------

The premises benefit from the following:

- |  |                                   |   |
|--|-----------------------------------|---|
| ■ Gas fired central heating (including heating within warehouse) | ■ Painted concrete floor          | ■ Suspended ceiling and CAT II lighting within office areas |
| ■ LED lighting within warehouse                                  | ■ Single and Disabled WC          | ■ Kitchen break-out areas                                   |
| ■ 3-phase power  | ■ Ample parking and yard          | ■ 1 x Level access loading door 5m height                   |
|  | ■ Secure site / 24 hours security |   |
|  | ■ Eaves height 6.5m               |   |

### Terms

The premises are available on a new full repairing and insuring lease for a term to be agreed.

### Rent

Rent on application.

### Rateable Value

For business rates information please visit the Valuation Office Agency website: [www.voa.gov.uk](http://www.voa.gov.uk).

### Energy Performance Certificate (EPC)

The Energy Performance Asset Rating is **B44**.

### Service Charge

Upon Application.

### Legal Costs

Each party to be responsible for their own legal costs incurred in the transaction.



Ground floor office.



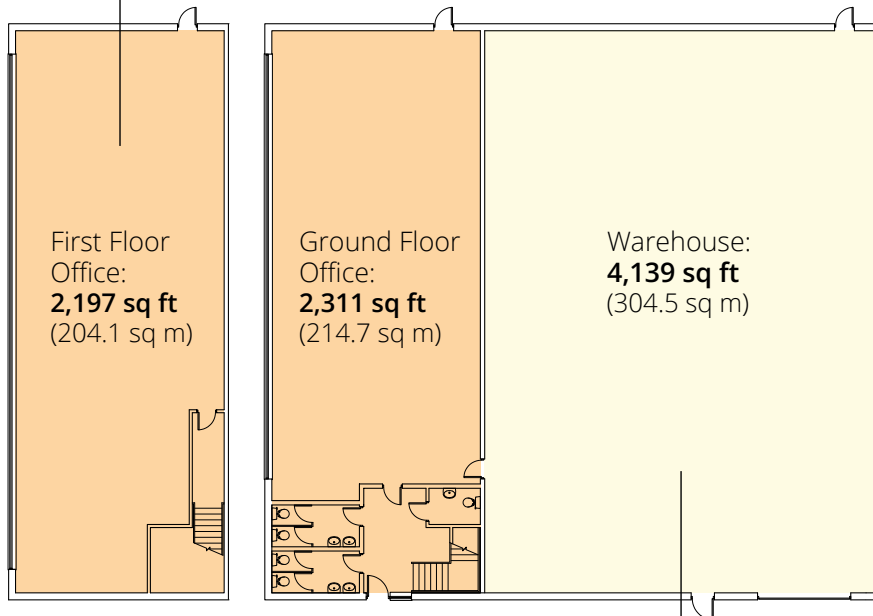





Aerial photograph of Fareham Reach Business Park looking south west.



Ordnance Survey © Crown Copyright 2013. All rights reserved. Licence number 100022432.



# FAREHAM REACH

## Fareham Reach Business Park

Fareham Road, Gosport PO13 0FW

### Towns

Distance from  
Fareham Reach Business Park:

Portsmouth:	10 miles
Southampton:	16 miles
Winchester:	26 miles
Basingstoke:	45 miles
Bournemouth:	48 miles
Brighton:	55 miles
London:	78 miles

### Airports

Distance from  
Fareham Reach Business Park:

Southampton:	16 miles
Bournemouth:	45 miles
Heathrow:	75 miles
Gatwick:	73 miles

### Rail

Journey times from  
Fareham train station:

Southampton:	21 minutes
Portsmouth:	27 minutes
Salisbury:	52 minutes
Bournemouth:	66 minutes
Brighton:	78 minutes
London:	115 minutes

### Ports

Distance to major ports:

Portsmouth:	10 miles
Southampton:	16 miles
Poole:	52 miles



### Viewing

Strictly by appointment through joint sole agents:

#### Matthew Poplett

DDI: 02380 574512

M: 07971 824525

E: [matt@hlp.co.uk](mailto:matt@hlp.co.uk)

#### Andy Hellier

DDI: 01329 225744

M: 07930 661782

E: [andy@hlp.co.uk](mailto:andy@hlp.co.uk)

#### Elise Evans

M: 07703 393120

E: [eevans@lsh.co.uk](mailto:eevans@lsh.co.uk)

#### George Cook

M: 07596 578707

E: [gcook@lsh.co.uk](mailto:gcook@lsh.co.uk)



HELLIER  
LANGSTON

01329 220 111

02382 022 111

[www.hlp.co.uk](http://www.hlp.co.uk)

Lambert  
Smith  
Hampton

01489 579579

[www.lsh.co.uk](http://www.lsh.co.uk)

IMPORTANT NOTICE: Hellier Langston, Lambert Smith Hampton and their clients give notice that: (i) they have no authority to make or give any representations or warranties in relation to the property. These particulars do not form part of any offer or contract and must not be relied upon as statements or representations of fact. (ii) Any areas, measurements or distances are approximate. The text, photographs and plans are for guidance only and are not necessarily comprehensive. It should not be assumed that the property has all necessary planning, building regulation or other consents. Hellier Langston and Lambert Smith Hampton have not tested any services, equipment or facilities. (iii) Purchasers must satisfy themselves by inspection or otherwise.