

Lease Plan

Part 1 of 2 - Demise

Drawing No LPT5039 B	Rev 03	 LEASE PLANS OF TITLE LAND REGISTRY COMPLIANT PLANS
<small>Additional copies of these Plans are available on request. We do not recommend submitting anything other than our original plans to the Land Registry as most reproductions will be rejected due to distortion and scaling inaccuracy.</small>	Size A4	
Lease Plans of Title Lane End, High Wycombe Buckinghamshire HP14 3DX 07968 728 118 www.leaseplansoftitle.co.uk		

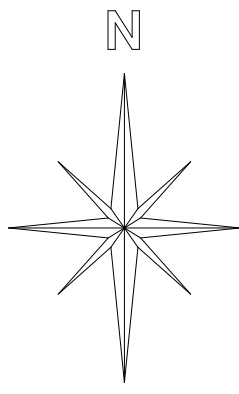

Drawing Title Lease Plan (1 of 2 Demise)			
Ground Floor premises known as Unit 9, Fisher's Industrial Estate Wiggenhall Road Watford Hertfordshire WD18 0FN			
Scale 1:200	Date 27/05/2026	Drawn By KS	Approved By John AA Fisher PS

Net Internal Area
5042 sqft 468sqm

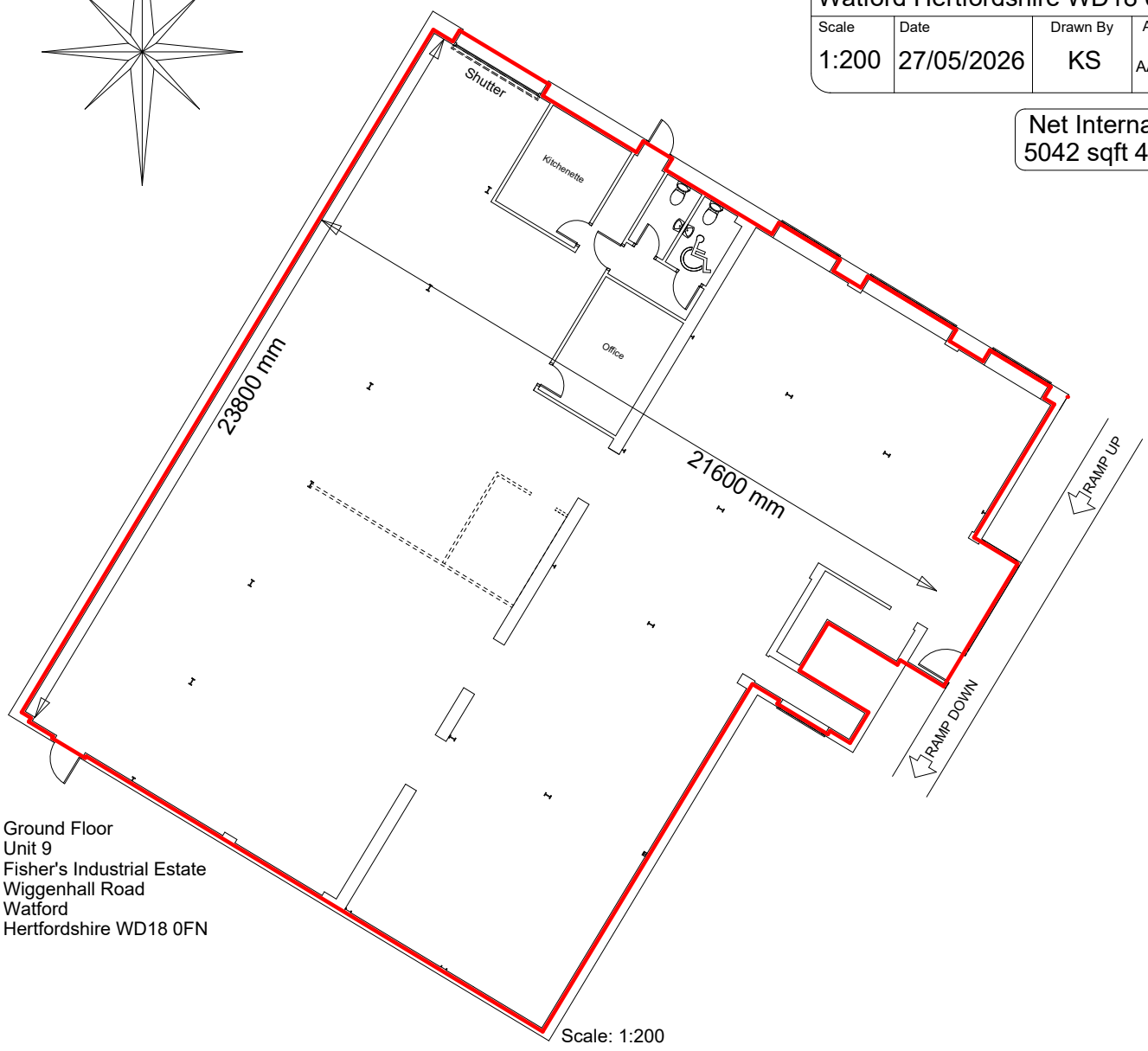

Ground Floor
Unit 9
Fisher's Industrial Estate
Wiggenhall Road
Watford
Hertfordshire WD18 0FN

NOTE

The red line indicates the Ground Floor property known as Unit 9, Wiggenhall Road, Watford, Hertfordshire WD18 0FN