

Current Desk Count\* = 235

\*excludes offices

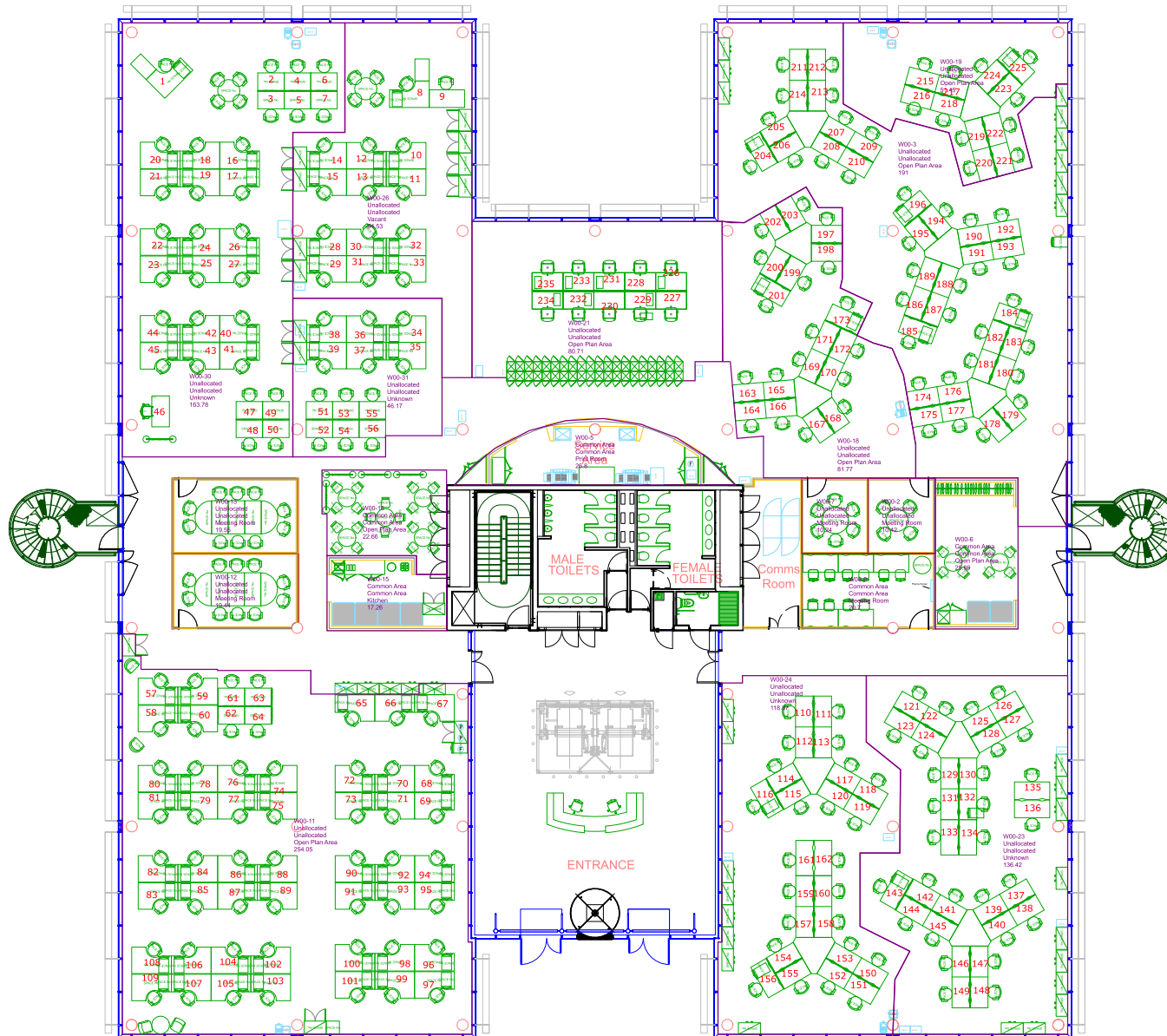

Notes

1. No dimensions are to be scaled from this drawing. Any errors or omissions are to be reported to the CAD Manager - Property Services (tel: 01793 657070).
2. All dimensions are to be checked on site prior to any works taking place.

M	Master has been amended following desk changes	24.04.20
L	Master has been amended to follow new business structures	21.06.17
K	Master has been amended following changes to structure	01.03.17
J	Master has been amended following changes to team desk positions	20.10.16
I	Master has been amended following changes to team desk positions	25.01.16
H	Master has been amended following additional desk	07.09.15
G	Master has been amended following changes to team desk positions	24.06.15
F	Master has been amended following changes to structure chart	10.02.15
E	Master has been amended following changes to team desk positions	18.09.14
D	Master has been amended following changes to Spacestation	30.07.14
C	Master has been updated in the Carlton job NW93916	28.05.14
B	Master has been updated in the with floor walk carried out on WC room 17.09.12	09.10.12
A	Master has been synchronised and migrated to bring in line with Spacestation	08.08.12
Rev.	Description	Date



**Property Services**  
 Nationwide Building Society  
 Nationwide House  
 Pipers Way  
 Swindon  
 SN38 1SN

CONFIDENTIAL

Telephone 01793 657070

Building / Branch Name  
**Pegasus House**  
 Windmill Hill Business Park

Property Ref. **SZ16** Branch Prefix ---

Floor Level  
**Ground Floor**

Drawing Title  
**Master Drawing**

**General Arrangement Plan**

Drawn By: D.D.Harris Date: 2007 Scale: 1:100 Sheet Size: A1

Drawing No. **SZ16-00.1** Revision **M**