

CASTLE BRIDGE



In the heart of the City.
At the heart of your business.



1-5, Castlebridge, Cardiff, CF11 9BB

www.castlebridge-cardiff.co.uk

Castlebridge offers a working environment that encourages creativity, productivity & occupier well-being



Work/Life Balance

An office that encourages you to make the most of your working day and improve your work/life balance.

- Take advantage of the picturesque cycle and running routes to and from the office
- Maintain an affinity with the outside world with unspoilt views and ample natural daylight into the offices
- Bute Park and Sophia Gardens opposite can offer a relaxed environment to unwind or an active place to spend a lunch break
- Reduce travel time and stress with an easy commute



Working Environment

Castlebridge aims to provide an office that sets itself apart with its quality finishes and facilities.

- A flexible, multi-let office environment catering for requirements of 500-50,000 sq.ft
- Creating a positive working environment with stylish receptions and common areas
- Vibrant office hub supporting collaborative working and tenant interaction
- Bright, open plan offices with city and park views
- Impressive new shower and changing facilities
- High ratio of on site, secure cycle and car parking
- An office development that encourages creativity and productivity



Central Cardiff Location

In the heart of Cardiff city centre, Castlebridge has everything on its doorstep

- Overlooking Bute Park, Sophia Gardens and the River Taff
 - Moments from The Millennium Stadium and Cardiff Castle
 - Five minute walk to Cardiff Central Railway Station
 - A short stroll to the central shopping district
 - A wide variety of cafes, restaurants and bars
 - Quick and easy access to the A4232 ring road and M4 motorway
-



CASTLE BRIDGE

In the heart of the City

- Overlooking Bute Park and the River Taff
- Moments from Cardiff Castle
- Minutes' walk to the shopping centres, restaurants, cafes and bars
- Five minute walk to Cardiff Central Railway Station
- Two minute walk to Millenium Stadium
- Direct access to cycle and running routes

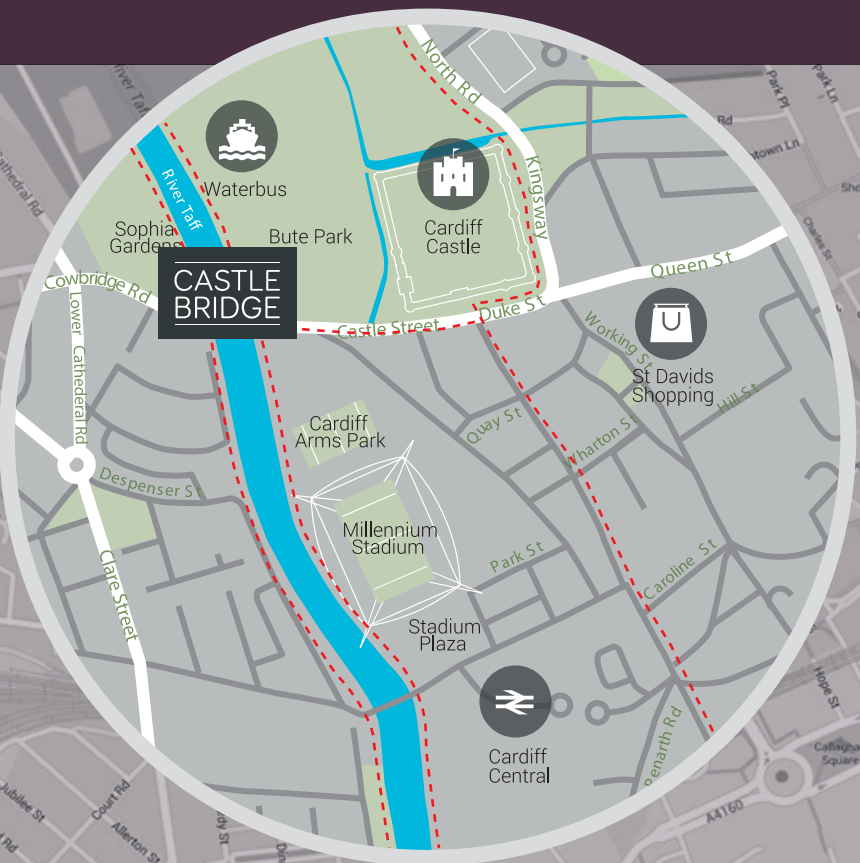

Further Information

Offices to Let : 500-50,000 sq ft

BENEFITING FROM

- New shower and changing facilities
- High ratio of car and cycle parking
- Refurbished receptions and common areas
- Bright open plan offices
- Raised access floors
- LG7 compliant lighting
- EPC Rating of C

Site Plan

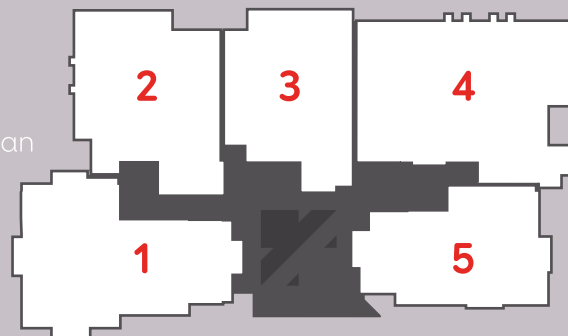

Please call for current availability and to discuss your office requirement



ANDREW OLIVER
T: +44 (0)117 945 0577
aoliver@ashvillegroup.co.uk



RHYDIAN MORRIS
T: +44 (0)29 2072 6002
rhydian.morris@eu.jll.com



GARY CARVER
T: +44 (0) 2920 368 963
gcarver@savills.com

MISREPRESENTATIONS ACT 1967 & DECLARATION: Ashville Asset Management, JLL and Savills for themselves and for the vendors of this property whose agents they are give notice that: a) the particulars are set out as general outline only for the guidance of intending purchasers and do not constitute, nor constitute part of, an offer or contract; b) all descriptions, dimensions, references to condition and necessary permissions for use and occupation and other details are given in good faith and are believed to be correct, but any intending purchaser should not rely on them as statements or representations of fact but should satisfy themselves by inspection or otherwise as to the correctness of each of them; c) no person in the employment of Ashville Asset Management, JLL and Savills has any authority to make or give any representation or warranty whatever in relation to this property. Subject to Contract. Exclusive of VAT. January 2016.