



wework

# Large Office Availability

30 CHURCHILL PLACE  
LONDON E14 5EU

January 2023

[VIEW VIRTUAL TOUR](#)

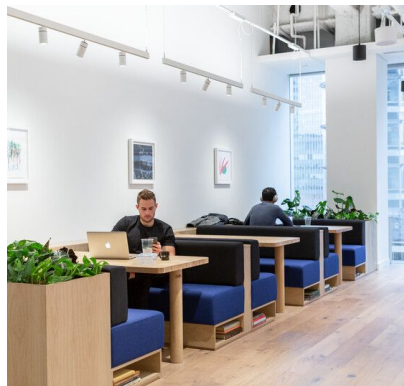

# 30 Churchill Place

Canary Wharf, London, E14



Building Exterior

Opened December 2019

-1, 2, 3, 4, 5, 6, 7, 8, 9, 10

Typical Floor Plate: 28,618 SQ FT

286,180 Total SQ FT

**30 Churchill Place offers Grade A purpose-designed office space, in the financial and business district of Canary Wharf**

- Enter the double-height atrium reception at WeWork 30 Churchill Place and find yourself in an ultra modern, energy-efficient, innovatively designed building.
- The steel and glass construction allows for airy workspaces, with floor-to-ceiling windows offering views of the surrounding skyscrapers as well as the public squares and green spaces.
- Created by our in-house team of artists and interior designers, the light-flooded offices, conference rooms and breakout areas combine to provide an environment that fosters productivity, creativity and innovation.
- Less than five minutes' walk from transport links serving Central London, reachable by Underground, DLR and the forthcoming Crossrail overground line.

[WEBSITE](#)

[VIRTUAL TOUR](#)



Building Lobby



Common Area

# 10th Floor

12,881 SQFT | 285 desks

24 Internal Rooms

- + 420 person office
- + Currently programmed as:
  - + 285 desks
  - + 14 internal meeting rooms
  - + 10 internal private office
  - + 7 privacy working booths
  - + 3 lounge areas
  - + 1 copy machine & office corner
  - + Private furnished pantry
  - + 1 private reception
  - + 1 private IT closet
  - + 2 private storage rooms
- + Membership Passes included: 420
- + Monthly Credits: 850
- + Office Ref: 10-101

List Price - £187,200 PCM + VAT

## Enjoy access to shared building amenities:

- + Access to communal amenity space
- + 63 bookable meeting rooms
- + 32 communal phonebooths
- + In-house barista, event space, honesty market, beer taps, mother's room, dog friendly, bike storage

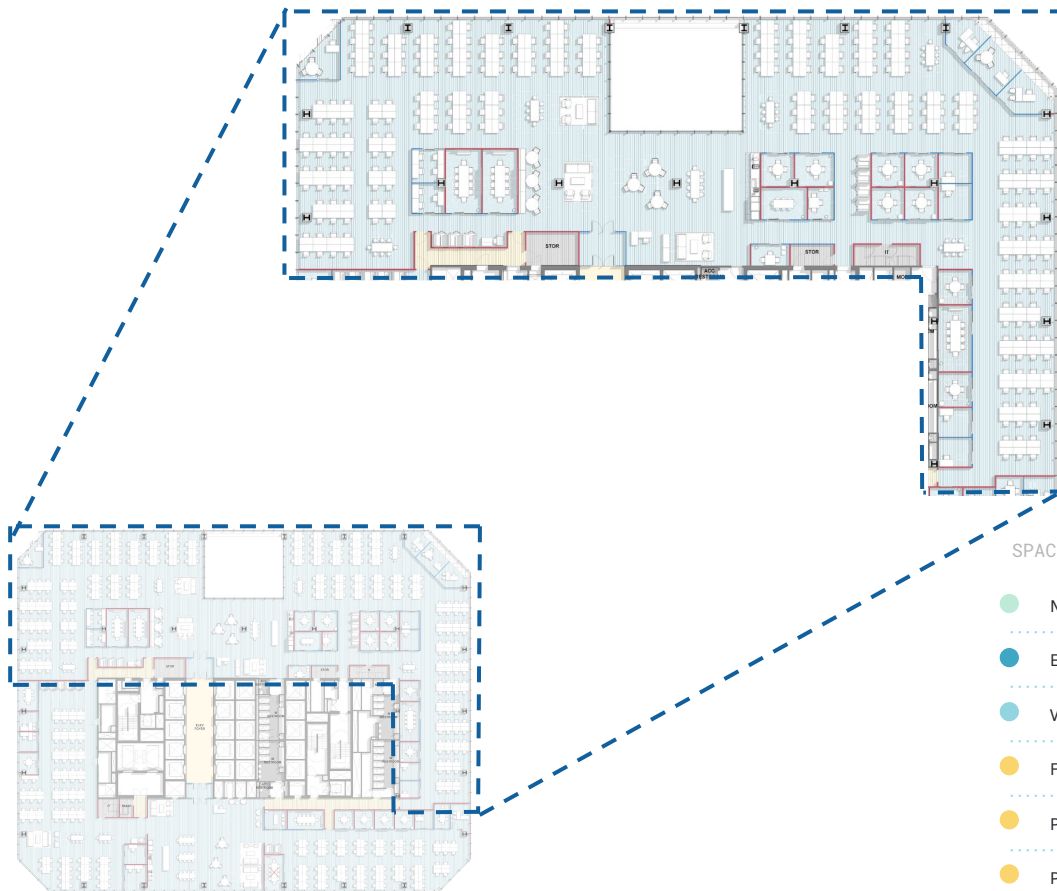

### SPACE TYPES

- Meeting Rooms
- Executive Offices
- Workstations
- Full Pantry
- Printing Stations
- Phone Booths

NB. Pricing is based on a total square footage (dedicated sqft + pro rata allocation of shared space).

<sup>1</sup> The layouts presented are for illustrative purposes only; the maximum occupancy assumes WeWork's standards and density.

<sup>2</sup> Layouts can be configured to fit client's desired needs, preferred density and programming.



# 9th Floor

11,416 SQFT | 238 Desks

19 Internal Rooms

- + 364 person office
- + Currently programmed as:
  - + 238 desks
  - + Private Suite and entrance lounge
  - + Panoramic views of the city
  - + Private atrium space
  - + 11 internal meeting rooms
  - + 8 internal private office
  - + 7 privacy working booths
  - + 3 lounge areas
  - + 1 copy machine & office corner
  - + Private furnished pantry
  - + 1 private reception
- + Membership Passes included: 364
- + Monthly Credits: 738
- + Office Ref: 09-101

List Price - £162,250 PCM + VAT

## Enjoy access to shared building amenities:

- + Access to communal amenity space
- + 63 bookable meeting rooms
- + 32 communal phonebooths
- + In-house barista, event space, honesty market, beer taps, mother's room, dog friendly, bike storage

NB. Pricing is based on a total square footage (dedicated sqft + pro rata allocation of shared space).



### SPACE TYPES

- Meeting Rooms
- Executive Offices
- Workstations
- Full Pantry
- Printing Stations
- Phone Booths

<sup>1</sup> The layouts presented are for illustrative purposes only; the maximum occupancy assumes WeWork's standards and density.  
<sup>2</sup> Layouts can be configured to fit client's desired needs, preferred density and programming.

# 7th Floor

2,299 SQFT | 67 Desks

3 Internal Rooms

- + 94 person office
- + Currently programmed as:
  - + 67 desks
  - + Panoramic views of the city
  - + 2 internal meeting rooms
  - + 1 internal private office
  - + 1 lounge area
- + Membership Passes included: 94
- + Monthly Credits: 198
- + Office Ref: 07-103

**List Price - £41,900 PCM + VAT**

**Available 1st June 2023**

## Enjoy access to shared building amenities:

- + Access to communal amenity space
- + 63 bookable meeting rooms
- + 32 communal phonebooths
- + In-house barista, event space, honesty market, beer taps, mother's room, dog friendly, bike storage



### SPACE TYPES

- Meeting Rooms
- Executive Offices
- Workstations
- Full Pantry
- Printing Stations
- Phone Booths

<sup>1</sup> The layouts presented are for illustrative purposes only; the maximum occupancy assumes WeWork's standards and density.

<sup>2</sup> Layouts can be configured to fit client's desired needs, preferred density and programming.

# 7th Floor

1,409 SQFT | 42 Desks

- + 60 person office
- + Currently programmed as:
  - + 42 desks
  - + Panoramic views of the city
  - + 3 internal meeting rooms
  - + 1 lounge are
- + Membership Passes included: 60
- + Monthly Credits: 130
- + Office Ref: 07-107

List Price - £26,750 PCM + VAT

## Enjoy access to shared building amenities:

- + Access to communal amenity space
- + 63 bookable meeting rooms
- + 32 communal phonebooths
- + In-house barista, event space, honesty market, beer taps, mother's room, dog friendly, bike storage

NB. Pricing is based on a total square footage (dedicated sqft + pro rata allocation of shared space).



### SPACE TYPES

- Meeting Rooms
- Executive Offices
- Workstations
- Full Pantry
- Printing Stations
- Phone Booths

<sup>1</sup> The layouts presented are for illustrative purposes only; the maximum occupancy assumes WeWork's standards and density.

<sup>2</sup> Layouts can be configured to fit client's desired needs, preferred density and programming.

# 7th Floor

1,353 SQFT | 43 Desks

- + 55 person office
- + Currently programmed as:
  - + 43 desks
  - + Panoramic views of the city
  - + 1 internal meeting room
  - + 1 lounge are
- + Membership Passes included: 55
- + Monthly Credits: 120
- + Office Ref: 07-105

List Price - £24,500 PCM + VAT

## Enjoy access to shared building amenities:

- + Access to communal amenity space
- + 63 bookable meeting rooms
- + 32 communal phonebooths
- + In-house barista, event space, honesty market, beer taps, mother's room, dog friendly, bike storage

NB. Pricing is based on a total square footage (dedicated sqft + pro rata allocation of shared space).



### SPACE TYPES

- Meeting Rooms
- Executive Offices
- Workstations
- Full Pantry
- Printing Stations
- Phone Booths

<sup>1</sup> The layouts presented are for illustrative purposes only; the maximum occupancy assumes WeWork's standards and density.

<sup>2</sup> Layouts can be configured to fit client's desired needs, preferred density and programming.



# 6th Floor

2,301 SQFT | 67 Desks

3 Internal Rooms

- + 94 person office
- + Currently programmed as:
  - + 67 desks
  - + Panoramic views of the city
  - + 2 internal meeting rooms
  - + 1 internal private office
  - + 2 privacy working booths
  - + 1 lounge area
- + Membership Passes included: 94
- + Monthly Credits: 198
- + Office Ref: 06-103

List Price - £41,900 PCM + VAT

## Enjoy access to shared building amenities:

- + Access to communal amenity space
- + 63 bookable meeting rooms
- + 32 communal phonebooths
- + In-house barista, event space, honesty market, beer taps, mother's room, dog friendly, bike storage

NB. Pricing is based on a total square footage (dedicated sqft + pro rata allocation of shared space).

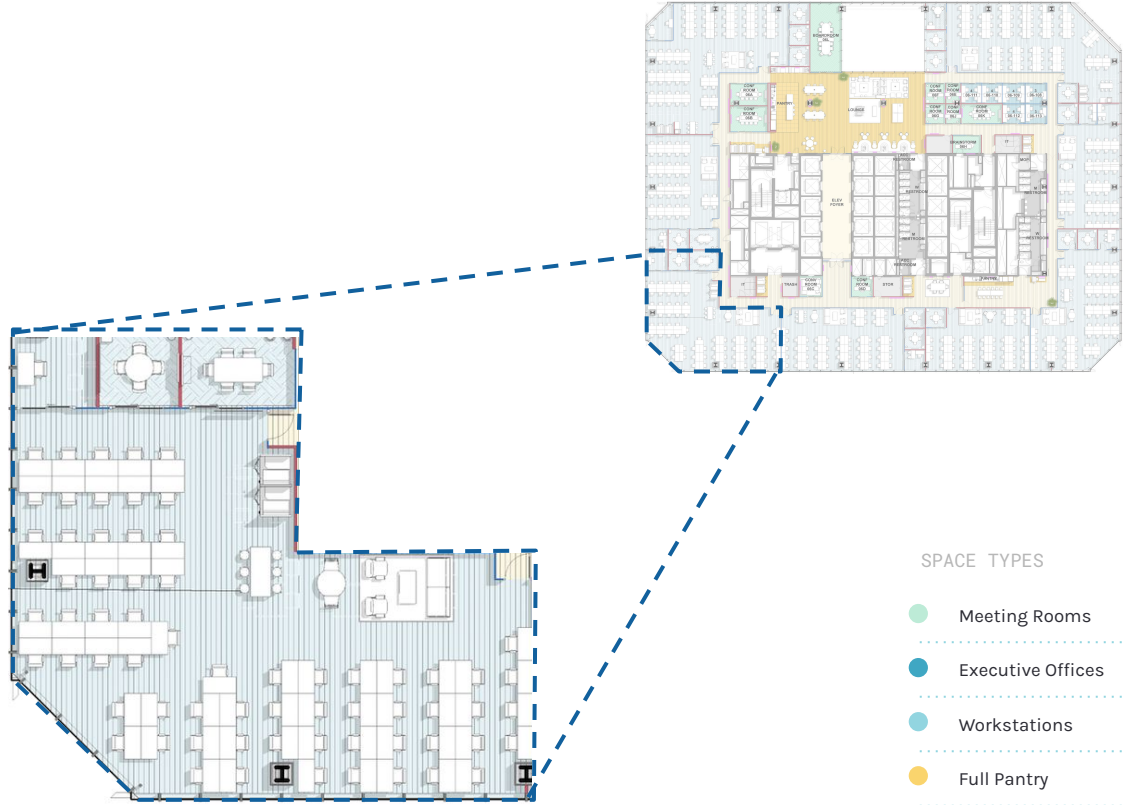

<sup>1</sup> The layouts presented are for illustrative purposes only; the maximum occupancy assumes WeWork's standards and density.

<sup>2</sup> Layouts can be configured to fit client's desired needs, preferred density and programming.



# 6th Floor

2,707 SQFT | 79 Desks

- + 108 person office
- + Currently programmed as:
  - + 79 desks
  - + Panoramic views of the city
  - + 3 internal meeting rooms
  - + 1 internal private office
  - + 2 privacy working booths
  - + 1 lounge area
- + Membership Passes included: 108
- + Monthly Credits: 226
- + Office Ref: 06-114

List Price - £48,150PCM + VAT

## Enjoy access to shared building amenities:

- + Access to communal amenity space
- + 63 bookable meeting rooms
- + 32 communal phonebooths
- + In-house barista, event space, honesty market, beer taps, mother's room, dog friendly, bike storage

NB. Pricing is based on a total square footage (dedicated sqft + pro rata allocation of shared space).



### SPACE TYPES

- Meeting Rooms
- Executive Offices
- Workstations
- Full Pantry
- Printing Stations
- Phone Booths

<sup>1</sup> The layouts presented are for illustrative purposes only; the maximum occupancy assumes WeWork's standards and density.

<sup>2</sup> Layouts can be configured to fit client's desired needs, preferred density and programming.

# 6th Floor

2,301 SQFT | 67 Desks

- + 94 person office
- + Currently programmed as:
  - + 67 desks
  - + Panoramic views of the city
  - + 3 internal meeting rooms
  - + 1 internal private office
  - + 2 privacy working booths
  - + 1 lounge are
- + Membership Passes included: 94
- + Monthly Credits: 198
- + Office Ref: 06-103

List Price - £41,900PCM + VAT

Enjoy access to shared building amenities:

- + Access to communal amenity space
- + 63 bookable meeting rooms
- + 32 communal phonebooths
- + In-house barista, event space, honesty market, beer taps, mother's room, dog friendly, bike storage

NB. Pricing is based on a total square footage (dedicated sqft + pro rata allocation of shared space).



## SPACE TYPES

- Meeting Rooms
- Executive Offices
- Workstations
- Full Pantry
- Printing Stations
- Phone Booths

<sup>1</sup> The layouts presented are for illustrative purposes only; the maximum occupancy assumes WeWork's standards and density.

<sup>2</sup> Layouts can be configured to fit client's desired needs, preferred density and programming.

# 6th Floor

1,675 SQFT | 71 Desks

- + 71 person office
- + Currently programmed as:
  - + 53 desks
  - + Panoramic views of the city
  - + 2 internal meeting rooms
  - + 1 internal private office
  - + 1 lounge area
- + Membership Passes included: 61
- + Monthly Credits: 152
- + Office Ref: 06-104

List Price - £31,650 PCM + VAT

## Enjoy access to shared building amenities:

- + Access to communal amenity space
- + 63 bookable meeting rooms
- + 32 communal phonebooths
- + In-house barista, event space, honesty market, beer taps, mother's room, dog friendly, bike storage

NB. Pricing is based on a total square footage (dedicated sqft + pro rata allocation of shared space).



### SPACE TYPES

- Meeting Rooms
- Executive Offices
- Workstations
- Full Pantry
- Printing Stations
- Phone Booths

<sup>1</sup> The layouts presented are for illustrative purposes only; the maximum occupancy assumes WeWork's standards and density.

<sup>2</sup> Layouts can be configured to fit client's desired needs, preferred density and programming.

# 6th Floor

1,346 SQFT | 53 Desks

- + 55 person office
- + Currently programmed as:
  - + 53 desks
  - + Panoramic views of the city
  - + 1 internal meeting rooms
  - + 1 lounge are
- + Membership Passes included: 55
- + Monthly Credits: 120
- + Office Ref: 06-105

List Price - £24,500 PCM + VAT

Enjoy access to shared building amenities:

- + Access to communal amenity space
- + 63 bookable meeting rooms
- + 32 communal phonebooths
- + In-house barista, event space, honesty market, beer taps, mother's room, dog friendly, bike storage

NB. Pricing is based on a total square footage (dedicated sqft + pro rata allocation of shared space).



## SPACE TYPES

- Meeting Rooms
- Executive Offices
- Workstations
- Full Pantry
- Printing Stations
- Phone Booths

<sup>1</sup> The layouts presented are for illustrative purposes only; the maximum occupancy assumes WeWork's standards and density.

<sup>2</sup> Layouts can be configured to fit client's desired needs, preferred density and programming.



# 6th Floor

1,911 SQFT | 59 Desks

- + 77 person office
- + Currently programmed as:
  - + 59 desks
  - + Panoramic views of the city
  - + 3 internal meeting rooms
  - + 1 lounge are
- + Membership Passes included: 77
- + Monthly Credits: 164
- + Office Ref: 06-106

List Price - £34,300 PCM + VAT

## Enjoy access to shared building amenities:

- + Access to communal amenity space
- + 63 bookable meeting rooms
- + 32 communal phonebooths
- + In-house barista, event space, honesty market, beer taps, mother's room, dog friendly, bike storage

NB. Pricing is based on a total square footage (dedicated sqft + pro rata allocation of shared space).



### SPACE TYPES

- Meeting Rooms
- Executive Offices
- Workstations
- Full Pantry
- Printing Stations
- Phone Booths

<sup>1</sup> The layouts presented are for illustrative purposes only; the maximum occupancy assumes WeWork's standards and density.

<sup>2</sup> Layouts can be configured to fit client's desired needs, preferred density and programming.

# 6th Floor

1,407 SQFT | 45 Desks

- + 60 person office
- + Currently programmed as:
  - + 45 desks
  - + Panoramic views of the city
  - + 3 internal meeting rooms
  - + 1 lounge are
- + Membership Passes included: 60
- + Monthly Credits: 130
- + Office Ref: 06-107

List Price - £26,750 PCM + VAT

## Enjoy access to shared building amenities:

- + Access to communal amenity space
- + 63 bookable meeting rooms
- + 32 communal phonebooths
- + In-house barista, event space, honesty market, beer taps, mother's room, dog friendly, bike storage

NB. Pricing is based on a total square footage (dedicated sqft + pro rata allocation of shared space).



## SPACE TYPES

- Meeting Rooms
- Executive Offices
- Workstations
- Full Pantry
- Printing Stations
- Phone Booths

<sup>1</sup> The layouts presented are for illustrative purposes only; the maximum occupancy assumes WeWork's standards and density.

<sup>2</sup> Layouts can be configured to fit client's desired needs, preferred density and programming.

# 5th Floor

1,644 SQFT | 48 Desks

- + 58 person office
- + Currently programmed as:
  - + 48 desks
  - + Panoramic views of the city
  - + 1 internal meeting rooms
  - + 1 lounge are
- + Membership Passes included: 58
- + Monthly Credits: 126
- + Office Ref: 05-106

List Price - £25,850 PCM + VAT

## Enjoy access to shared building amenities:

- + Access to communal amenity space
- + 63 bookable meeting rooms
- + 32 communal phonebooths
- + In-house barista, event space, honesty market, beer taps, mother's room, dog friendly, bike storage

NB. Pricing is based on a total square footage (dedicated sqft + pro rata allocation of shared space).



### SPACE TYPES

- Meeting Rooms
- Executive Offices
- Workstations
- Full Pantry
- Printing Stations
- Phone Booths

<sup>1</sup> The layouts presented are for illustrative purposes only; the maximum occupancy assumes WeWork's standards and density.

<sup>2</sup> Layouts can be configured to fit client's desired needs, preferred density and programming.

# 5th Floor

1,522 SQFT | 43 Desks

- + 55 person office
- + Currently programmed as:
  - + 43 desks
  - + Panoramic views of the city
  - + 1 internal meeting rooms
  - + 1 lounge are
- + Membership Passes included: 55
- + Monthly Credits: 120
- + Office Ref: 05-111
- List Price - £24,500 PCM + VAT

Enjoy access to shared building amenities:

- + Access to communal amenity space
- + 63 bookable meeting rooms
- + 32 communal phonebooths
- + In-house barista, event space, honesty market, beer taps, mother's room, dog friendly, bike storage

NB. Pricing is based on a total square footage (dedicated sqft + pro rata allocation of shared space).



## SPACE TYPES

- Meeting Rooms
- Executive Offices
- Workstations
- Full Pantry
- Printing Stations
- Phone Booths

<sup>1</sup> The layouts presented are for illustrative purposes only; the maximum occupancy assumes WeWork's standards and density.

<sup>2</sup> Layouts can be configured to fit client's desired needs, preferred density and programming.



# 5th Floor

1,706 SQFT | 43 Desks

- + 69 person office
- + Currently programmed as:
  - + 43 desks
  - + Panoramic views of the city
  - + 1 internal meeting rooms
  - + 1 lounge are
- + Membership Passes included: 69
- + Monthly Credits: 148
- + Office Ref: 05-101

List Price - £30,750 PCM + VAT

Enjoy access to shared building amenities:

- + Access to communal amenity space
- + 63 bookable meeting rooms
- + 32 communal phonebooths
- + In-house barista, event space, honesty market, beer taps, mother's room, dog friendly, bike storage

NB. Pricing is based on a total square footage (dedicated sqft + pro rata allocation of shared space).



## SPACE TYPES

- Meeting Rooms
- Executive Offices
- Workstations
- Full Pantry
- Printing Stations
- Phone Booths

<sup>1</sup> The layouts presented are for illustrative purposes only; the maximum occupancy assumes WeWork's standards and density.

<sup>2</sup> Layouts can be configured to fit client's desired needs, preferred density and programming.



Conference Room



# Contacts

---

FOR ENQUIRIES PLEASE CONTACT :

James Brydon  
Leasing Manager - East London  
[James.Brydon@wework.com](mailto:James.Brydon@wework.com)



© 2021 WeWork. The WeWork trademark and related logos are the property of WeWork Companies LLC. Photographs contained herein may be representative examples of various WeWork locations and do not necessarily depict the WeWork location referenced in the brochure. While reasonable efforts have been made to check the accuracy of the information contained here, WeWork, its officers, employees, directors, and representatives make no warranty, express or implied, regarding the accuracy of the information and disclaim any liability arising from the use of the information contained herein. All dimensions are approximate and subject to variances and prices are subject to contract. It is your obligation to independently verify particulars of the property. WeWork reserves the right to make changes.

