

YOU
CAN
YOU
CAN
YOU
CAN
YOU
CAN
YOU
CAN
YOU
CAN
YOU
CAN
YOU
CAN
YOU
CAN
YOU
CAN
YOU
CAN

Space to grow



2 Redman Place





2 Redman Place

2 Redman Place is our very latest Rogers Stirk Harbour designed office building, adjacent to the new footbridge connecting directly to the V&A East and London College of Fashion.

2 Redman is also the new global headquarters for Cancer Research UK and the British Council. Other occupiers include FNZ, Mind and the National Institute for Health and Care Excellence (NICE).

Just over 48,600 sq ft of office space remains available at the top of the building over the 9th, 8th and part 7th floors. Units are available from 8,722 sq ft upwards.

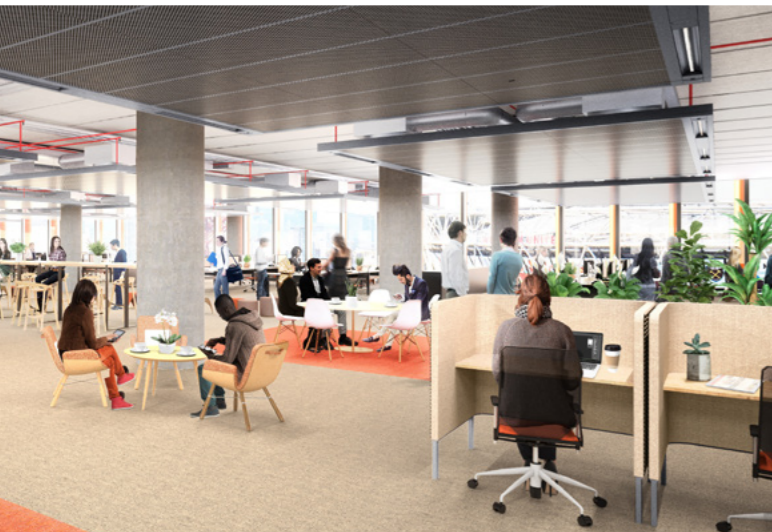

In Stratford YOU CAN

International Quarter London (IQL) is an incredible neighbourhood at the heart of Stratford that brings the best of London together in one place.

Creating an ambitious new way of life that combines the very best of London's culture, entertainment, shops and restaurants with beautiful homes and globally recognised workplaces.



IQL
STRATFORD





Feel the energy



At the heart of a growing inclusive innovation community, IQL is attracting some of the best talent and positioned to tap into the growing science and tech corridor and East London jobs boom.

Stratford has been labelled one of the healthiest workplaces in London by the Centric Lab due to its quality of fresh air and low noise, making it an ideal place to spend time outdoors.

There is a genuine sense of excitement around Stratford – of optimism and anticipation about the transformation that is happening and what has still yet to come.

This energetic neighbourhood is rich with diversity, room to breathe, and everything at your fingertips - from a shopping destination to the East Bank art and cultural quarter, world leading education facilities including UCL and UAL, all set amongst the legacy of the Olympic facilities.

Welcome to IQL Stratford



STRATFORD INTERNATIONAL STATION

STRATFORD HOTEL

WESTFIELD STRATFORD

STRATFORD STATION

S1

S2

S3

S11

S10

THE TURING BUILDING

2 REDMAN PLACE

EAST VILLAGE

COMPLETE PIPELINE

D&D LONDON'S HAUGEN
OPEN SEPT 2021

V&A EAST
2025

LONDON COLLEGE OF FASHION
2023

BBC MUSIC
2025

SADLER'S WELLS EAST
2025

QEOP - 560 ACRES OF GREEN PARKLAND AND CANAL ROUTES

Located in the heart of the Queen Elizabeth Olympic Park, IQL is delivering 2.5m sq ft of highly sustainable workspace in one of the healthiest neighbourhoods in the capital and within one of London's most exciting new Innovation Districts.

1m sq ft already complete and let and 1.5m sq ft still to come.

Be Direct

'Changeless' travel to and from Stratford reaching across the whole of London.

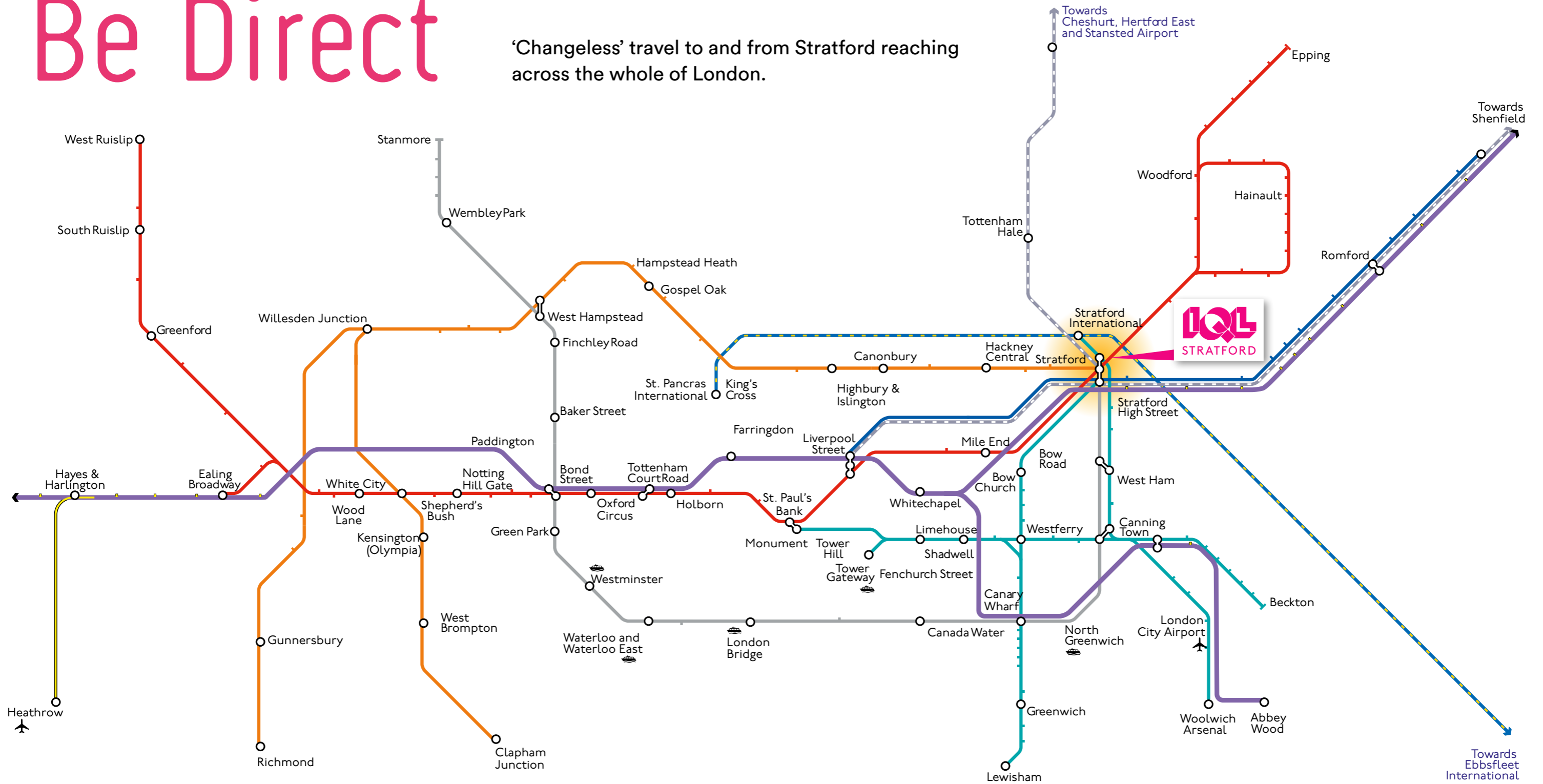

6

mins high speed train to King's Cross St Pancras

7

mins to Liverpool Street

8

mins to Canary Wharf

10

mins to Tottenham Court Road

14

mins to London City Airport

15

mins to Bond Street

20

mins to Waterloo

- Central
- Jubilee
- Docklands Light Railway
- London Overground
- Elizabeth Line (Crossrail)
- Abellio Greater Anglia
- Southeastern High Speed (the Javelin)
- TfL Rail
- Interchange stations
- ✈ Airport
- ⚓ Riverboat services

A workplace beyond boundaries

As Activity Based Working evolves to a city scale, we're building infrastructure that workstyles can evolve in to. Workplace at IQL extends beyond the boundaries of a rented tenancy out to the building and public spaces. With places to meet and work both in and outdoors including tech enabled outdoor office structures and walking routes that connect through the park, supported by Olympic grade digital infrastructure.



Floorplans

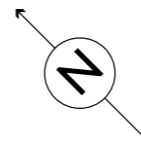

With 100% fresh air to the offices, full height glazing and spectacular views, these ready to go offices are available for immediate occupation

Floor	sqm	sq ft
7	810	8,722
8	1,853	19,943
9	1,853	19,943
Total	4,516	48,608

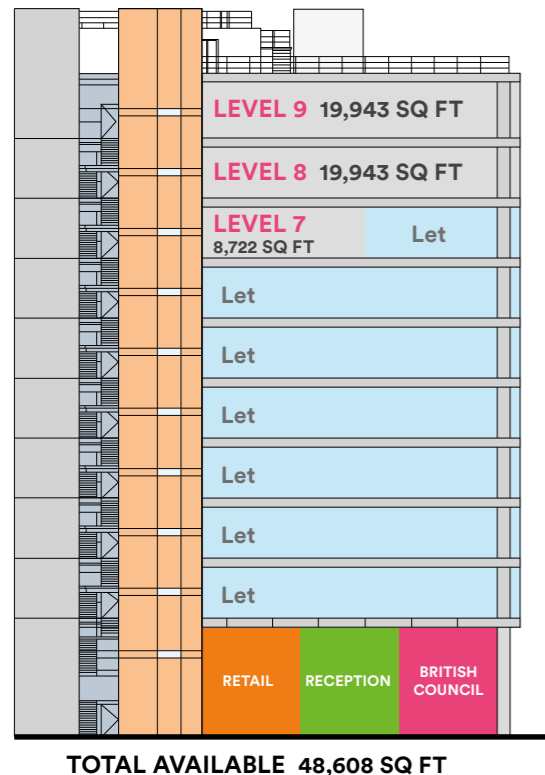

The details



EPC B



WELL GOLD



BREEAM
OUTSTANDING

In the top 2% of buildings in London



AIR
CONDITIONING

Fan coil air conditioning
100% fresh air
13.6 litres per second per person



END OF TRIP
FACILITIES

257 Bicycle Parking Spaces
22 Showers
346 Lockers

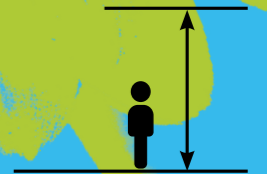

3.45M

Average floor to underside of the soffit



Get in touch

For any further information
please contact:



Felicity Ranger

Central London Office Leasing Manager

M +44 (0)7525 593 550

felicity.ranger@lendlease.com

Agents:



Angus Goswell

angus.goswell@knightfrank.com

+44 (0)7717 343 151

Ian McCarter

ian.mccarter@knightfrank.com

+44 (0)7940 508 650



Simon Crotty

simon.crotty@eu.jll.com

+44 (0)7826 947 267

Matt Mycock

matthew.mycock@eu.jll.com

+44 (0)7795 010 136



Fred Hargreaves

fred.hargreaves@bnpparibas.com

+44(0)7909 684 413

Tom Marsden

tom.marsden@bnpparibas.com

+44 (0)7904 980 073

