

SECTION A

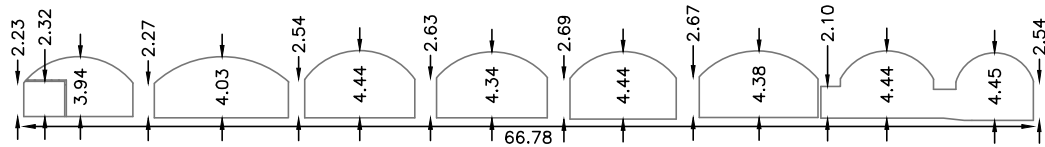

SECTION B

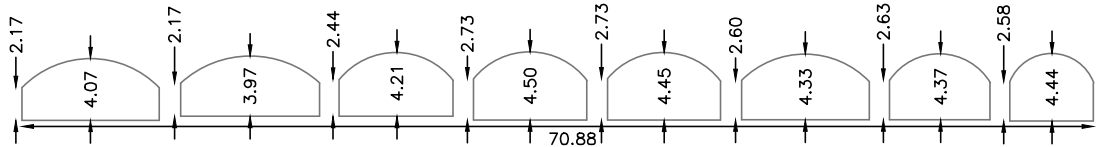

Property Ref: **VXH03100**

Arches Bet Vauhall Walk & Tin-
LONDON, SE1 7TL



Rental Space Ref: **VXH03105**

Part Arch 88 & Arches 89-95 Glasshouse Walk, LONDON, SE1

Net Internal Area

NIA **1796.38 sq m** **19336 sq ft**

The following have been INCLUDED in the TOTAL NIA:

INT_RAI	10.45 sq m	112 sq ft
SLU_1	506.78 sq m	5455 sq ft
SLU_2	222.79 sq m	2398 sq ft
SLU_3	225.59 sq m	2428 sq ft
SLU_4	841.22 sq m	9055 sq ft

The following have been EXCLUDED from the TOTAL NIA:

INT_LOW	1.02 sq m	11 sq ft
INT_OTH	3.48 sq m	37 sq ft

Gross Internal Area

GIA **1800.88 sq m** **19384 sq ft**

The following have been INCLUDED in the TOTAL GIA:

SLU_1	506.91 sq m	5456 sq ft
SLU_2	222.79 sq m	2398 sq ft
SLU_3	225.59 sq m	2428 sq ft
SLU_4	845.59 sq m	9102 sq ft

Land Area

LAND **68.83 sq m** **741 sq ft**

The following have been INCLUDED in the TOTAL Land Area:

EXT_COV	20.12 sq m	217 sq ft
EXT_VEH	48.71 sq m	524 sq ft

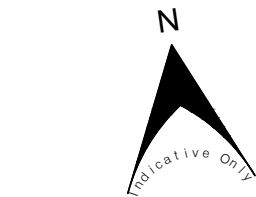

ALBERT EMBANKMENT

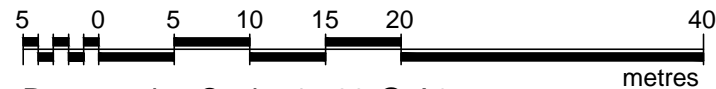
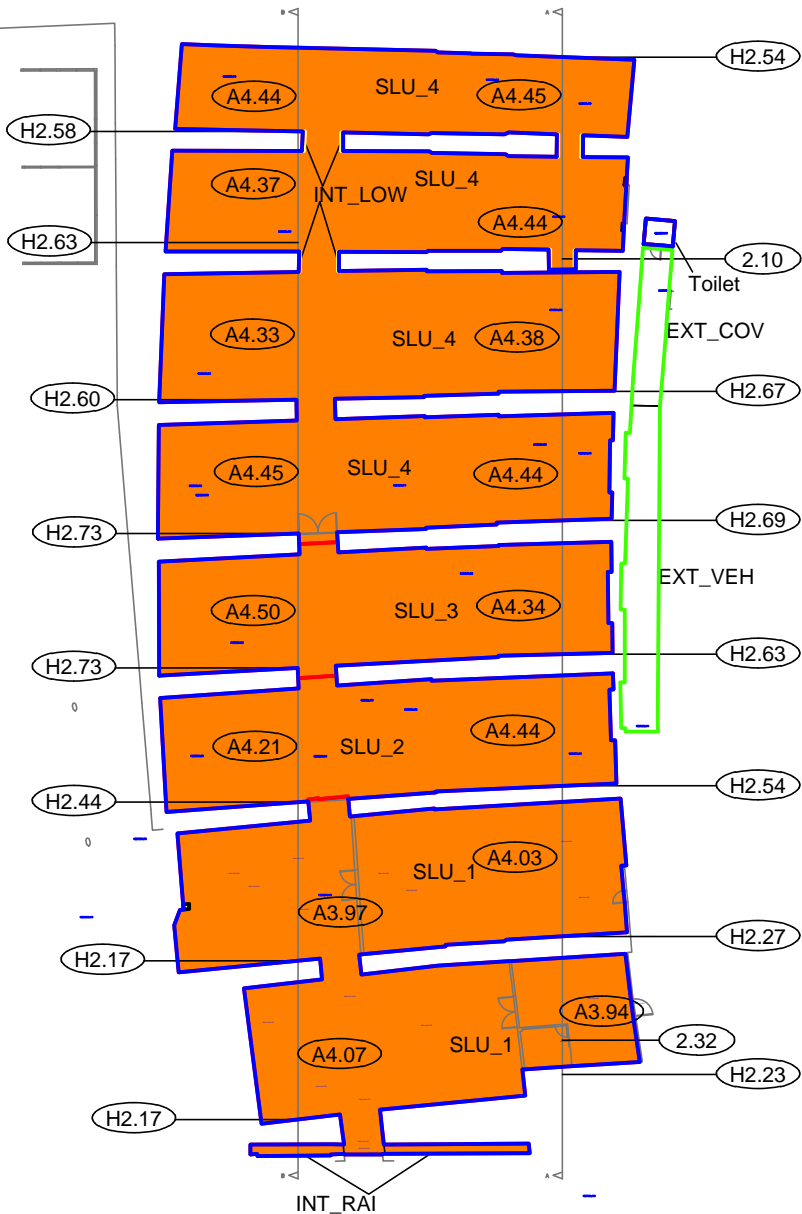

Presentation Scale 1:500 @ A3

Notes:
This drawing complies with the RICS Code of Measuring Practice, 6th edition (September 2007) and the Globally applicable 6th Edition (May 2015). It indicates the extent of the areas quoted, produced to an accuracy commensurate with standard presentation scales. It is held in a scaled digital CAD format.

This drawing has been produced for area referencing purposes requested by the original commissioning agent and must not be used for any architectural or construction/engineering purposes or for any other purpose other than that for which it is originally intended. Plowman Craven Limited accepts no responsibility for details that are subsequently found to be the consequence of undisclosed facts or that were obscured from view at the time of survey or that have been altered since the date of survey.

This drawing contains Ordnance Survey data which has been reproduced with the permission of the Controller of Her Majesty's Stationery Office, Crown copyright 2020. The Ordnance Survey data has been obtained and reproduced by Plowman Craven Ltd in agreement with The Arch Company under Network Rail Licence Number 100040692.

Legend:
Single Lettable Unit
Restricted Headroom
H0.00 Haunch Height (m)
A0.00 Arch Maximum Height (m)
0.00 Floor To Ceiling Height (m)

Revisions:
P01 - Original Issue (August 2023)

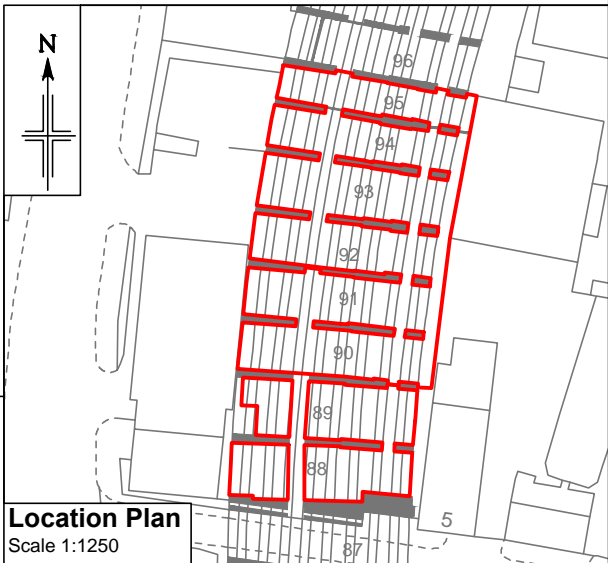

Dwg No. **43264-PCL-VXH03105-GF-DR-G-00001_Master-S6-P01**

Plowman Craven
Regulated by RICS

