

Scale Space 58 Wood Lane White City, London W12 7RZ

FANTASTIC FULLY FITTED & FURNISHED OFFICE FLOOR TO LET

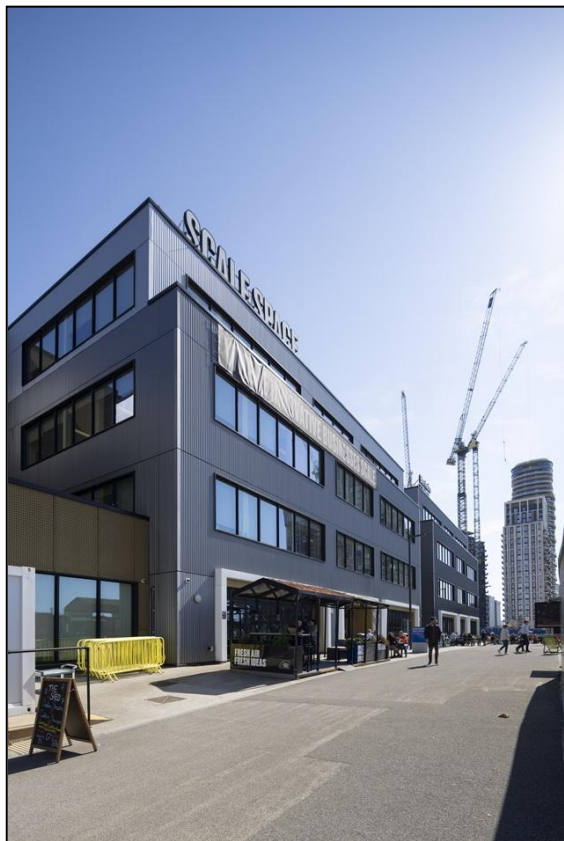

5,683 SQ. FT. (528 SQ. M.)

LOCATION

Scale Space is a modern office building, prominently situated on the east side of Wood Lane, opposite the junction with South Africa Road. The area is very well served by public transport with White City (Central Line) and Wood Lane (Hammersmith & City and Circle Lines) being less than a 5 minute walk of the building and numerous bus routes operating from Wood Lane.

White City is recognised as one of the leading office and business locations in Central / West London with major occupiers including Imperial College, Net-A-Porter, BBC, ITV, L'Oreal, Publicis, and The White Company forming a thriving business community in the increasingly popular office location.

The area also benefits from excellent retail and restaurant amenities, underpinned by Westfield, which is situated just a 5-minute walk away.

ACCOMMODATION

Providing a sensible mix of open plan areas, meeting rooms, collaboration space together with a kitchen and break out area, totalling 5,683 sq ft.



**Scale Space
58 Wood Lane
White City, London
W12 7RZ**

HanoverGreen





**Scale Space
58 Wood Lane
White City, London
W12 7RZ**

 **HanoverGreen**





Scale Space
58 Wood Lane
White City, London
W12 7RZ



Scale Space is home to an innovative community of science and tech start-ups, and engineered to give businesses access to the right people, services and space they need to grow. With an onsite café and sports facilities onsite it provides a fantastic opportunity for businesses to join an innovative community as part of the Imperial campus. Scale Space is a JV between Imperial College London and Blenheim Chalcot and the space being offered is currently occupied by an Imperial College department.

AMENITIES

- Fully air conditioned
- Fully accessible raised floor
- On site recording studio, available on a separate booking basis
- Two automatic passenger lifts
- Ground floor cafeteria
- LED lighting
- Full height windows
- Communal meeting rooms available on a booking basis
- Manned reception
- Superb natural light
- Showers
- Fully fitted and furnished to a high standard
- Bike storage

TERMS

An assignment of the existing lease which is held for a term to expire on the 12th March 2035, subject to annual index linked rent reviews on the 1st July. The rent reviews are subject to a cap, further information upon request.

The lease is subject to a landlords break option effective from 30th June 2030 and the lease is held outside of the provisions of the Landlord & Tenant Act 1954 which relate to security of tenure and compensation.

Alternatively, a new sub-lease is available for a term to be agreed – terms upon request.



Scale Space
58 Wood Lane
White City, London
W12 7RZ



RENT

Current passing rent £233,448.04 per annum exclusive of VAT, equating to £41.08 per sq ft per annum exclusive.

RATES

Approx. £25.00 per sq.ft. payable.

SERVICE CHARGE

Currently running at £12.56 per sq.ft. exclusive of VAT.

ESTATE CHARGE

Between £1.50-2.00 per sq.ft. exclusive of VAT.

LEGAL COSTS

Each party is to be responsible for its own legal costs incurred in this transaction.

POSSESSION

Available August 2025, or possibly earlier.

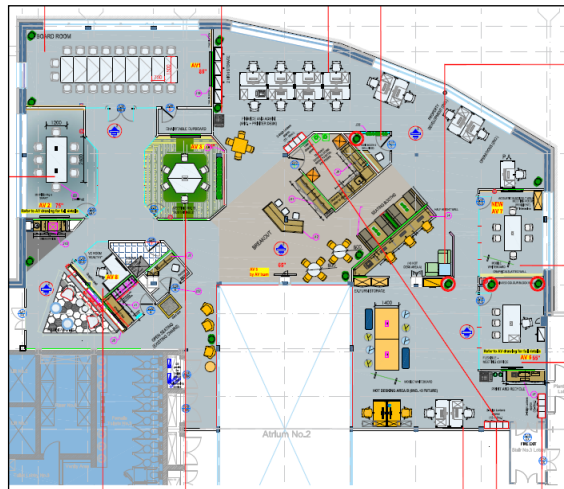

Viewings by arrangement through joint agents Noble Harris or Hanover Green: -

Matthew Noble
mnoble@nobleharris.co.uk
020 7291 6142
079 8099 1214

Carl Dobrin
cdobrin@nobleharris.co.uk
020 7291 6141
075 4507 7959

David Cuthbert
dcuthbert@hanovergreen.co.uk
077 1018 3423

Richard Zoers
rzoers@hanovergreen.co.uk
077 3056 7607

MISREPRESENTATION ACT | COPYRIGHT | DISCLAIMER

Noble Harris LLP and Hanover Green LLP, for themselves and for the vendors of this property, whose agents they are, give notice that (1) the particulars and any further information communicated by any means to potential purchasers of the property described in the particulars, or their advisers, in connection with the possible sale of the property are provided solely for the purpose of assisting potential purchasers in decided whether they wish to proceed with further investigation of the property and do not constitute either the whole or any part of an invitation, offer or contract for sale of the property; (ii) all descriptions, dimensions, references to condition and necessary permissions for use and occupation and other details are given in good faith and are believed to be correct as at the date of the particulars (or the date of the relevant information if earlier). However, potential purchasers are not entitled to rely on them as statements or representations of fact but should satisfy themselves by searches, enquiries, surveys and inspections or otherwise with regard to the accuracy of such details. No responsibility or liability is or will be accepted by Noble Harris LLP or Hanover Green LLP, the vendor(s) of the property or any of their respective subsidiaries, affiliates, directors, officers, representatives, employees, advisors, or agents for any loss or damage suffered by any party, resulting from reliance on the particulars or any other information communicated by any means to that party, or its advisers, in connection with the possible sale of the property. No person in the employment of Noble Harris or the vendor(s) has authority to make or give any representation or warranty, express or implied, in property. References to Noble Harris LLP include any joint agents acting with Noble Harris LLP in the possible sale of the property. No person in the employment of Noble Harris LLP or Hanover Green LLP, or the vendor(s) has authority to make or give any representation or warranty, express or implied, in relation to the property. References to Noble Harris include any joint agents acting with Noble Harris.