

Notes

- 1 All dimensions are in millimeters.
- 2 Dimensions are not to be scaled directly from this drawing.
- 3 All dimensions are to be checked on site and the Architect is to be informed of any discrepancies before construction commences.
- 4 All references to drawings refer to the current revision of that drawing.
- 5 Structural and services information shown is indicative only. Refer to Consultants drawings for details and setting out.

Rev	Description	Date	By	Chk
R	Retail Unit F removed and combined with retail Unit A. Gym entrance and location changed. Retail Unit A and D layouts changed.	30.08.12	as	
Q	Dry Cleaner area amended	30.05.12	as	
P	Gym and Dry Cleaner areas amended	02.03.12	as	
N	Small office renamed F to avoid duplicate name	20.02.12	mp	
M	Units divided as requested	08.12.11	mp	
I	Units divided as requested	11.11.11	dk	
K	Units divided as requested	25.10.11	mp	
J	Units divided as requested	19.10.11	mp	
H	Units split as indicated	02.08.11	mp	
G	Units A and B combined	08.03.11	mp	
F	Text size amended for A3 use	15.04.10	mp	
E	Services Notes Added, Block B Lobby Updated, Substation Updated, Core D2 Added, Scale Amended to 1:50 & Sheet Size Updated To A0.	28.10.09	RA	MP
D	Additional Information Added.	30.01.09	MP	
C	Outline Of Substation Amended.	29.01.09	MP	
B	Outline Of Nursery Amended.	28.01.09	MP	
A	Substation Updated.	14.01.09	MP	

Rev Description Date By Chk

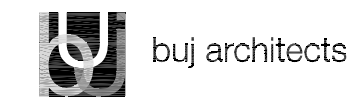

buj architects

35 Millharbour
London
E14 9TX

Tel: 020 7531 3300
Fax: 020 7531 3301
e-mail: buj@buj.co.uk

Job title
Lanterns Court
London E14

Drawing title
Block BC Ground Floor
Commercial Units
and Nursery

Drawn by mp **Date** 10/07 **Scale @ A3** NTS

Checked **Date** **Issued for** COMMENT

Job No.	Client Ref.	Project Status	Drawing No.	Revision
956	(--)	C	008	R