

TO LET
PART 6TH
FLOOR

RIVERSIDE SUITE.

NO.1 WHITEHALL RIVERSIDE,
1 RIVERSIDE WAY,
LEEDS, LS1 4BN



Newly refurbished light and spacious Grade A workspace with stunning riverside views.



Situated off Whitehall Road, only a few minutes' walk from the train station, the Riverside Suite provides a premium Grade A specification throughout, including basement car park.

This is an enviable business destination with all the benefits of the city centre and transport links on the doorstep.

4,015 sqft
6th floor
suite with a
Grade A
specification.

RIVERSIDE
SUITE.



Specification

Recently refurbished to include:

- New 4-pipe fan coil air conditioning
- New metal tiled suspended ceiling
- New ultra efficient LED lighting
- Fully accessible raised floors (150mm void)
- New carpets
- Clear floor to ceiling height of 2.8m
- Fitted kitchen facilities
- Four, 13 person passenger lifts
- 2 secure parking spaces & cycle storage
- Shower and changing rooms
- Building commissionaire

Indicative Space Plan

- 38 x fixed desks
- 16 x touch down workspaces
- 1 x 10 person meeting room
- 1 x 5 person meeting room
- 1 x 3 person meeting room
- 3 x 4 person booths
- Kitchen/Staff break out area
- 'Town Hall' collaboration area

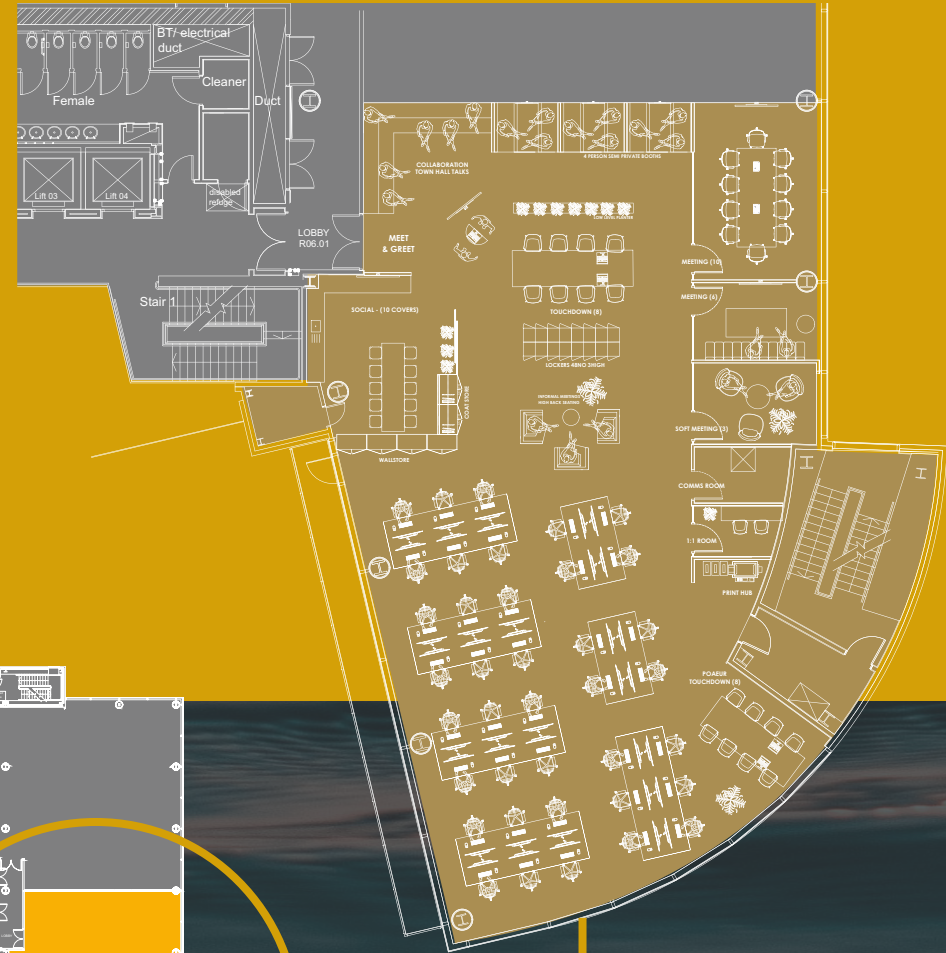

COME AND JOIN...

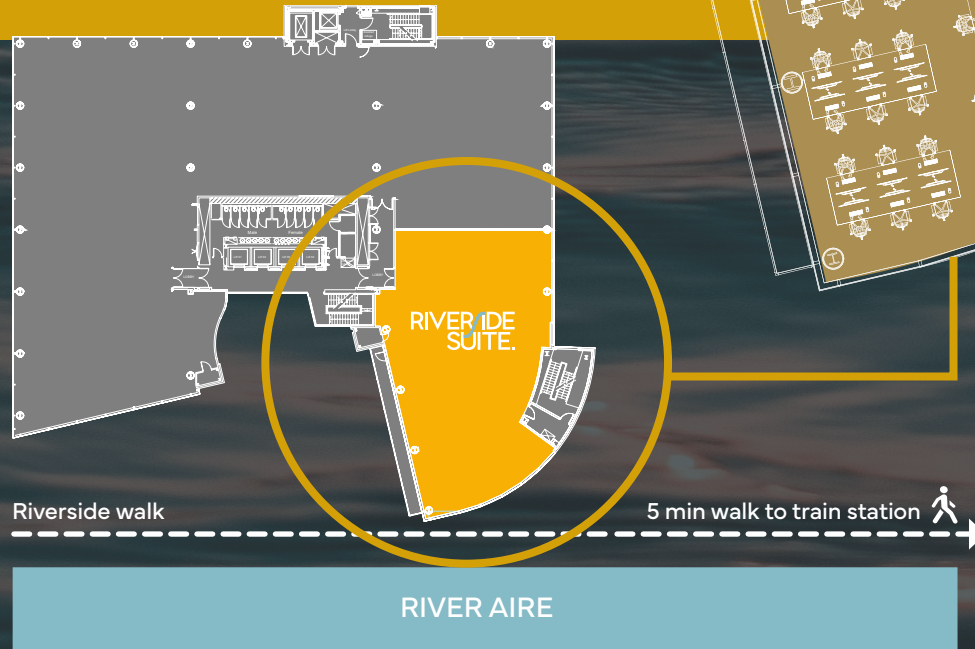

RIVERIDE
SUITE.



Indicative fit out



RIVERIDE
SUITE.



Indicative fit out



Additional bookable
meeting rooms available

Perfectly positioned in the dynamic west end business district of Leeds.

The superb location of Riverside Suite at No.1 Whitehall Riverside means you're only a short walk from Leeds Train Station and situated only minutes from great shopping, vibrant bars and fantastic restaurants.



EPC
EPC B - 44

Terms

The Riverside Suite is available by way of a Sub-Lease until December 2031. More flexible lease terms are available upon request.

RIVERSIDE
SUITE.

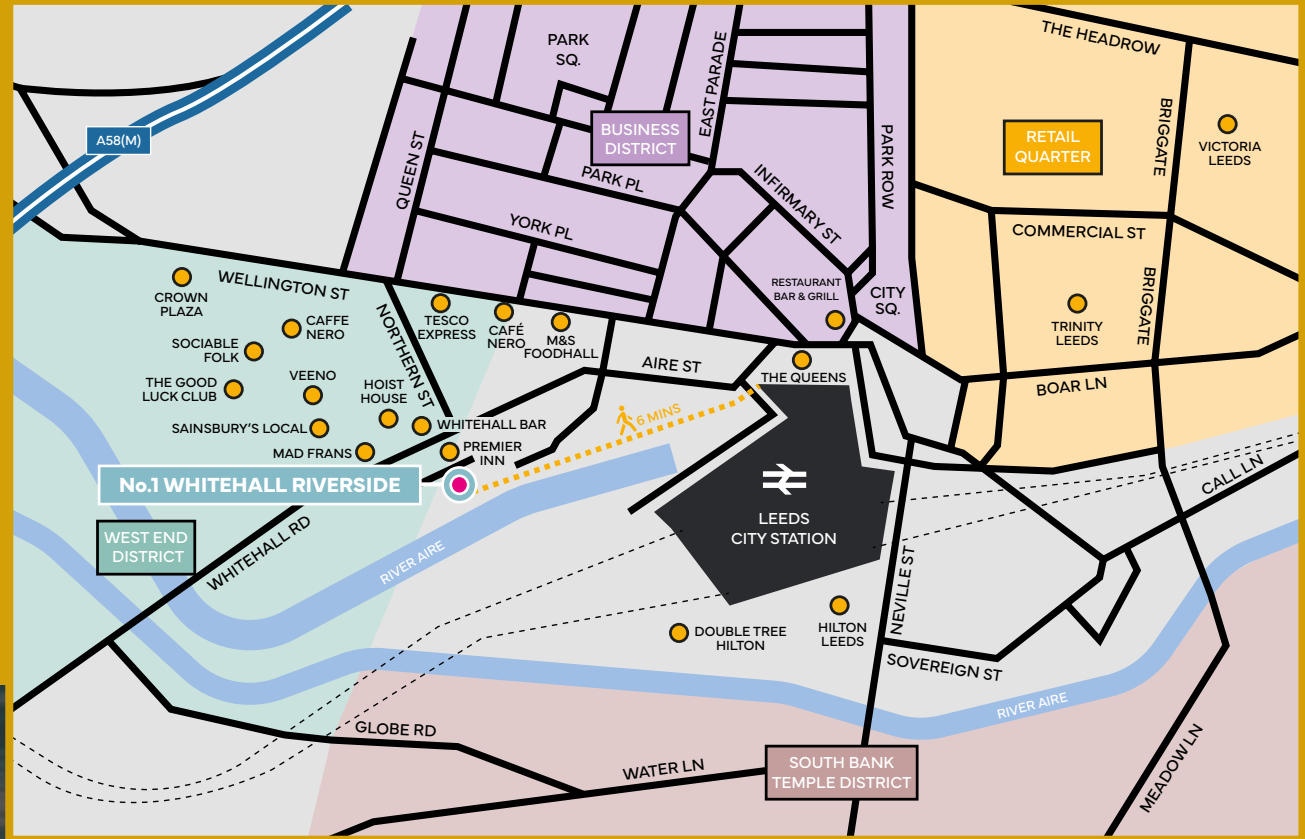

For further information or to arrange a viewing please contact the joint leasing agents - JLL and Sanderson Weatherall.



Tom Brammell

T: 07734 883071
E: tom.brammell@jll.com

Christabelle Day

T: 07849 570131
E: christabelle.day@jll.com



Richard Dunn

T: 07801 767859
E: richard.dunn@sw.co.uk

Jay Dhesi

T: 07518 290500
E: jay.dhesi@sw.co.uk

MISREPRESENTATION ACT:

JLL and Sanderson Weatherall for themselves and for the vendors or lessors of this property, whose agents they are give notice that: a) all particulars are set out as general outline only for the guidance of intending purchasers or lessees, and do not comprise part of an offer or contract: b) all descriptions, dimensions, references to condition and necessary permissions for use and occupation, and other details are given in good faith and are believed to be correct but any intending purchasers or tenants should not rely on them as statements or representations of fact but must satisfy themselves by inspection or otherwise as to the correctness of each of them. c) no person in the employment of JLL and Sanderson Weatherall has any authority to make any representation of warranty whatsoever in relation to this property. Design and Production DS.EMOTION May 2024_7947