

AREA PLAN

5-8 DYSART STREET

LONDON, EC2

Second Floor

Net Internal Area

	OFFICE	169.6 sq m	1826 sq ft
---	--------	------------	------------

TOTAL NIA: 169.6 sq m 1826 sq ft

The following has been EXCLUDED from the TOTAL NIA:

Door Recess	0.4 sq m	4 sq ft
Heater	0.7 sq m	8 sq ft

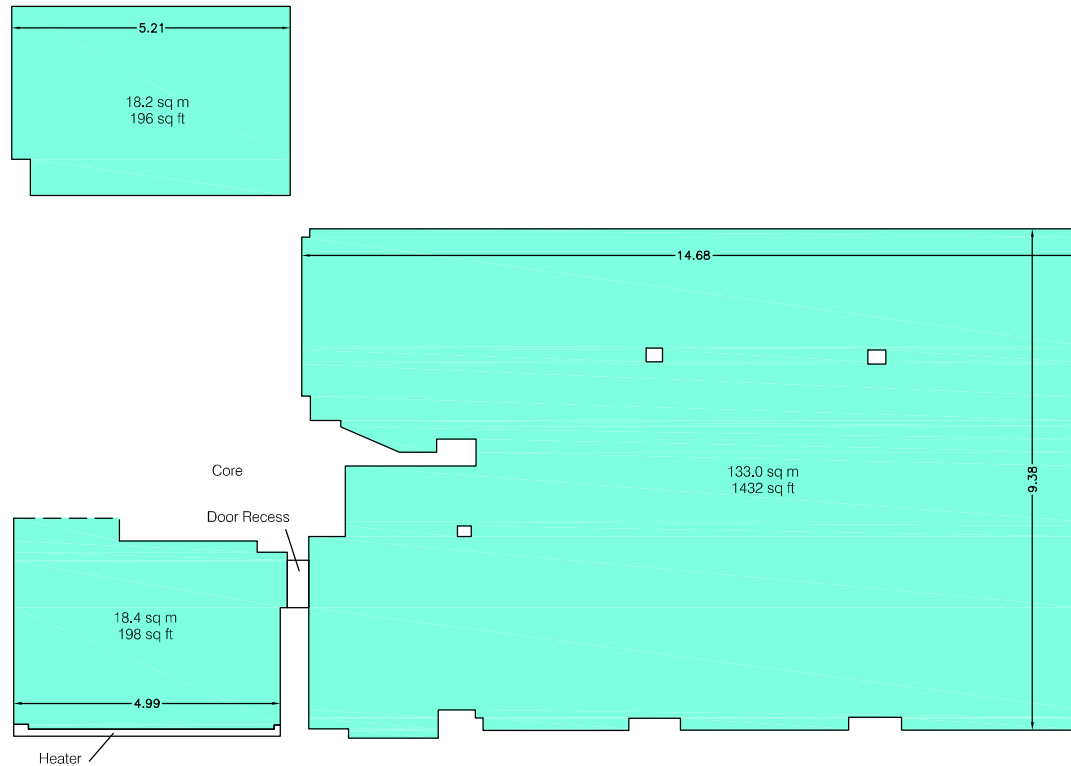

DYSART STREET

Condition of Site:
Occupied
Vacant
Heavy Fit-Out
Shell & Core
Under Construction
Cat A Fit-Out

Notes:
This drawing complies with the 6th edition of the RICS code and indicates the extent of the areas quoted, produced to an accuracy commensurate with standard presentation scales.
It is held in a scaled digital CAD format.
Dashed line denotes assumed wall line, Wall line inaccessible due to fixtures and fittings.

Revisions:
A - Original Issue (March 2011)

Dwg No. 24797-A2

Issue A

March 2011

Scaled for presentation purposes

Plowman Craven

Regulated by RICS



+44(0)1582 765566

www.plowmancraven.co.uk