

- NOTES**
- This drawing is to be read in conjunction with all relevant drawings documents & specifications.
 - Do not scale from this drawing, use figured dimensions only, and check all dimensions on site.
 - Copyright is reserved by RSR INTERIORS LIMITED, this drawing is issued on the condition that it is not copied, reproduced, retained or disclosed to any unauthorised person either wholly or in part without the consent in writing of RSR INTERIORS LIMITED.

- LEGEND**
- EXISTING WALLS
 - NEW DOUBLE SWANNECK 100MM H/P FIRE RATED STUD PARTITION
 - NEW SINGLE SWANNECK 75MM STUD PARTITION
 - NEW 100MM HORIZONTAL MIDDLE TO WINDOW HEIGHT
 - NEW SOLID CORE FIBREGLASS DOOR
 - NEW FULL HEIGHT TOUGHENED GLASS DOOR
 - EXISTING DOOR

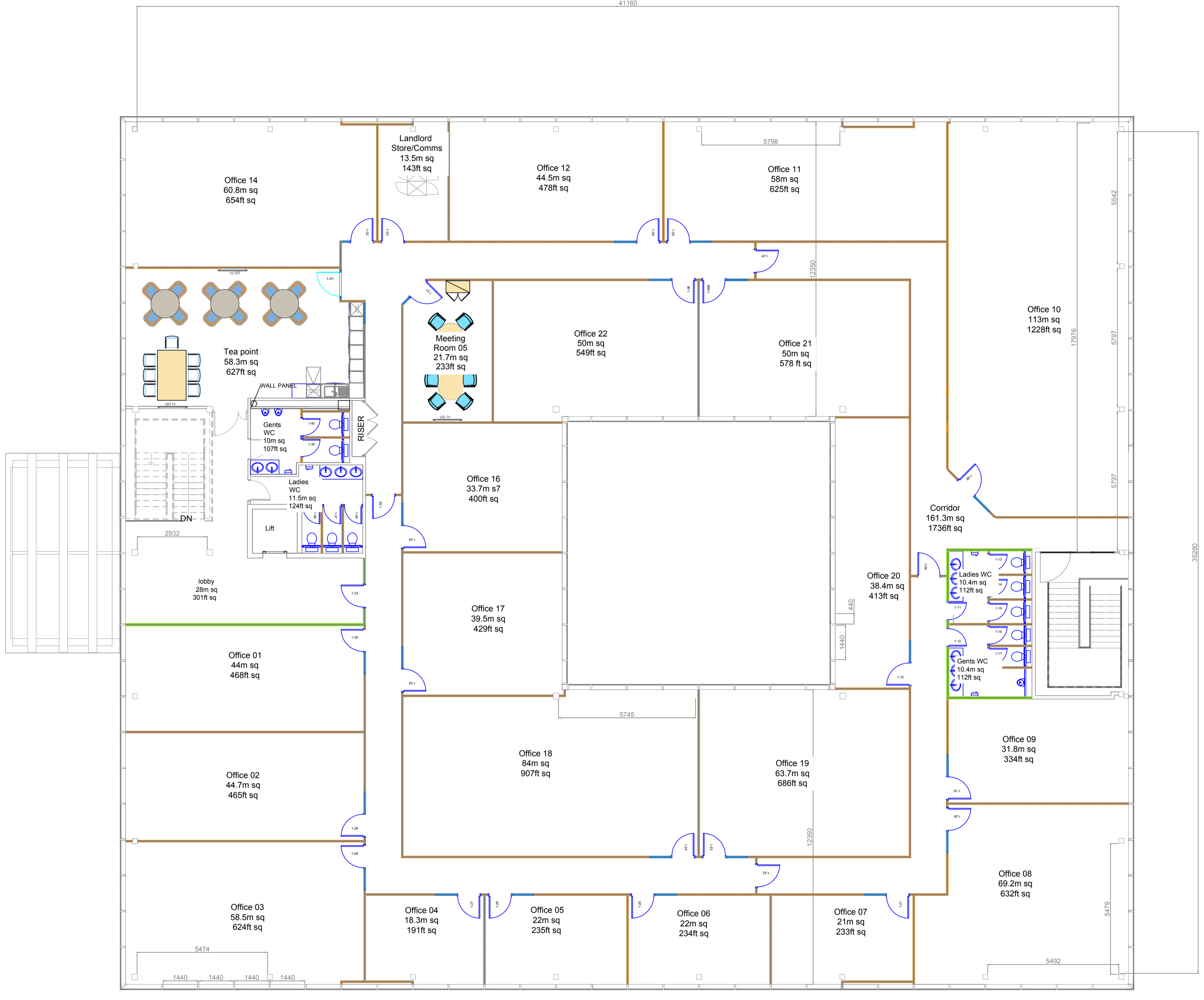

1st Floor GA

1st Floor GA
Scale 1:100@ A1

Rev	AS BUILT	Description	By	Chkd	Date

CLIENT:
H.I.G Bauer Property Limited

PROJECT NUMBER: INT07381
ADDRESS:
Scorpio House,
Rockingham Drive, Linford
Wood Business Park,
Milton Keynes, MK14 6LY

DESCRIPTION:
1st Floor General
Arrangement Layout

AS BUILT		PRE CONSTRUCTION CONSTRUCTION AS BUILT	
DRAWING NUMBER	APPROVED	DRAWING NUMBER	APPROVED
04-08-17	1:100@A1		
DATE	SCALE		REVISION



RSR INTERIORS LTD
Lumen House, Rockingham Drive
Linford Wood, Milton Keynes, MK14 6LY
Phone: 01908 218830 Fax: 01908 969414
Email: enquiries@rsresponse.co.uk

