

TO LET



Unit 9A Coldhams Business Park, Cambridge, CB1 3LH

Advanced Manufacturing / Distribution unit

34,388 sq ft (3,195 sq m)



To be fully refurbished

Summary

Description

Unit 9A is a modern, high-specification advanced manufacturing and distribution warehouse facility situated at the end of a terrace of three warehouse units. It is of traditional steel portal frame construction with profile metal clad elevations.

Terms

Available by way of a direct lease with the landlord. Quoting rent available on application.

Additional Information

Business Rates

Interested parties are encouraged to enquire directly with the local authority, Cambridge City Council: www.cambridge.gov.uk

Services

Mains drainage, water and electricity are believed to be available to the Property. Interested parties are however advised to make their own enquiries to the relevant service providers.

Postcode

CB1 3LH

Legal costs

All parties to bear their own legal costs.

Value added tax

All prices, premiums and rents etc. are quoted exclusive of VAT at the prevailing rate.

EPC

EPC Rating - C71.
Certificate available upon request.

Specification Includes

- Semi-detached unit
- Two-storey offices to front elevation
- 7.7m clear height to warehouse
- 1 x dock level door
- 1 x level access door
- Impressive double height reception area
- 65 car parking spaces
- Existing power supply of 200 kVA, with scope to upgrade



Location

Coldhams Business Park is strategically located in the heart of Cambridge City adjacent to Cambridge Airport.

It is highly accessible for distribution and production businesses, being located at the interchange of the A14, A11 and M11, approximately 20 miles north of Stansted, 50 miles north of London and 54 miles west of Felixstowe. Unit 9A is well-served by local bus routes, as well as by rail (Cambridge mainline station 2.5 miles) with a direct line service to Kings Cross (53 mins) and Stansted Airport (30 mins). The Unit is also easily accessible by bicycle.

Coldhams Business Park benefits from a number of amenities on-site including: an 80 bedroom Holiday Inn Express Hotel and David Lloyd Gym and tennis club. In addition, a Sainsbury's superstore and petrol station are located approximately 1/2 mile from the property. Adjacent business's include: Booker Cash & Carry, Huws Gray, Travis Perkins, AGFA, BSS and Toyota and Lexus.

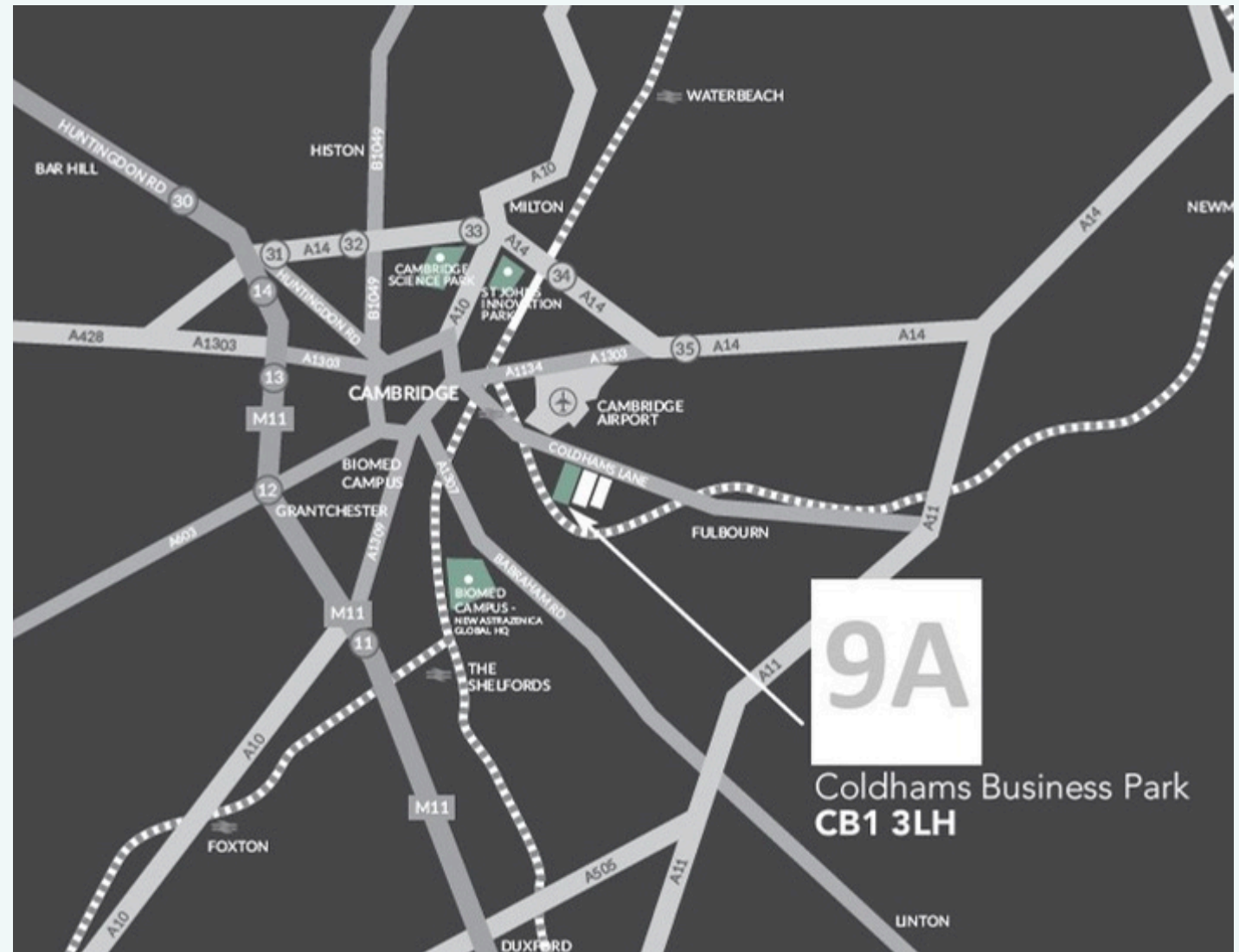

Accommodation

Unit 9A

Description	Sq Ft	Sq m
Ground floor Warehouse	26,854	2,495
Ground floor offices & ancillary	3,767	350
First floor offices	3,767	350
Total	34,388	3,195



All measurements are made on a Gross Internal Area (GIA) basis.

Floor Plans

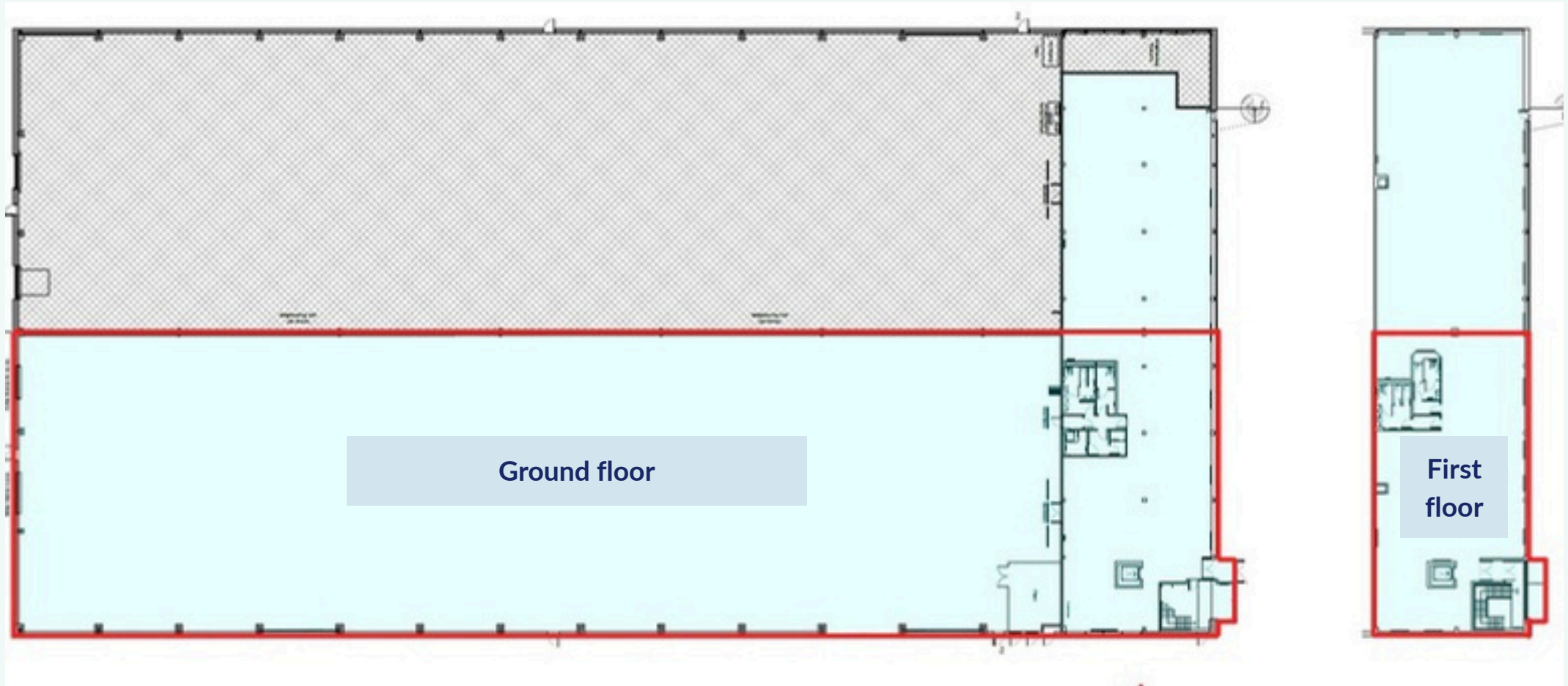

Gallery

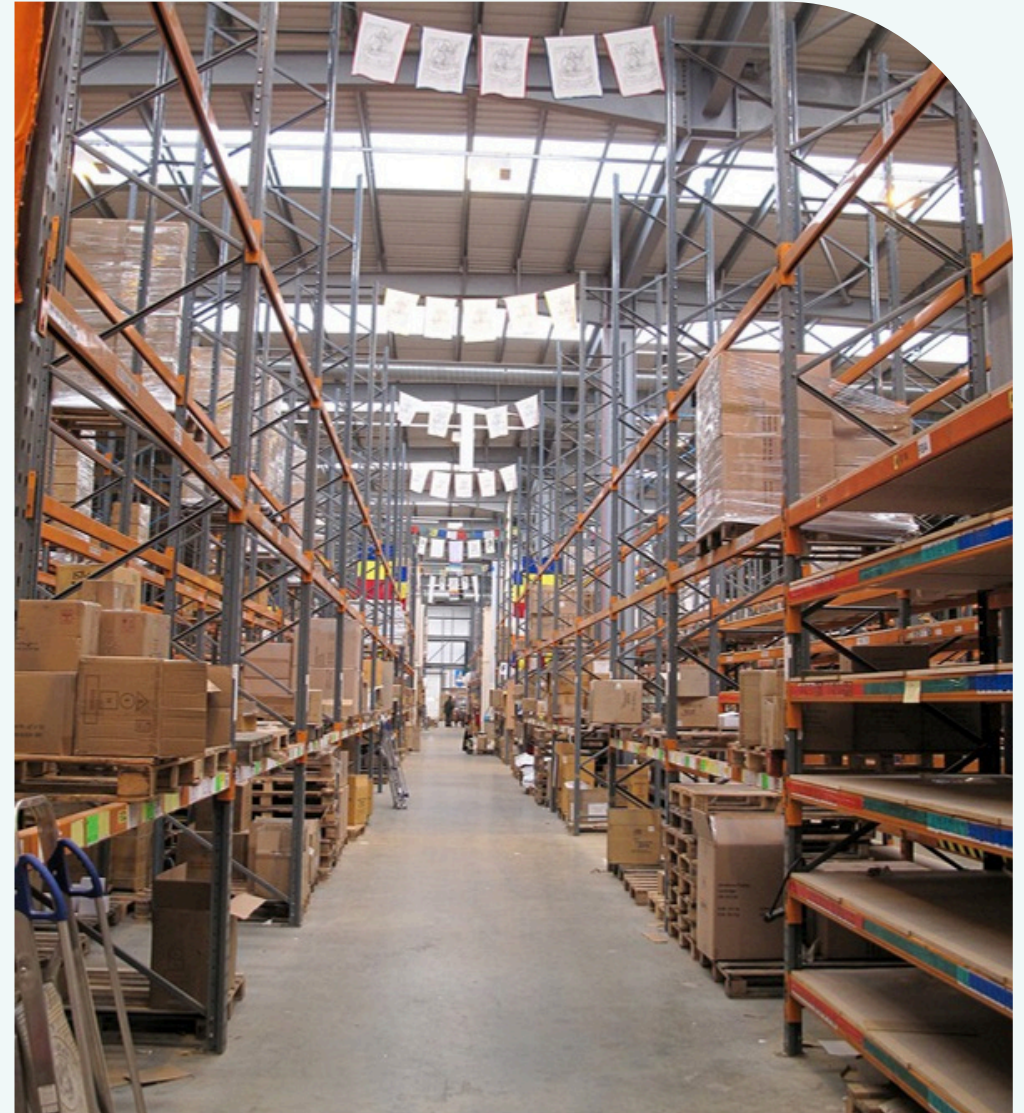

Gallery

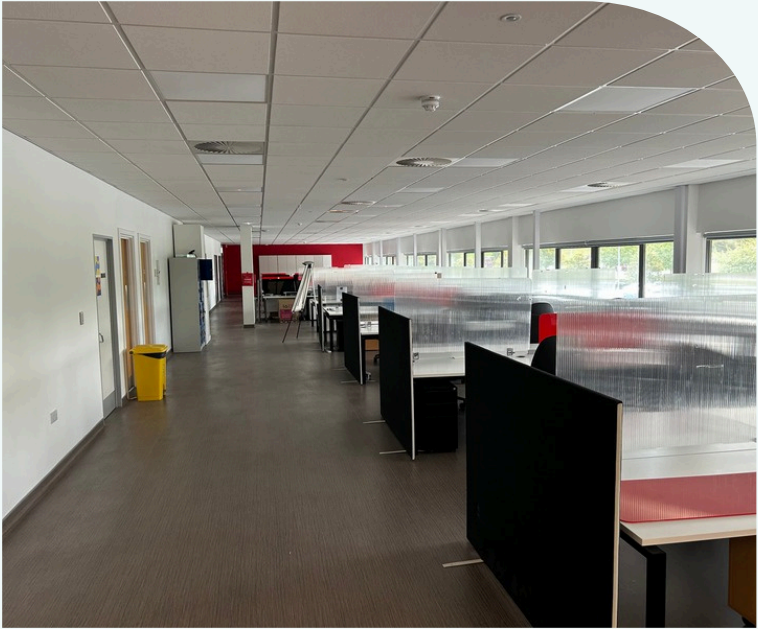

January 2026



*Get in touch with
our experts*



Walter Scott

07918 081533

walter.scott@bidwells.co.uk



Rory Banks

07976 832083

rory.banks@bidwells.co.uk

Important notice

Bidwells LLP act for themselves and for the vendors/landlords of this property, whose agents they are, give notice that:

Nothing contained in these particulars or their contents or actions, both verbally or in writing, by Bidwells LLP form any offer or contract, liability or implied obligation to any applicants, viewing parties or prospective purchasers of the property to the fullest extent permitted by law and should not be relied upon as statements or representative of fact. No person in the employment of Bidwells LLP or any joint agents has authority to make or give any representation or warranty whatever in relation to this property. Any areas of measurements or distances are approximate. The text, photographs and plans are for guidance only, may not be to scale and are not necessarily comprehensive. No assumptions should be made that the property has all necessary planning, building regulation or other consents. Bidwells LLP has not carried out a survey, nor tested the services, appliances or facilities. Purchasers must satisfy themselves by inspection or otherwise. All rentals and prices are quoted exclusive of VAT unless otherwise stated.

Prospective purchasers and tenants will be asked to produce identification of the intended purchaser/tenant and other documentation in order to support any conditional offers submitted to the vendors. Bidwells LLP accepts no liability of any type arising from your delay or other lack of co-operation. We may hold your name on our database unless you instruct us otherwise.

OS licence no. ES 100017734. © Copyright Bidwells LLP 2017. Bidwells LLP is a limited liability partnership registered in England and Wales (registered number OC 344553). Registered office is Bidwell House, Trumpington Road, Cambridge CB2 9LD where a list of members is available for inspection. Your statutory rights are not affected by this notice.

