

## 33 CAVENDISH SQUARE, MARYLEBONE, LONDON W1G 0DT

Grade A Office to Let – 2,380 sq ft to  
55,567 sq ft.



### LOCATION

The property is located on Margaret Street with retail units on the ground floor on Oxford Street. There is extensive shopping, restaurants and bars in a close proximity.

### DESCRIPTION

33 Cavendish Square is a landmark tower building which provides 200,000 sq ft of open plan office accommodation over nineteen upper floors. The building provides a rare opportunity to occupy prime office accommodation in one of London's finest Georgian Squares which offers panoramic views across Central London from the upper floors.

### AMENITIES

- Double height entrance hall
- 8 x 20 passenger lift
- Four pipe fan coil air conditioning
- Raised floor

- Onsite car and bike parking
- Secure basement storage
- Fully integrated management system
- 24 hour access and security
- Onsite management team

### TRANSPORT LINKS

Oxford Circus  2 minutes  
Bond Street  3 minutes

### AVAILABILITY

Floor	Wing	Area (sq ft.)	Rent (PSF)	Rates (PSF)	S.C. (PSF)
14 <sup>th</sup>	N & S	7,157	£79.50	£36.98	£20.15
11 <sup>th</sup>	E	4,241	£67.50	£36.08	£20.15
11 <sup>th</sup>	N & S	7,334	£67.50	£36.08	£20.15
8 <sup>th</sup>	N	2,380	£75.00	£38.15	£20.15
7 <sup>th</sup>	E & S	8,124	£60.00	£37.98	£20.15
6 <sup>th</sup>	E	4,170	£57.50	£28.45	£20.15
5 <sup>th</sup>	N,E & S	15,043	£57.50	£28.84	£20.15
3 <sup>rd</sup>	N & S	7,208	£52.50	£28.84	£20.15
3 <sup>rd</sup>	E	3,905	U/O	£28.84	£20.15

### TERMS

The space is available on a new lease direct from the landlord, on a term by arrangement.

### CONTACT

**Maxim Vane Percy: 020 7866 7628**

[maxim.vanepercy@montagu-evans.co.uk](mailto:maxim.vanepercy@montagu-evans.co.uk)

**Alex Kirk: 020 3962 6453**

[alex.kirk@montagu-evans.co.uk](mailto:alex.kirk@montagu-evans.co.uk)

**Megan Davies: 07341114753**

[megan.davies@montagu-evans.co.uk](mailto:megan.davies@montagu-evans.co.uk)

**Joint agents: CBRE – 020 7182 2000**

For further information or to arrange a viewing.

## 11<sup>th</sup> FLOOR PLAN

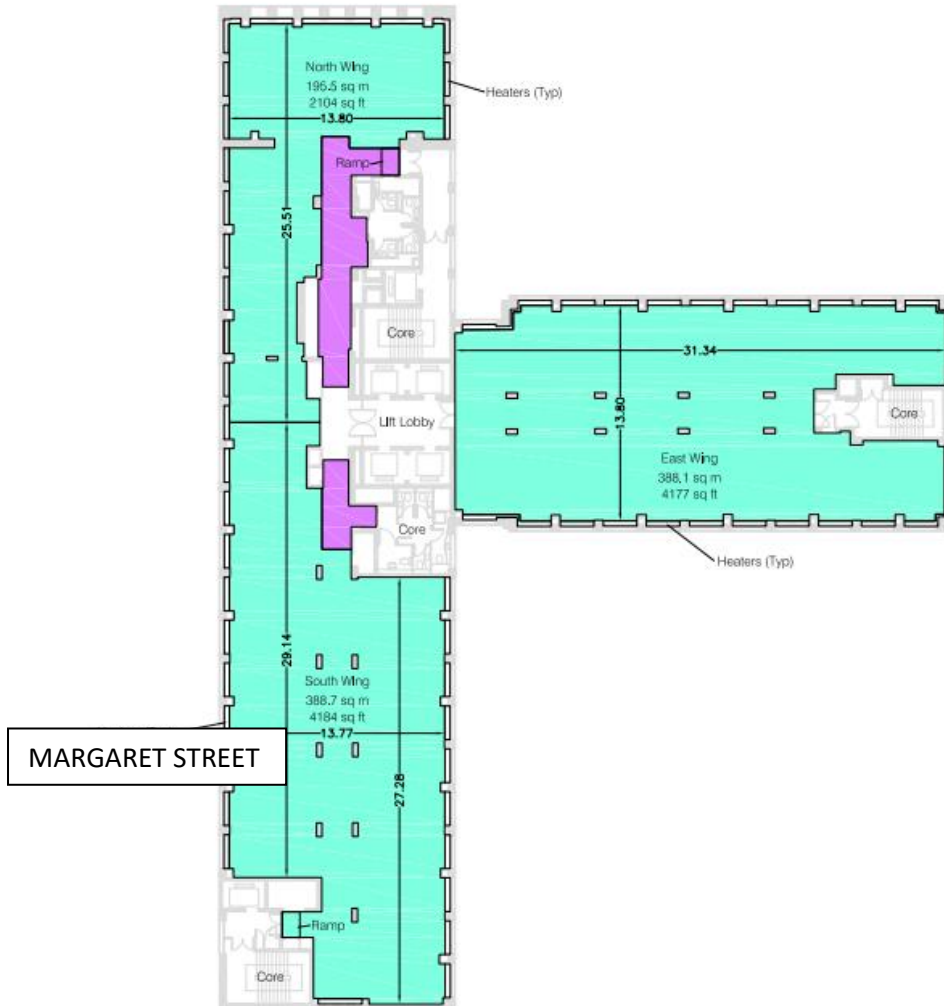
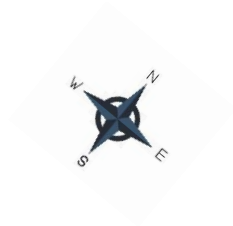

**Matterport Video 7th Floor East Wing:** <https://my.matterport.com/show/?m=88SCKbgpMtC>



**Matterport Video 7th Floor South Wing:** <https://my.matterport.com/show/?m=iqva9wcnMpp>

**Matterport Video 14<sup>th</sup> Floor North & South Wing:** <https://my.matterport.com/show/?m=J154sfZLPPM>