





NOTES:
 ALL INFORMATION CONTAINED IN THIS DRAWING (INCLUDING DIGITAL DATA) SHOULD BE CHECKED & VERIFIED PRIOR TO ANY FABRICATION OR CONSTRUCTION.

-  OFFICE A - VACANT
NIA Area = 1079.53m² (11620ft²)
-  OFFICE B - VACANT
NIA Area = 119.37m² (1285ft²)
-  OFFICE C - BMA
NIA Area = 1105.69m² (11902ft²)
-  VAULTED SUITES
NIA Area = 582.88m² (6274ft²)

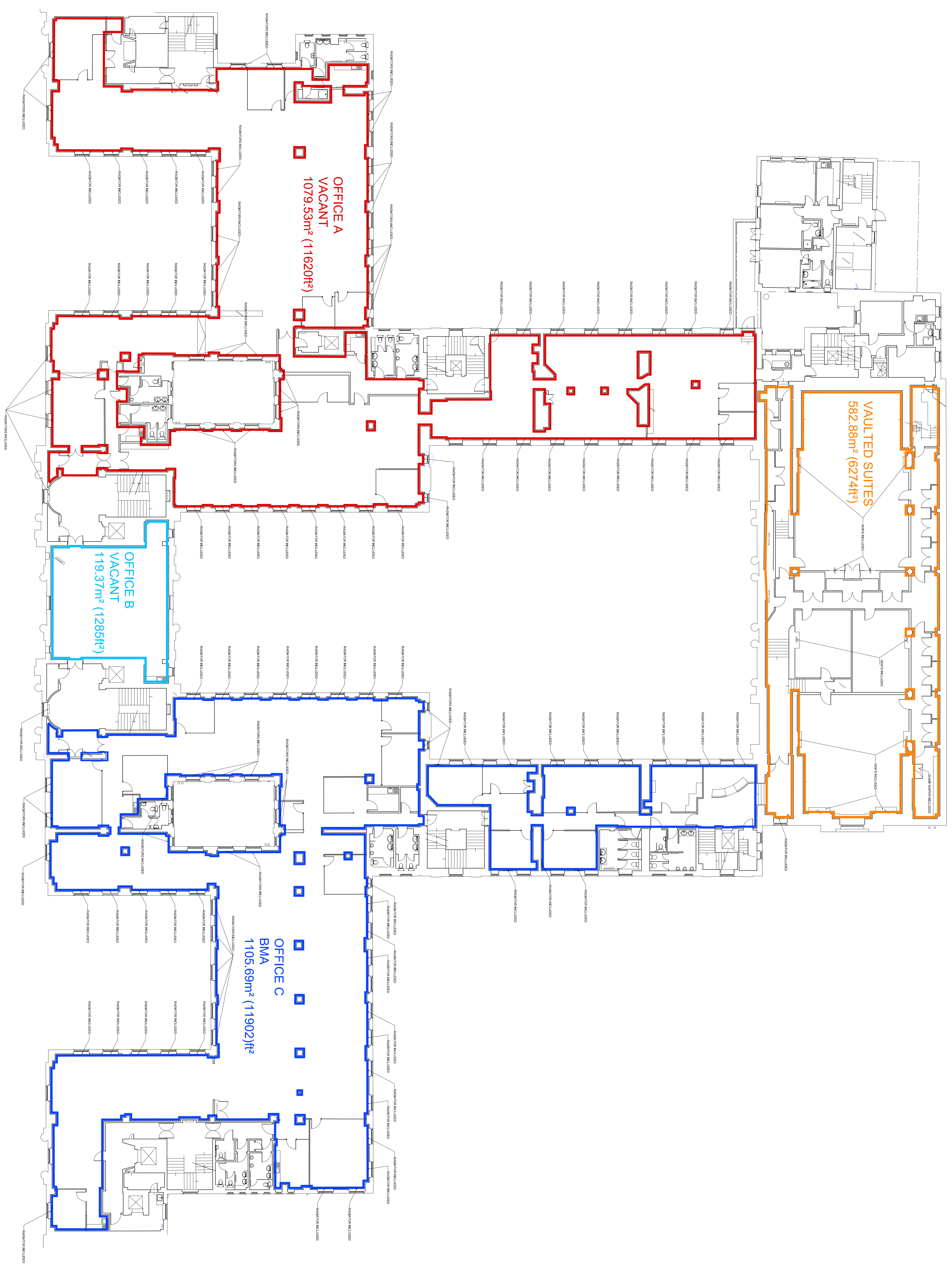

**3RD FLOOR PLAN NIA AREA
 (DRAFT)**

Daydon Griffiths & Surry
 LU1 1QS, 1 Filament Walk
 SM19 4SD

BMA

Client Name:
 British Medical Association

Project:
 British Medical Association - BMA
 20 Tavistock Square
 London
 WCH 9HW

Title:
 3RD FLOOR NIA AREA
 EXISTING SURVEY

DWG REF: BMA House - Existing Survey (632) (NIA & GSI Area) DWG
 DWG NO: 005
 SCALE: 1:150 @ A0
 DATE: NOV 2021
 DRAWN BY: D G & S
 CHECKED BY: D G & S

Tel: +44 (0)207 488 8940
 Email: info@dgandg.com
 Website: www.dgandg.com