

Consort House Ground Floor (1:100@A2)

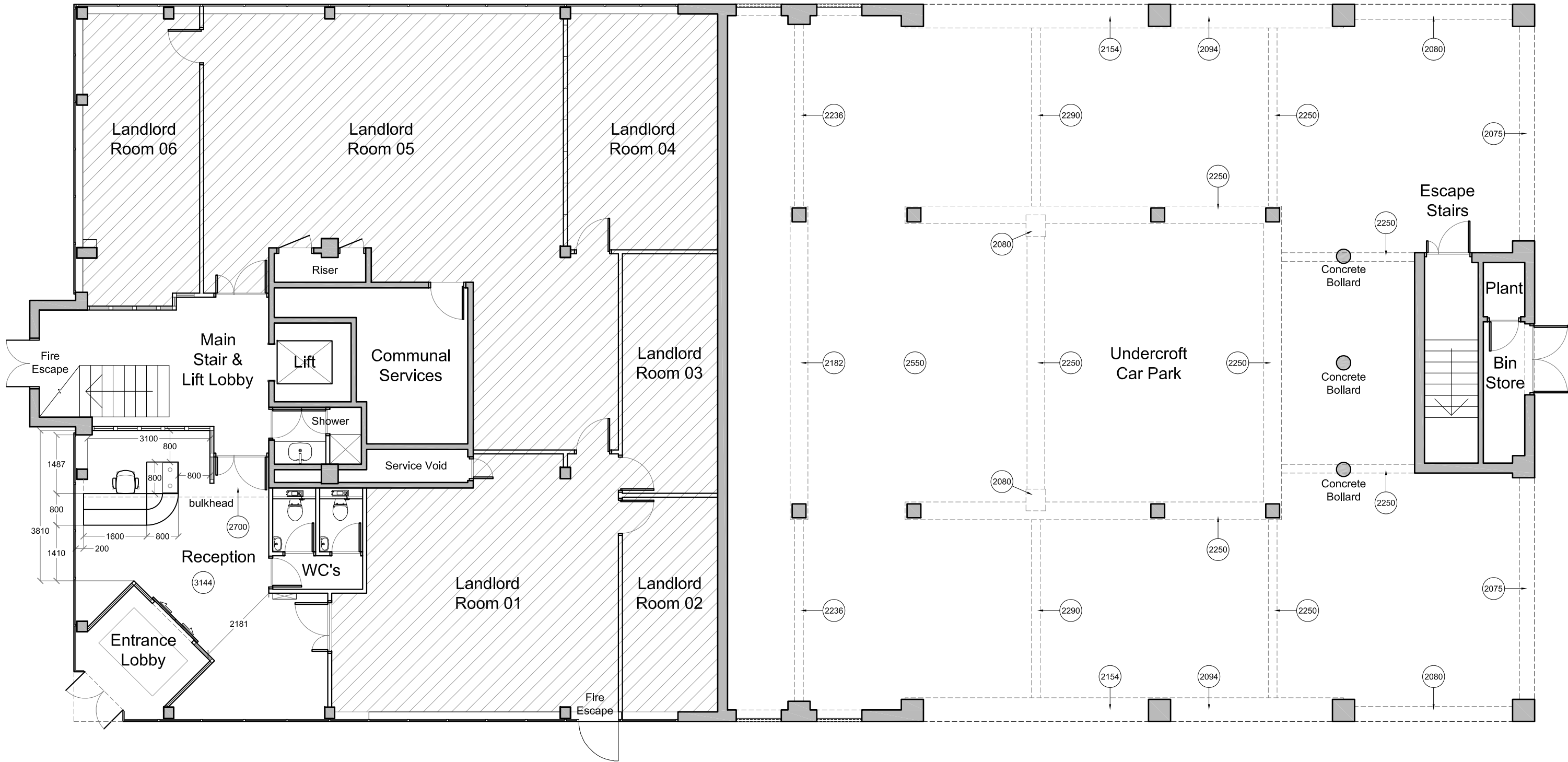

Landlords Space:

Indicates Out of Bounds Space as per Lease Agreement



**COPYRIGHT**  
copyright © this drawing may not be copied (in whole or in part), retained or disclosed without the prior written consent of the planning office limited

**SCALE**  
dimensions should be scaled with care. contractors must verify all dimensions before starting work, any discrepancies are to be reported to the planning office limited

Revisions:

★ drawing created	21.01.18
<b>A</b> layouts revised to client feedback	29.01.18
<b>B</b> layouts revised to client feedback	31.01.18
<b>C</b> pack updated with services, ground floor layout & site information. signed off GA's remain the same as Revision B.	07.02.18
<b>D</b> changes to partitions and desk layouts on both floors	03.05.18



Site Address:

Consort House  
1 Princes Road  
Weybridge, KT13 9TU

Client:

Toshiba

Project Title:

New Weybridge Office

Drawing Title:

Existing Ground Floor  
General Arrangement

★ Drawing Scale:	★ Issue Date:
1:100@A2	03.05.18

★ Drawn by:	★ Revision:
BRC	<b>D</b>

★ Drawing Number:
TPO576-06-08D

★ Drawing Number:  
**P R E L I M I N A R Y**

TPO Design + (The Planning Office Limited)  
25 Peppard Road, Sonning Common, RG49SS  
T: 07747 561 463  
E: enquiries@tpodesign.co.uk  
W: www.tpodesign.co.uk