



GPE.  
Fully Managed

[gpe.co.uk/portfolio/16-dufours-place](https://gpe.co.uk/portfolio/16-dufours-place)

# 16 Dufour's Place

A WORKPLACE CELEBRATING CREATIVITY AND CULTURE

16 Dufour's Place,  
Soho, W1F 7SP



# Contents

03	What's in your building	>
04	Why us	>
07	Working towards a better world	>
09	Availability Schedule	>
11	Floorplans	>
17	Location	>
22	Get in touch	>





# A modern, collaborative workplace that oozes Soho attitude

Set over seven storeys and alive with technology and amenities, 16 Dufour's Place is a statement workplace where your business can thrive.

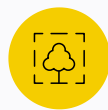

## Shared courtyard

Step outside to the communal courtyard with break-out collaboration space. It's marvellous!



## Complimentary meeting rooms

Additional tech-equipped, private spaces are bookable free of charge.



## Spacious, shared lounge

With fast Wi-Fi, great coffee and sweet treats from Luminary Bakery, you'll never drop off.



## Shower cubicles

Access to five showers to start your day feeling fresh.



## Cycle storage

19 super-secure cycle spaces for your beloved two wheeled companion.



## sesame® workplace app

The sesame app provides a host of benefits, from contactless building access to meeting room booking.



Regular social activities to support your wellbeing

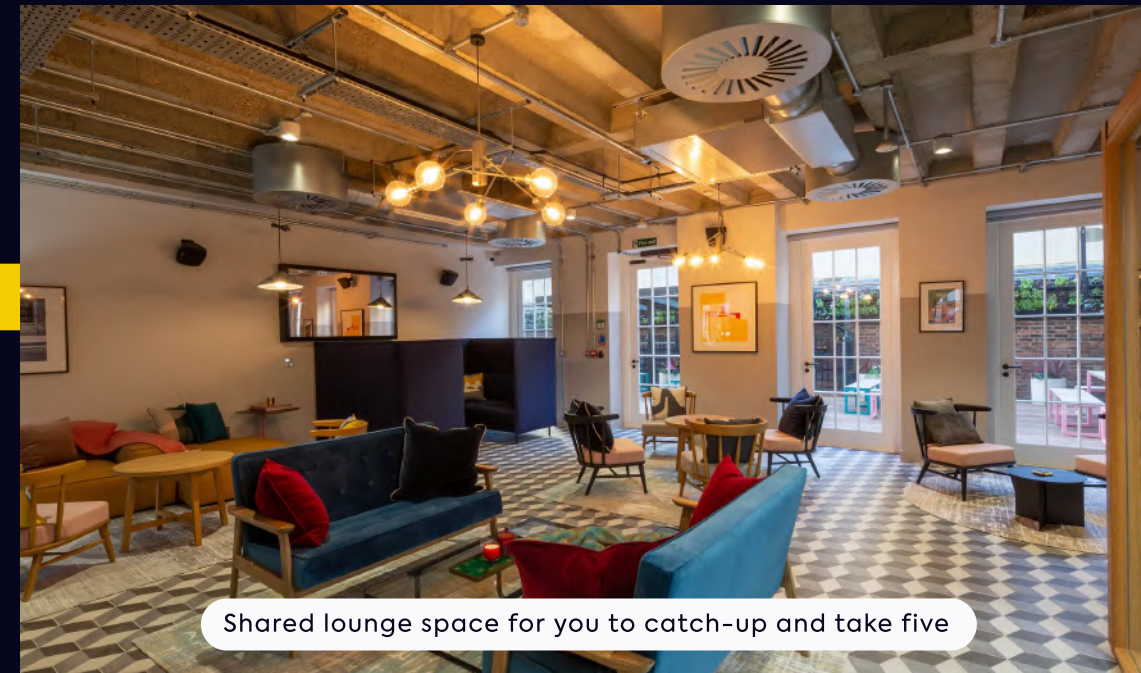

Shared lounge space for you to catch-up and take five



Shared courtyard to work, relax and socialise

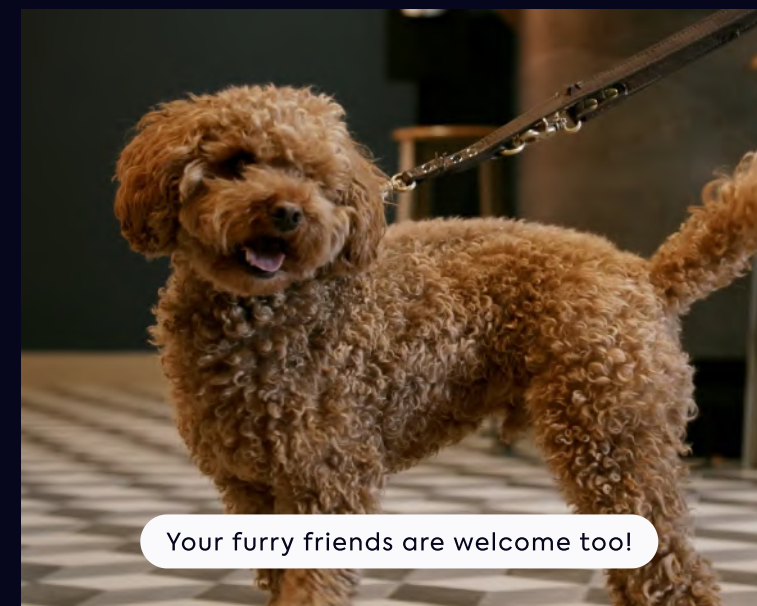

Your furry friends are welcome too!



Barista bar serving free pastries and refreshments daily!



# It's all included in one bill, no hidden extras

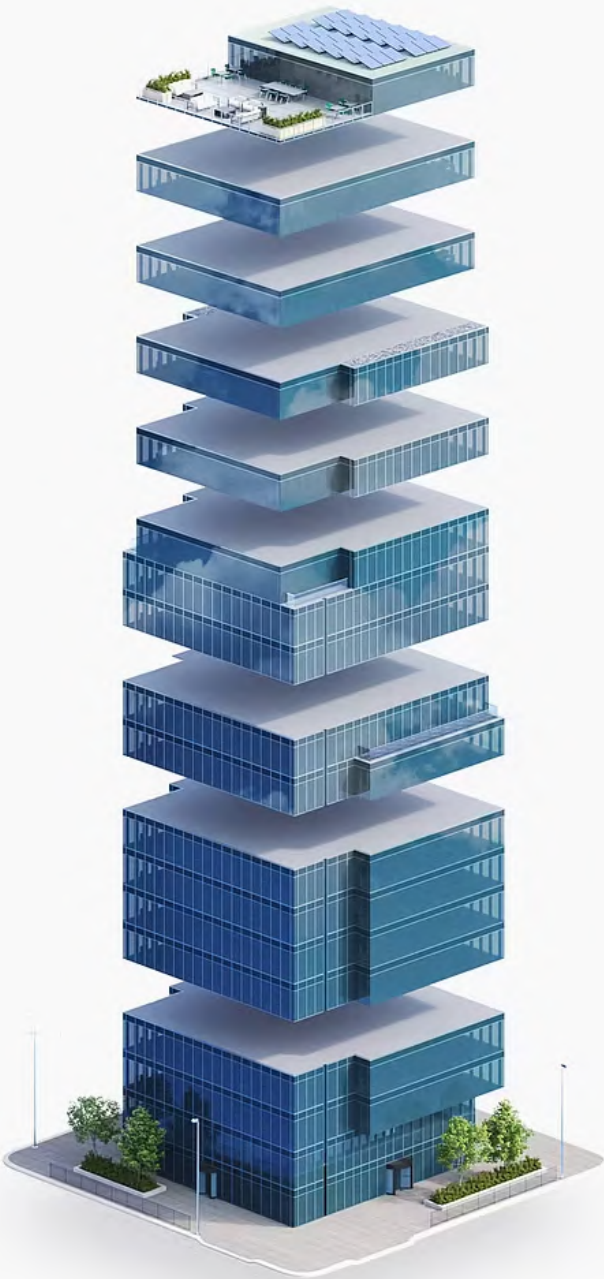

- Events, Food and Beverages
- Security
- IT Connectivity and Support
- Utilities
- Cleaning and Maintenance
- Fully Furnished Workspace
- Building Service Charge
- Business Rates
- Rent

## 6 reasons to choose GPE Fully Managed



### 1 – Fully managed and fully yours

Say hello to a furnished workspace that's exclusively yours. Our Fully Managed service is a truly hassle-free experience.

[How we make it hassle-free](#)



### 2 – All-in-one bill with no hidden extras

Say goodbye to multiple bills. Each month you'll receive one all-inclusive bill from us, and, your bill remains fixed for your contract period.

[See what's included](#)



### 3 – Relax, you're in safe hands

We've been doing this for a long time. Our in-house experts curate the perfect experience, so you can enjoy market-leading workspaces. We own and manage our buildings, so you'll always deal directly with us.

[Learn more about us](#)



### 4 – Plug in and go – your tech's all sorted

You get safe, secure and fast wireless connectivity so you can work seamlessly from day one, with IT help on-hand. Everyone gets access to sesame™, your workspace app.

[Head over to the tech](#)



### 5 – Working towards a better world

We're committed to becoming a net zero carbon business by 2040, sourcing 100% renewable energy and maximising material reuse. We'll also work with you to reduce your carbon footprint, creating sustainable spaces where your business can thrive.

[How we're reducing our impact](#)



### 6 – Exceptional service as standard

Your people are our priority. It's why we've developed our customer charter – the values by which we operate – so we can deliver you a great experience.

[Learn more about our services](#)



# Exceptional service as standard



## Everything taken care of

Our welcoming customer management team will ensure a hassle-free experience for you and your employees. Let our team take care of everything so you can focus on running your business.



Building management



Community management



Statutory compliance



Food & Beverage



24/7 Helpdesk



Health & safety



Maintenance



Access & visitor management



Events

## Purposeful partnerships

We're passionate about working closely with our thriving local communities, supporting local businesses and social enterprises. By choosing a Fully Managed workspace, you help these fantastic businesses every day.







View full  
building  
video



Contents

16 Dufour's Place





# Working towards a better world



During the fit out of 16 Dufour's Place we...



Diverted 97% of waste from landfill.



Procured all fittings and finishing through environmental product declarations (EPD's).



Achieved SKA Gold for our sustainable fit out.



Installed efficient zoned lighting and temperature control systems.



Used 100% sustainable timber.



Created breakout areas on every floor, to provide a rest area for staff wellbeing.

At GPE, we are:



**Integrating climate resilience across our business.**

- Creating more green space.
- Creating adaptable, future-proof buildings.



**Putting health and wellbeing front and centre.**

- Fitwell/WELL enabled buildings and air quality monitoring.
- Creating inclusive spaces and running wellbeing events.



**Decarbonising our business to become net zero by 2030.**

- Using 100% renewable energy.
- Low carbon by design, including using preloved materials and furniture.



**Creating a lasting positive social impact in our communities.**

- Supporting social enterprises and charities.
- Supporting local employment and apprenticeships.





# Our events and wellness programme

Our workplaces are more than just offices—they're vibrant communities that foster genuine connections.

Your Customer Experience Manager will help keep your team happy and engaged with a thoughtfully curated programme of wellbeing initiatives and events throughout the year.

From wellness sessions to networking opportunities, seasonal celebrations, charitable fundraisers and educational workshops, we create experiences that bring people together and make the workplace an inspiring and happy place to be.



Networking events



Fitness classes, yoga & pilates



Creative workshops



Seasonal pop-ups



Screening of sporting events



Charitable fundraisers

Contents

16 Dufour's Place

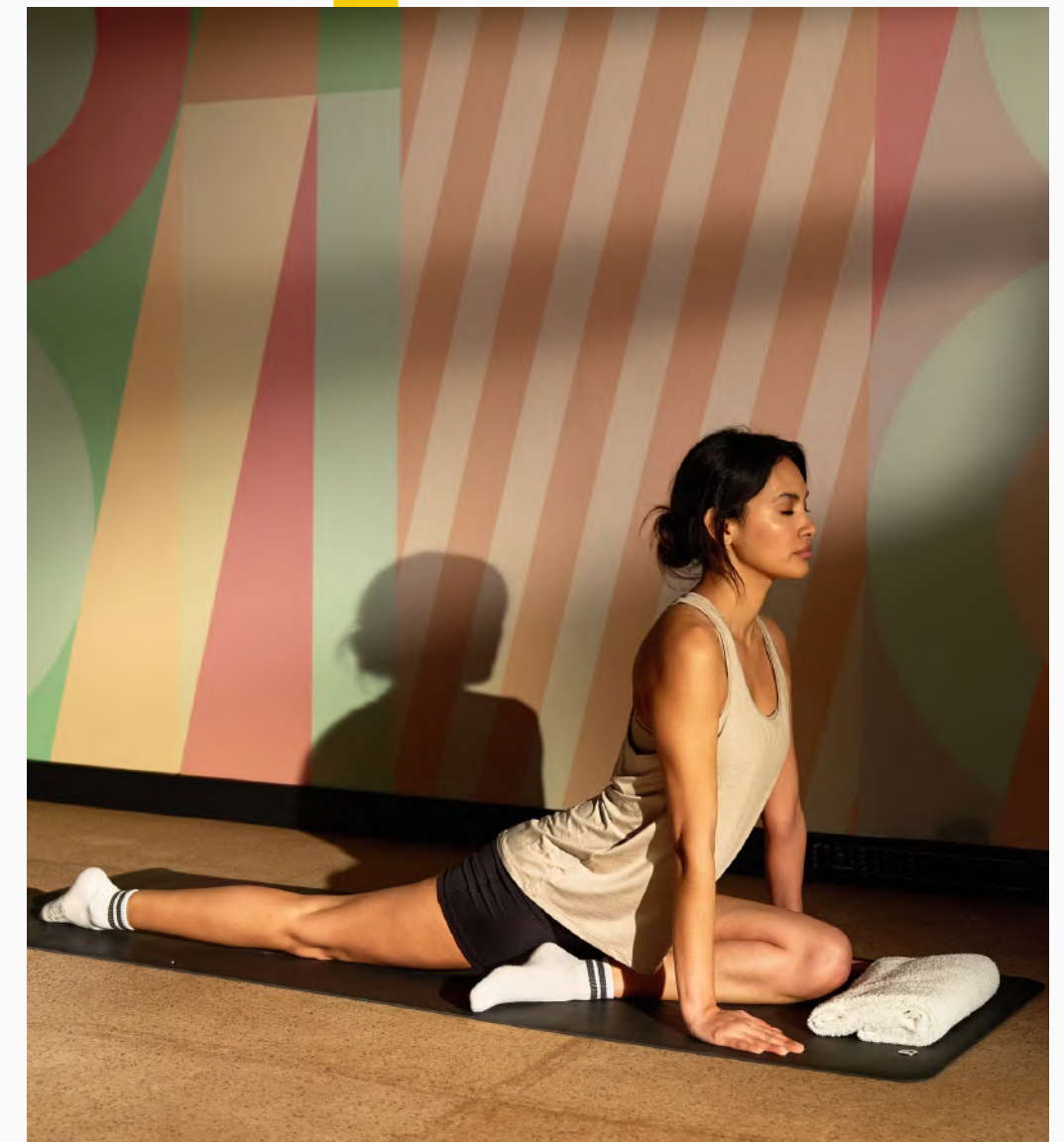





\*Event programme is subject to change and will vary by building.



# Availability schedule

Let’s get down to the details...







The details

Floor	Configuration	Max occupancy	Sq ft	Floorplan	Key features	Availability
6th Floor, 16 Dufour's Place	20 desks, 1 meeting room + breakout spaces	27	1,595		Breakout areas, large meeting room and 3 phone booths with a spacious kitchen.	<div><div></div>Available now</div>
5th Floor, 16 Dufour's Place	24 desks, 2 meeting rooms + breakout spaces	28	2,010		Vibrant, community-focused space with ample breakout areas, meeting rooms and biophilia throughout	<div><div></div>Available now</div>
3rd Floor, 16 Dufour's Place	40 desks, 2 meeting rooms + breakout spaces	56	3,134		Spacious breakout areas, welcome lounge, quiet zone & meeting rooms crafted for collaboration.	<div><div></div>Available now</div>
2nd Floor, 16 Dufour's Place	32 desks, 5 meeting rooms + breakout spaces	56	3,143		Multiple meeting rooms, welcome lounge and spacious breakout areas.	<div><div></div>Available now</div>

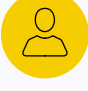

# Floorplan

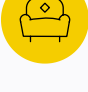
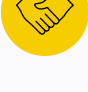
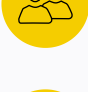
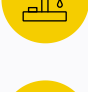
## 2nd floor, 16 Dufour's Place

-  Soho
-  3,143 sq ft
-  56 maximum occupancy
-  32 current desks
-  5 meeting rooms
-  2 breakout areas
-  Welcome lounge
-  2 person pod
-  Kitchen
-  Coffee machine

[View/download 2D floorplan](#)

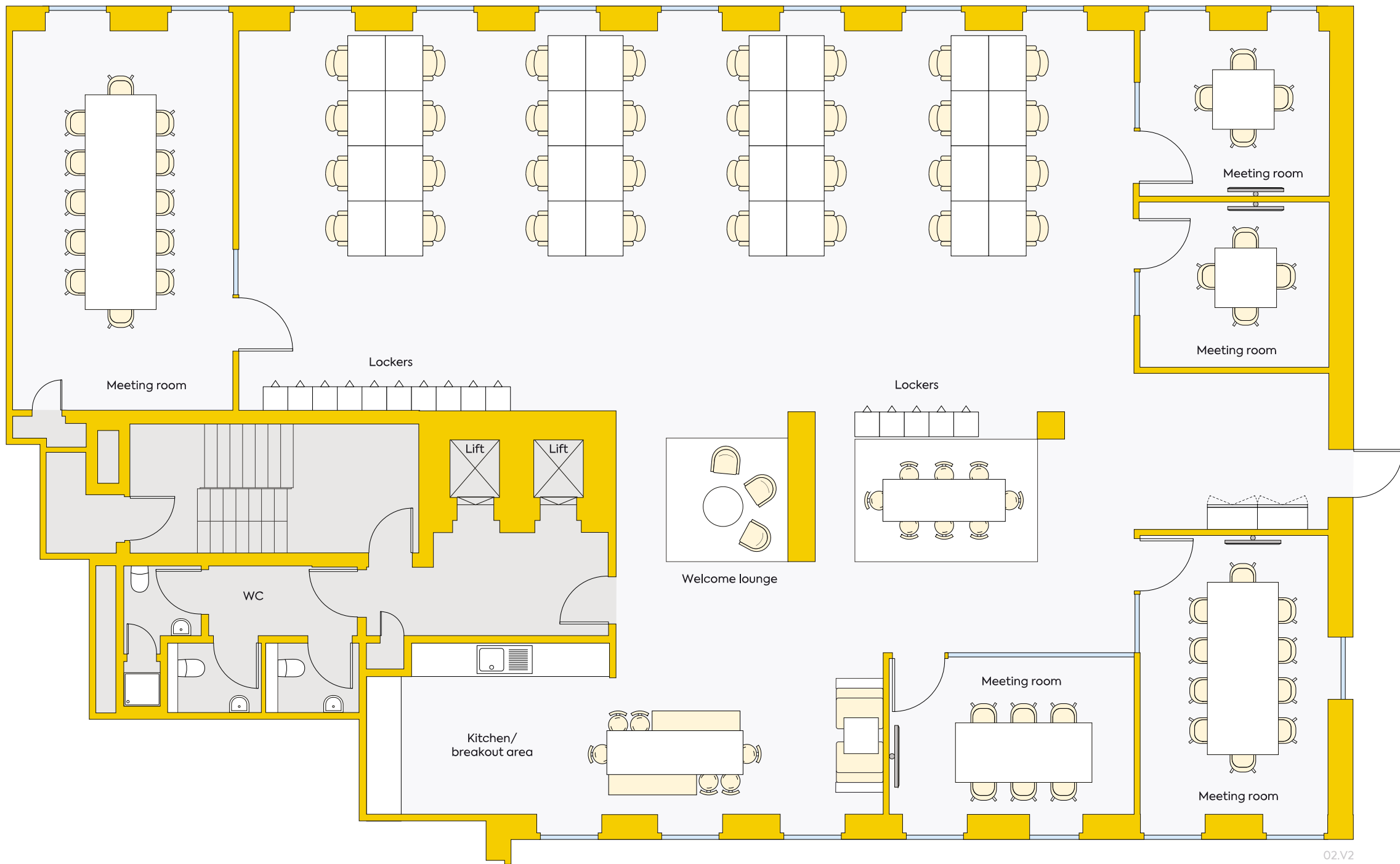









02.V2

\*This floorplans colour scheme and furnishings are for illustrative purposes only.

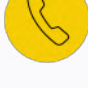

# Floorplan

## 3rd floor, 16 Dufour's Place

-  Soho
-  3,134 sq ft
-  56 maximum occupancy
-  40 current desks
-  Private office
-  2 meeting rooms
-  Welcome lounge
-  2 phone booths
-  Kitchen

[View/download 2D floorplan](#)

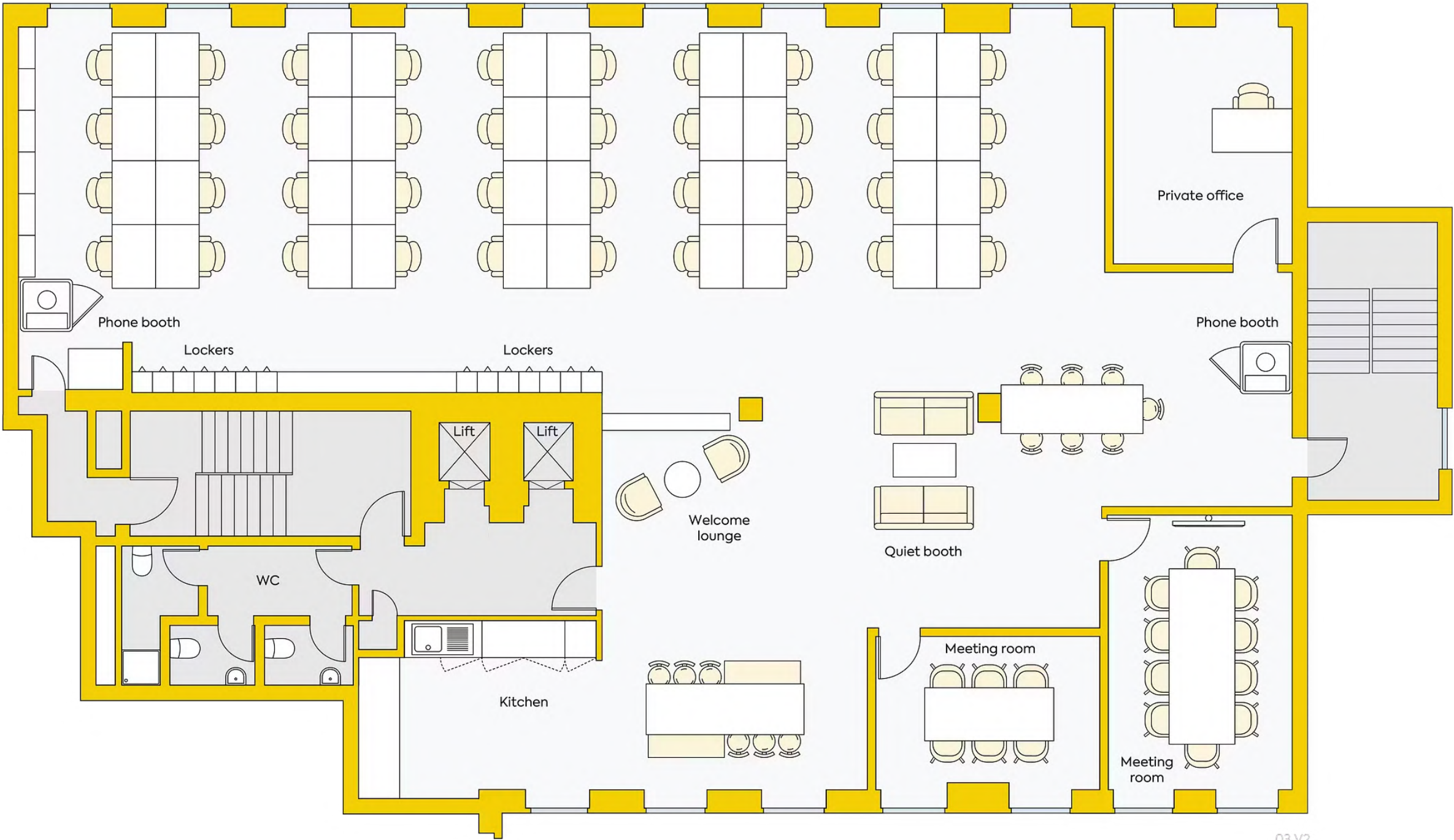

03.V2

\*This floorplans colour scheme and furnishings are for illustrative purposes only.





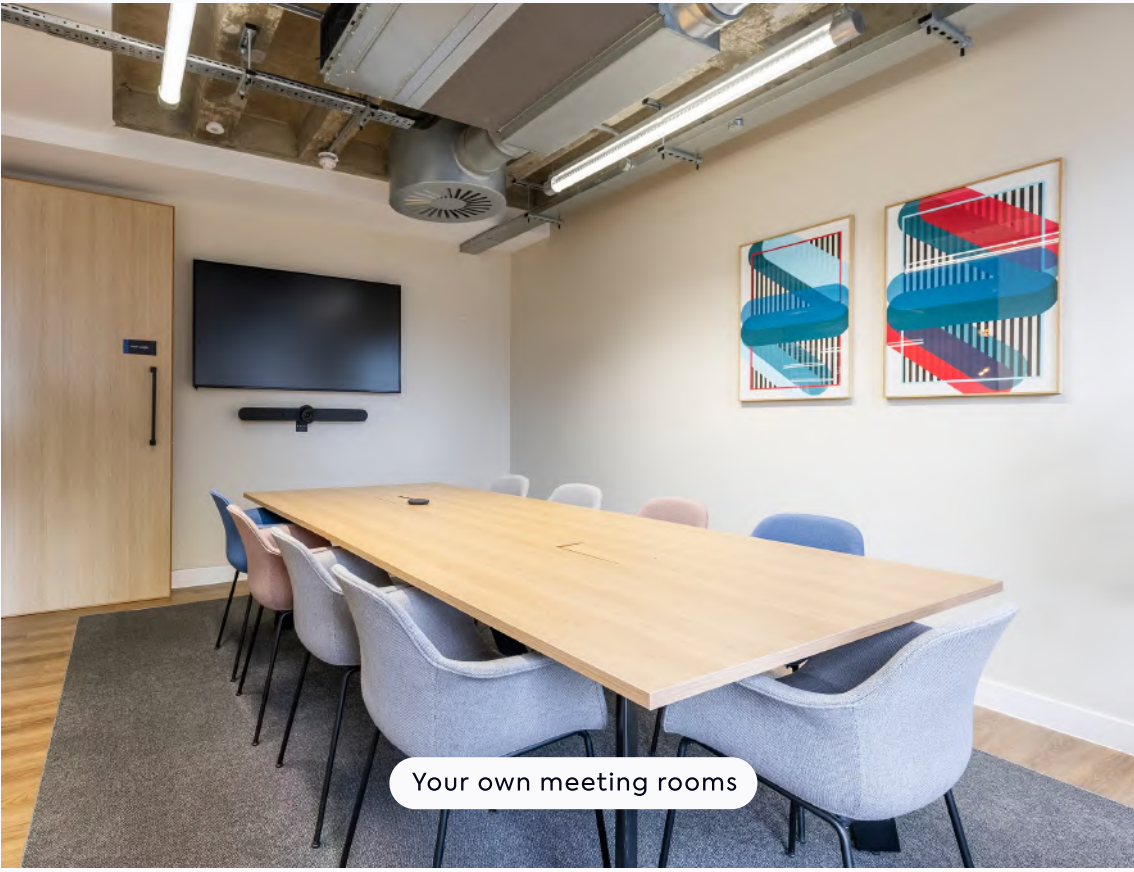
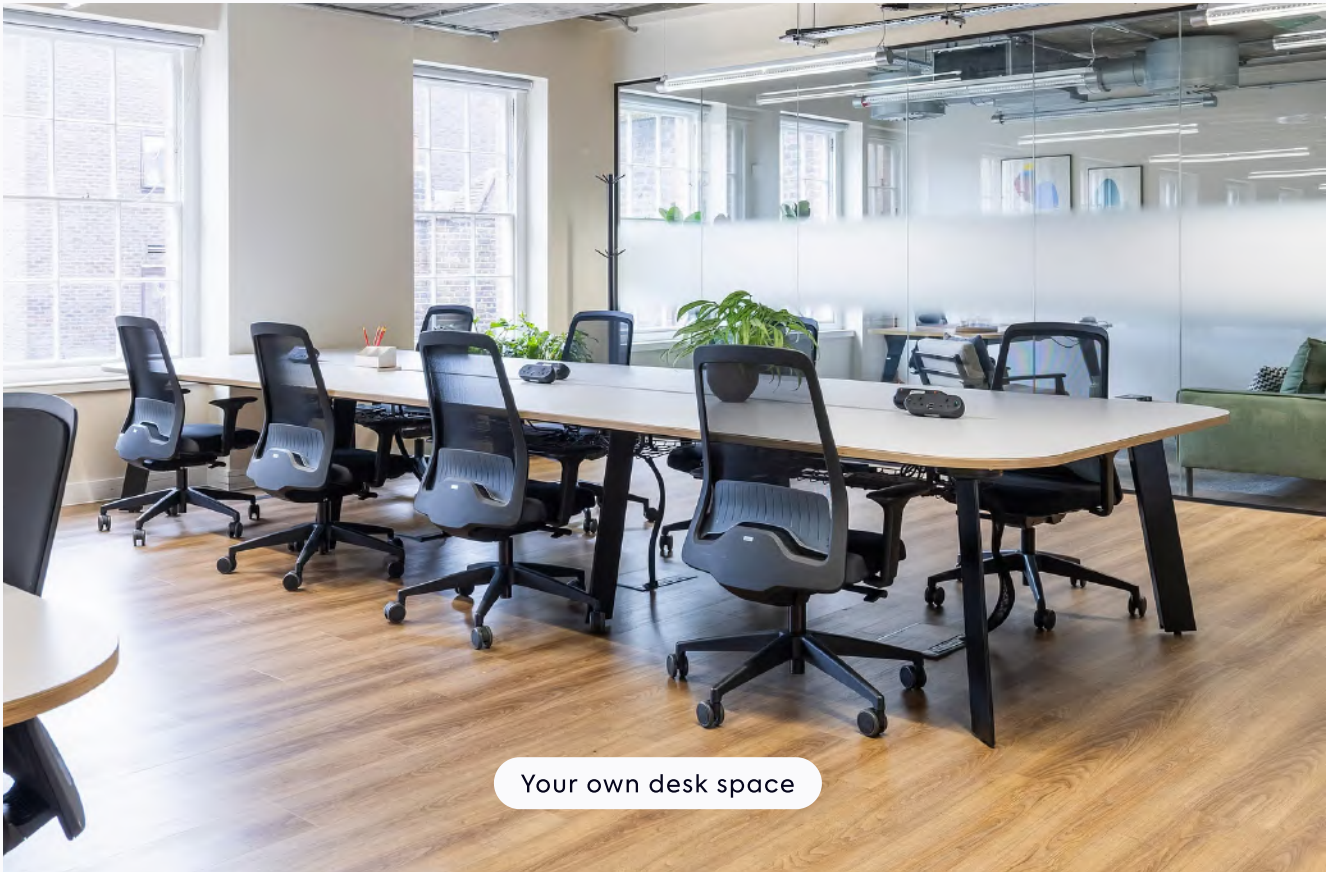
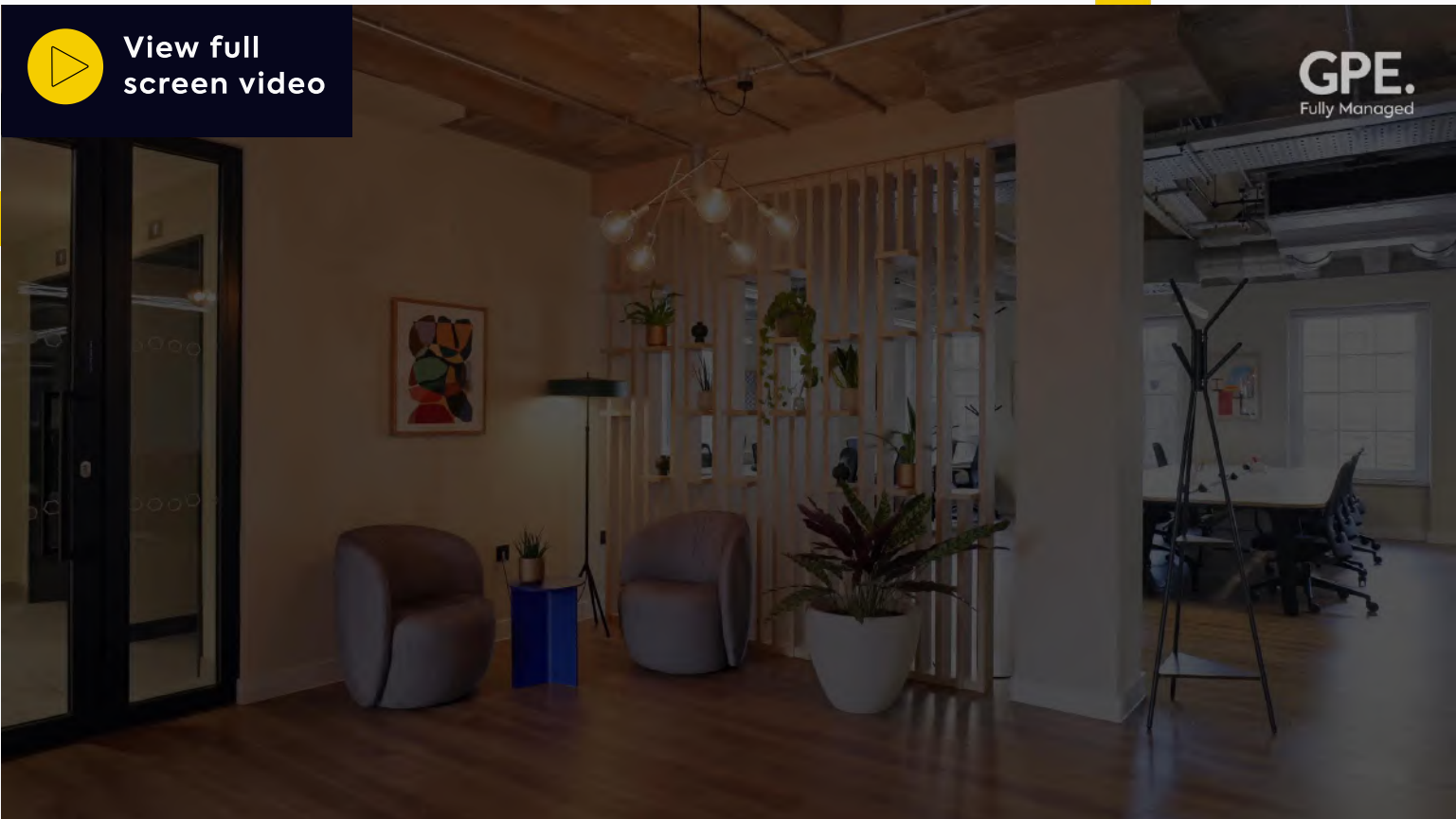
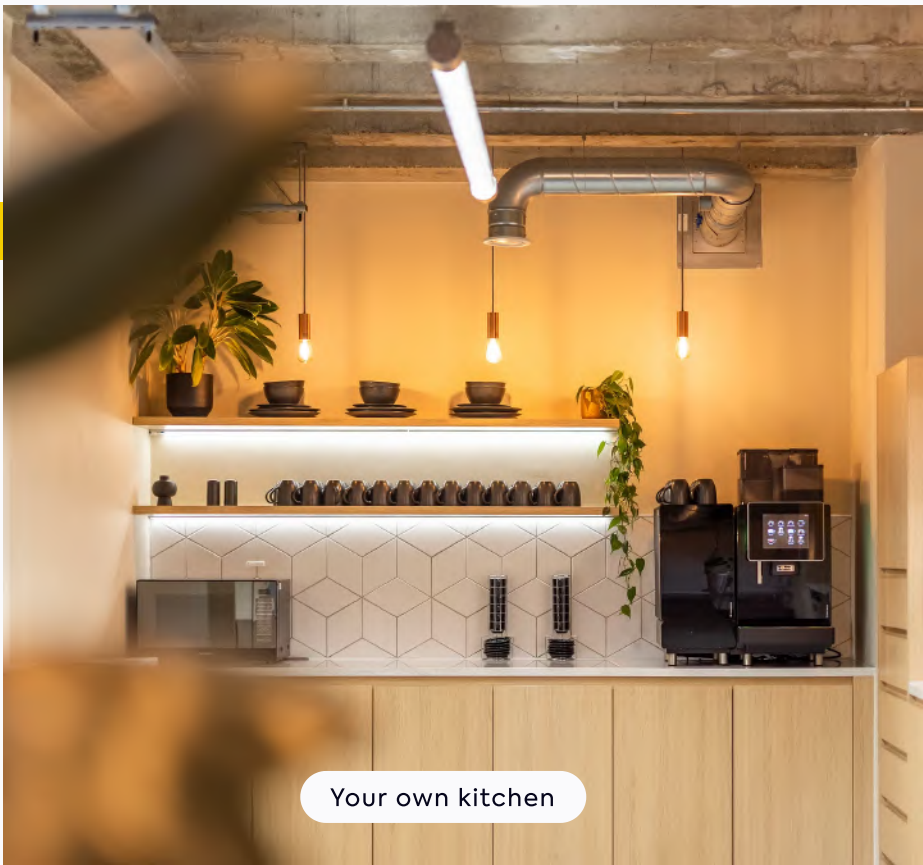



# 3rd Floor



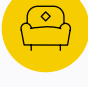
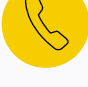
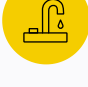

# Floorplan

## 5th floor, 16 Dufour's Place

-  Soho
-  2,010 sq ft
-  28 maximum occupancy
-  28 current desks
-  2 meeting rooms
-  Breakout area
-  2 phone booths
-  Kitchen
-  Coffee machine

[View/download 2D floorplan](#)

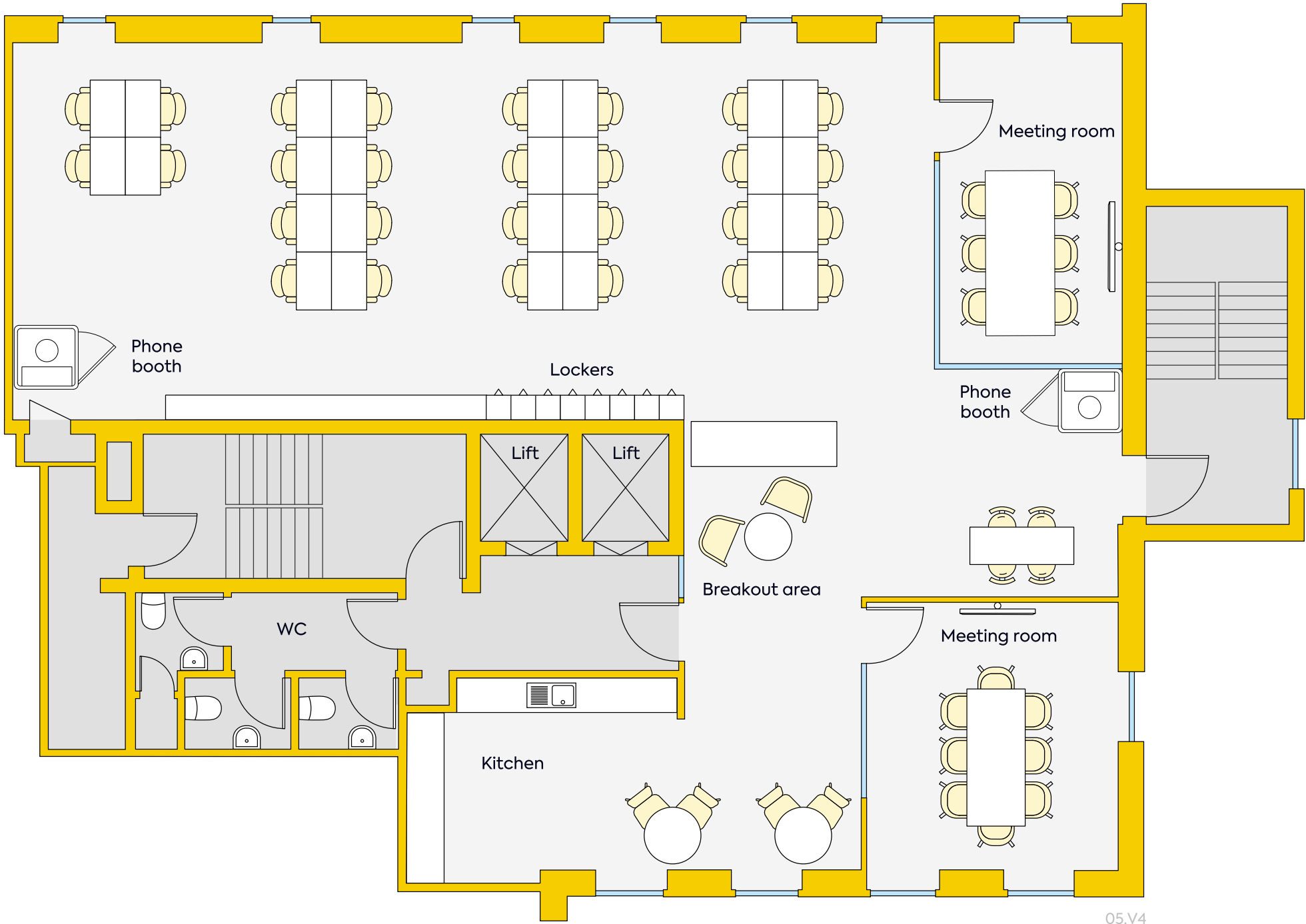

\*This floorplans colour scheme and furnishings are for illustrative purposes only.





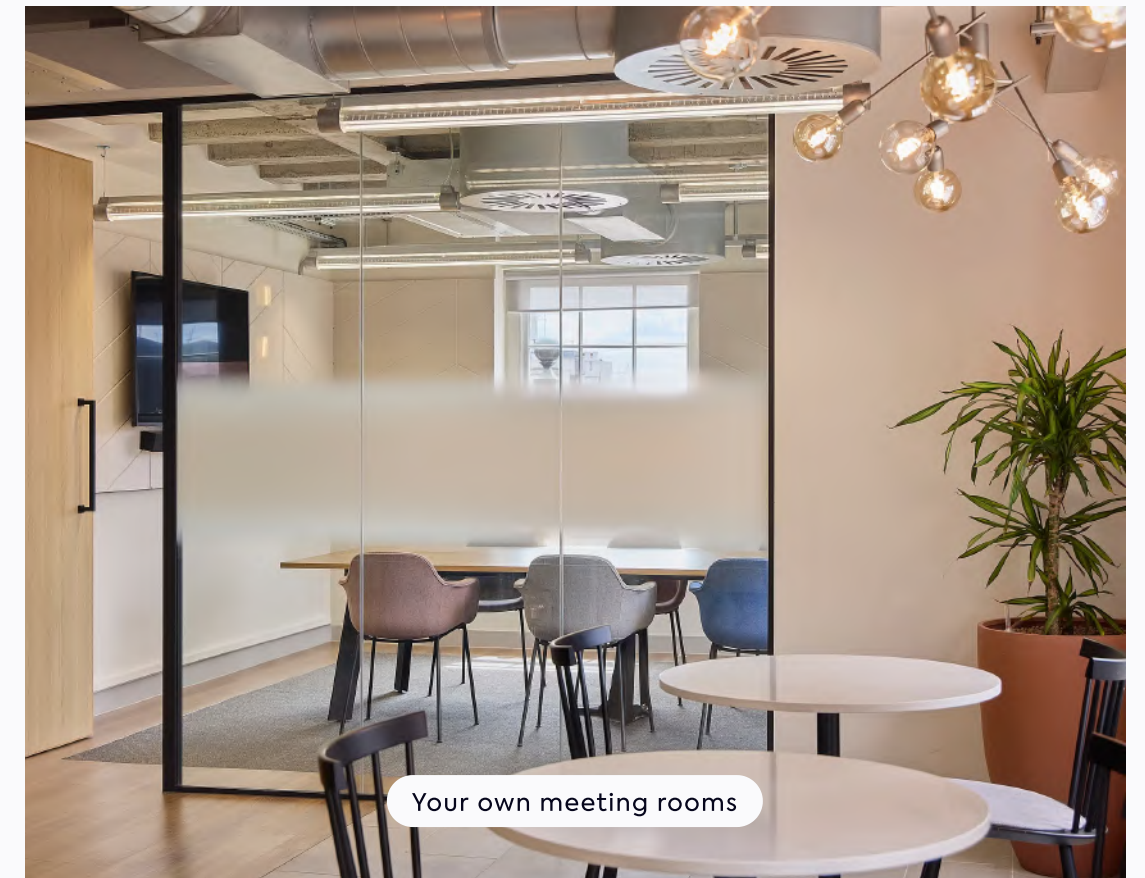
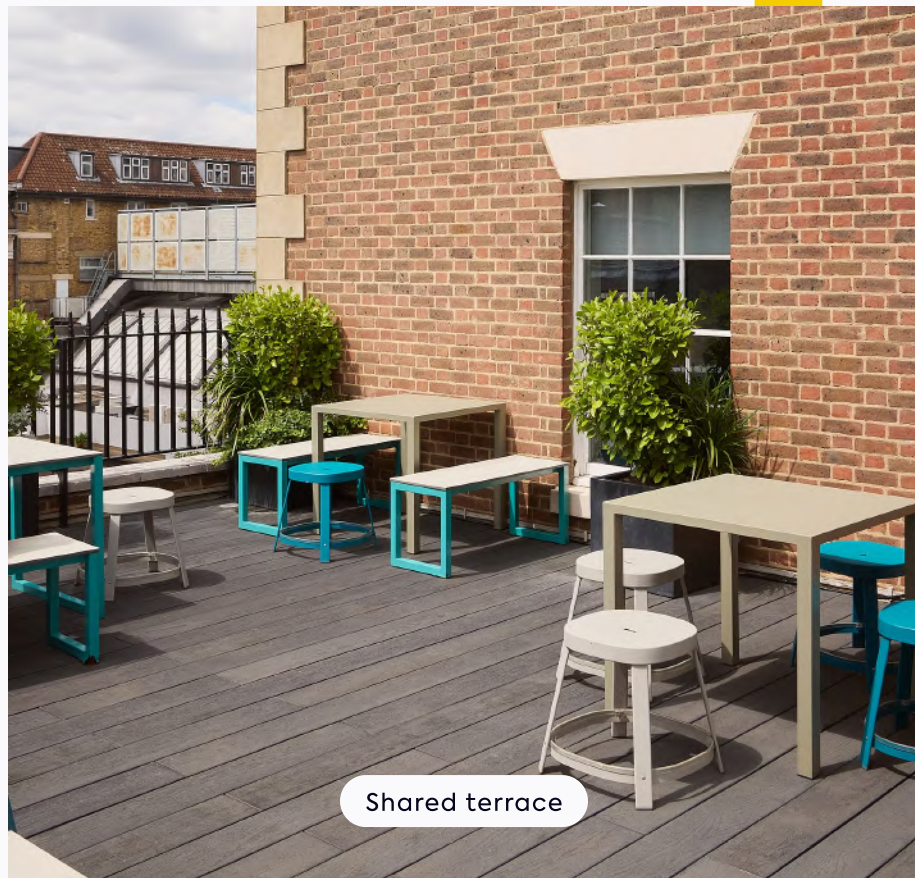
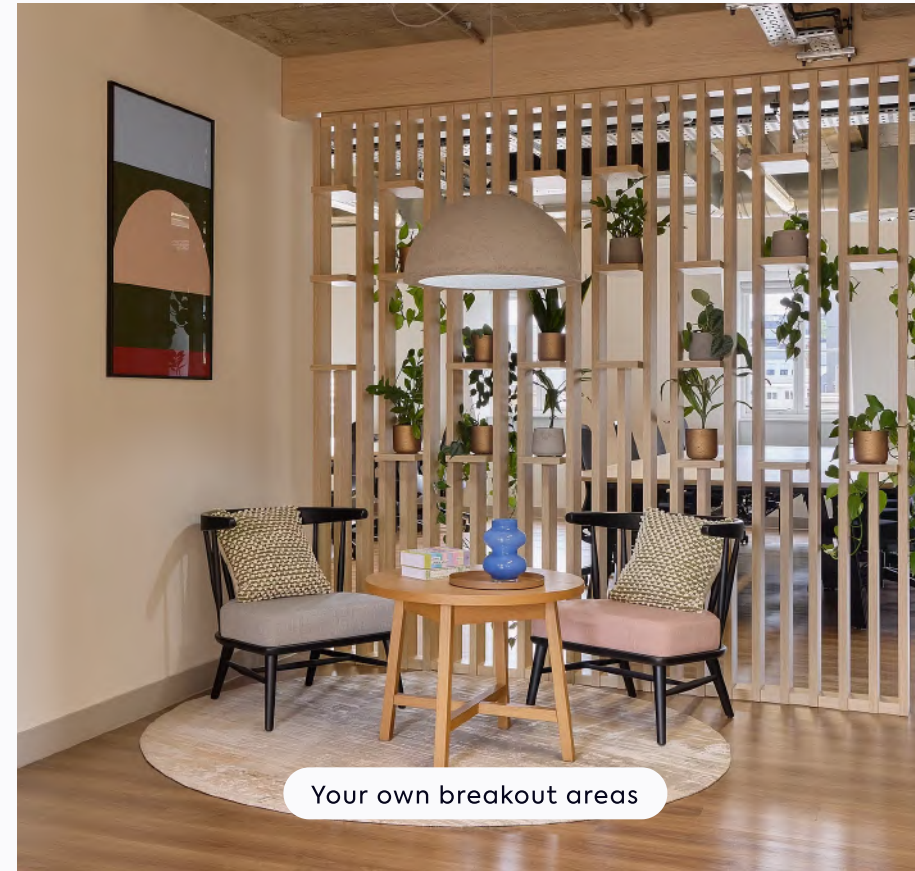
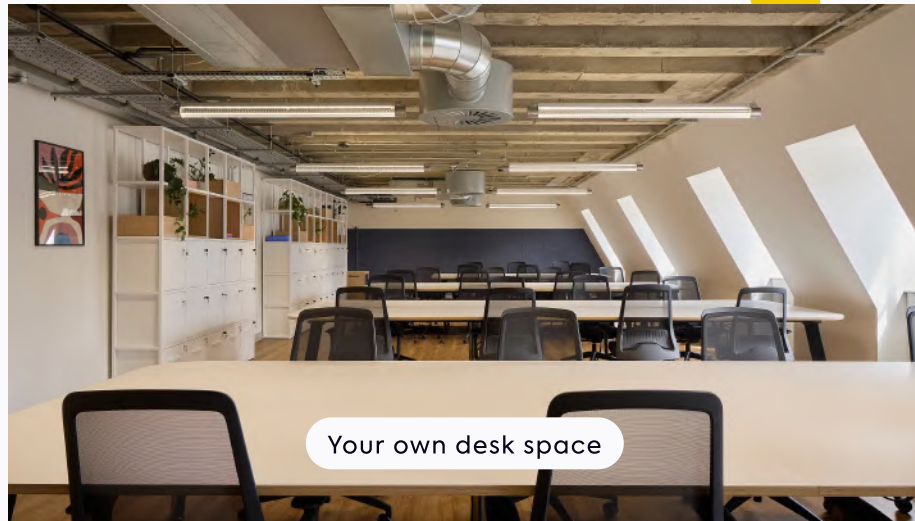



# 5th Floor



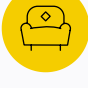
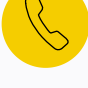

# Floorplan

6th floor, 16 Dufour's Place

-  Soho
-  1,595 sq ft
-  27 maximum occupancy
-  20 current desks
-  Meeting room
-  Breakout area
-  3 phone booths
-  Kitchen
-  Coffee machine

[View/download 2D floorplan](#)

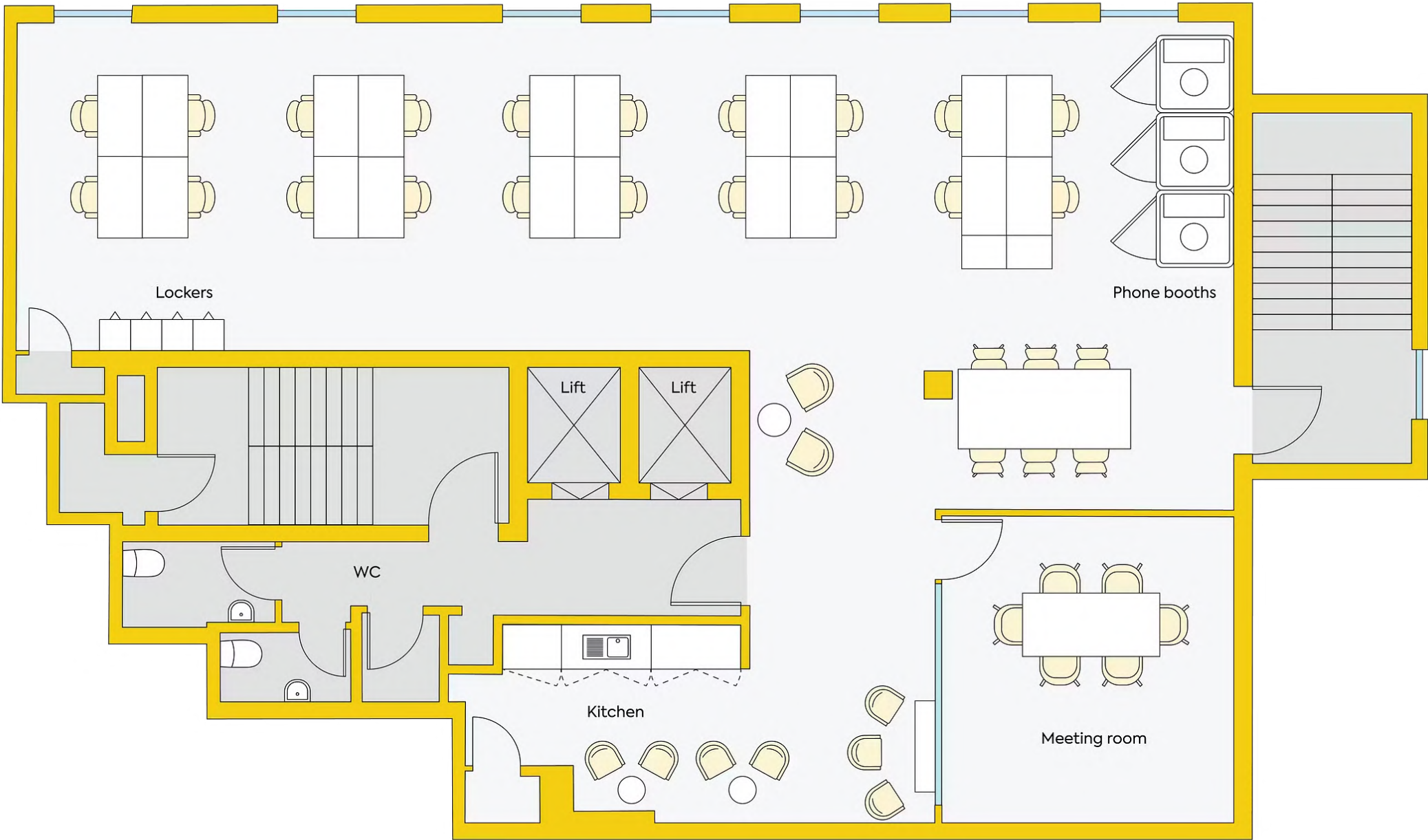

06.V3

\*This floorplans colour scheme and furnishings are for illustrative purposes only.



# 6th Floor

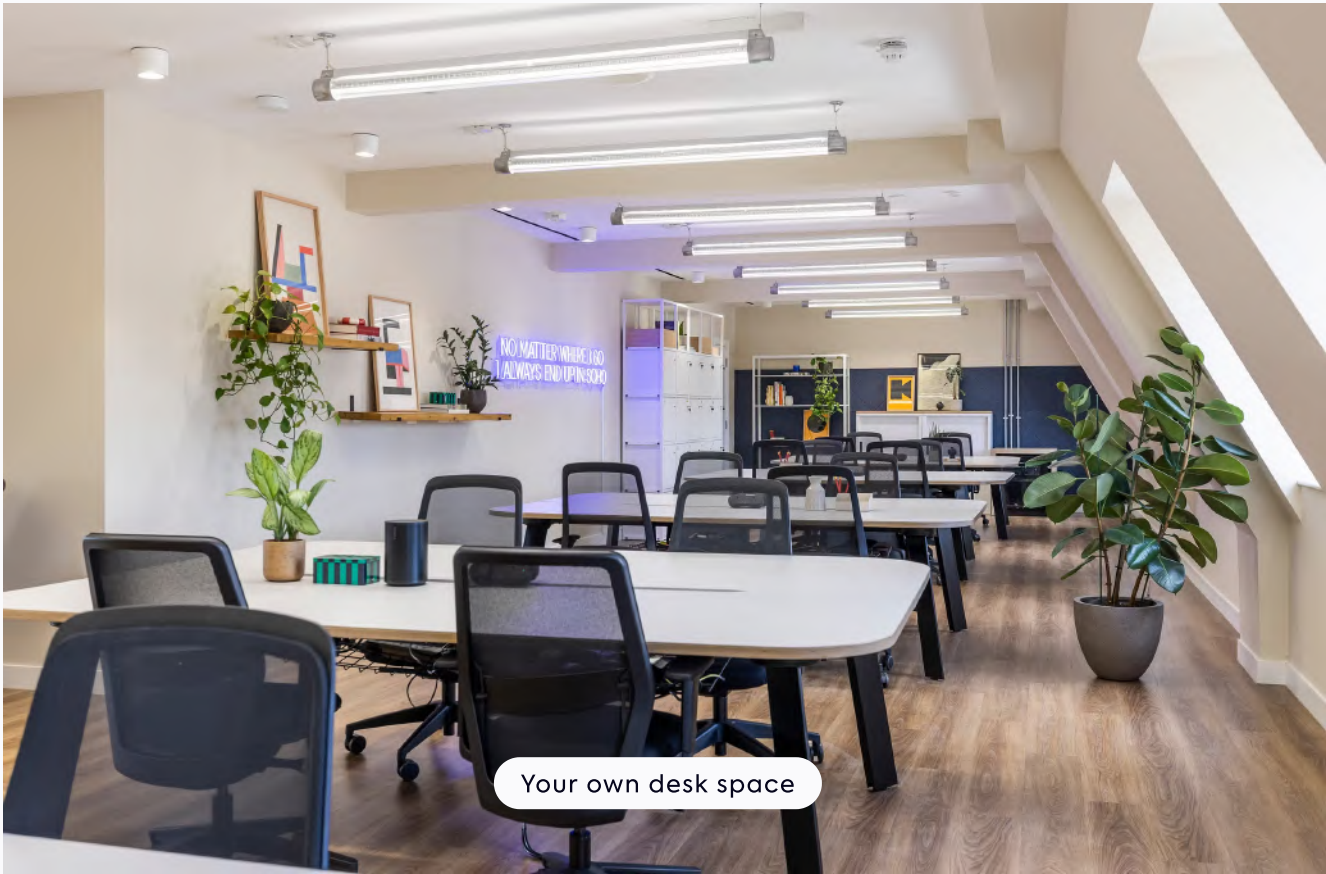
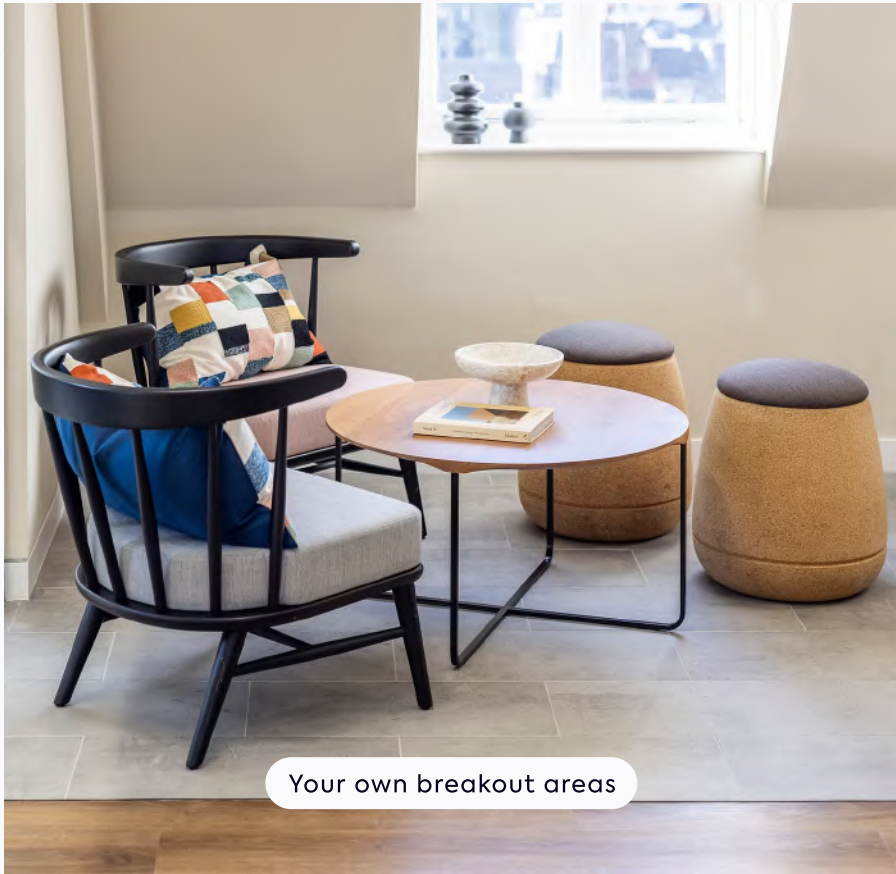
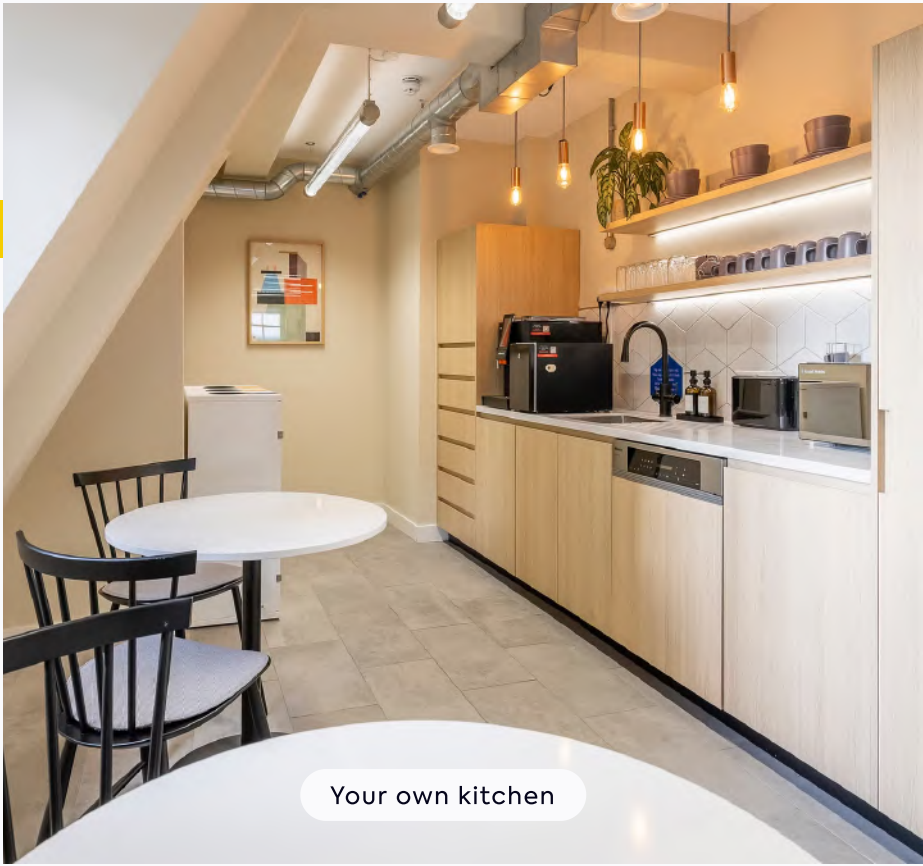
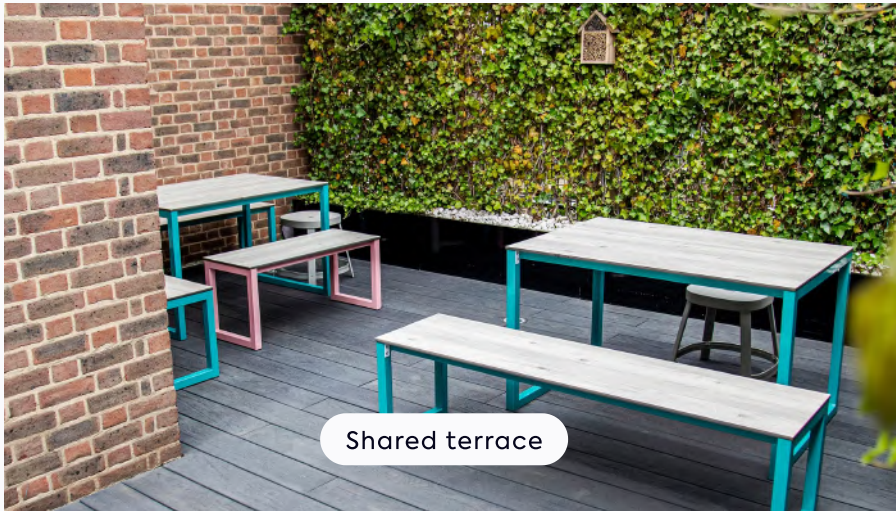



# Truly Connected

Nestled in the heart of London, 16 Dufour's Place benefits from excellent public transport links, including Tottenham Court Road and Oxford Circus, which are within walking distance and grant access to multiple lines for seamless travel across London.

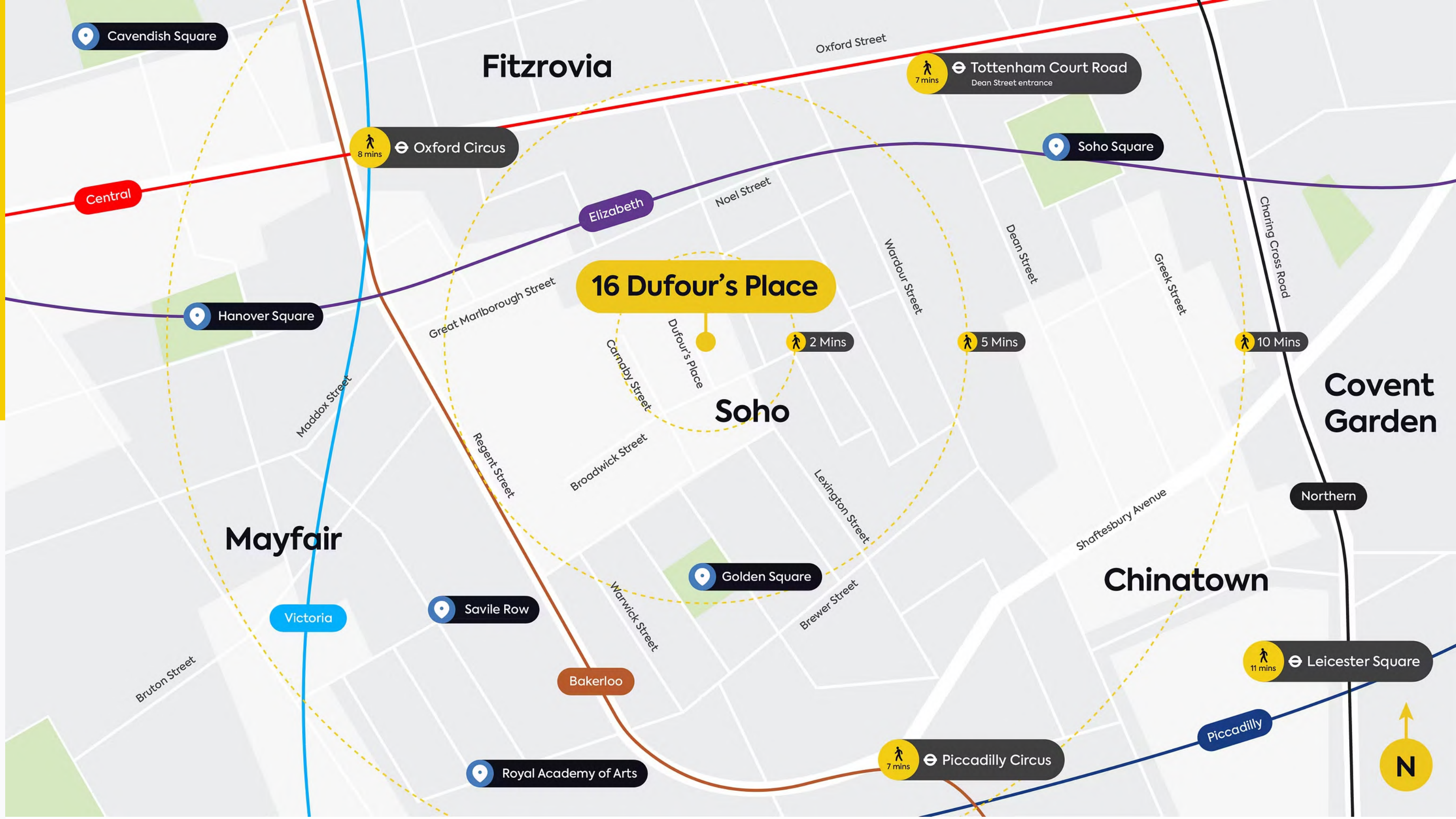

 **Walking Distance**

**Tottenham Court Road**  
7 mins  
   

**Piccadilly Circus**  
7 mins  
  

**Oxford Circus**  
8 mins  
   

**Leicester Square**  
11 mins  
  





Dean Street



Berwick Street



Soho Square



Old Compton Brasserie



Manette Street



The French House



# Tried and tasted

Within

# 10

minutes



## Highlights

- 1 The Life Goddess
- 2 Sucre
- 3 Antidote Wine Bar
- 4 Italian Bear Chocolate
- 5 Bao
- 6 Quo Vadis
- 7 The French House
- 8 Simmons Bar
- 9 Bar Italia
- 10 Cafe Boheme



## Our pick

**7. The French House**  
An iconic watering hole with a no tech rule. Ideal for a quick break from your screen.



# Good food



Soho has an abundance of diverse dining options that cater for every palate, from authentic Greek at The Life Goddess, to Asian inspired street food at Bao. As the sun sets, Soho's vibrant nightlife comes alive with plenty of places to go for after work cocktails.



# Spoilt for choice

Within

10

minutes



## Highlights

- 1 Boom Battle Bar
- 2 Outernet
- 3 Soho Square
- 4 Liberty London
- 5 Sounds of the Universe
- 6 Wizard Exploratorium
- 7 Ronnie Scott's
- 8 Golden Square
- 9 Soholistic Spa
- 10 The Crystal Maze



## Our pick

**7. Ronnie Scott's**  
A basement jazz club with an old school vibe. There's nowhere else quite like it.



# Things to do



Soho has a range of experiences, from iconic theatres to eclectic boutiques and art galleries. You can even try your hand at The Crystal Maze experience and see who in your team has what it takes in The Crystal Dome.

Food & Drink

Things to do

Hidden Gems



# On your doorstep

Within

# 10

minutes



## Highlights

- 1 The Photographer's Gallery
- 2 Cahoots
- 3 Berwick Street Market
- 4 The Vault at Milroy's of Soho
- 5 Curzon Soho



## Our pick

### 5. Curzon Soho

An independent cinema with an atmosphere, comfort and a bar – what's not to like!



# Hidden Gems



There's lots waiting to be discovered in Soho. Bustling street markets, art galleries and independent cinemas. Take a peek at some lesser known cocktail bars – one hidden away behind a bookcase and the other in an abandoned train station!

Food & Drink

Things to do

Hidden Gems



# Get in touch

We hope we've piqued your interest, but it's only just the beginning.  
We'd love to show you more. Get in touch to book your viewing today.



**Molly Maguire**

+44 (0) 7887 841 816  
molly.maguire@gpe.co.uk



**David Korman**

+44 (0) 7435 939 956  
david.korman@gpe.co.uk



**Anna Tweed**

+44 (0) 7990 633 486  
anna.tweed@gpe.co.uk

Talk to us



**Find a space that's fully  
yours. More locations  
across London.**

See availability

All CGIs are for indicative purposes only. Misrepresentation ACT 1967: Whilst all the information in these particulars is believed to be correct, agent nor GPE (Dufour's Place) Ltd guarantee its accuracy nor is it intended to form any part of any contract. All areas quoted are approximate.