

SECTION A

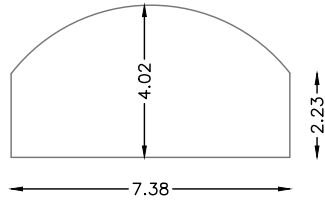

SECTION B

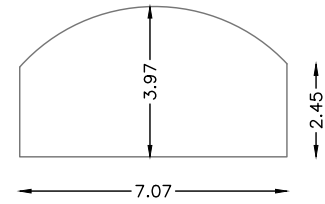

Property Ref: VXH01900

Arches Between Wandsworth Road,
LONDON, SW8 1SQ



Rental Space Ref: VXH01926

Arch 29 Miles Street, LONDON, SW8

Net Internal Area

NIA 230.02 sq m 2476 sq ft

Gross Internal Area

GIA 230.02 sq m 2476 sq ft

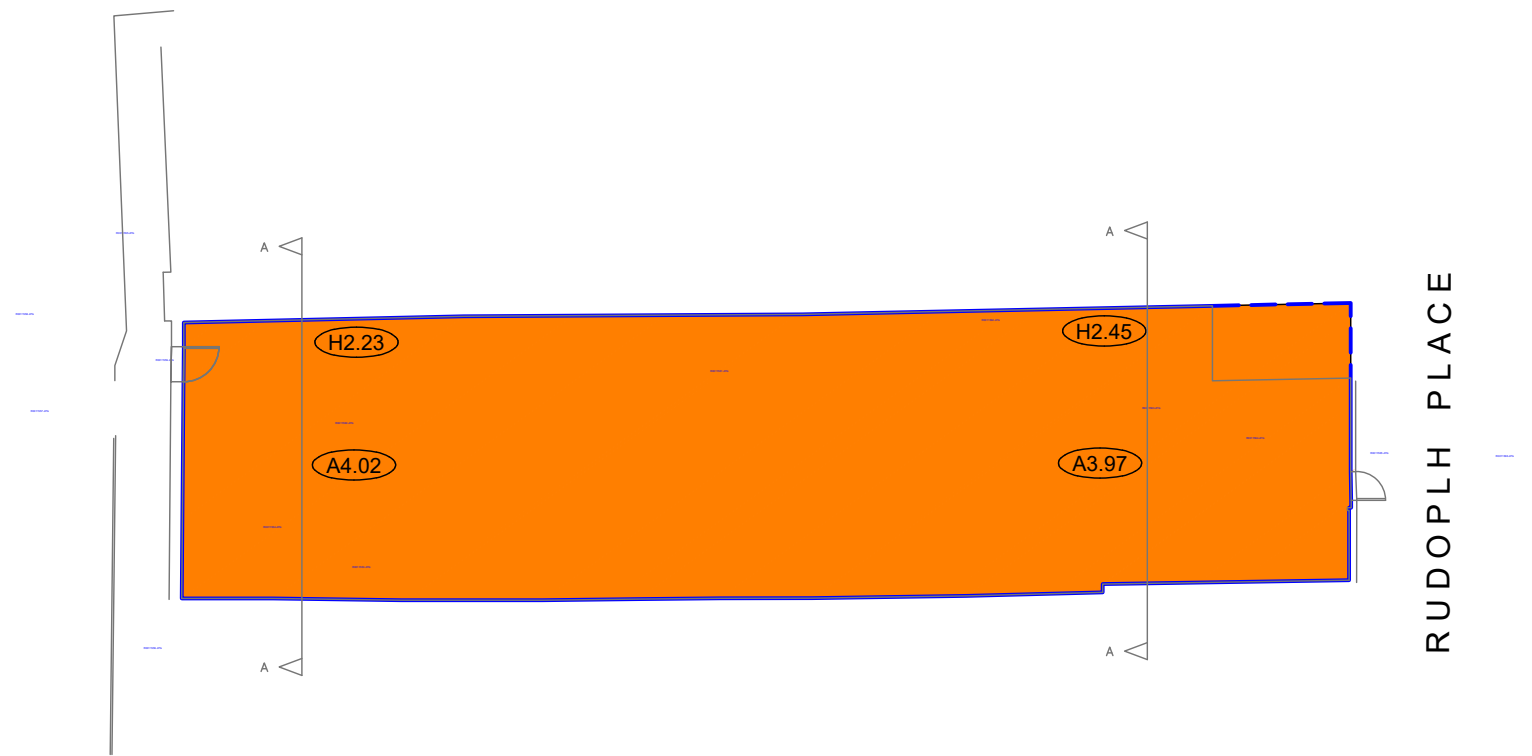
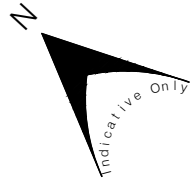

MILES STREET

RUDOPH PLACE

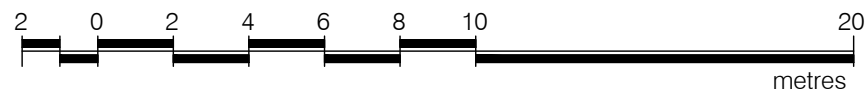

Presentation Scale 1:200 @ A3

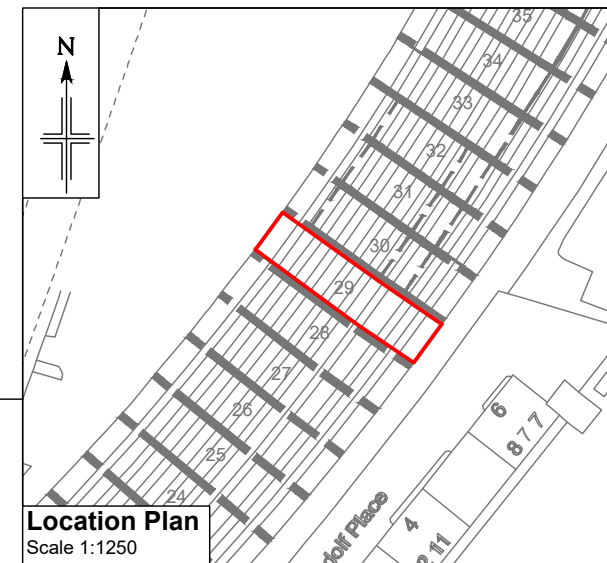

Location Plan
Scale 1:1250

Notes:
This drawing complies with the RICS Code of Measuring Practice, 6th edition (September 2007) and the Globally applicable 6th Edition (May 2015). It indicates the extent of the areas quoted, produced to an accuracy commensurate with standard presentation scales. It is held in a scaled digital CAD format.
Dashed lines denote assumed wall lines inaccessible or not in situ at the time of survey.

This drawing has been produced for area referencing purposes requested by the original commissioning agent and must not be used for any architectural or construction/engineering purposes or for any other purpose other than that for which it is originally intended. Plowman Craven Limited accepts no responsibility for details that are subsequently found to be the consequence of undisclosed facts or that were obscured from view at the time of survey or that have been altered since the date of survey.

This drawing contains Ordnance Survey data which has been reproduced with the permission of the Controller of Her Majesty's Stationery Office, Crown copyright 2020. The Ordnance Survey data has been obtained and reproduced by Plowman Craven Ltd in agreement with The Arch Company under Network Rail Licence Number 100040692.

Legend:

- H0.00 Haunch Height (m)
- A0.00 Arch Maximum Height (m)
- 0.00 Floor To Ceiling Height (m)

Revisions:

P01 - Original Issue (October 2020)

Dwg No.
43264-PCL-VXH01926-GF-DR-G-00001_Master-S6-P01

Plowman Craven

Regulated by RICS

