

**ALDERMARY
HOUSE**
15 QUEEN STREET
LONDON EC4

Newly refurbished offices with excellent views immediately available with a redesigned reception and fully upgraded end of trip facilities.

HIGH-QUALITY & INSPIRATIONAL

Located in the heart of the City, Aldermary House offers 1,910 to 8,742 sq ft of newly refurbished Cat B office space on a prominent corner site. The comprehensive refurbishment that was undertaken has resulted in an EPC B rating.

The architect redesigned units provide high quality office accommodation with a manned reception and excellent end of trip facilities. The building benefits from a private gym that is available to all tenants.



Main Reception



Exterior

AVAILABILITY

FLOOR	FITOUT	SQ FT	SQ M	DESKS	MEETING ROOMS	STATUS
3rd (W)	CAT B	2,138	198.6	24	2	AVAILABLE
3rd (N&S)	CAT B	4,694	436.0	48	4	AVAILABLE
1st (N)	CAT B	1,910	177.4	20	2	AVAILABLE
TOTAL		8,742	812.1			



3rd North & South Meeting Room



3rd North & South Kitchenette



3rd North & South Waiting Area



3rd North & South Workspace

3RD FLOOR NORTH & SOUTH

4,694 sq ft

- 48x Desks
- 1x Reception
- 1x 12-person meeting room
- 3x 8-person meeting rooms
- 2x Soft seating booths
- 1x Teapoint
- 4x Breakout areas
- 1x Waiting area
- 2x Focus pods

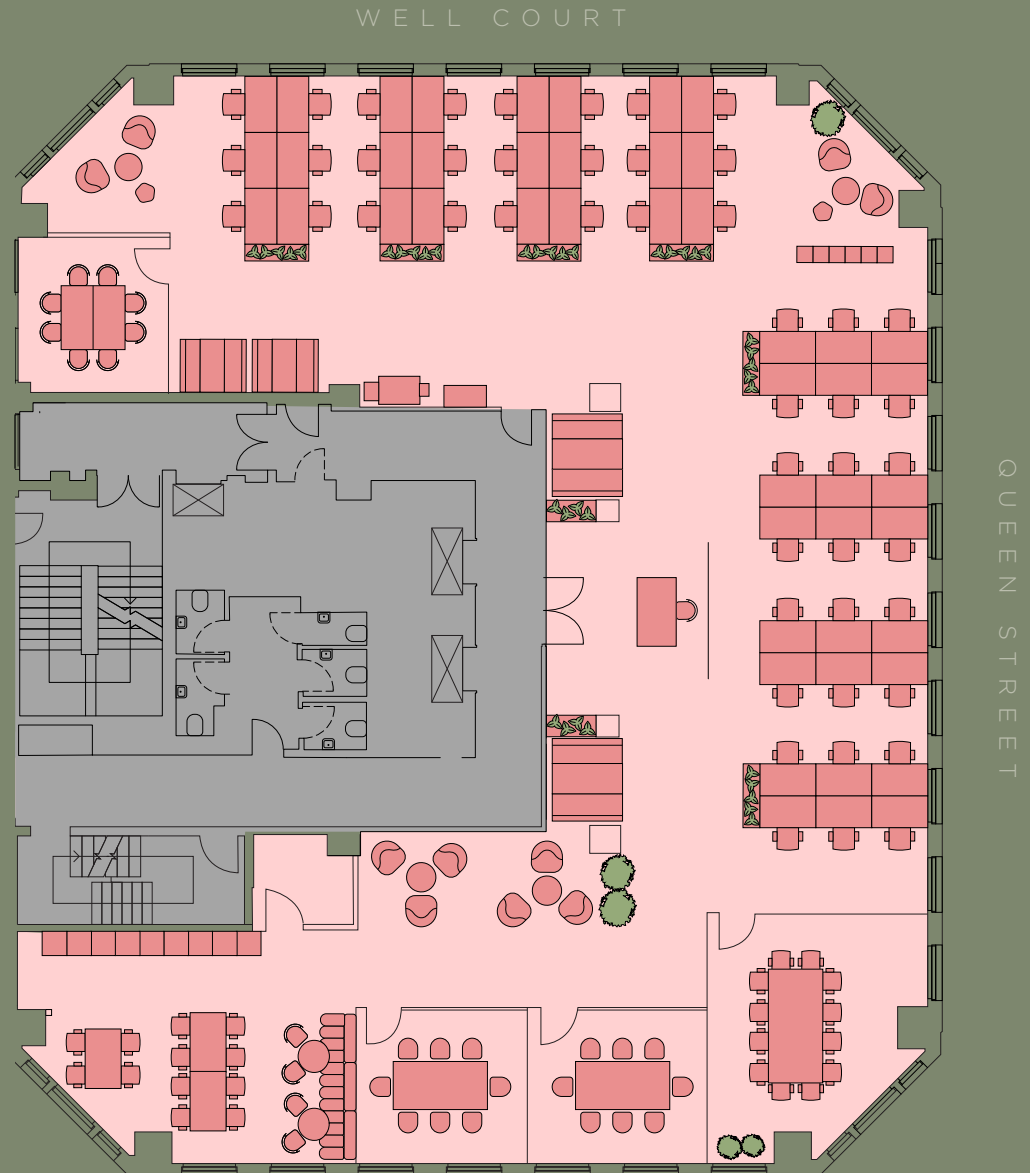



3rd West Kitchenette



3rd West Workspace



3rd West Meeting Room



3rd West Workspace

3RD FLOOR WEST

2,138 sq ft

- 24x Desks
- 1x 8-person meeting room
- 1x 6-person meeting room
- 1x Soft seating booth
- 1x Teapoint
- 1x Breakout area

WELL COURT

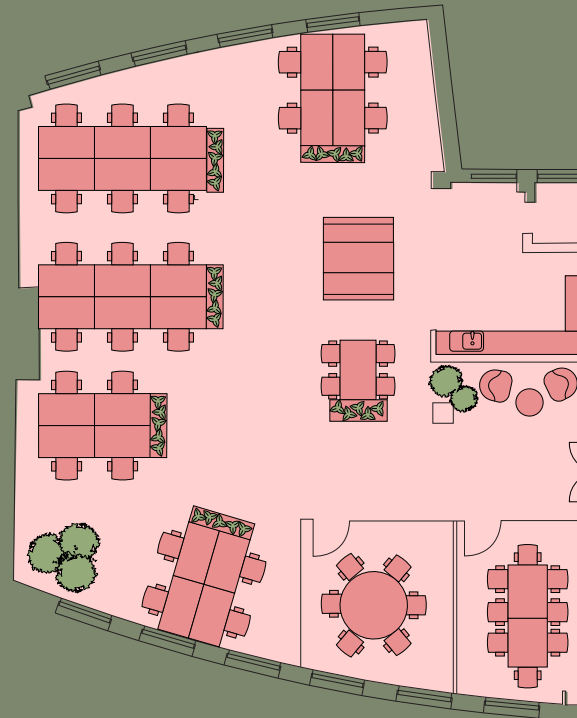

QUEEN STREET





1st North Meeting Rooms



1st North Workspace



1st North Kitchenette

1ST FLOOR NORTH

1,910 sq ft

- 20x Desks
- 1x 6-person meeting room
- 1x 4-person meeting room
- 1x Highbar area
- 4x Breakout areas
- Lockers

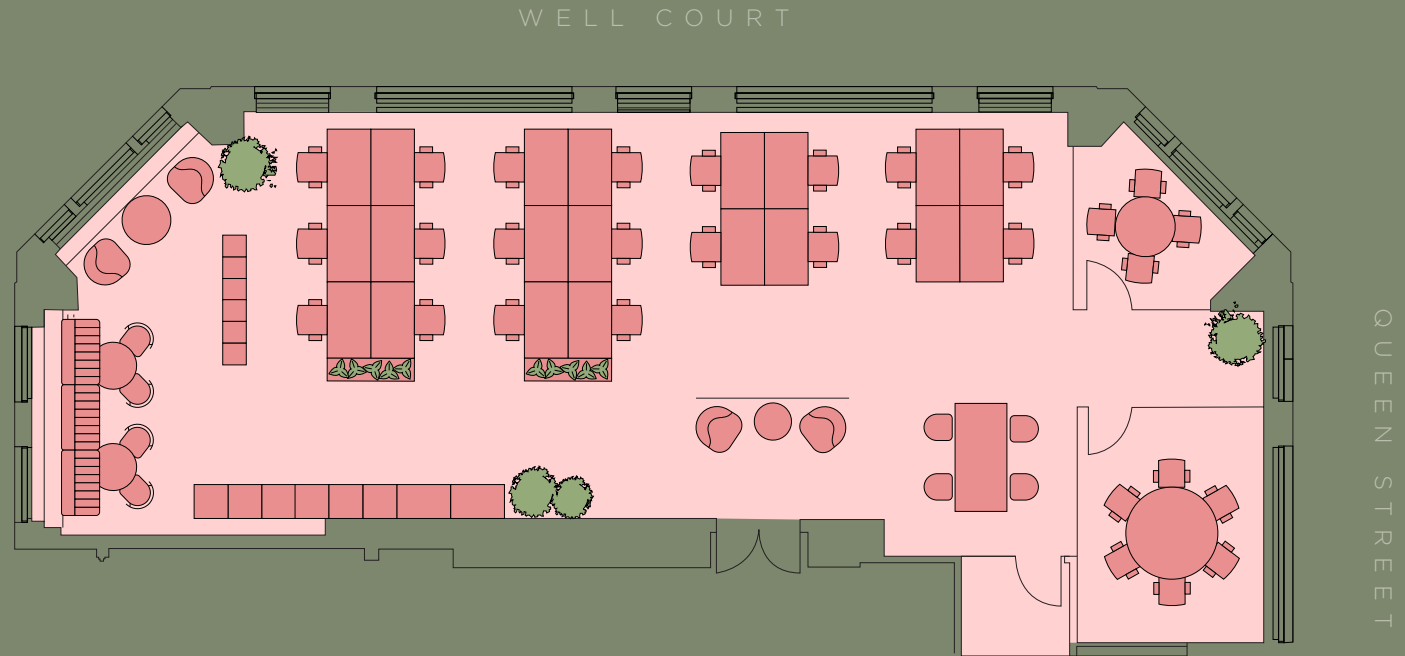

HIGHLIGHTS

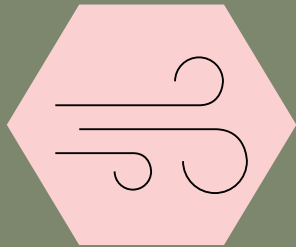

Tenant-controlled VRF
air-conditioning units

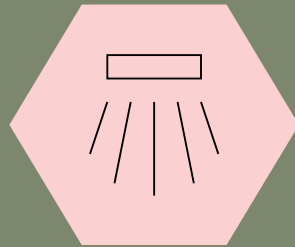

Recessed and suspended
LED lighting

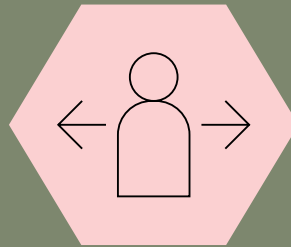

Occupational
design criteria -
1 person / 10 sq m

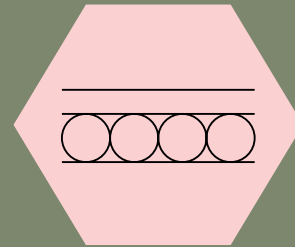

Hyperoptic connected
to all floors

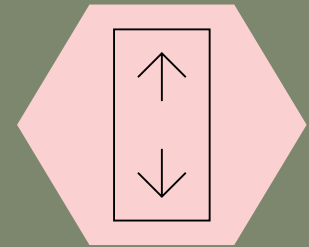

Two 13-person
passenger lifts



EPC B rating

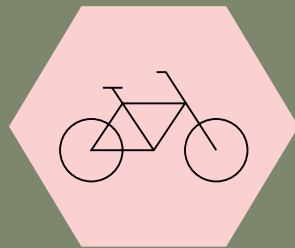

Secure bike storage
with bike repair station

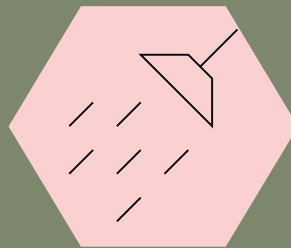

Refurbished WCs,
lockers and shower
facilities

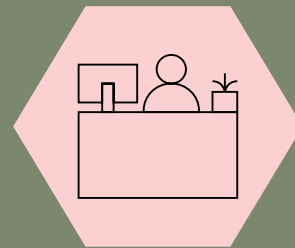

Refurbished double
height reception

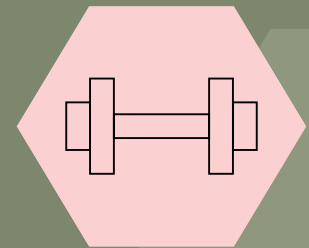

Tenants' gym



Locker Storage



View over St. Mary Aldermary Church



Tenants' Gym

CITY CENTRAL

Aldermary House is at the heart of the City, overlooking Bloomberg's headquarters with its renowned arcade of restaurants. The building is also moments away from the City's primary retail area at One New Change, Cheapside and Bow Lane. If you want some peaceful green space, St Paul's Cathedral Gardens is on the door step. The building is well connected with Underground, National Rail, DLR and the Elizabeth Line easily accessible.



One New Change











Bloomberg Arcade



Bow Lane

TRANSPORT & LOCAL AMENITY

Walking Times

- 
BANK
 3 Minutes
- 
MANSION HOUSE
 3 Minutes
- 
CANNON STREET
 4 Minutes
- 
ST. PAUL'S
 7 Minutes
- 
MONUMENT
 8 Minutes
- 
MOORGATE
 10 Minutes
- 
CITY THAMESLINK
 12 Minutes
- 
FARRINGDON
 16 Minutes

*walking times calculated from Aldermary House, according to Google Maps



CONTACT



Francis Cundell
f.cundell@inglebytrice.co.uk
07939 598 545

Malcolm Trice
m.trice@inglebytrice.co.uk
07791 049 792



Abby Brown
abby.brown@knightfrank.com
07827 083 969

Abby Dwan
abby.dwan@knightfrank.com
07976 084 158

Important notice relating to the Misrepresentation Act 1967 and the Property Misdescriptions Act 1991: (i) the particulars are set out as a general outline only for guidance of intending purchasers or lessees and do not constitute, nor constitute part of, an offer or contract (ii) all descriptions, dimensions, references to condition and necessary permission for use and occupation, and other details are given in good faith and are believed to be correct, but any intending purchasers or occupiers should not rely on them as statements or representations of fact, but must satisfy themselves by inspection or otherwise as to the correctness of each of them. October 2025

Marketing: [Stuart Chapman Design](#)