

The Langham Estate

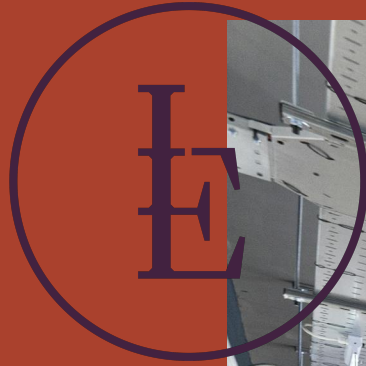

Great Titchfield
House, 14-18 Great
Titchfield Street,
London, W1W 8BD

2ND FLOOR
1,938 SQ FT | 180.05 SQ M
OFFICE TO LET

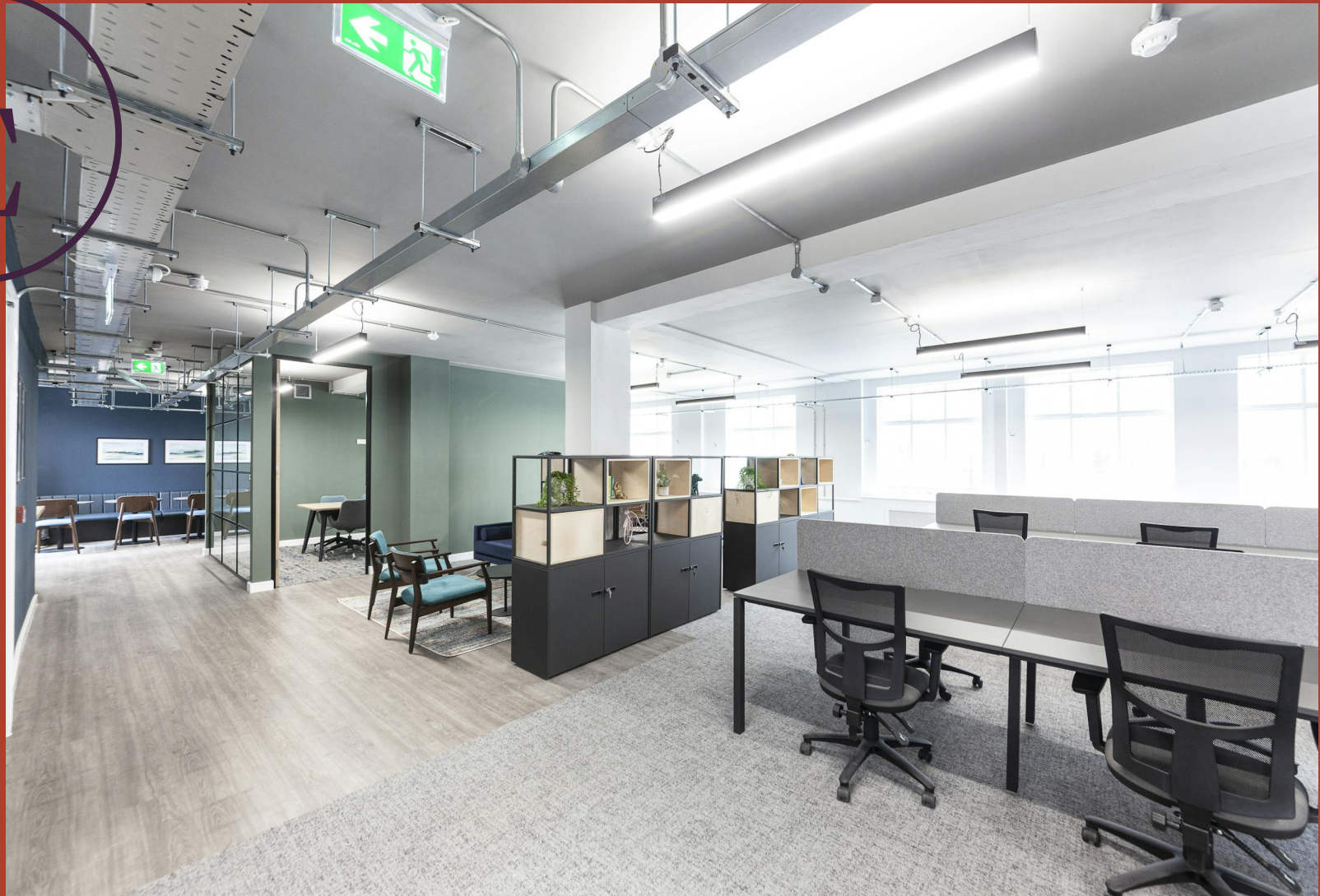

[Langhamestate.com](https://www.langhamestate.com)

020 7580 5656

Great Titchfield House, 14-18 Great Titchfield Street - 2nd Floor



Location

Great Titchfield House is located on the east side of Great Titchfield Street, between Margaret Street and Mortimer Street, in the heart of vibrant Fitzrovia.

The property is moments away from the international retail thoroughfare of Oxford Street & Regent Street and a short walk away from Regent's Park.

The area has excellent transport links including 8 underground tube lines spread across 8 stations, with Oxford Circus Station being just a 3-minute walk away, while Tottenham Court Road Station, featuring the Elizabeth Line, is also in close proximity.

Connectivity

Oxford Circus	3 mins walk
Goodge Street	6 mins walk
Tottenham Court Road	7 mins walk
Bond Street	9 mins walk

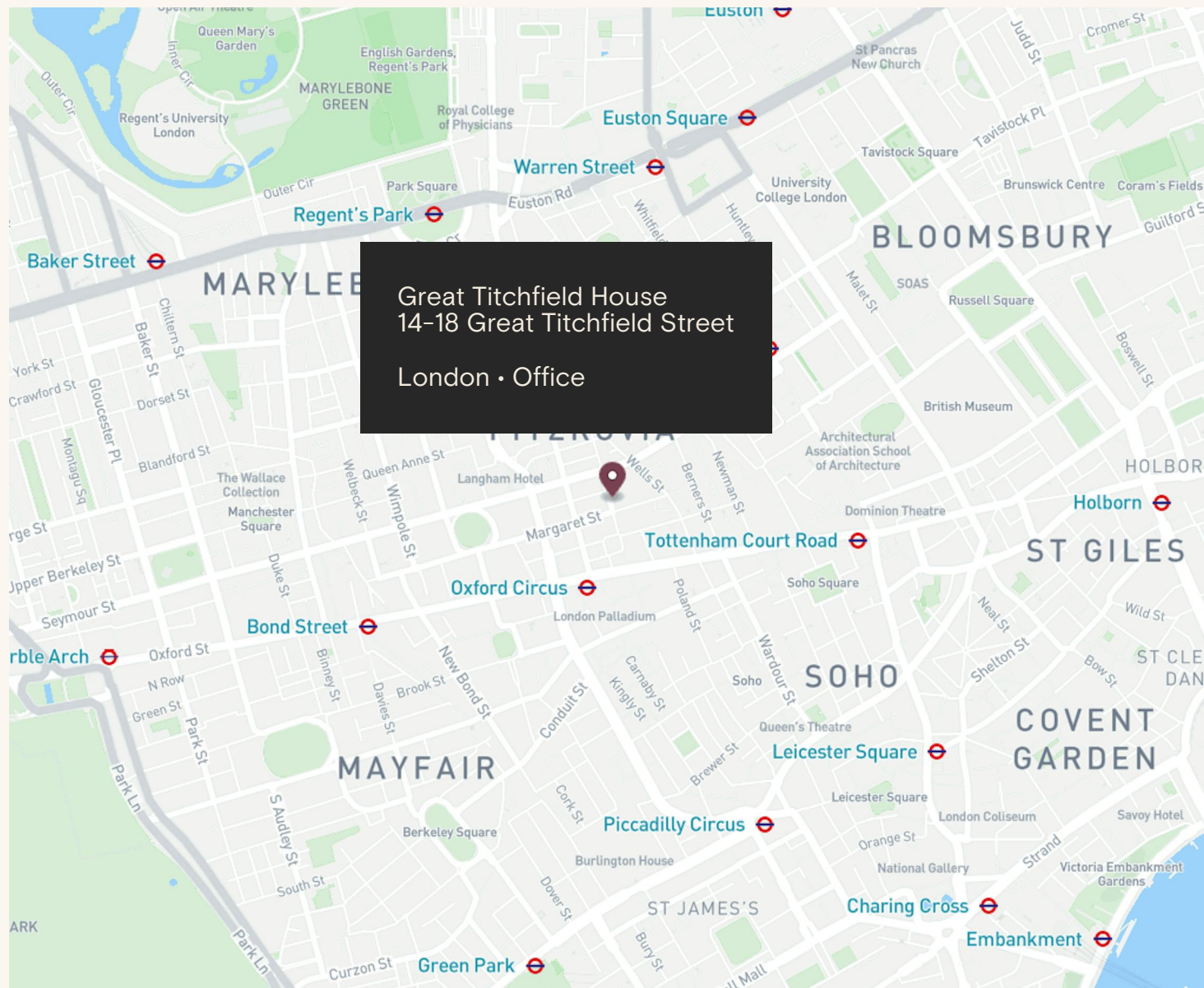

Great Titchfield House, 14-18 Great Titchfield Street - 2nd Floor



1,938 sq ft fitted office space
with its own kitchenette
and one meeting room





Great Titchfield House, 14-18 Great Titchfield Street - 2nd Floor



Great Titchfield House, 14-18 Great Titchfield Street - 2nd Floor



Features

- Mainly Open Plan
- Partial Wood Flooring
- Communal Showers
- Furnished
- Good Natural Light
- Own Kitchenette
- 24 Hour Access
- LED Lighting
- Feature Lighting
- Lounge Area
- One Meeting Room
- Entry Phone

Details

Floor Area
1,938 SQ FT / 180.05 SQ M

Rent
£72.50 per sq ft

Lease Terms
A new Full Repairing & Insuring Lease is available for a term by arrangement, outside the Landlord & Tenant Act 1954.

Possession
Immediate upon completion of legal formalities

Legal Costs
Each party to be responsible for their own legal costs

VAT
Pricing exclusive of V.A.T

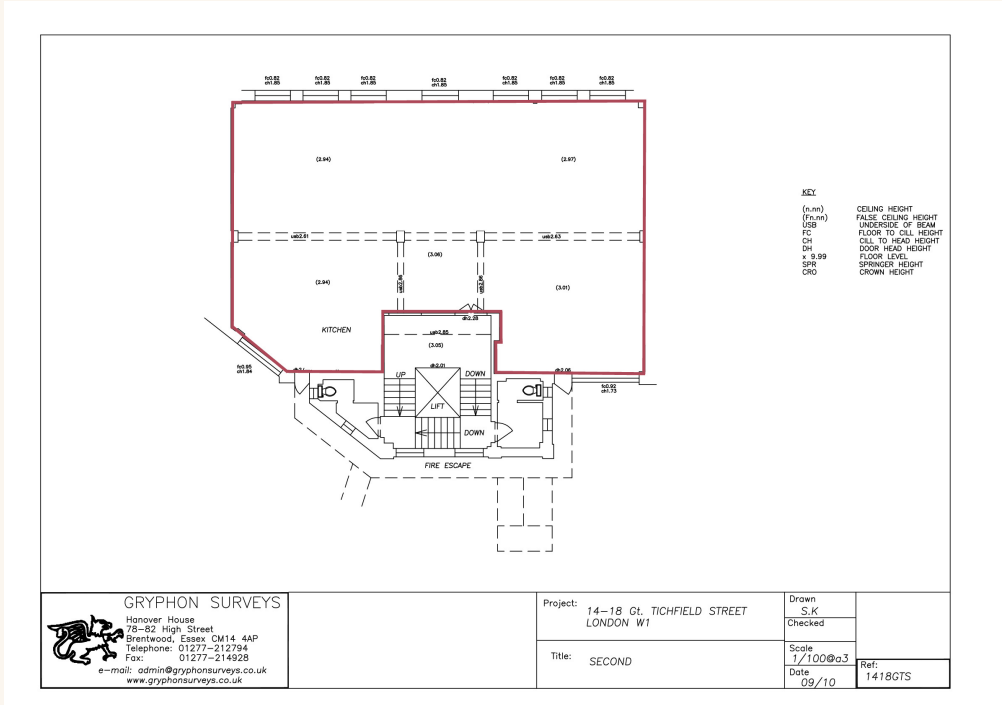



Name	sq ft	sq m	Availability
2nd	1,938	180.05	Available
Total	1,938	180.05	

Schedule of Areas



FQ

Discover Fitzrovia *Quarter*



FITZROVIA QUARTER

Explore our neighbourhood

The Langham Estate

langhamestate.com

For further information call

020 7580 5656

Daniel Yershon

daniel.yershon@langhamestate.com

020 7907 4986

07731 985 129

Malcolm Cohen

malcolm.cohen@langhamestate.com

07526 189 462

020 7907 4983

Sabina Bathurst

sabina.bathurst@langhamestate.com

02079074960

07355603106

