

**FITTED AND FURNISHED SUITES**  
**ARK.LONDON**

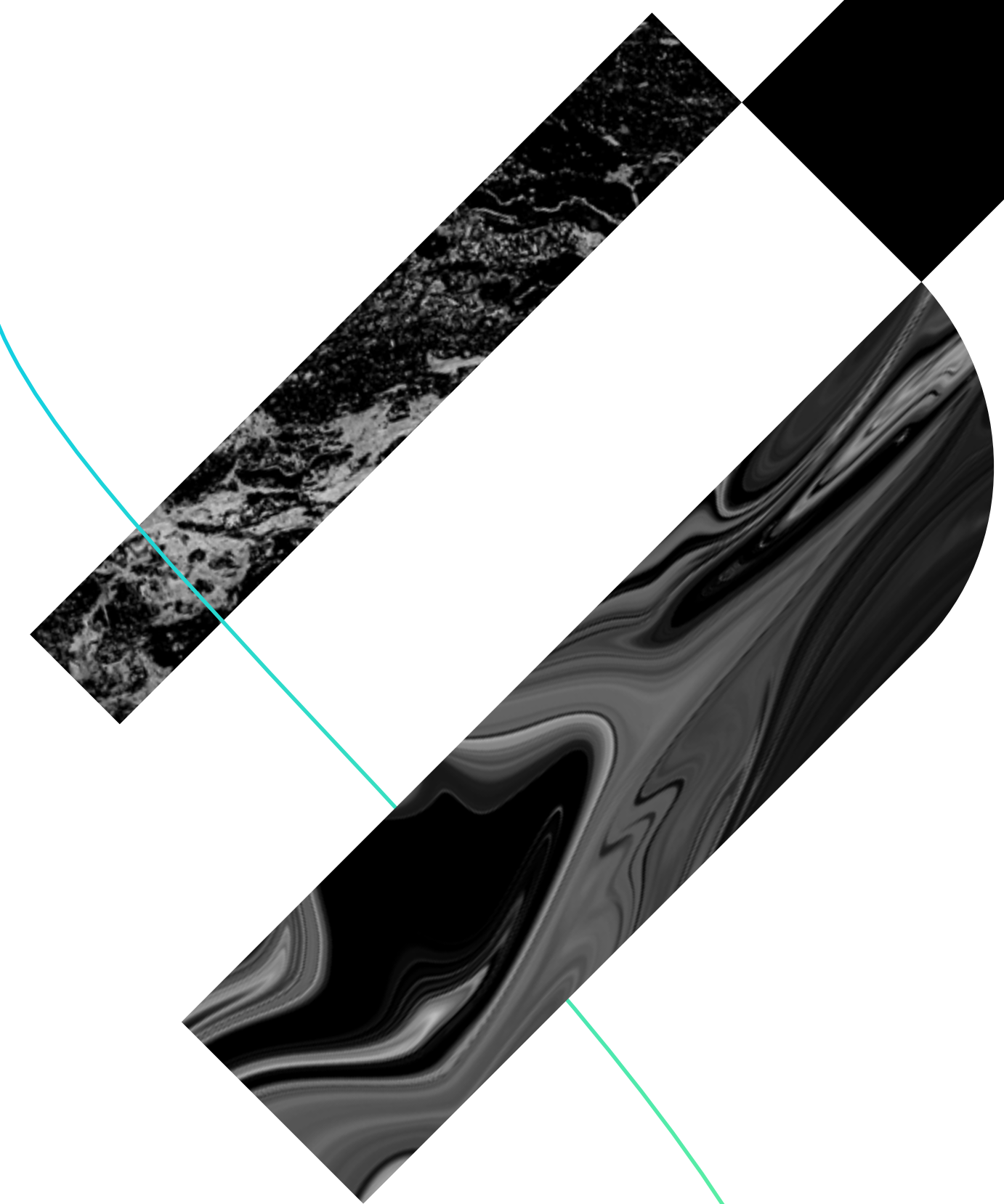
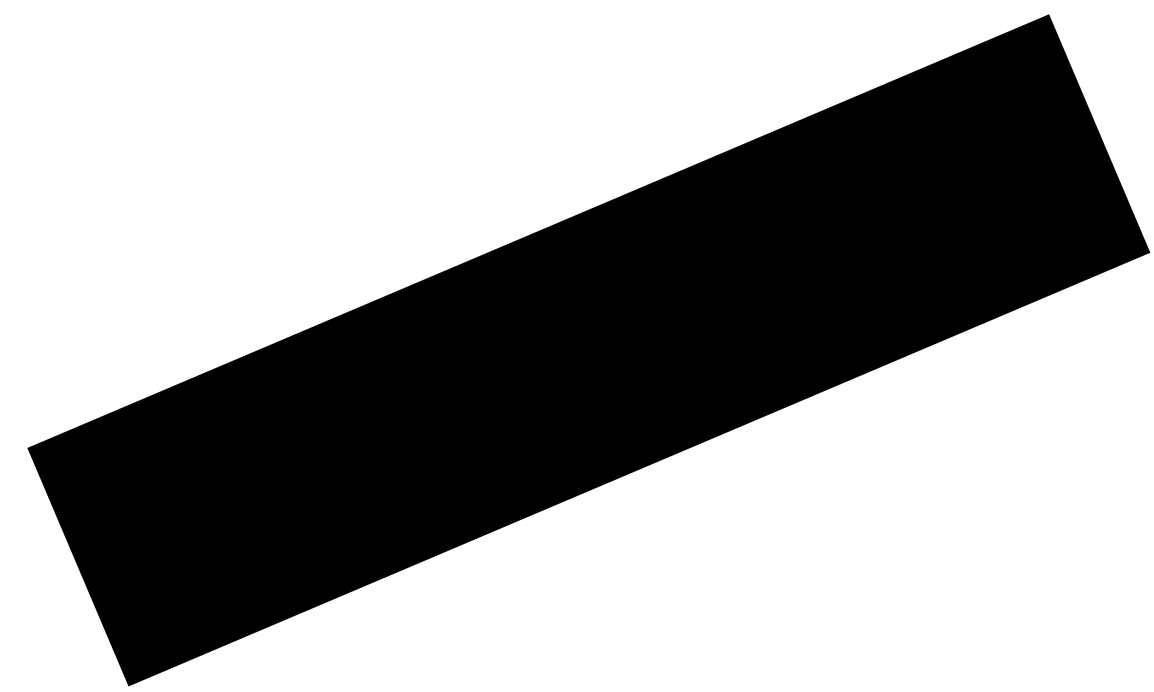
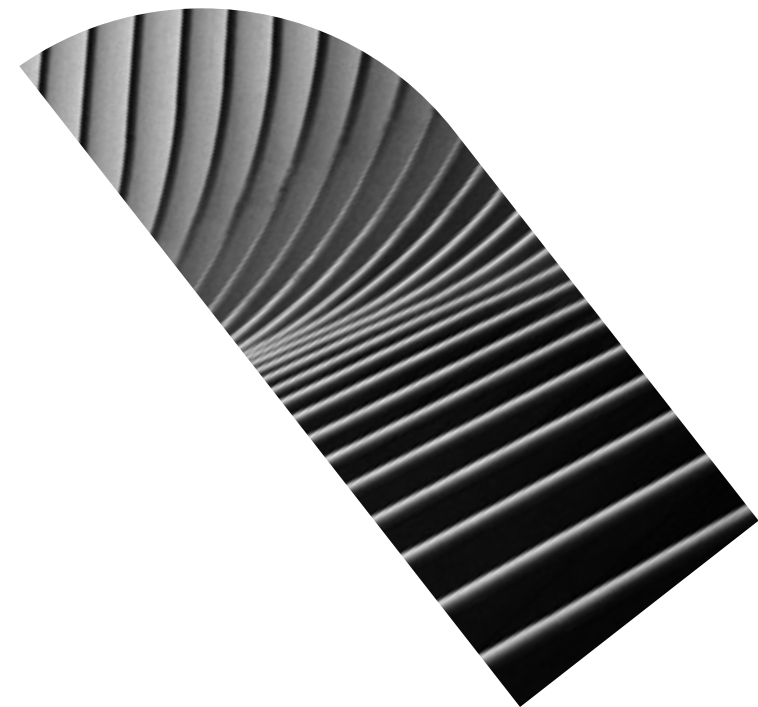
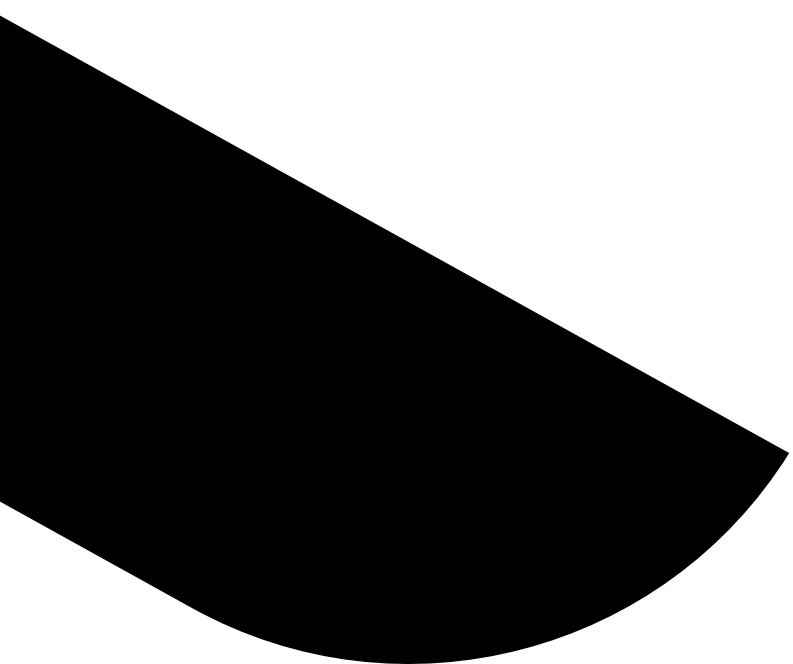

**ORIGINAL**  
**BY DESIGN**

W6

**ARK**  
**ARK**

# A WORKPLACE OF PRODUCTIVITY

With its multitude of spacious communal areas ARK seamlessly blends collaborative space with private meeting rooms and kitchens in place.

The fitted suites of the newly renovated ARK offers occupiers flexibility and convenience with a range of size available from 1,300 to 7,000 sq ft.

ARK<sup>W6</sup>



# LEVEL 3 →

## UNIT B (NORTH)

1,447 SQ FT // 134 SQ M

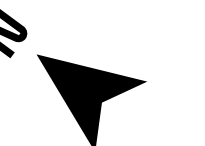
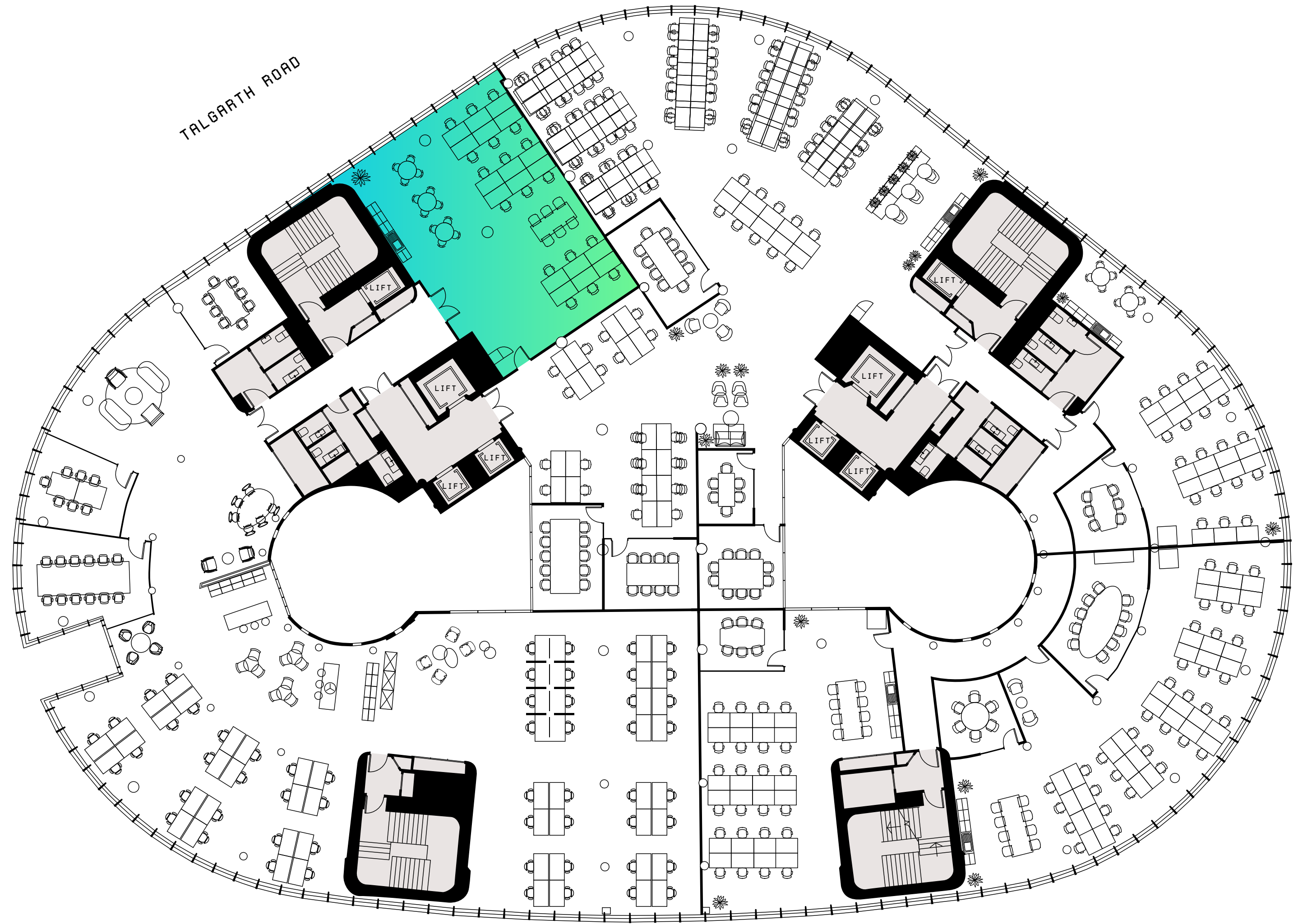

# LEVEL 4 →

UNIT B / C

7,911 SQ FT // 734 SQ M

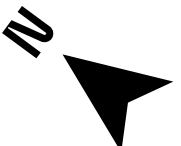
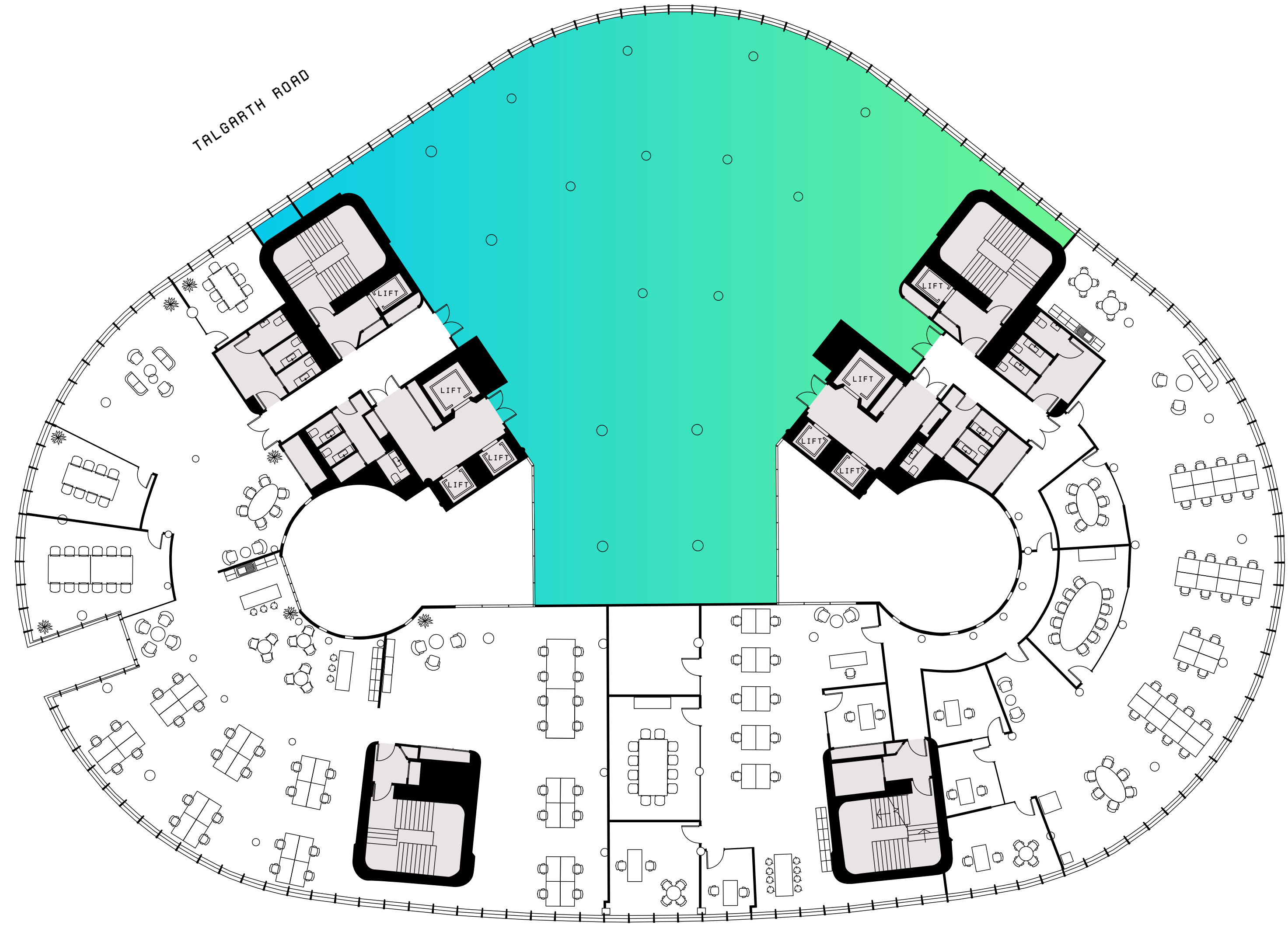

# LEVEL 7 →

## UNIT A

3,266 SQ FT // 303 SQ M

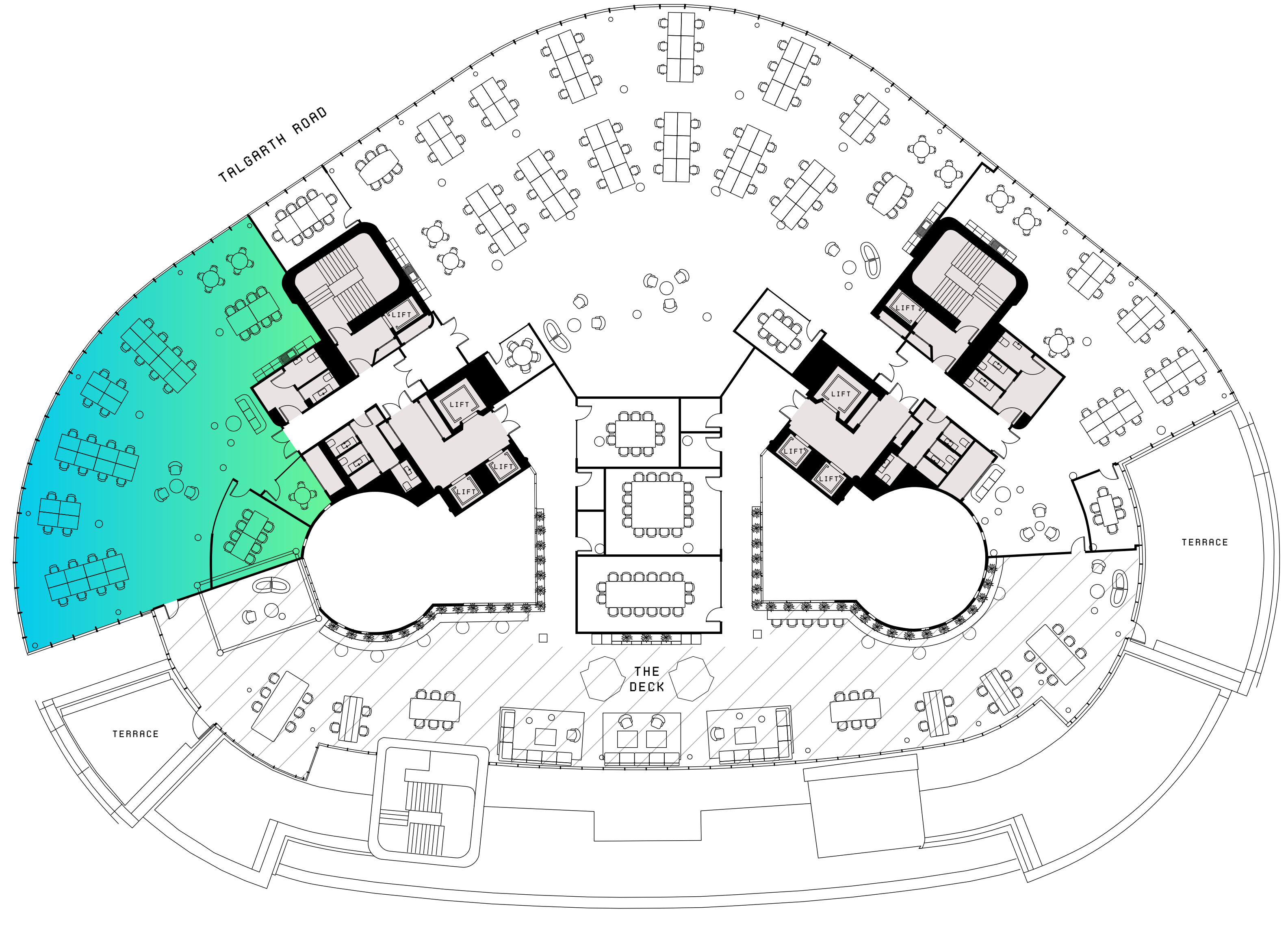

# LEVEL 7 →

## UNIT B

7,306 SQ FT // 679 SQ M

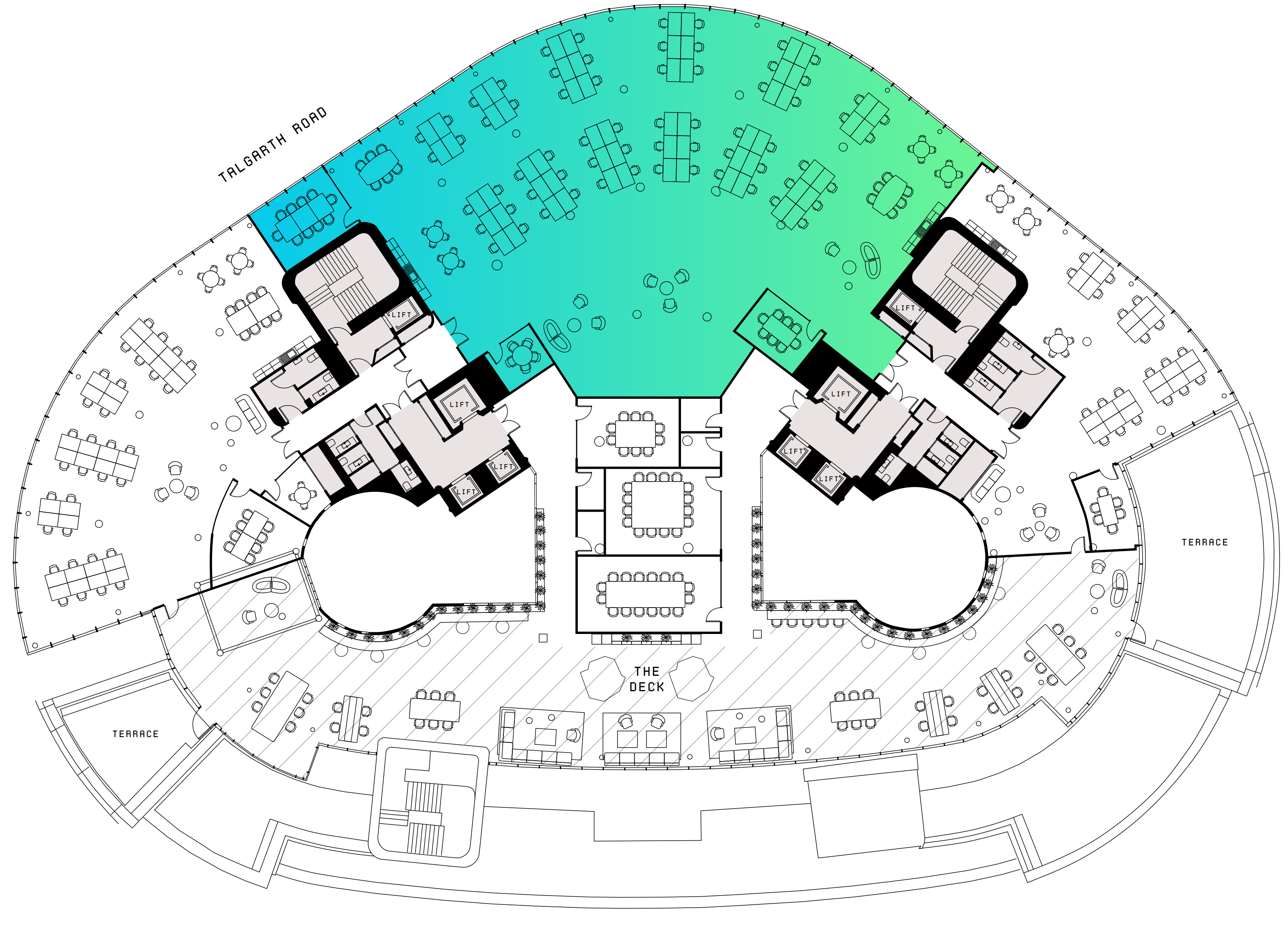

# LEVEL 7 →

## UNIT C

2,097 SQ FT // 195 SQ M

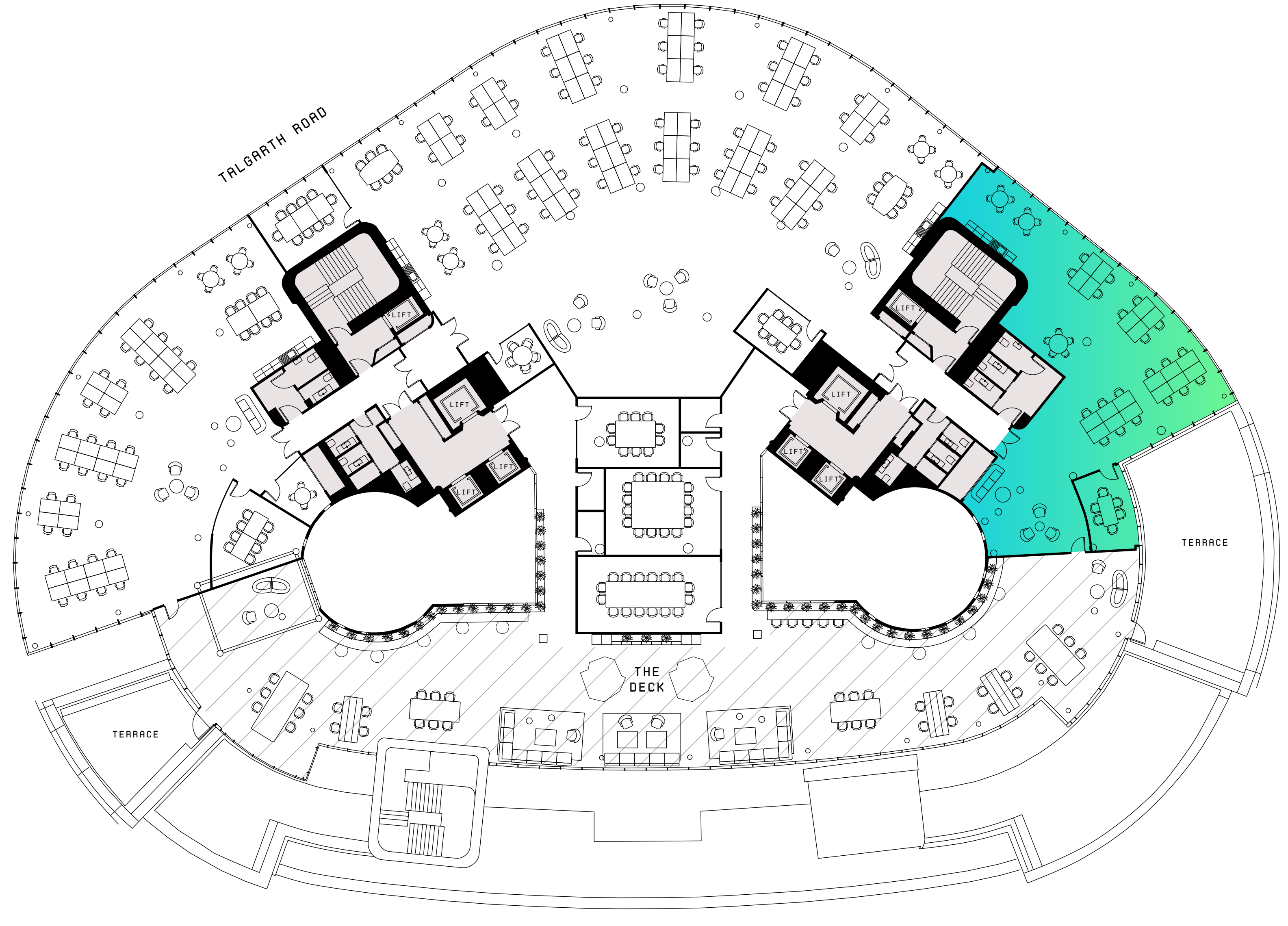

# LEVEL 8 →

## UNIT A

2,663 SQ FT // 247 SQ M

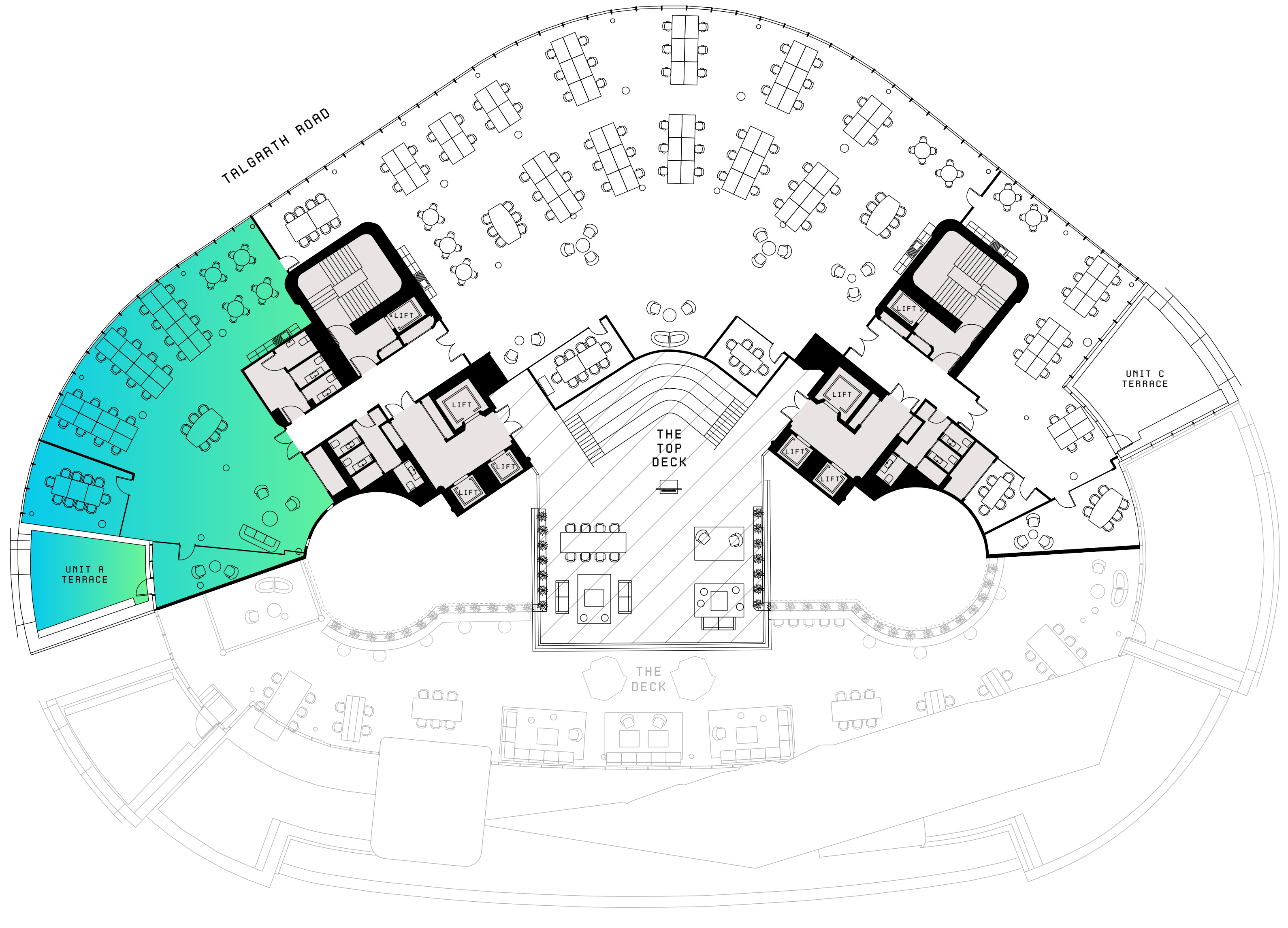

# LEVEL 8 →

## UNIT B

7,006 SQ FT // 651 SQ M

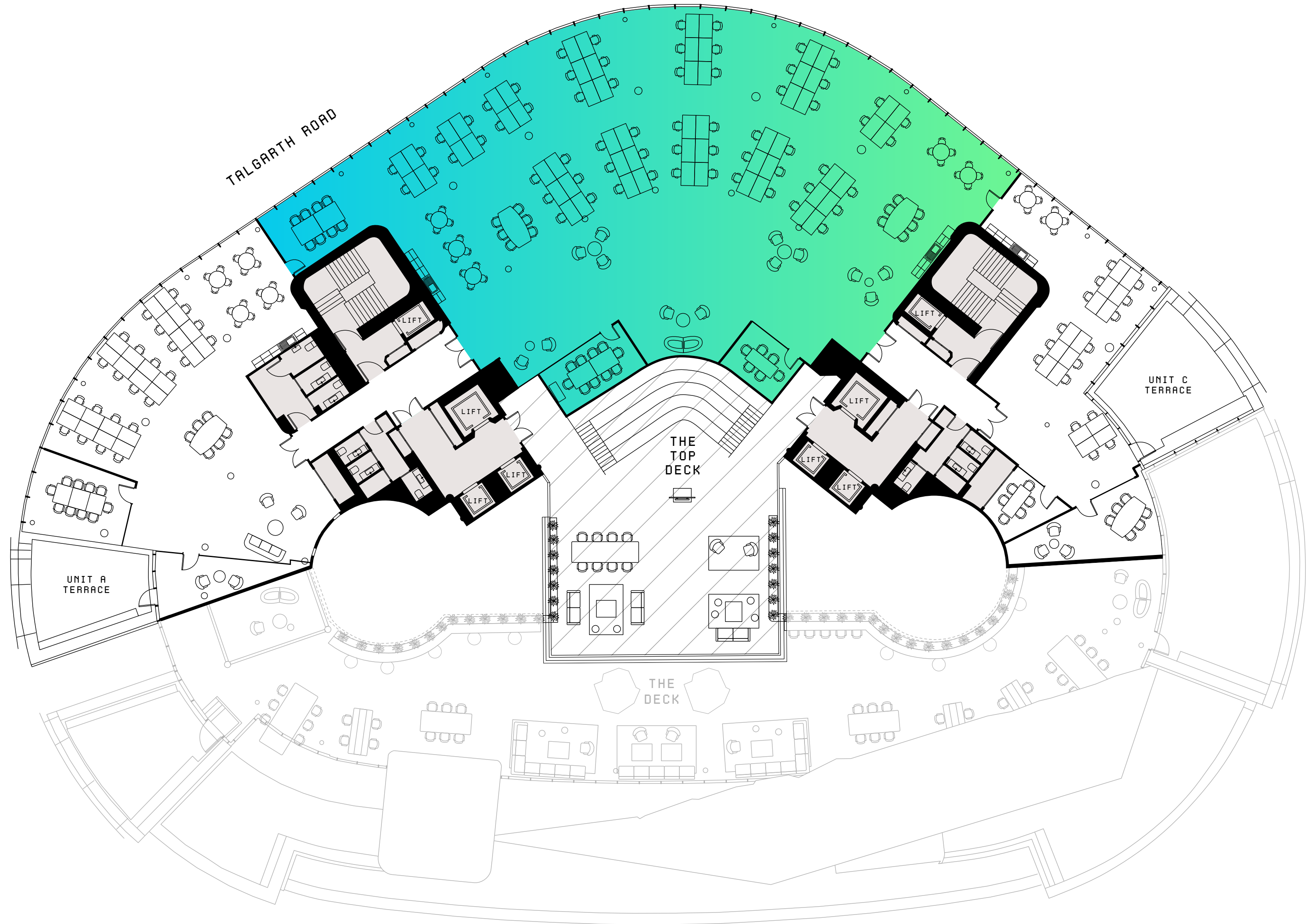

# LEVEL 8 →

## UNIT C

1,753 SQ FT // 163 SQ M

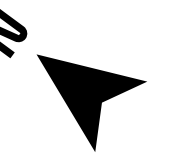
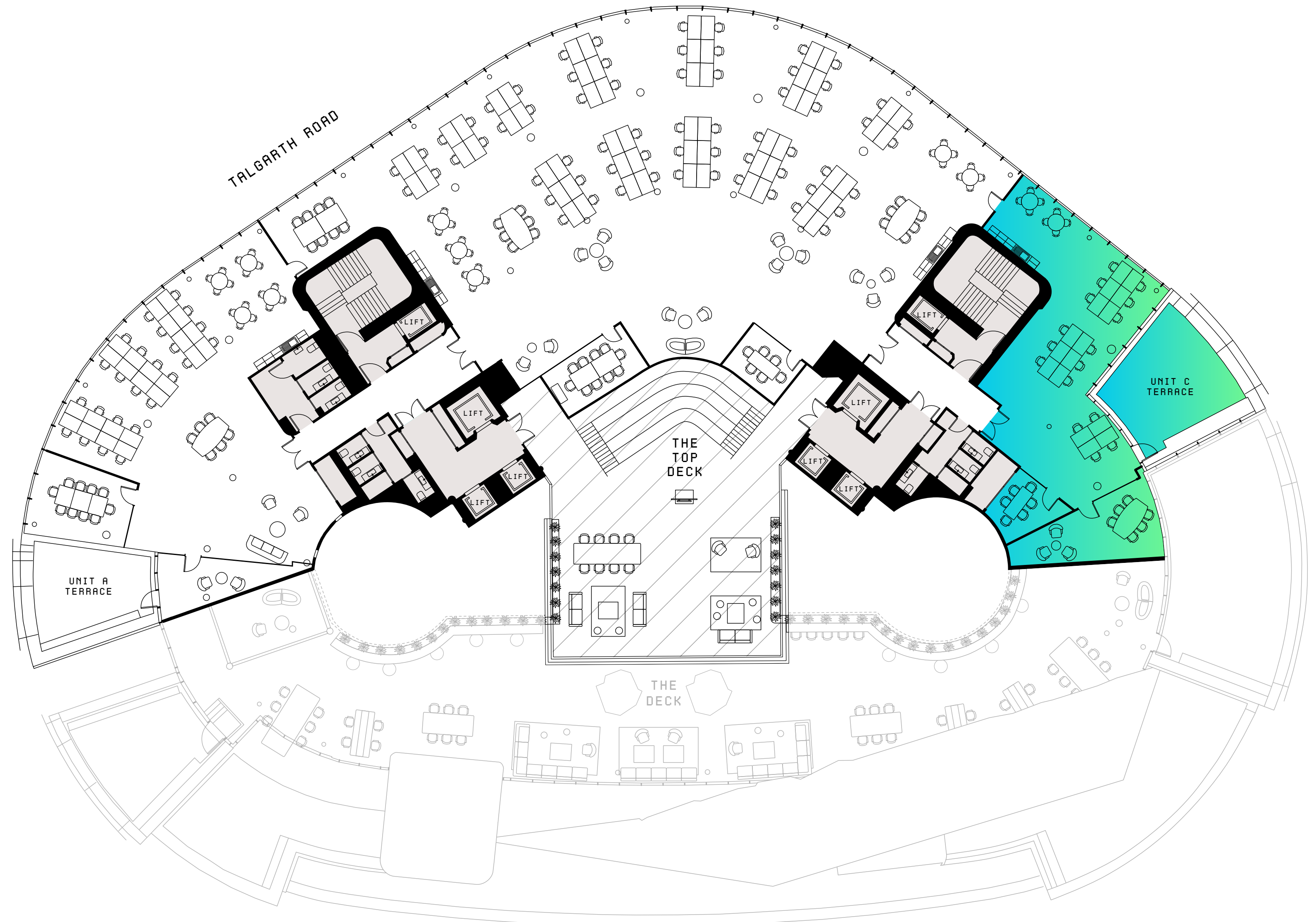

# BUILDING SPECIFICATION

- ✓ 2.7m-3.5m typical floor to ceiling height
- ✓ Upgraded public realm & improved approach
- ✓ Newly refurbished reception and amenity lounge with cafe totalling 7,914 sq ft
- ✓ New bike store – 212 spaces
- ✓ New shower & changing facilities
- ✓ Brand new fully equipped gym
- ✓ 36 secure basement parking spaces (including EV parking)

## BUILDING AND SUSTAINABILITY CREDENTIALS

- ✓ Wired Score Gold
- ✓ EPC rating - B
- ✓ BREEAM Excellent



# THE TOP DECK

A state-of-the-art auditorium, with the capacity to host functions for up to 90 x people.

## TECHNICAL SPECIFICATIONS

- ✓ Display - Philips 94" Native 4K (3,840 x 2,160)
- ✓ Connectivity - White Face Plate with HDMI & USB-C Connectivity (Manual or Auto Switching)
- ✓ Audio Reproduction - Ultra-Compact, Steerable, Self-Powered Column L-line Array with 12 Full-Range
- ✓ Sonos audio streaming device, with Apple audio interface
- ✓ 2 x Sennheiser handheld wireless microphones

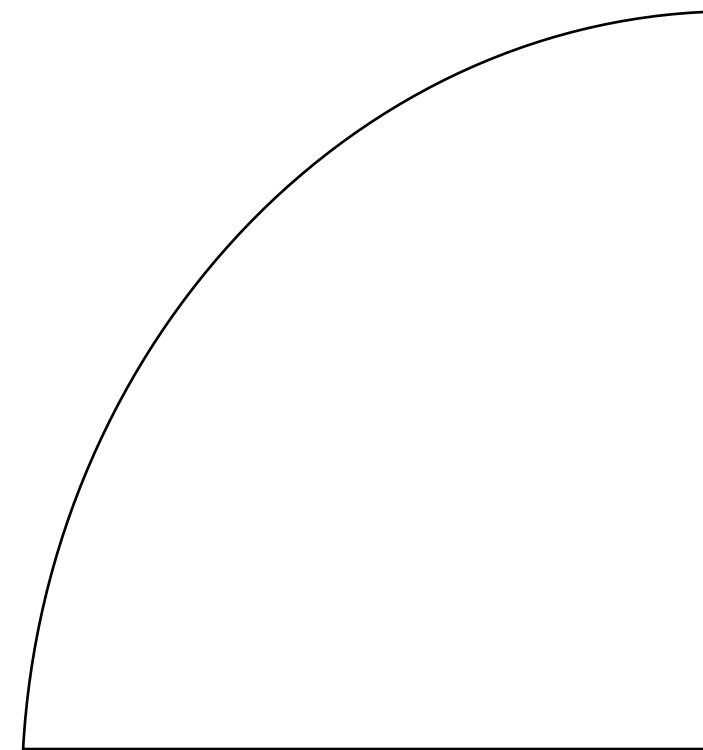
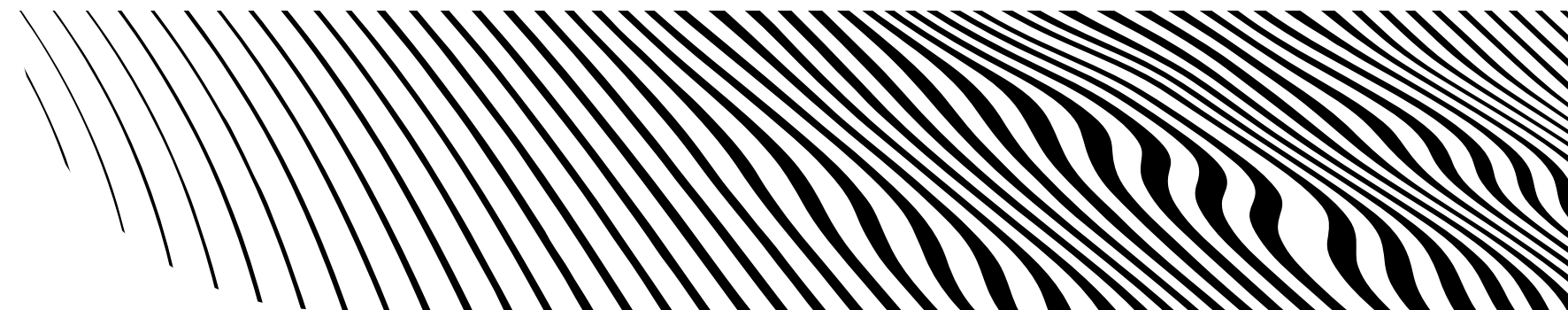

# A PLACE TO IMPRESS, AND TO BE IMPRESSED.

All occupiers will benefit from the absolute best-in-class amenities that ARK has to offer, with the on-site gym, end of trip and changing facilities, impressive entrance, reception and social hub and crow's nest 360 degree meeting room in the sky.

[CLICK THROUGH TO VIEW THE FULL SPACE](#)

# A WORLD AWAY FROM THE HUSTLE AND BUSTLE

The island site that is ARK, is totally unique and a landmark in its own right. Just minutes away from Hammersmith station, Hammersmith high street and the M4, it is incredibly placed for all means of travel. Just a short walk away from the river, you'll find a range of local eateries to choose from with delicious food and idyllic riverside views.

## EXPLORE MORE

**03** MINUTES

Walk to Hammersmith underground and bus station.

**04** TUBE LINES

A stone's throw away from Hammersmith underground station.

**13** MINUTES

Drive time to the M4 (Chiswick roundabout).

**14** MINUTES

To the Elizabeth line via Paddington station.

**18** BUS ROUTES

Via Hammersmith bus station.

**35** MINUTES

To London Heathrow (T5) via the Piccadilly line.

**A4** MOTORWAY

Conveniently located on your doorstep.

**29** MINUTES

Drive time to Heathrow (T5) via the M4.

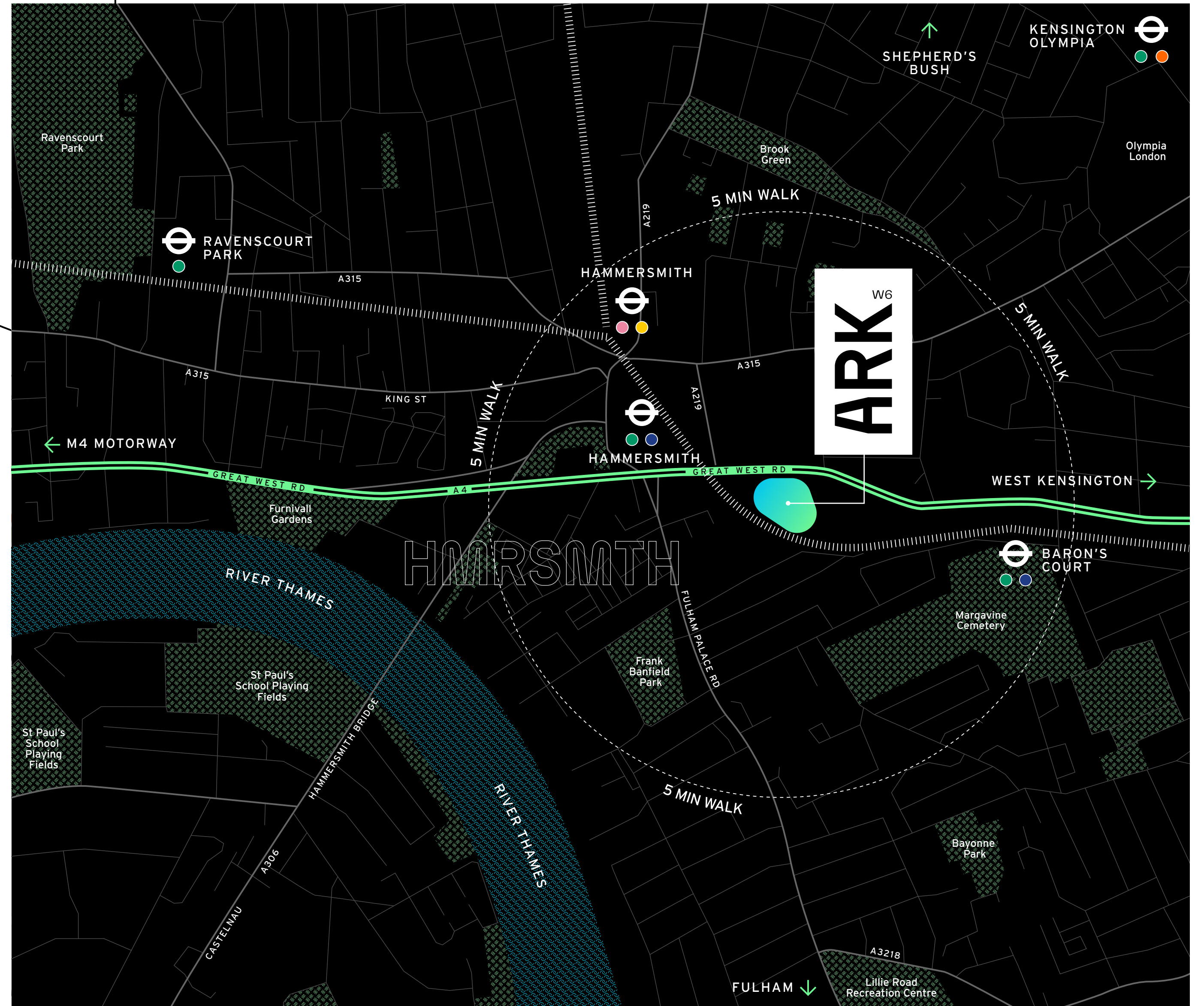

ARK<sup>W6</sup>

Architecture by

**Gensler**

Visit our website

**ARK.LONDON**

201 Talgarth Road  
Hammersmith  
W6 8BJ

**workthere** 

Peter Hall  
07837 719 263  
peter.hall@workthere.com

Jodie Burwood  
07939 890 689  
jodie.burwood@workthere.com



Freddie Corlett  
07870 555 842  
fcorlett@savills.com

Andrew Willcock  
07870 999 628  
awillcock@savills.com

Holly Purvis  
07977 371 475  
holly.purvis@savills.com

Kian Kelly  
07890 903 968  
kian.kelly@savills.com



James Taylor  
07899 843 767  
james.taylor@cushwake.com

Guy Ritcher  
07741 094 570  
guy.ritcher@cushwake.com

Cameron Lineen  
07827 335 661  
cameron.lineen@cushwake.com



Simon Kibble  
07774 646 393  
skibble@frostmeadowcroft.com

Tristan David  
07789 347 999  
tdavid@frostmeadowcroft.com

MISREPRESENTATION ACT 1967: Cushman & Wakefield and Savills for themselves and for the Vendors or Lessors of this property whose agents they are give notice that. 1. All descriptions, dimensions, reference to condition and necessary permissions for use and occupation, and other details are given without responsibility and any intending purchasers or tenants should not rely on them as statements or representations of fact but must satisfy themselves by inspection or otherwise as to the correctness of each of them. 2. Any services mentioned have not been tested and therefore prospective occupiers should satisfy themselves as to their operation. 3. These particulars are produced in good faith, and set out as a general guide only and do not constitute part of any offer or contract. 4. No person in the employment of Cushman & Wakefield nor Savills has any authority to make or give representation or warranty whatever to this property. 5. All prices and rents are quoted exclusive of VAT unless otherwise stated. Designed by J2.net - February 2026.