

For rent

Flexible office space

boho five

Ground floor 2,735 sq ft

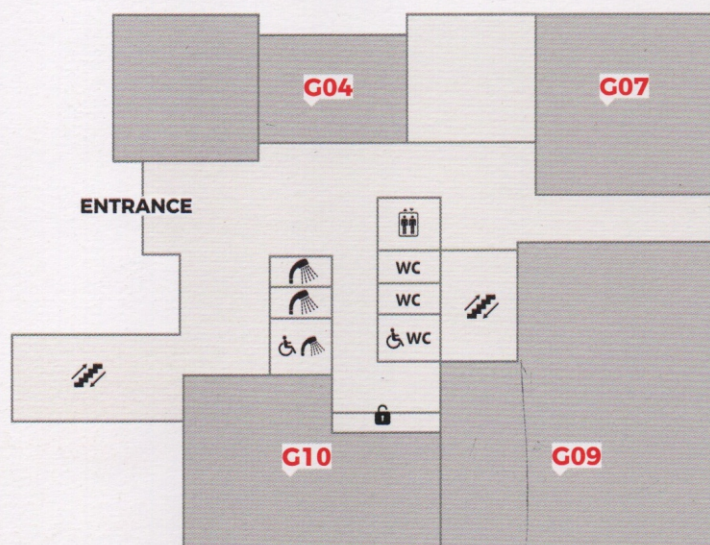

G04 219 sq ft
G07 471 sq ft
G09 1,053 sq ft
G10 554 sq ft

First floor 3,107 sq ft



105 336 sq ft
106 511 sq ft
107 538 sq ft
108 426 sq ft
109 480 sq ft
110 530 sq ft
111 286 sq ft

- Offices can be adapted to suit tenants
- Multiple offices can be secured
- 24/7-secure access
- High speed broadband
- Accessible spaces
- Sustainable and environmentally-friendly utilities
- Light and airy offices
- Breakout spaces and private meeting rooms
- Communal kitchen areas and showers

For details and specifications about Boho One,
contact our team today on 01609 797 330

align CHARTERED
SURVEYORS

Second floor 2,770 sq ft



205 337 sq ft	209 251 sq ft	212 177 sq ft
206 170 sq ft	210 259 sq ft	213 538 sq ft
207 171 sq ft	211 177 sq ft	

Third floor 2,758 sq ft



305 336 sq ft	309 531 sq ft	313 269 sq ft
306 170 sq ft	310 177 sq ft	314 250 sq ft
307 171 sq ft	311 177 sq ft	315 258 sq ft
308 161 sq ft	312 258 sq ft	

Fourth floor 2,763 sq ft

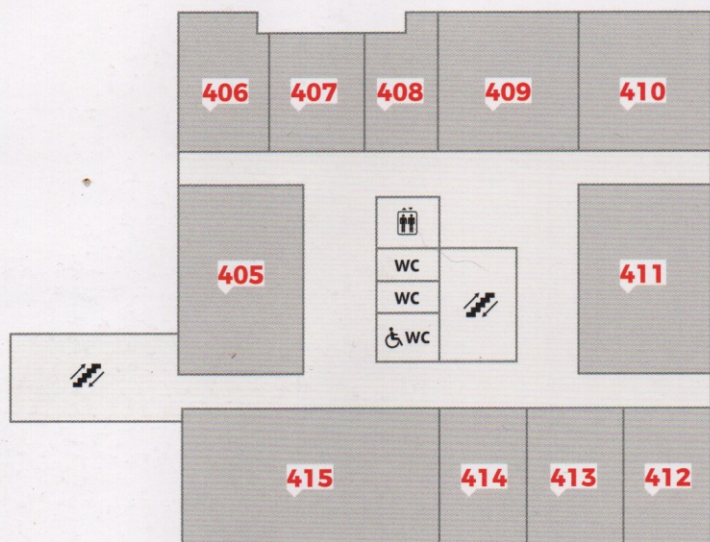

405 337 sq ft	409 272 sq ft	413 187 sq ft
406 171 sq ft	410 259 sq ft	414 168 sq ft
407 187 sq ft	411 360 sq ft	415 510 sq ft
408 141 sq ft	412 171 sq ft	

Fifth floor 2,881 sq ft



505 227 sq ft	508 269 sq ft	511 335 sq ft
506 104 sq ft	510 336 sq ft	512 337 sq ft
507 328 sq ft		

Contact us today to discuss your move to Boho #BepartofBoho