



Open Storage Site Terrick, North Lee Lane, Aylesbury, HP22 5YB

For Sale | 4.60 Acres

FREEHOLD OPEN STORAGE SITE

Open Storage Site Terrick, North Lee Lane, Aylesbury, HP22 5YB

FOR SALE

Summary

- Size: 4.60 Acres
- Price: Offers in excess of £1,300,000
- Rates payable: To be assessed.

Further information

- [Microsite](#)

Viewings and Further Information



Joanna Kearvell
07887 793030
jk@chandlergarvey.com



James Garvey
01494 460258 | 07471996320
jg@chandlergarvey.com

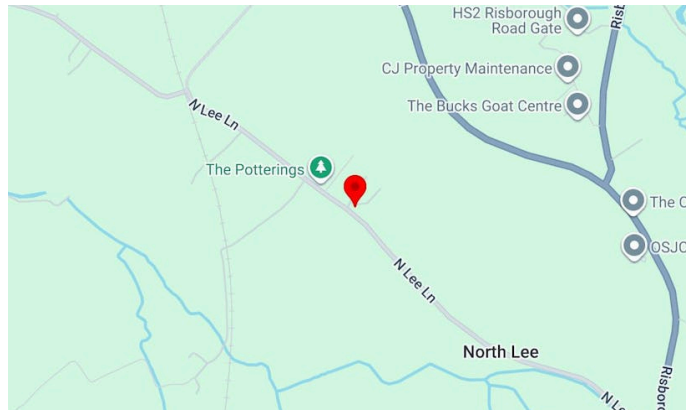

Description

4.6 acre open storage site for sale with vacant possession. The site is secure with new fencing and offers 1 acre of concrete storage, 0.5 acres of crushed concrete coverage and the remainder is grass.

There are a number of temporary structures on the site which could be retained or removed subject to requirements. The site has a water and electricity connection to the boundary which can be reconnected if required.

The previous use was storage for a significant period of time and further details on the planning situation can be provided.

Location

The site is located off North Lee Lane in Terrick with easy access to the A4010 between Princes Risborough and Aylesbury. Access to the A41 is 5.5 miles away with the nearest Chiltern Railway line service between Birmingham and London Marylebone available in Kimble less than 3 miles away.

Junction 6 of the M40 is 12 miles distant.



Terms

The property is for sale on a freehold basis with vacant possession.

What 3 Words

///prance.storybook.waltzes

<https://w3w.co/prance.storybook.waltzes>

VAT

Not applicable

Legal fees

Each party to bear their own costs

Floor plan

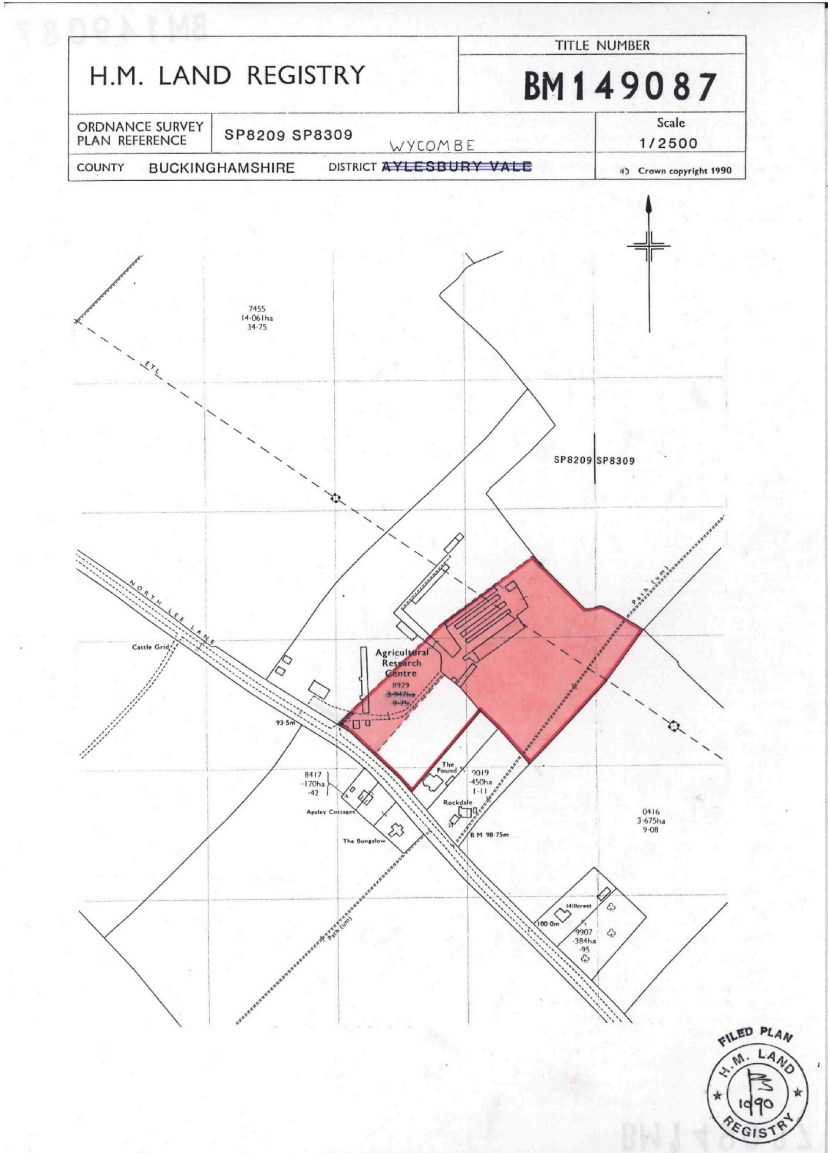

This is a print of the view of the title plan obtained from HM Land Registry showing the state of the title plan on 04 February 2026 at 16:50:48. This title plan shows the general position, not the exact line, of the boundaries. It may be subject to distortions in scale. Measurements scaled from this plan may not match measurements between the same points on the ground.

This title is dealt with by HM Land Registry, Leicester Office.

© Crown Copyright. Produced by HM Land Registry. Reproduction in whole or in part is prohibited without the prior written permission of Ordnance Survey. Licence Number AC0000851063.

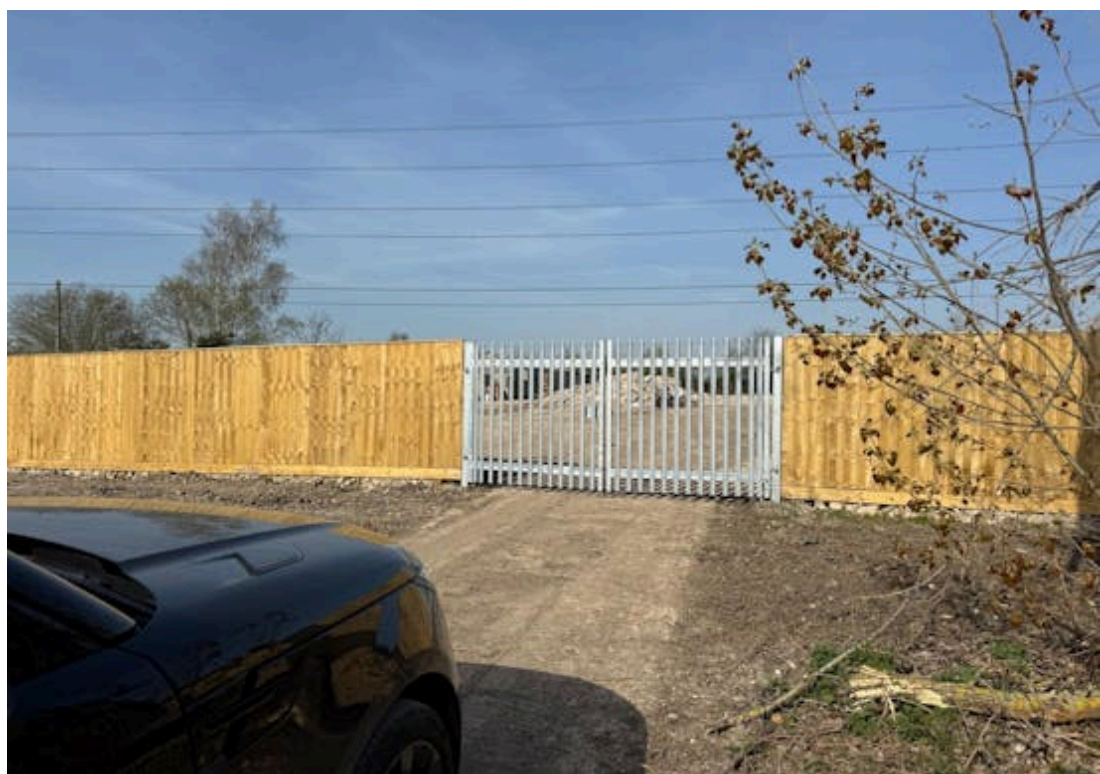
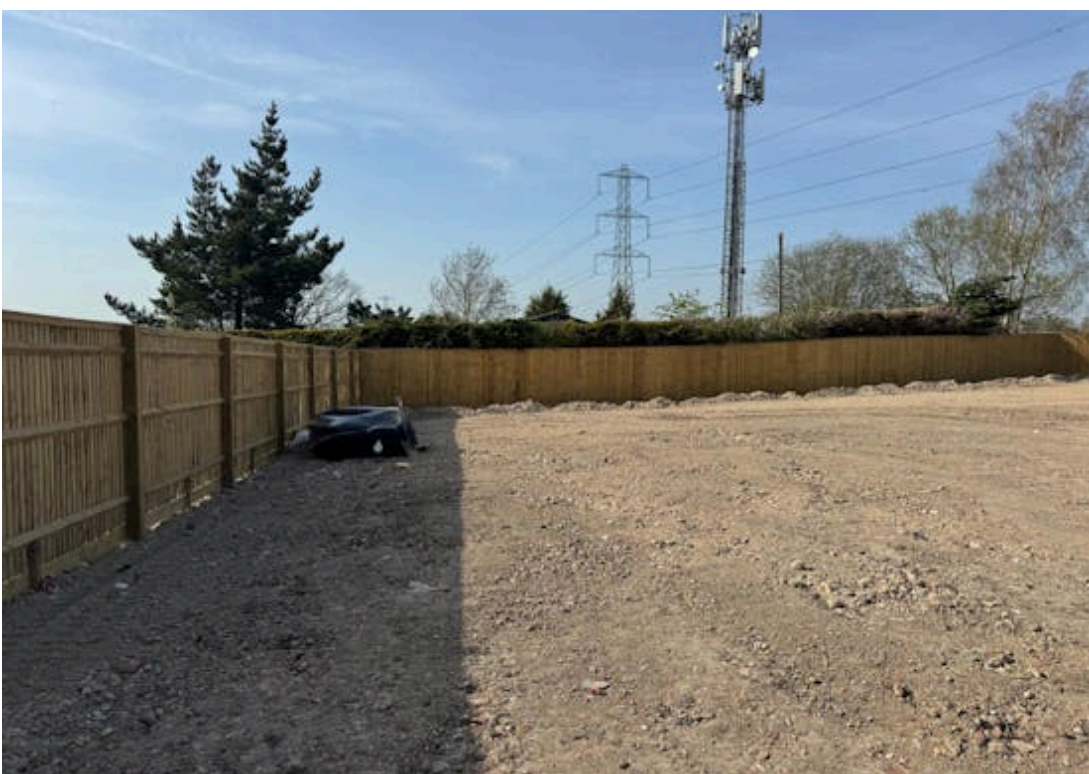

H.M. LAND REGISTRY		TITLE NUMBER
		BM 149087
ORDNANCE SURVEY PLAN REFERENCE	SP8209 SP8309	Scale 1/2500
COUNTY	BUCKINGHAMSHIRE	DISTRICT AYLESBURY VALE WYCOMBE
		© Crown copyright 1990

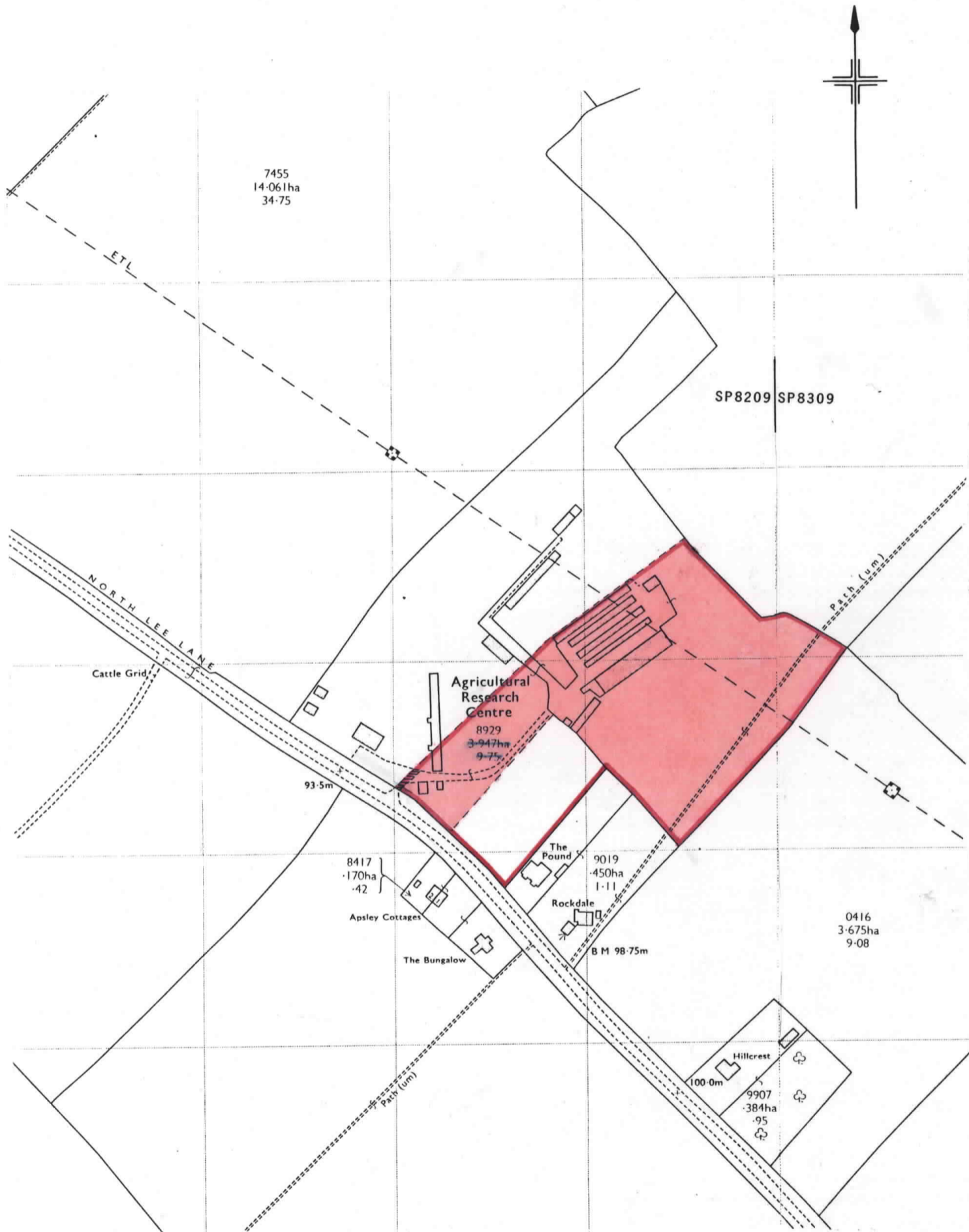

This is a print of the view of the title plan obtained from HM Land Registry showing the state of the title plan on 04 February 2026 at 16:50:48. This title plan shows the general position, not the exact line, of the boundaries. It may be subject to distortions in scale. Measurements scaled from this plan may not match measurements between the same points on the ground.

This title is dealt with by HM Land Registry, Leicester Office.

© Crown Copyright. Produced by HM Land Registry. Reproduction in whole or in part is prohibited without the prior written permission of Ordnance Survey. Licence Number AC0000851063.