

FOR SALE - LAND

BEITH ROAD

JOHNSTONE, PA5 0AZ



KEY HIGHLIGHTS

- 2.25 Acres
- Each unit = 1,668 SQ FT
- May be suitable for alternative uses, subject to planning
- Also benefitted from historic outline planning for a care home
- Full planning for 13 light industrial units
- Total developable GIA = 21,684 SQ FT
- Historically benefitted for planning from 26 residential units

SUMMARY

Available Size	2.25 Acres
Price	Offers in excess of £600,000 Offers are invited for our client's heritable interest with the benefit of the existing planning consent.
Business Rates	Upon Enquiry
EPC Rating	Upon enquiry

DESCRIPTION

Development opportunity with full planning consent for 13 x light industrial units

- Each unit = 1,668 SQ FT
- Total developable GIA = 21,684 SQ FT • Link to planning portal here [HERE](#)

Previous planning consents include;

- 26 residential units; 8 semi-detached houses and 18 flats
- Outline planning for nursing home

All planning queries should be made to Renfrewshire Council Planning Department on 0300 300 0144.

LOCATION

The subjects are located within Johnstone which is situated within the Renfrewshire Local Authority Region approximately 15 miles west of Glasgow City Centre.

More specifically the site is situated on the south side of Beith Road opposite West Johnstone Learning Centre & Cochrane Castle Primary School.

The A737 is situated just 1 mile north that connects with the M8 at Glasgow Airport in turn connecting with the M74 and M77 beyond.

Nearby public transport links are provided with regular bus services operating on Beith Road whilst Milliken Park Railway Station is just a 10-minute walk north.

ACCOMMODATION

The accommodation comprises the following areas:

sq ft	sq m	Availability
98,010	9,105.43	Available
Total	9,105.43	

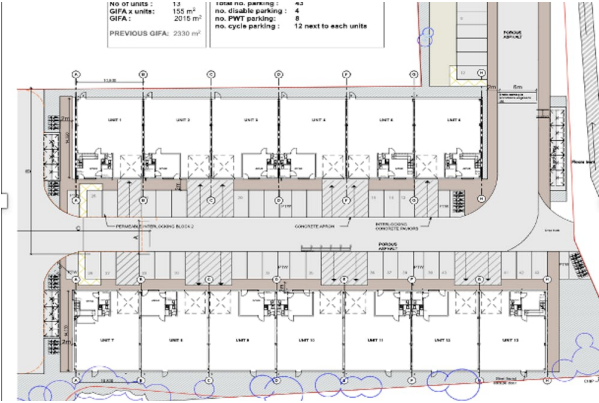
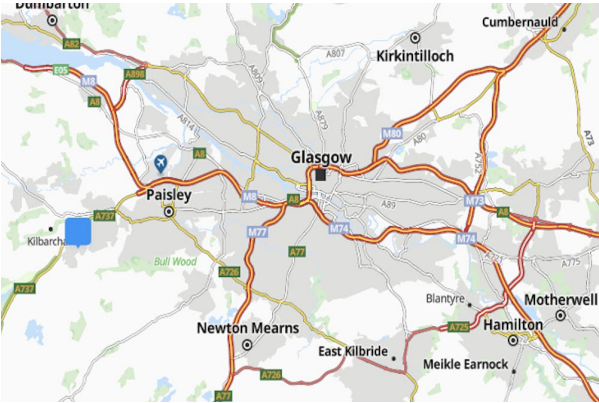
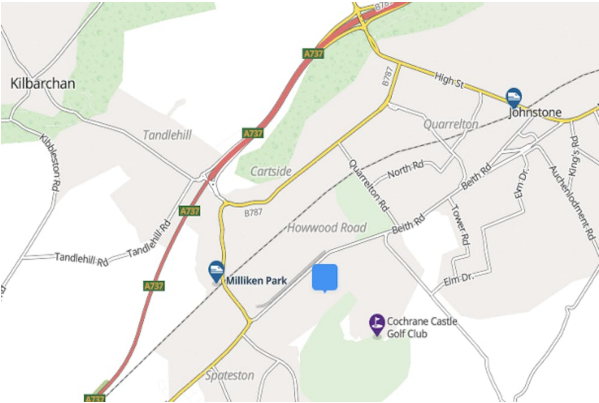
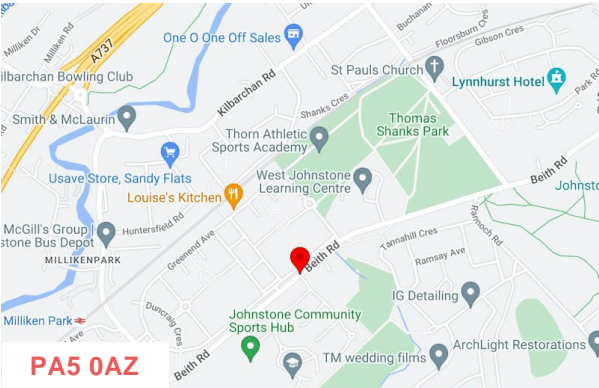

VIEWING & FURTHER INFORMATION

Gregor Brown

0141 212 0059 | 07717447897
gb@gmbrown.co.uk

G·M·BROWN