

To Let

WWW.ASDA.LIVE.JLL.COM CONCESSION UNIT AVAILABLE

Ferry Road Cardiff Bay Retail Park, Cardiff, CF11 0JR



Summary

Rent	£24,300 per annum
Business Rates	Upon Enquiry
Service Charge	Upon Enquiry
EPC	Property graded as D-E (Unit 1 - D (97), Unit 2 - E (121))

Key points

- Upon Instructions of Asda
- Prime location within the Asda store.
- Suitable for food use.

Location

The unit is within the Asda Superstore, located within the Cardiff Bay Retail Park and in close proximity to the International Sports Village. Situated at the entrance to the Cardiff Bay Retail Park makes it particularly prominent to traffic travelling in both directions on the A4232. Access to the motorway network is via the A4232 accessed via the roundabout, with Cardiff City Centre located circa 2.5 miles away accessible via a number of routes.

Accommodation

The property comprises a ground floor retail unit located to the right hand side of the entrance to the Asda Superstore fronting the car park.

Floor/Unit	sq ft	sq m
Ground	1,214	112.78

Nathank Chan

+447709 514101

nathank.chan@eu.jll.com

Mr Simon Watson-James (E J Hales)

029 2034 7112 | 07775 910991

simon@ejhales.co.uk

1. All dimensions to be checked on site and any discrepancy to be verified with the Store Partner before proceeding with the work.
2. DO NOT SCALE FROM THIS DRAWING.
3. Use this drawing for sizes and fixtures and stockpiling. When referencing refrigeration cabinets use the latest CBS drawing if the CBS drawing does not match this plan, please contact the Store Partner.
4. For all RGH areas please contact the Architect.
5. Exact position of all Bus Stop Signage to be positioned on site to suit the community as intended.

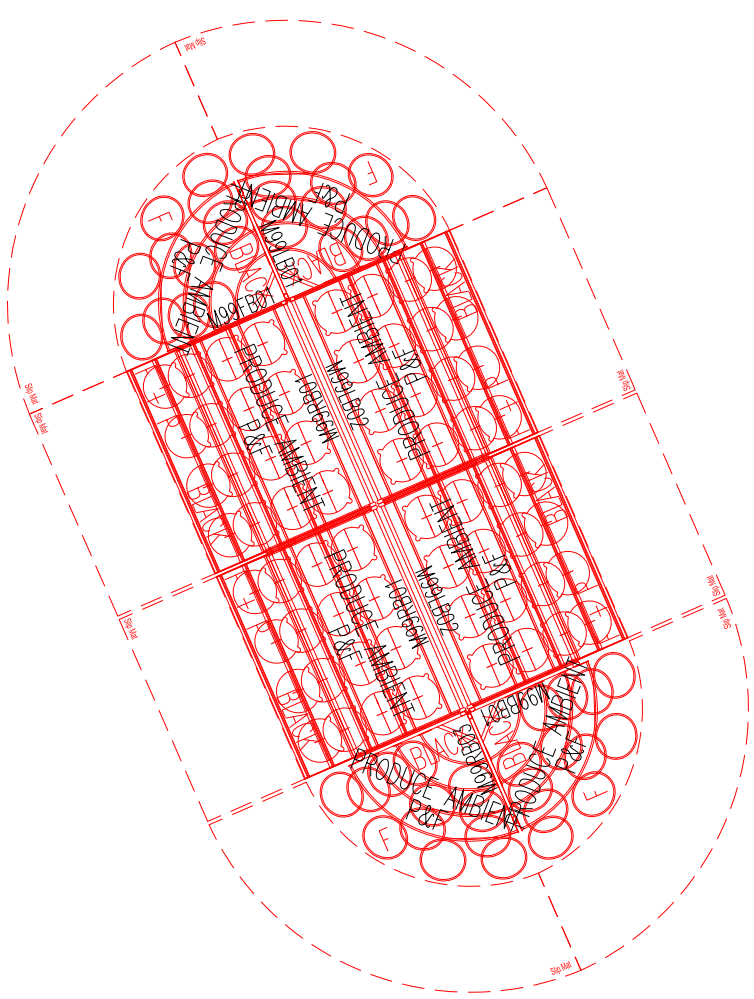

P&F NEW KIT

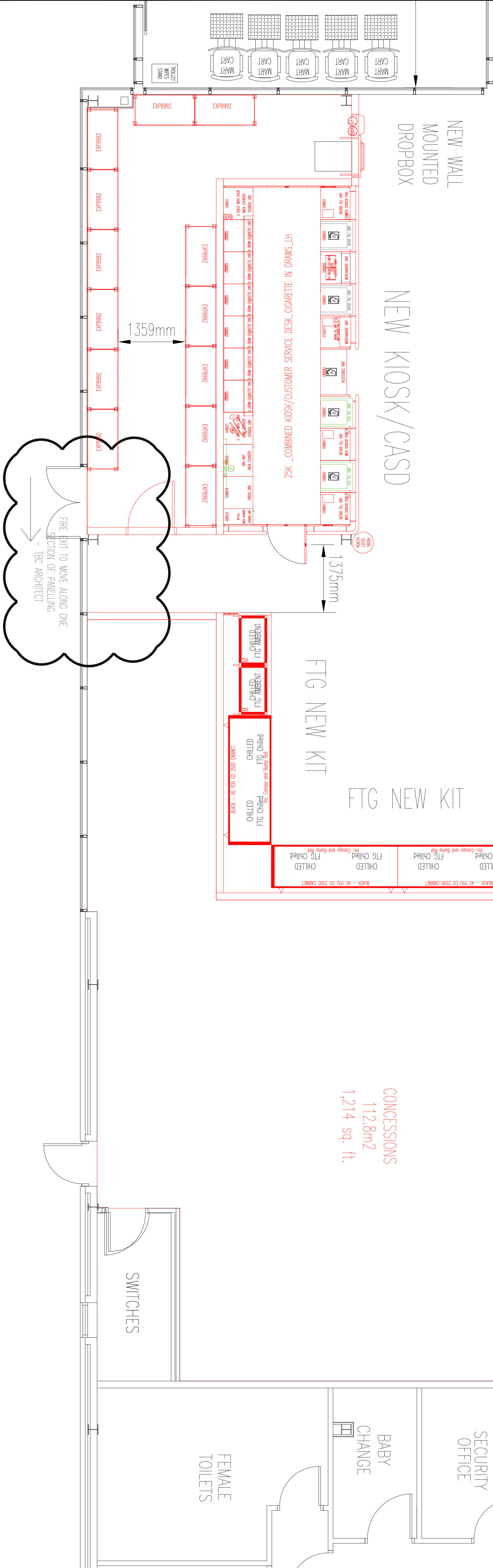
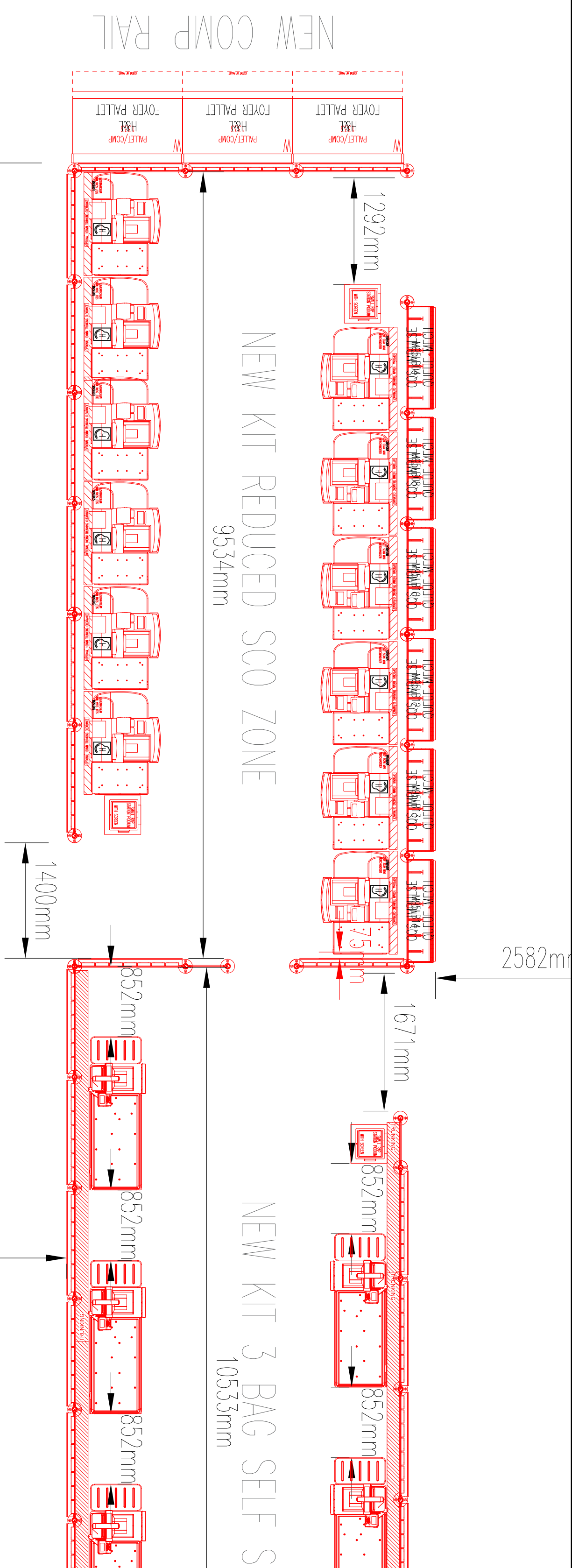
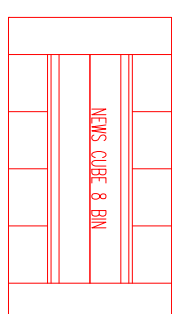

60031 sq ft	
Feet	
6'	66'
7'	76"
8'	86"
9	96"
10'	106"
11'	116"
12'	126"
13'	136"
14'	146"
15'	156"
16'	166"
mm	
1830	2000
	2100
	2300
	2400
	2600
	2700
	2900
	3000
	3200
	3300
	3700
	4000
	4200
	4600
	4800

KIT TYPE	BLOCK REFERENCE QUANTITY
ADDITIONAL KIT TO BE ORDERED BY FIRM THAT IS NOT SHOWN ON PLAN	

ASDA
Save money. Live Better

CARDIFF BAY

Scheme Type	
Ferry Road - Retail Park, Grange Town - Cardiff, CF11 0AR	

CARDIFF BAY REFRESH 2020

SAFT	REC	AMENDED	EXISTING
CARDIFF BAI REFRESH 2020			

SOFT	REC	AMENDED	EXISTING
Food Net	SOFT	SOFT	34634,264

Food Net	SOFT	SOFT	34634.2464	
GM Net	SOFT	SOFT	14785.7704	

GM Net	SQ-1	SQ-1	174,853,714
George Net	SQ-FT	SQ-FT	11630,502

George Mel	SOFT	SOFT	11000.0002	
Optical Mel	SOFT	SOFT	0	
Optical Mel	SOFT	SOFT		

Optical Test	SOFT	SOFT	0
Pharmacy Net	SOFT	SOFT	0
Pharm Spec Net	SOFT	SOFT	0

Phone Shop Mel	SOFT	SOFT	0
Mel Total	SOFT	SOFT	60350.5188

Net Total	SOFT	SOFT	60360,5188
Policy 107	SOFT	SOFT	71261,2216

Policy 107	SOFT	SOFT	71251.2216
Planning Cap			

Planning Cap		
Gross Footage		Ratio

Gross Footage		Ratio	
Slide Planner	JAY LINKLATER-JOHNSON @ Asia		

Store Planner	JAY LINQUATER-JOHANSON @ Asja
Direct Number	0113 626 2290

Direct Number	0113 826 2290
RCM/Sponsor	RCM Sponsor @ Asda

HLN / Sponsor	HLN / Sponsor @ Asia
SUM	SUM @ Asia

SiO ₂	SiO ₂ 100%
CM	CM 100%
CM	CM 100%
CM	CM 100%

CM	CM @ <i>Company</i>
PM	PM @ <i>Company</i>
CM	CM @ <i>Company</i>

FM	FM @ Company
George Plimmer	George Plimmer @ George Plimmer

George Planner	George Planner @ George
Architect	Architect @ Conway

Architect	Architect @ Company
Drawing Number	

Drawing Number
SP-GE-RE-4148SP-GT-RE-4148
Floor

Floor

GROUND FLOOR

GROUND FLOOR

FEASIBILITY: CONCESSIONS

Scale	1-10	Date
FEASIBILITY- CONCESSIONS		

Scale	N/A	Date	11/11/2011
-------	-----	------	------------