



## 455 Uxbridge Road, Hatch End

Pinner, HA5 4JS

### Fully Fitted Restaurant In A Prominent Retail Position - Lease for sale

**1,370 sq ft**

(127.28 sq m)

- Fully fitted restaurant
- Italian concept
- Prominent position on Hatch End High Street
- Substantial fit out ready for immediate occupation
- Walk in fridge and dry storage
- Fully fitted bar

# 455 Uxbridge Road, Hatch End, Pinner, HA5 4JS

## Summary

Available Size	1,370 sq ft
Rent	£39,000 per annum
Business Rates	Upon Enquiry
VAT	Not applicable
Legal Fees	Each party to bear their own costs
EPC Rating	B

## Description

The premises comprises a fully fitted restaurant situated on the main road through Hatch End. The fittings are of a high quality throughout and are ready for use by a prospective tenant. The kitchen is modern and well maintained with a large walk in fridge and an extension for dry storage to the rear of the property.

## Location

The property is located on Uxbridge Road within walking distance (0.3 mi) of Hatch End Overground Station. The building is positioned in a prominent location in the heart of Hatch End on a busy retail parade. Customer parking is available by way of on street pay and display as well as Grimsdyke Car park which is opposite the subject premises.

## Accommodation

The accommodation comprises the following areas:

Name	sq ft	sq m	Availability
Ground - Restaurant	663	61.59	Available
Ground - Kitchen	494	45.89	Available
<b>Total</b>	<b>1,157</b>	<b>107.48</b>	

## Terms

The premises are available by way of a sublease, subject to the landlords consent. The current passing rent is £34,000 per annum with an upcoming rent review on 8 October 2027. The lease was granted inside of the Landlord & Tenant Act 1954 and therefore the tenant would have the right to renew the lease at the end of the term.

## Premium

A premium is being sought to benefit our client's existing lease, fixtures, fittings, and associated goodwill. The premium has been set at £160,000.

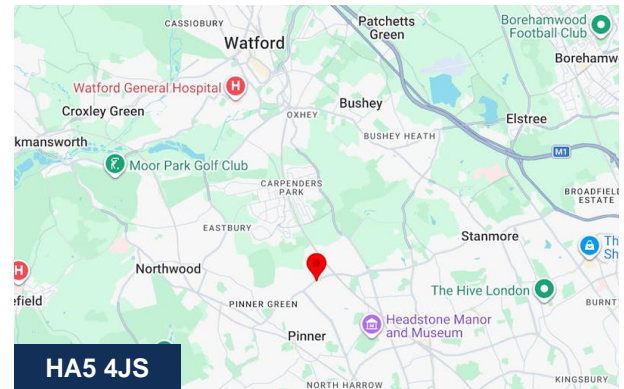

## Viewing & Further Information



Tom O'Malley

020 8429 9005 | 07522 700 508

tom@davidcharles.co.uk

The above information contained within this email is sent subject to contract. These particulars are for general information only and do not constitute any part of an offer or contract. All statements contained therein are made without responsibility on the part of the vendors or lessors and are not to be relied upon as statement or representation of fact. Intending purchasers or lessees must satisfy themselves, by inspection, or otherwise, as to the correctness of each of the statements of dimensions contained in these particulars. Generated on 10/04/2026





# Uxbridge Road, Pinner, HA5



Approximate Area = 1370 sq ft / 127.2 sq m

Outbuildings = 80 sq ft / 7.43 sq m

Total = 1450 sq ft / 134.7 sq m

For identification only - Not to scale

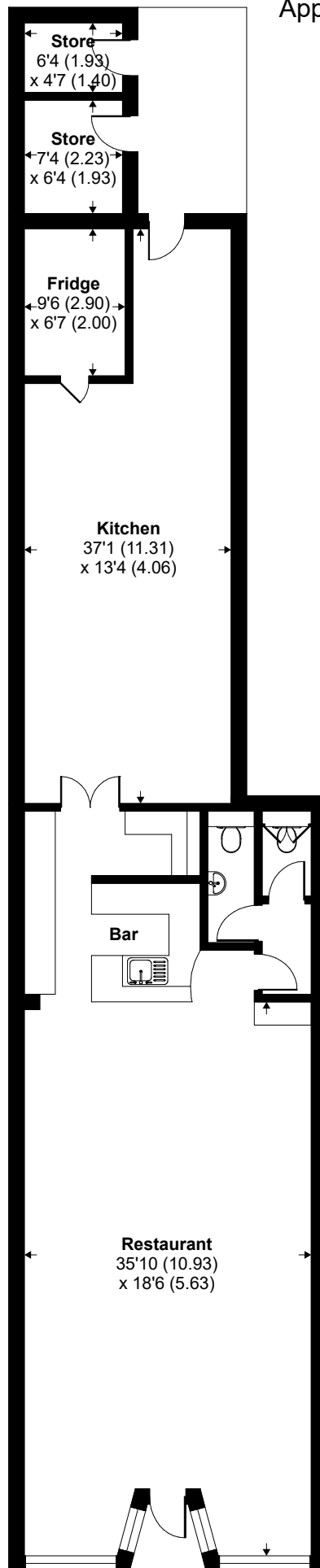

**GROUND FLOOR**