

SECTION A

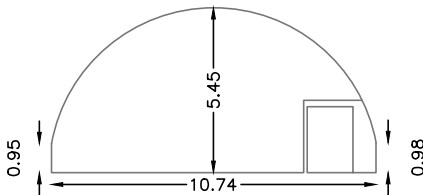

SECTION AA

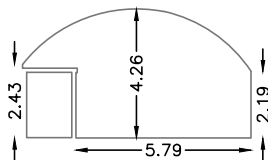

SECTION B

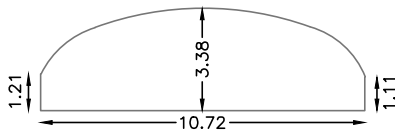

SECTION BB

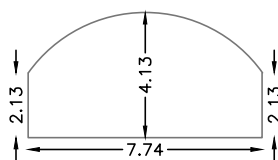

Property Ref: **BET06500**

Bethnal Green  
BETHNAL GREEN, E2 6JN



Rental Space Ref: **BET06505**

128 Three Colts Lane & 8A Cudworth Street, BETHNAL GREEN, E2

Net Internal Area

**NIA** **384.24 sq m** **4135 sq ft**

The following have been INCLUDED in the TOTAL NIA:

INT_RAI	1.24 sq m	13 sq ft
SLU_1	249.67 sq m	2687 sq ft
SLU_2	134.56 sq m	1448 sq ft

The following have been EXCLUDED from the TOTAL NIA:

INT_LOW	5.85 sq m	63 sq ft
INT_OTH	10.78 sq m	116 sq ft

Gross Internal Area

**GIA** **400.86 sq m** **4315 sq ft**

The following have been INCLUDED in the TOTAL GIA:

SLU_1	260.39 sq m	2803 sq ft
SLU_2	140.47 sq m	1512 sq ft

Land Area

**LAND** **212.55 sq m** **2288 sq ft**

The following have been INCLUDED in the TOTAL Land Area:

EXT_PED	169.64 sq m	1826 sq ft
EXT_VEH	42.91 sq m	462 sq ft

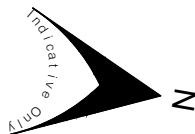

CUDWORTH STREET

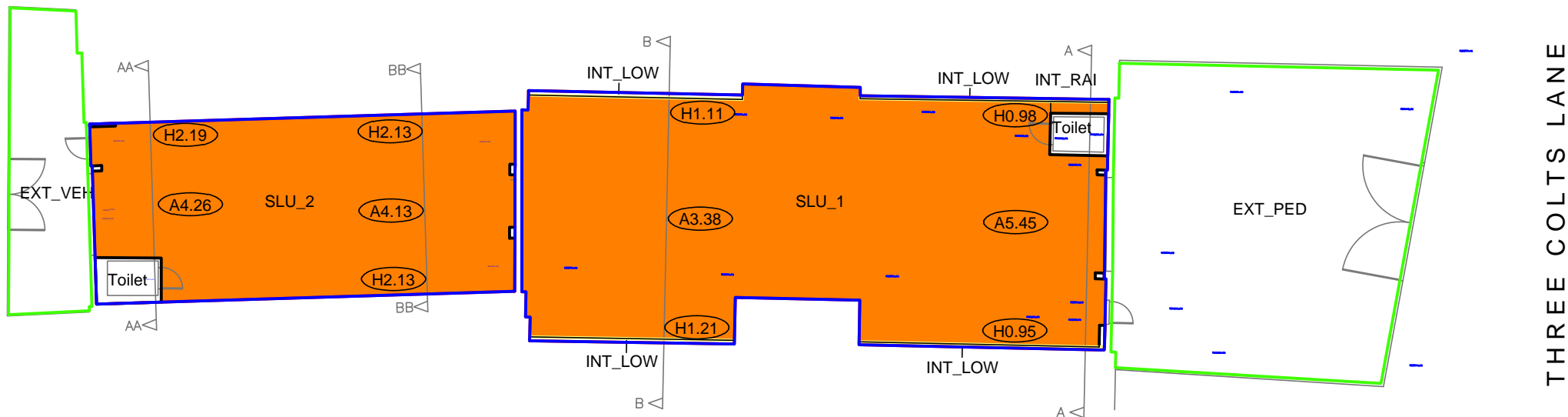

THREE COLTS LANE



Presentation Scale 1:250 @ A3

Notes:

This drawing complies with the RICS Code of Measuring Practice, 6th edition (September 2007) and the Globally applicable 6th Edition (May 2015). It indicates the extent of the areas quoted, produced to an accuracy commensurate with standard presentation scales. It is held in a scaled digital CAD format.

This drawing has been produced for area referencing purposes requested by the original commissioning agent and must not be used for any architectural or construction/engineering purposes or for any other purpose other than that for which it is originally intended. Plowman Craven Limited accepts no responsibility for details that are subsequently found to be the consequence of undisclosed facts or that were obscured from view at the time of survey or that have been altered since the date of survey.

This drawing contains Ordnance Survey data which has been reproduced with the permission of the Controller of Her Majesty's Stationery Office, Crown copyright 2020. The Ordnance Survey data has been obtained and reproduced by Plowman Craven Ltd in agreement with The Arch Company under Network Rail Licence Number 100040692.

Legend:

- Restricted Headroom
- H0.00 Haunch Height (m)
- A0.00 Arch Maximum Height (m)
- 0.00 Floor To Ceiling Height (m)

Revisions:

P01 - Original Issue (July 2024)

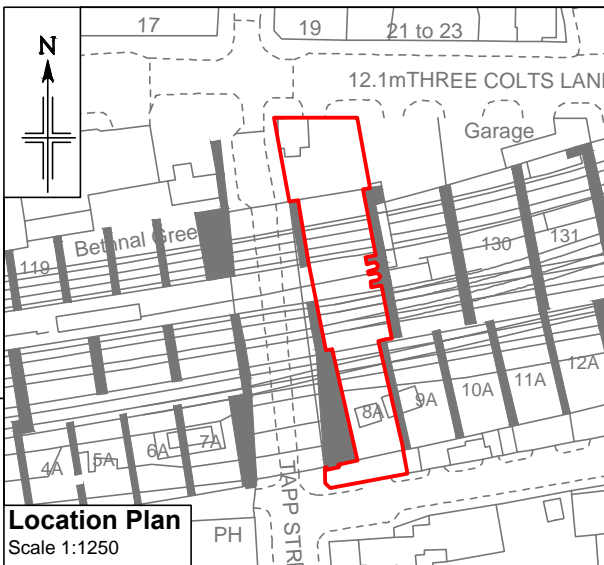

Dwg No.  
**43264-PCL-BET06505-GF-DR-G-00001\_Master-S6-P01**

**Plowman Craven**  
Regulated by RICS

