



32 Doe Meadow, Newburgh, WN8 7LZ

Price Guide £350,000



3



1



2



D



32 Doe Meadow

, WN8 7LZ

- Detached true bungalow
- Two bedrooms, two receptions and loft room
- Driveway, garage and rear garden
- Sought after location
- Open views to rear
- Requiring some update
- No chain

32 Doe Meadow is an attractive three bedroom bungalow offering good sized living accommodation with potential for remodelling and further updating if required. Set on a good sized plot with long driveway, garage and open views to the rear.



ACCOMMODATION COMPRISES;

ENTRANCE HALL

LOUNGE 16'8" x 11'5" (5.10m x 3.50m)

KITCHEN 16'8" x 10'9" (5.10m x 3.30m)

SUN ROOM/DINING AREA 7'11" x 10'9" (2.42m x 3.30m)

UTILITY ROOM 6'5" x 11'5" (1.98m x 3.50m)

BEDROOM 1

BEDROOM 2

BATHROOM

FIRST FLOOR ACCOMMODATION:

BEDROOM 3 23'5" x 11'7" (7.15m x 3.55m)





FRONT
REAR



Directions



Floor Plans

▼ Ground Floor

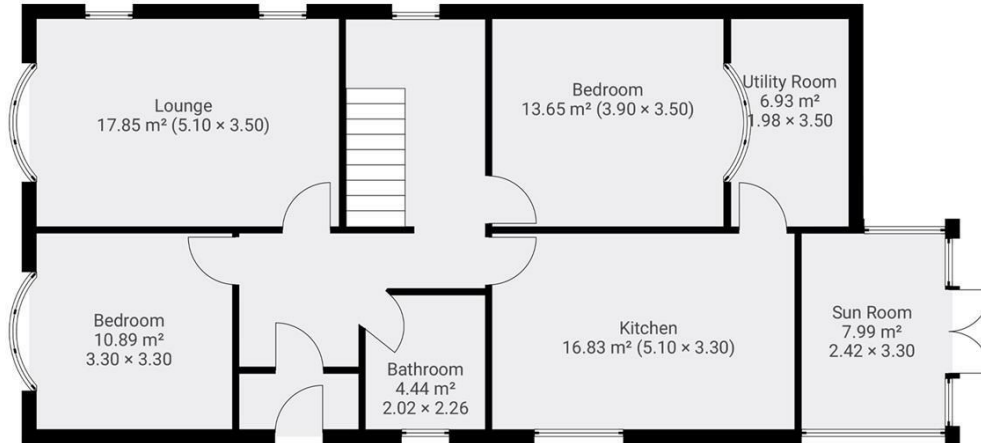

▼ 1st Floor

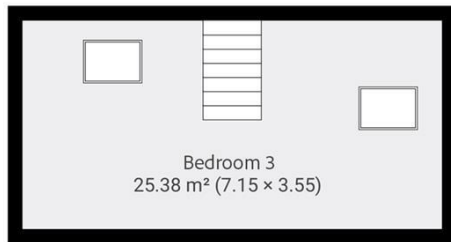

Total Area: 127.1 m²

Disclaimer: This floor plan is for illustrative purposes only and is not intended to be an exact representation of the property. All measurements, dimensions, and spatial relationships are approximate and should be independently verified. The layout, fixtures, and features depicted may differ from the actual property. This floor plan is not a substitute for a professional survey or architectural drawing. Angela Burnett & Co does not assume liability for any errors, omissions, or inaccuracies in this floor plan.

Location Map

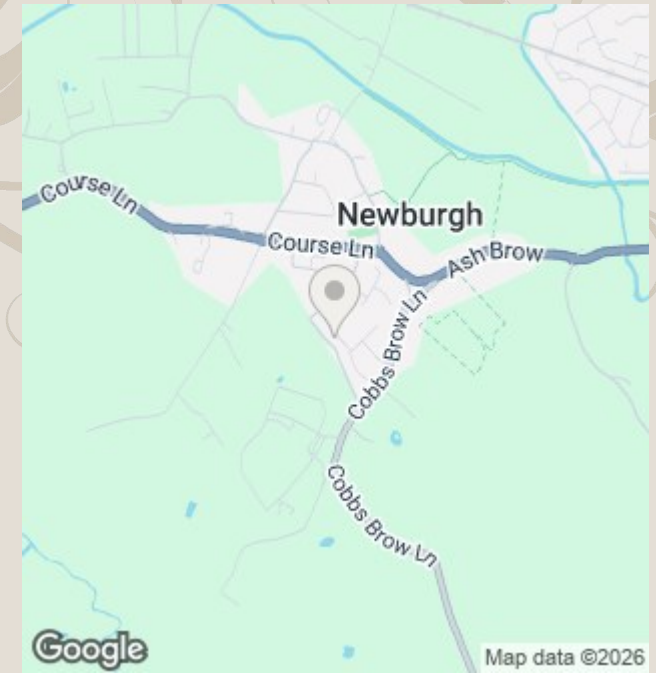

Energy Performance Graph

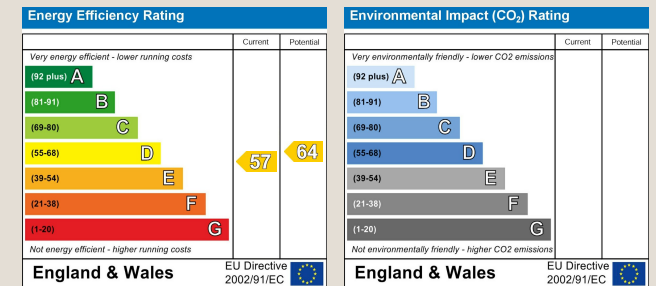

Property Specialists

Blacksmith's Barn Hall Lane, Mawdesley, Lancashire, L40 2QY Telephone: 01704 821393

Email: sales@angelaburnett.com www.angelaburnett.com

The particulars are set out as a general outline only for the guidance of intended purchasers or lessees, and do not constitute, any part of a contract. Nothing in these particulars shall be deemed to be a statement that the property is in good structural condition or otherwise nor that any of the services, appliances, equipment or facilities are in good working order. Purchasers should satisfy themselves of this prior to purchasing.