

# The Old Power Station, SW14

Approximate Gross Internal Area 30.5 sq m / 328 sq ft  
Approximate Net Internal Area (blue) 30 sq m / 323 sq ft

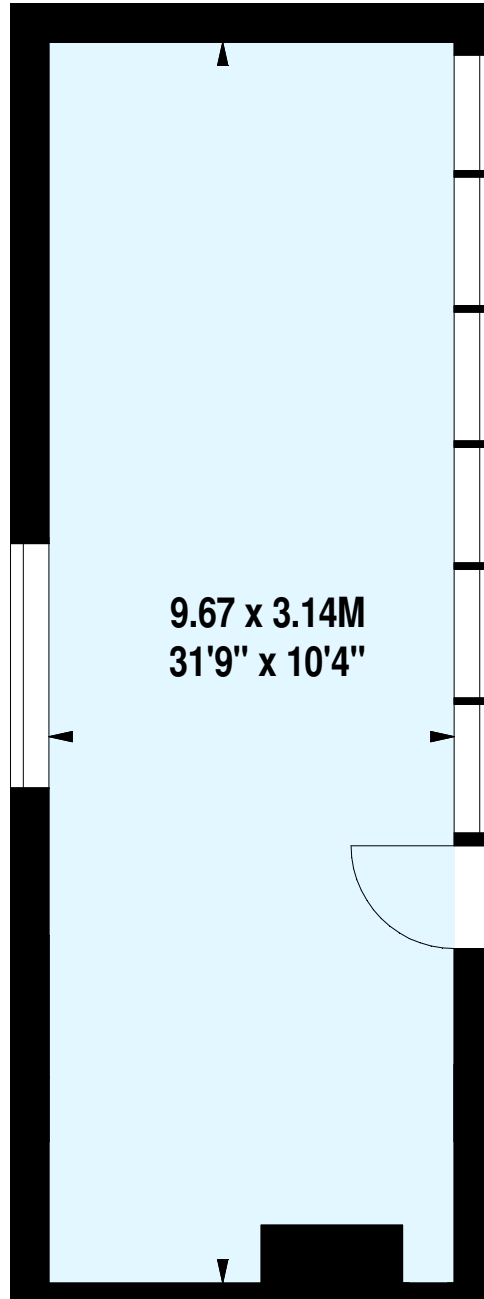
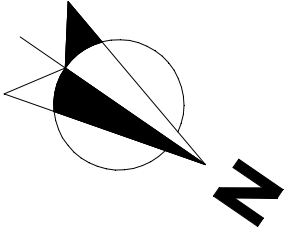

## First Floor

Floor Plan produced for Marston Properties by Mays Floorplans © . Tel 020 3397 4594

Illustration for identification purposes only, not to scale

All measurements are maximum, and include wardrobes and window bays where applicable