

FB80

FLAT BRACKET 80

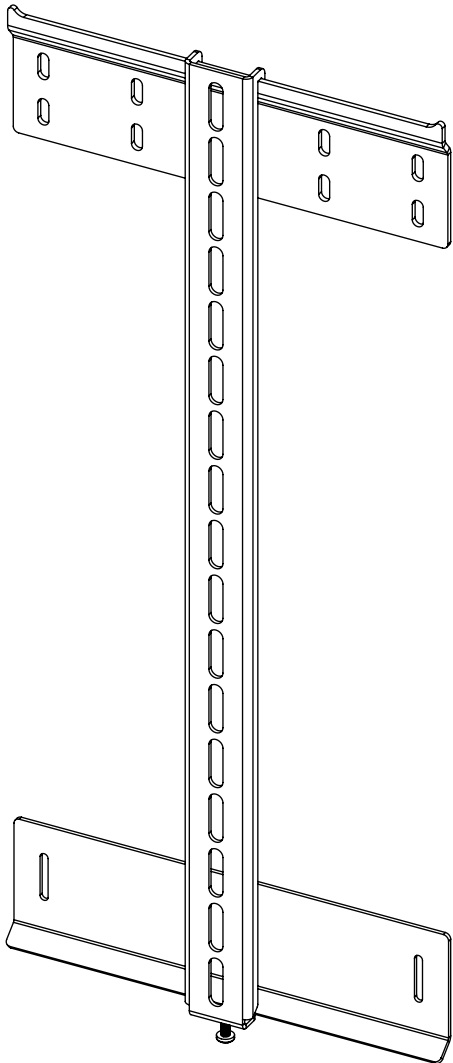

future automation

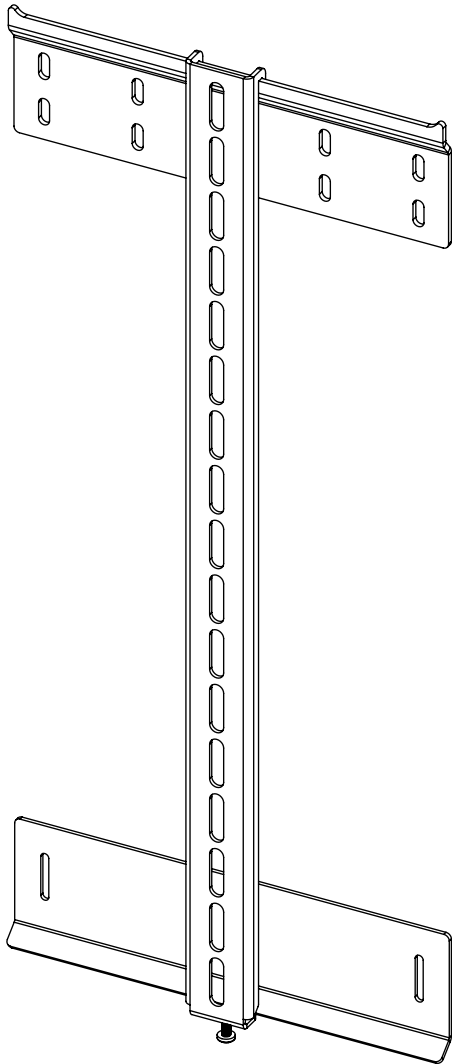

FB80

FLAT BRACKET 80



future automation

SPECIFICATION	MEASUREMENTS
Product Dimensions HxD	735mm (28.9") x 25mm (1.0")
Screen Sizes	80" - 100"
Maximum Weight Capacity	120Kg (265lb)
Product Weight	5.3Kg (11.7lb)
Packaging Dimensions	800mm (31.49") x 220mm (8.66") x 40mm (1.57")
Shipping Weight	6Kg (13lb)
Movement Type	Static
Package Contents	Mechanism
Marine Suitable	Yes (indoor)

FB80

FLAT BRACKET 80



future automation

DIMENSIONS

NOTE:
IT IS POSSIBLE TO INSTALL THE WALL BRACKETS SO THAT THE UPRIGHTS REST CENTRALLY ON THEIR RESPECTIVE WALL BRACKET.

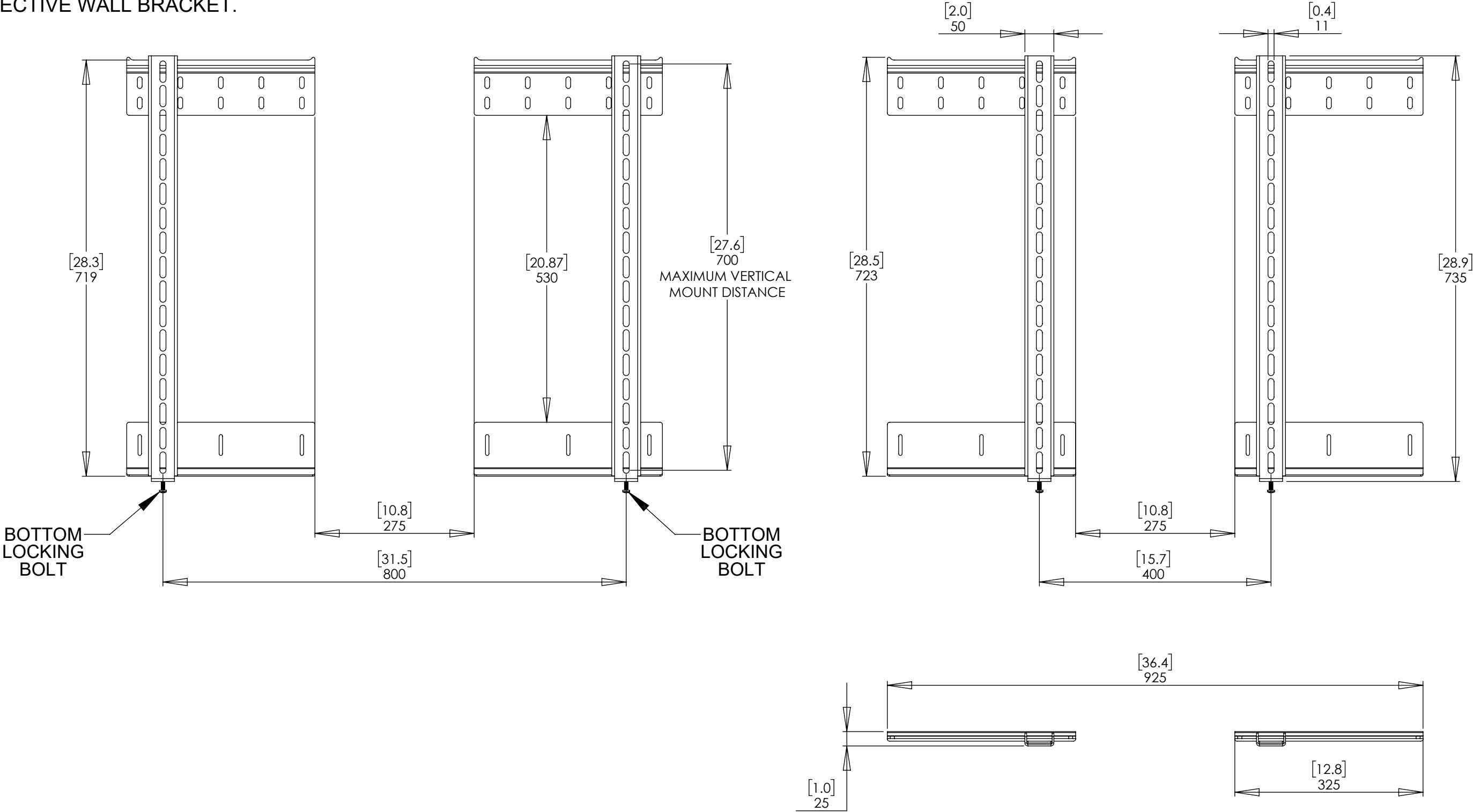

FB80

FLAT BRACKET 80



future automation

MOUNTING

WALL MOUNTS ARE ATTACHED ONTO THE WALL, WHILST UPRIGHTS ARE ATTACHED TO THE TV.

TV IS THEN HOOKED ONTO THE WALL PLATES AND ADJUSTED WITH BOTTOM BOLT.

REFER TO THE INSTRUCTION SHEET FOR DETAILS ON THIS.

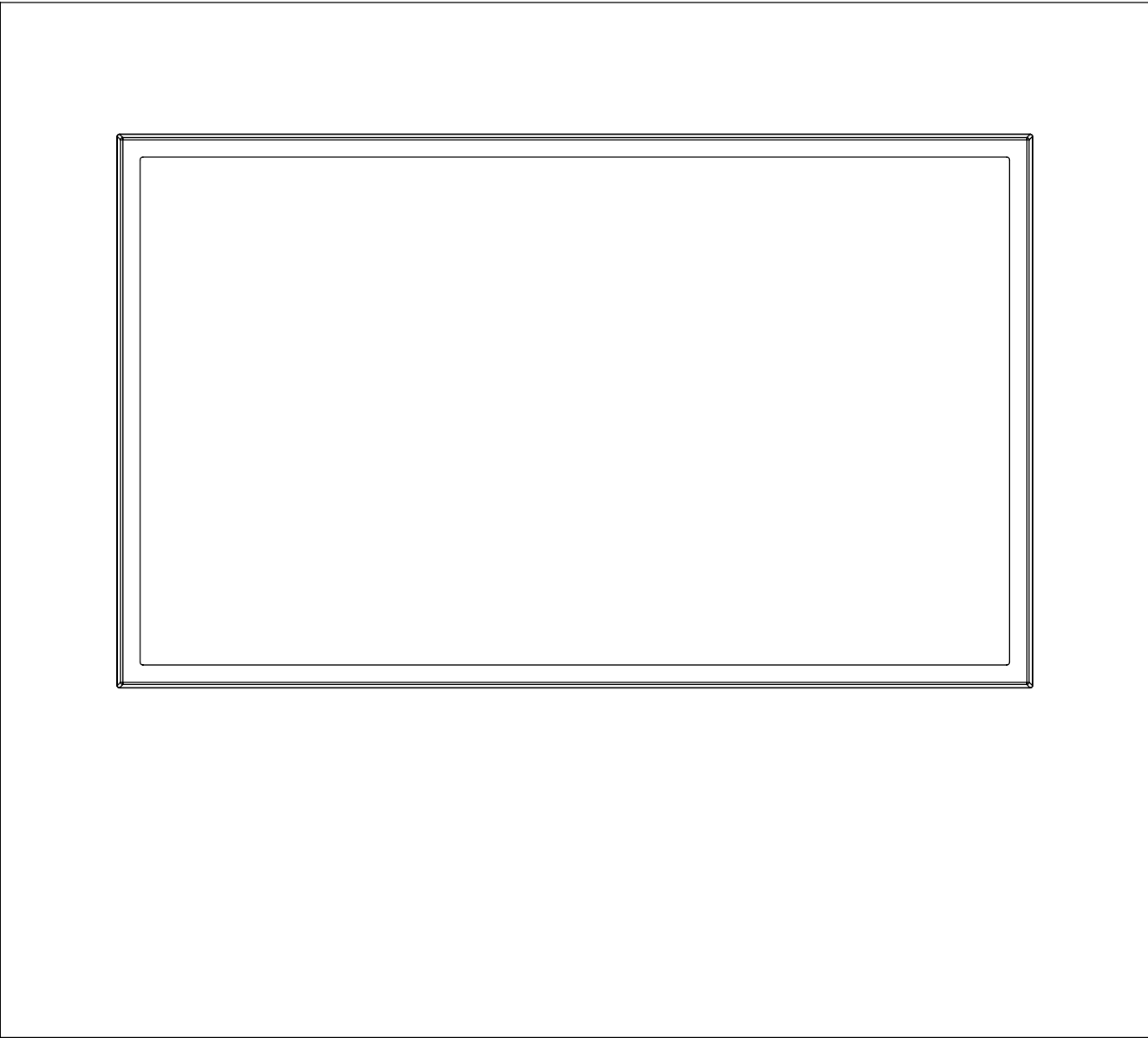
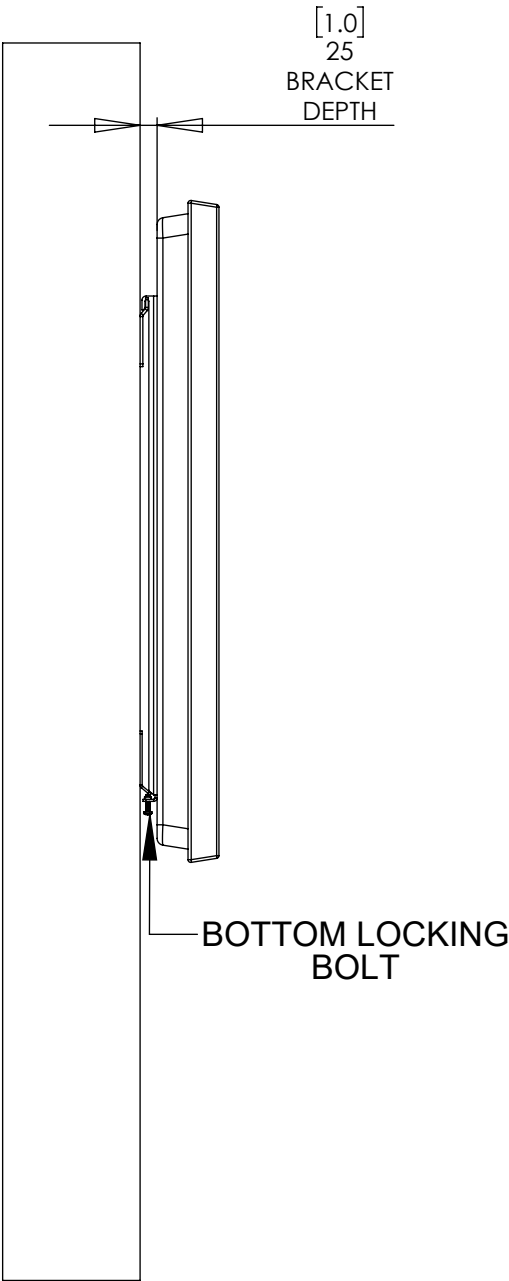

FB80

FLAT BRACKET 80



future automation

RECESS MOUNTING

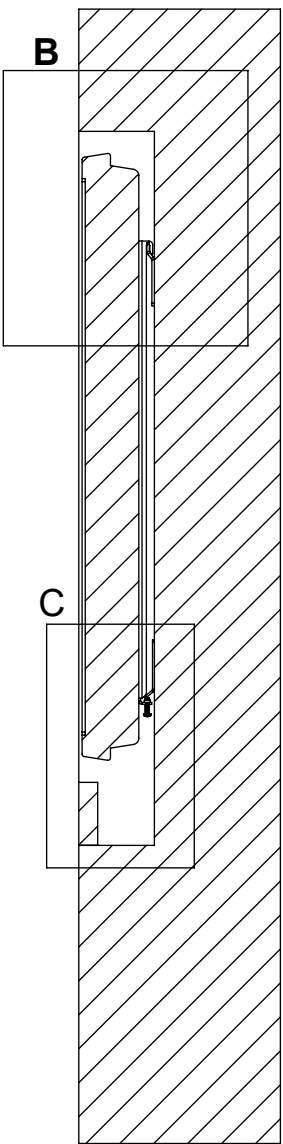
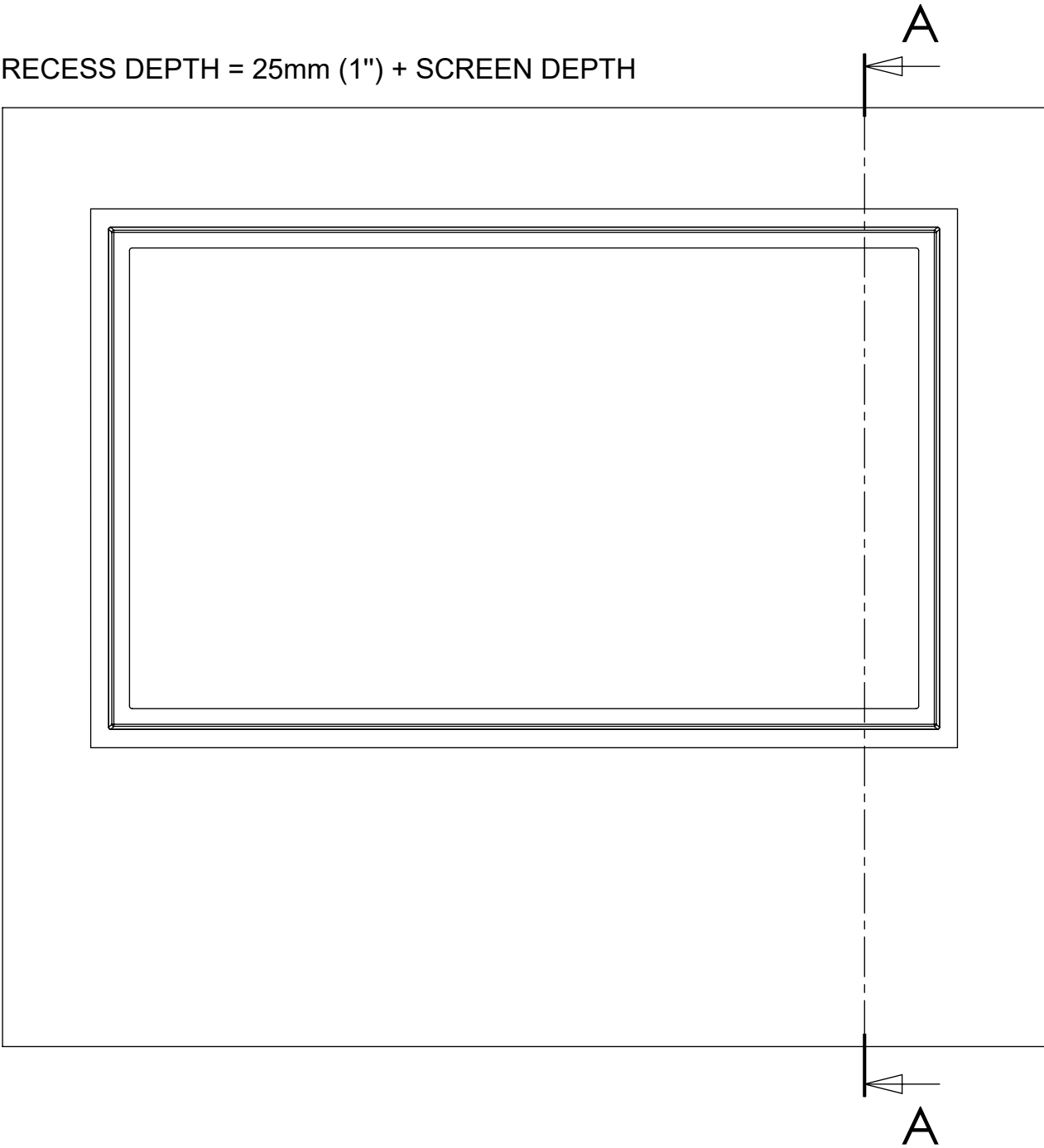

SECTION A-A

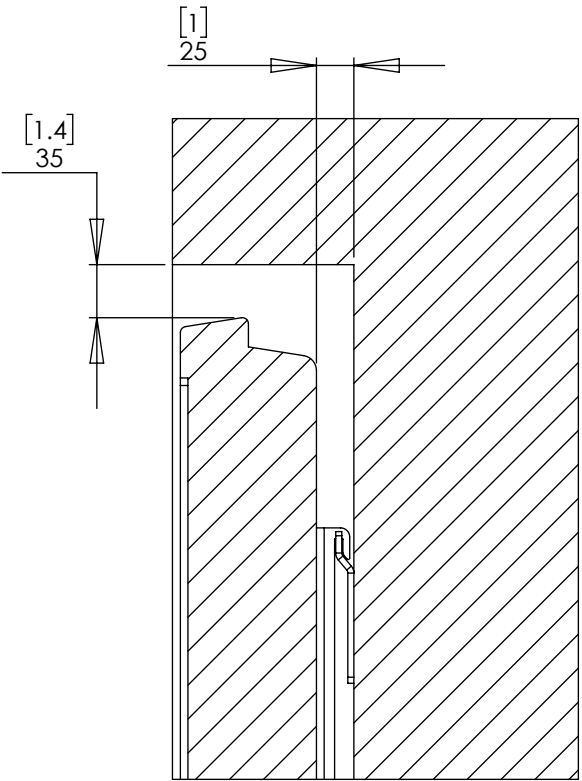

DETAIL B
SCALE 1 : 5

SUGGESTED 35mm (1.4")
GAP AROUND SCREEN
PERIMETER. HOOK OVER
SYSTEM REQUIRES 15mm
[0.6].

LARGER GAP MAY BE
NEEDED FOR EXTRA
VENTILATION DEPENDING
ON SCREEN TYPE.

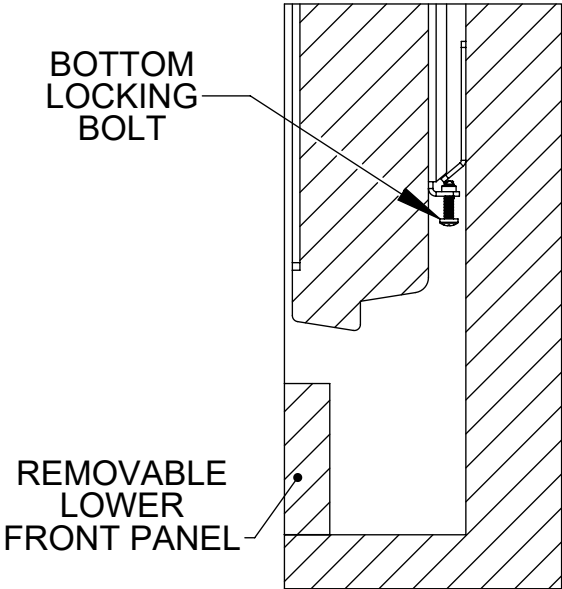

DETAIL C
SCALE 1 : 5

WHEN MOUNTING IN A
RECESS FOR MARINE
INSTALLATION,
ACCESS TO LOCKING
BOLTS IS ESSENTIAL.

A REMOVABLE PANEL
MAY BE REQUIRED.