



### DESIGN HIGHLIGHTS

- Quiet smooth action at approximately 30mm per second.
- Full cable management.
- Wide range of mounting options.
- Supplied with back mount cover and supports for top capping.
- DC motor.
- Different height options.

### OPTIONS

- Swivelling option
- Medium duty option

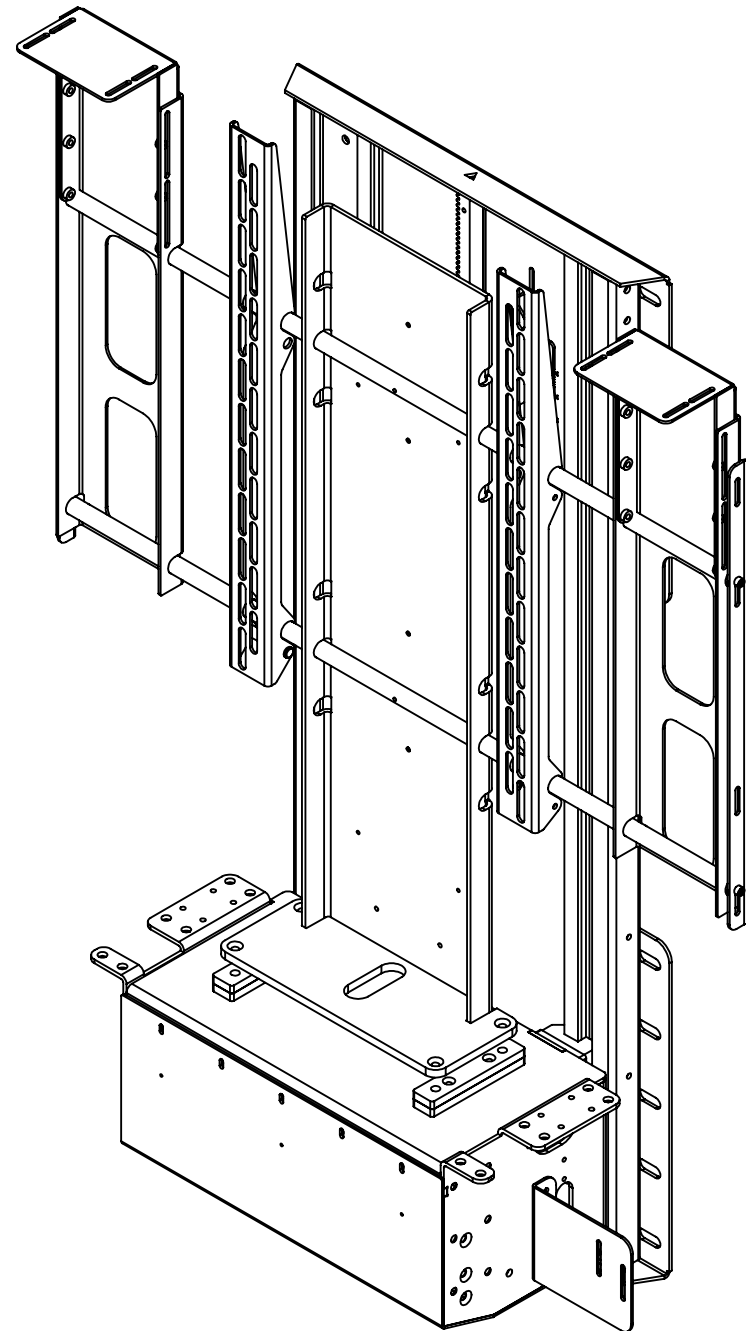

Mechanism Supplied as shown.

### WARNING

**It is the responsibility of the installer to warn all potential end users of the dangers of interfering with mechanisms during operation**

### IMPORTANT

**Mechanisms which lift or move weights need to be checked on a yearly basis for any damage which may result in an accident**

### FUNCTION

An electric mechanism to lift a flat screen television screen.

### SUITABILITY

Suitable for a total lifting weight of 100Kg.

### SPECIFYING

Check screen mounting details and request a suitable mount plate.

### CONTROL

Supplied with basic infrared remote. can be learnt by many learning remotes.

Also has switch control and RS232 so can be operated by relays, switches, Creston/AMX or Lutron systems.

FRONT ELEVATION - LIFT DOWN

**NOTE:**  
All cabinet parts shown are to be made by others and are not included with the lift supplied.

**IMPORTANT**  
GOOD FRONT ACCESS  
IS REQUIRED TO SET  
UP THIS MECHANISM

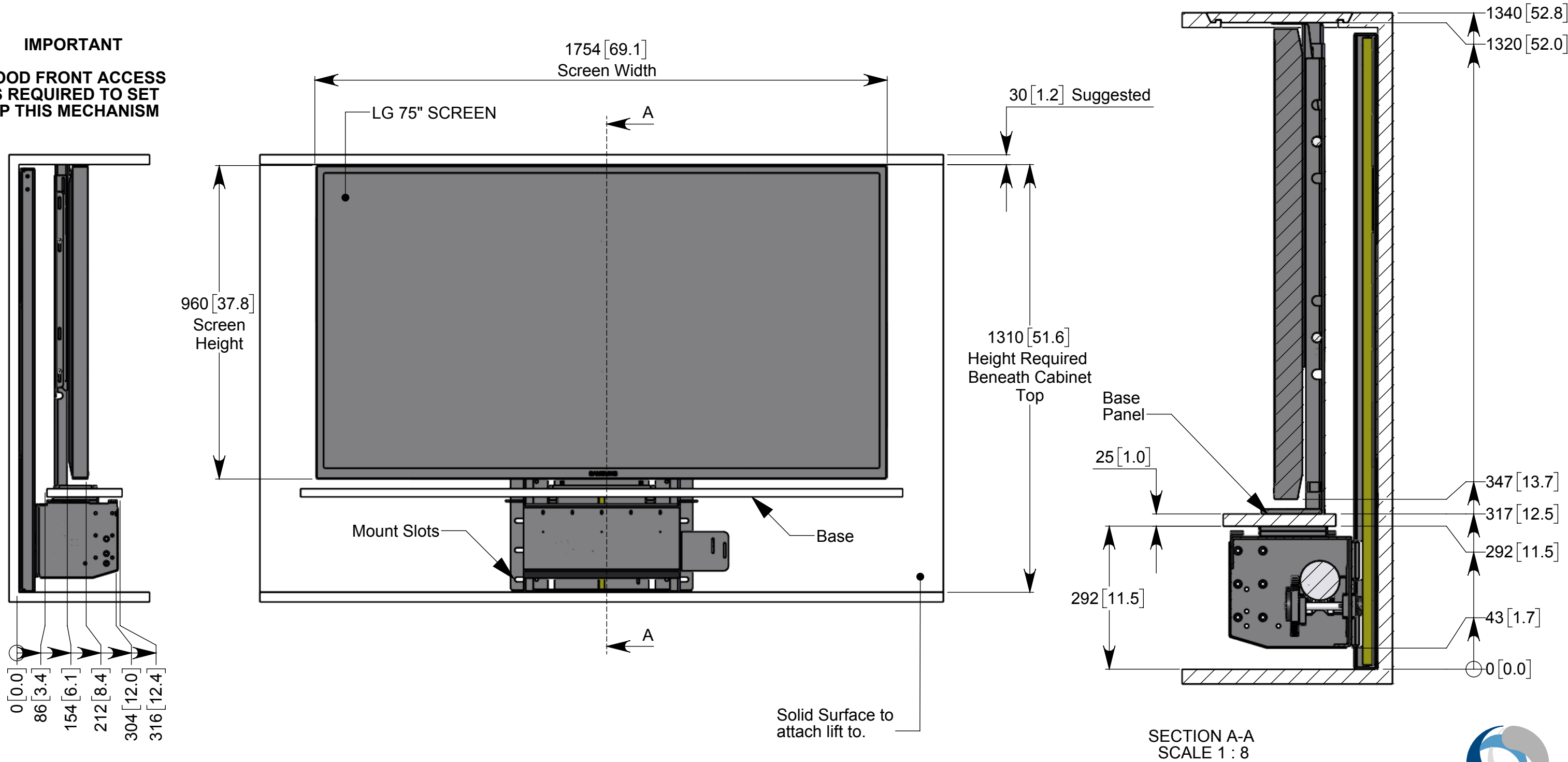

SCALE 1:12

FRONT ELEVATION - LIFT UP

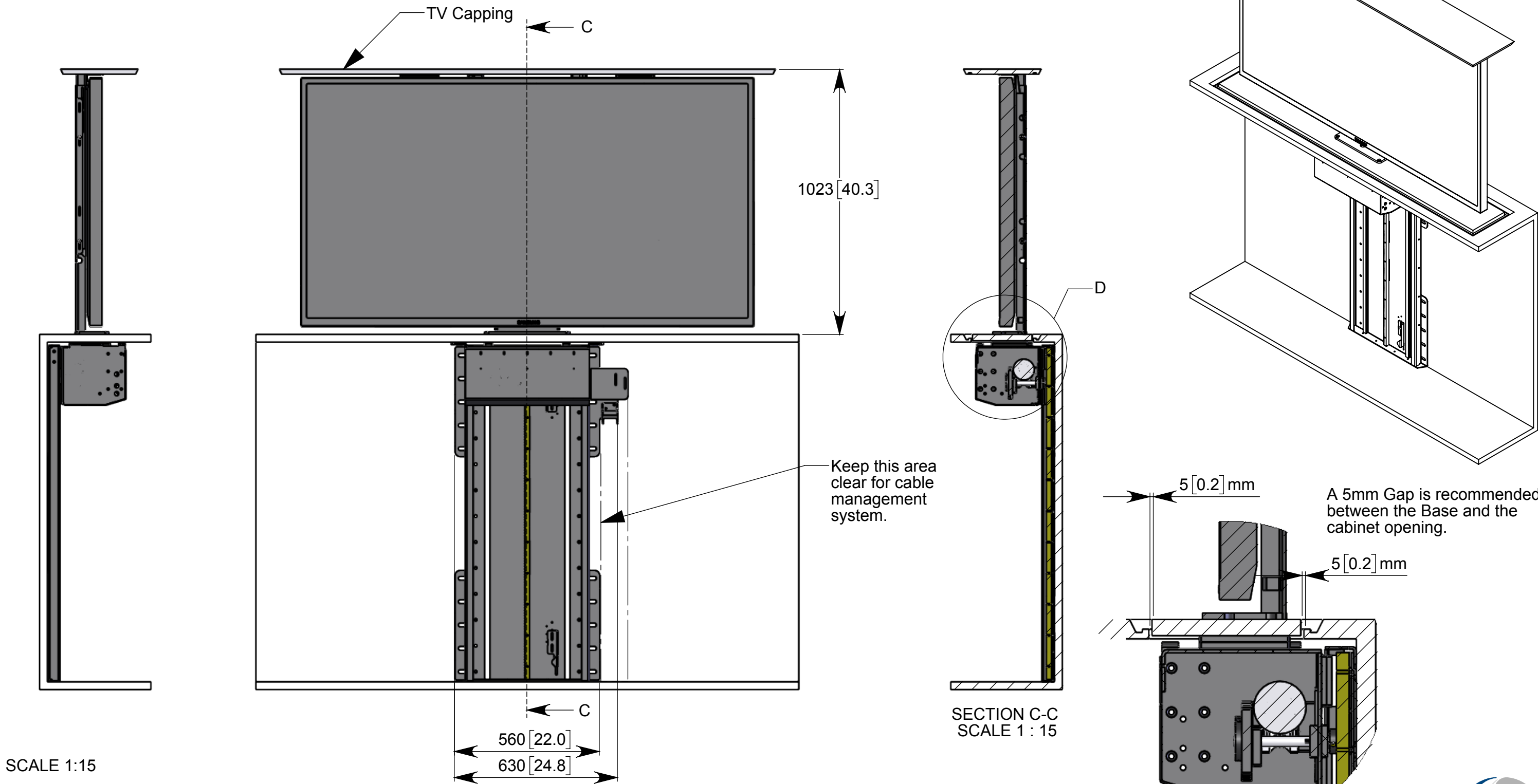

SCALE 1:15

See CAD for more  
Dimensions

Motors in the mechanism are all DC. A 3m flying lead back to a control box is supplied. Control box size is 200 x 150 x 55mm. The control unit has RS232, Infrared and Switch control inputs. Control box could be supplied by a 24V input if required or the 110 to 220V ac to DC power supply supplied. Power supply is 250mm wide x 170mm high and 130mm deep.

UP POSITION

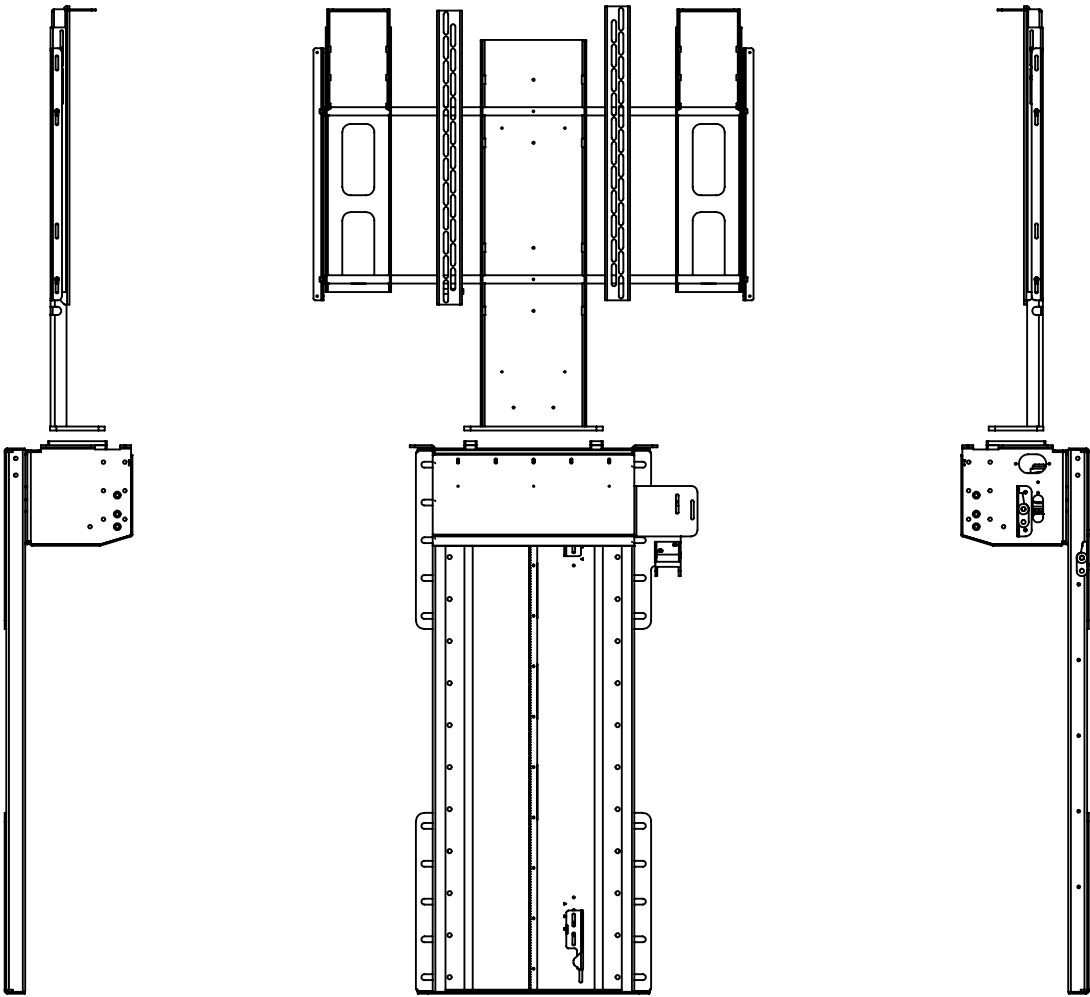

DOWN POSITION

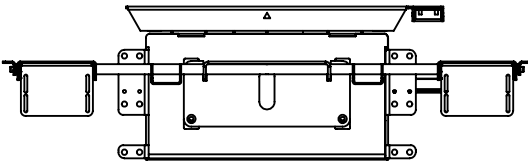

Adjustable lid  
brackets to support  
top cap.

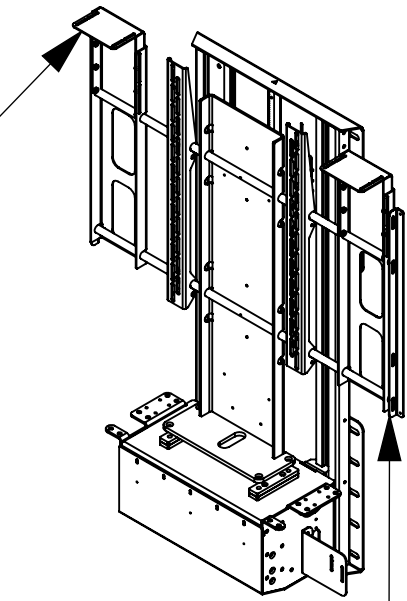

Side mount brackets to  
mount box enclosure to

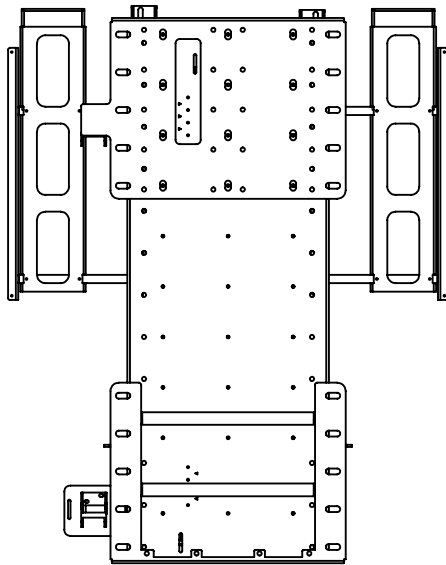
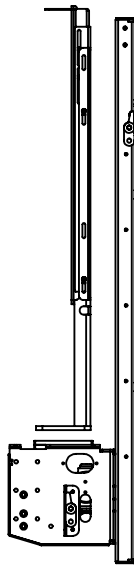
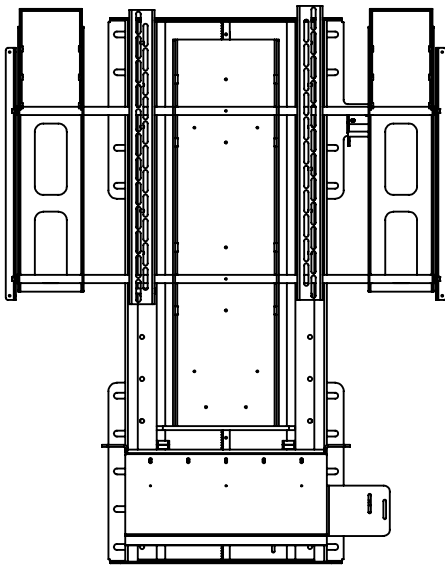
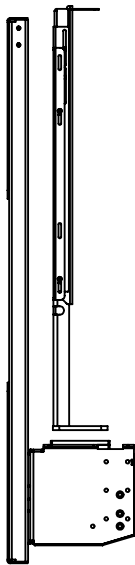

SCALE 1:18  
H1360 version shown with  
and back cover to suit an  
SAMSUNG 78"

See CAD for more Dimensions