

# PS40-MO

## MARINE OUTDOOR PULL & SWIVEL BRACKET

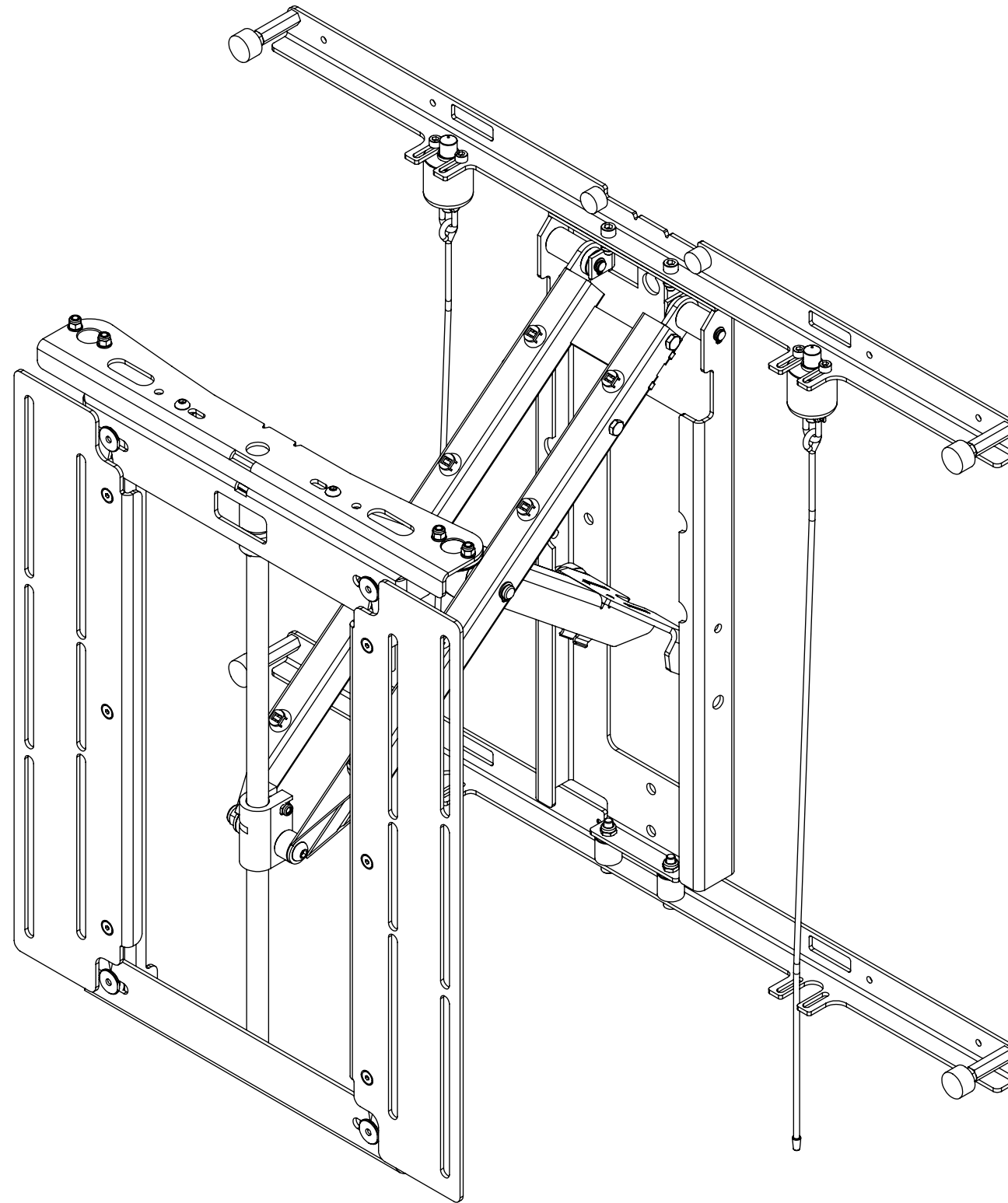

future automation



# PS40-MO

## MARINE OUTDOOR PULL & SWIVEL BRACKET



future automation

SPECIFICATION	MEASUREMENTS
Product Dimensions	557mm (21 15/16") x 700mm (27 9/16") x 56mm (2 3/16")
Screen Sizes	40" - 75"
Maximum Weight Capacity	60Kg (132lb)
Maximum Extension From Wall	400mm (15 3/4")
Depth From Wall	56mm (2 3/16")
Product Weight	11.5Kg (25.4 lb)
Packaging Dimensions	TBC
Shipping Weight	TBC
Maximum Rotation	45° - bi-directional with 43" screen - 38° with 55" - 32° with 65" - 27° with 75"
Movement Type	Manual
Mounting Patterns Supported	VESA 400, 300, 200 W x 400, 300, 200, 100 H
Product Options / Features	Specific B&O and Loewe mounts / adapters, Custom RAL paint finishes, Marine suitable version
Package Contents	Mechanism, cable routing bosses
Marine Suitable	Yes
Outdoor Suitable	Yes

# PS40-MO

## MARINE OUTDOOR PULL & SWIVEL BRACKET



future automation

### SCREEN ANGLES

THE VIEWS BELOW SHOW THE APPROPRIATE MAXIMUM SWIVEL ANGLES ACHIEVABLE FOR VARYING SCREEN SIZES.

**NOTE:** THE MAXIMUM SWIVEL ANGLE ACHIEVABLE IS 50° REGARDLESS OF THE SCREEN SIZE.

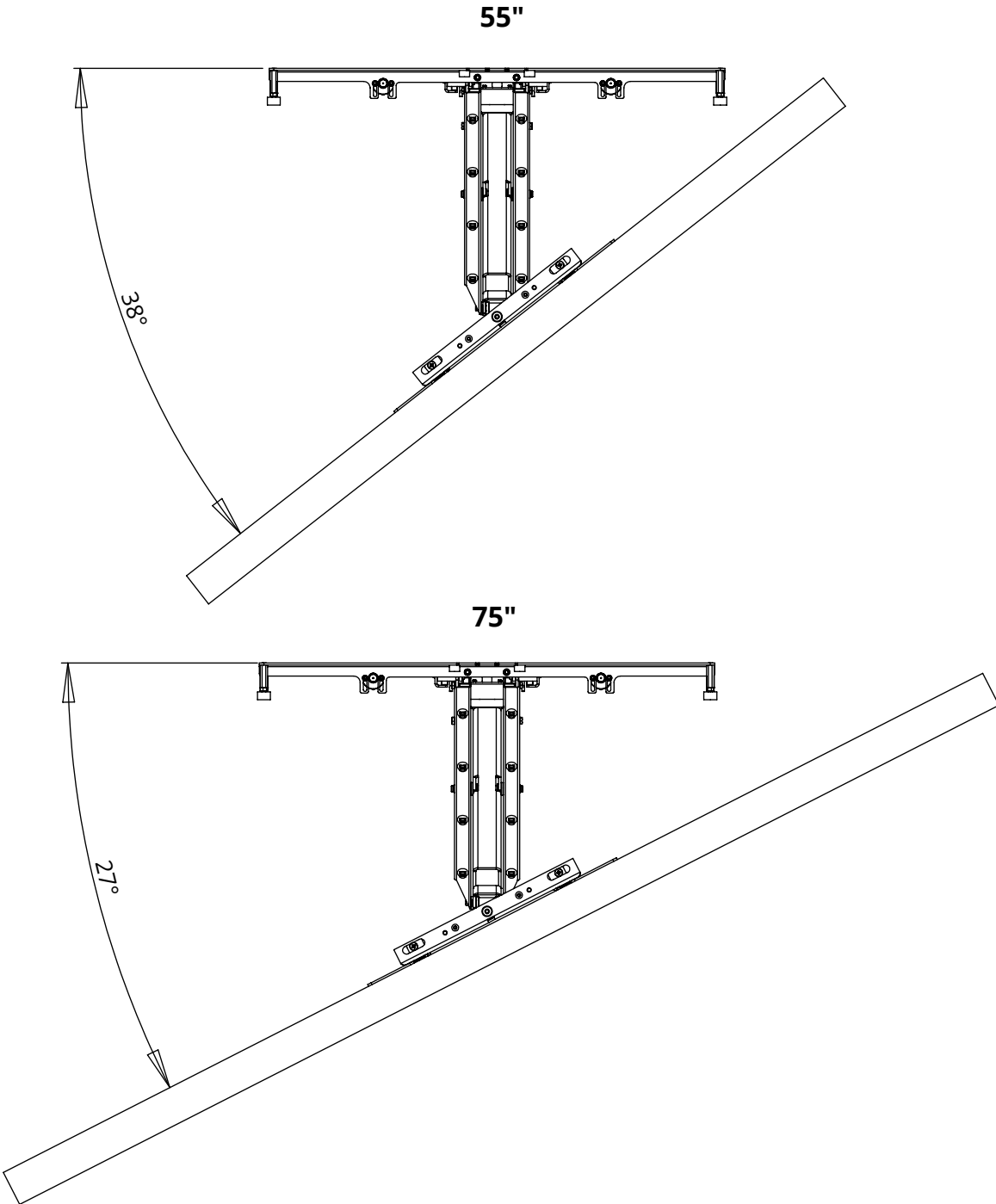
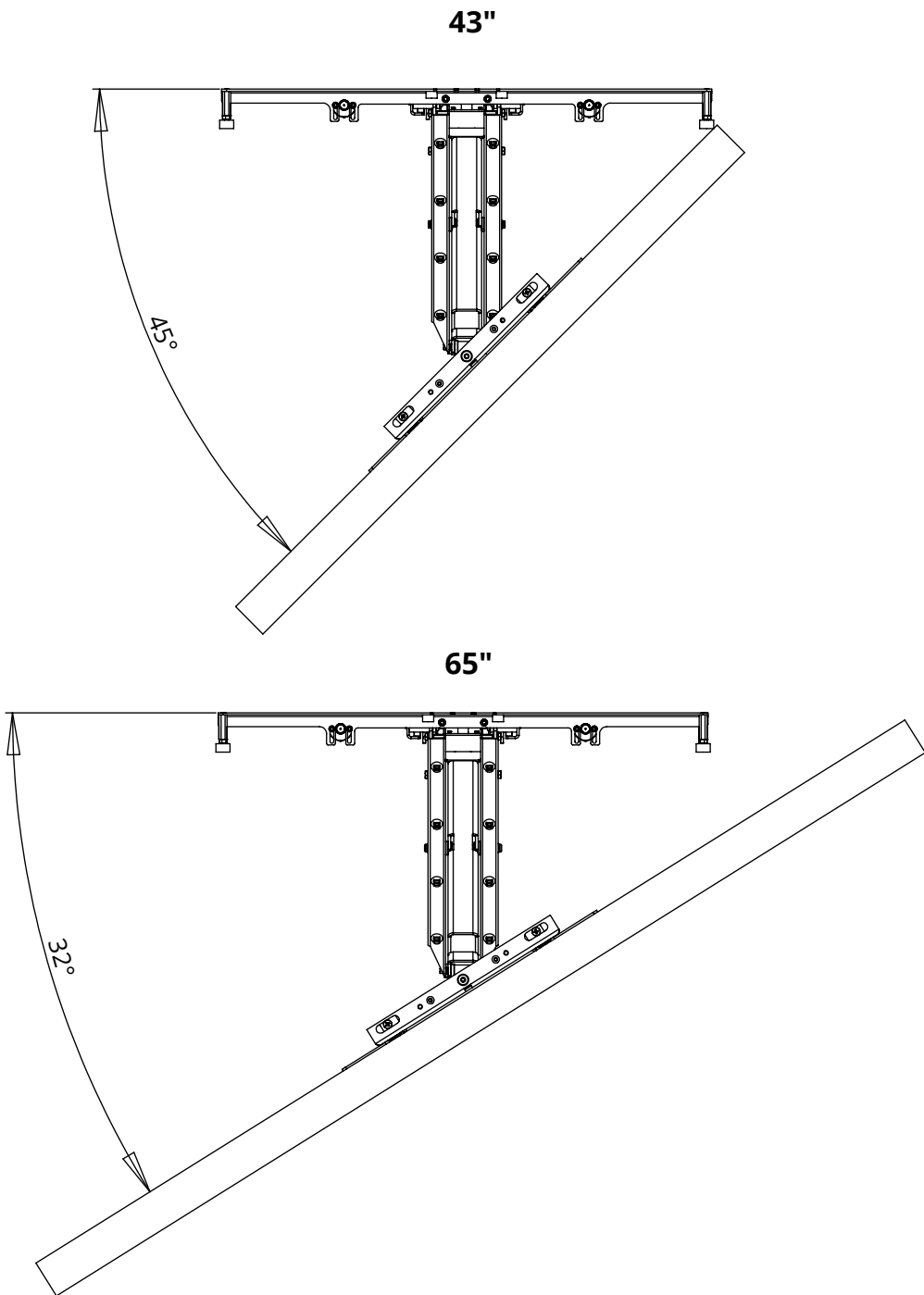

# PS40-MO

## MARINE OUTDOOR PULL & SWIVEL BRACKET

### GENERAL DIMENSIONS

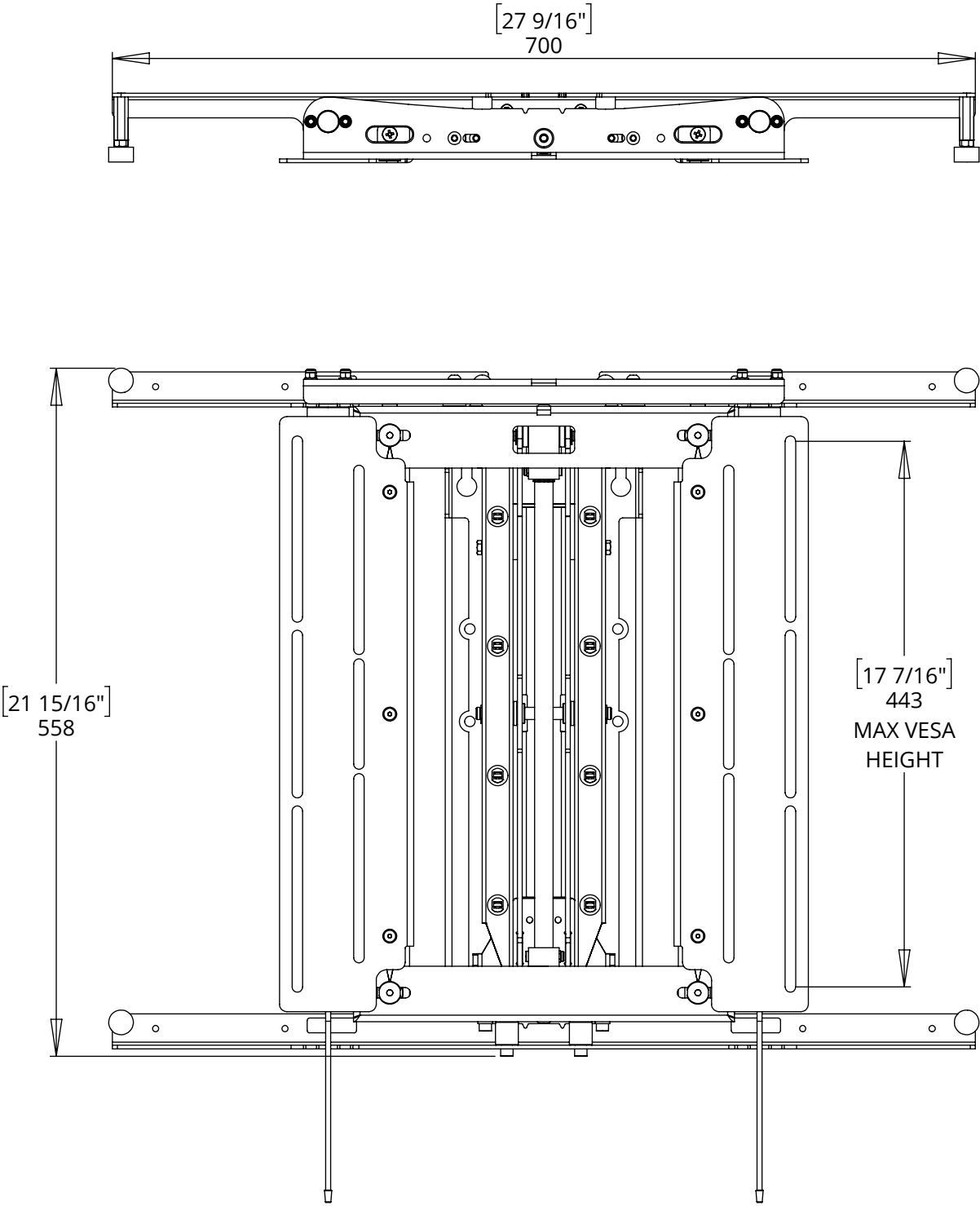

CLOSED POSITION

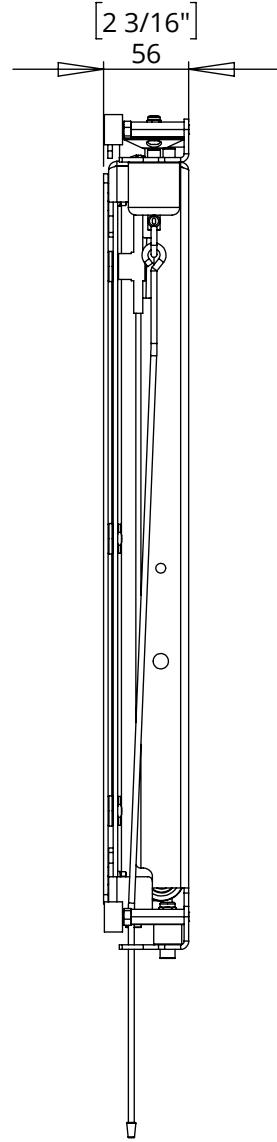

FULL EXTENSION

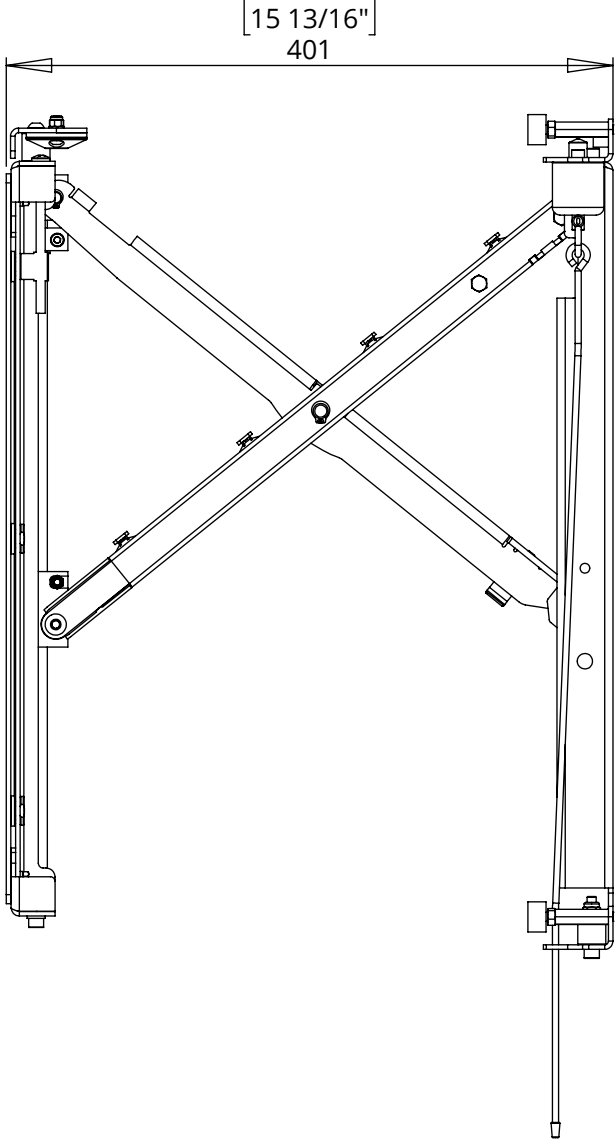

# PS40-MO

## MARINE OUTDOOR PULL & SWIVEL BRACKET



future automation

### CABLE ROUTING

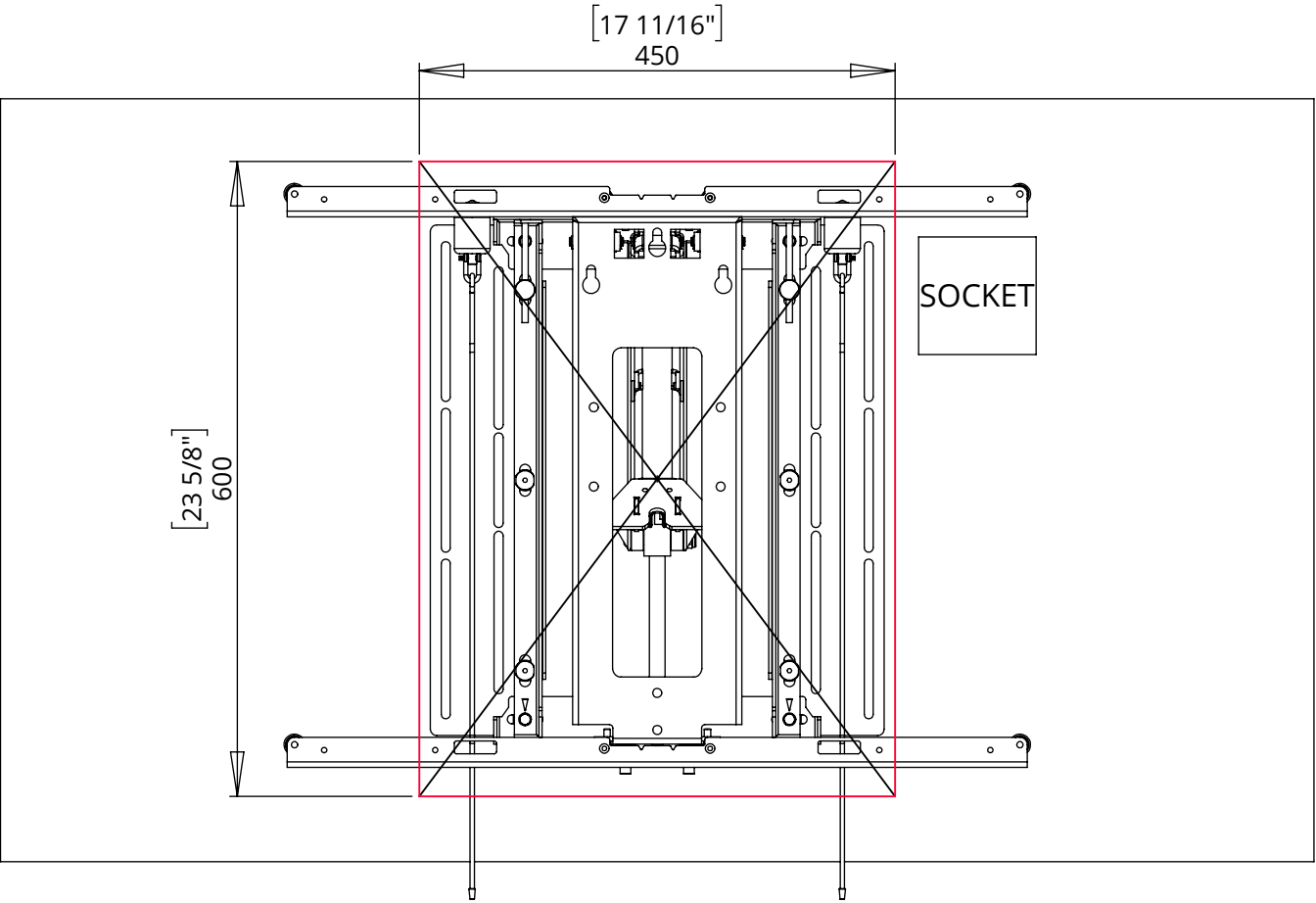
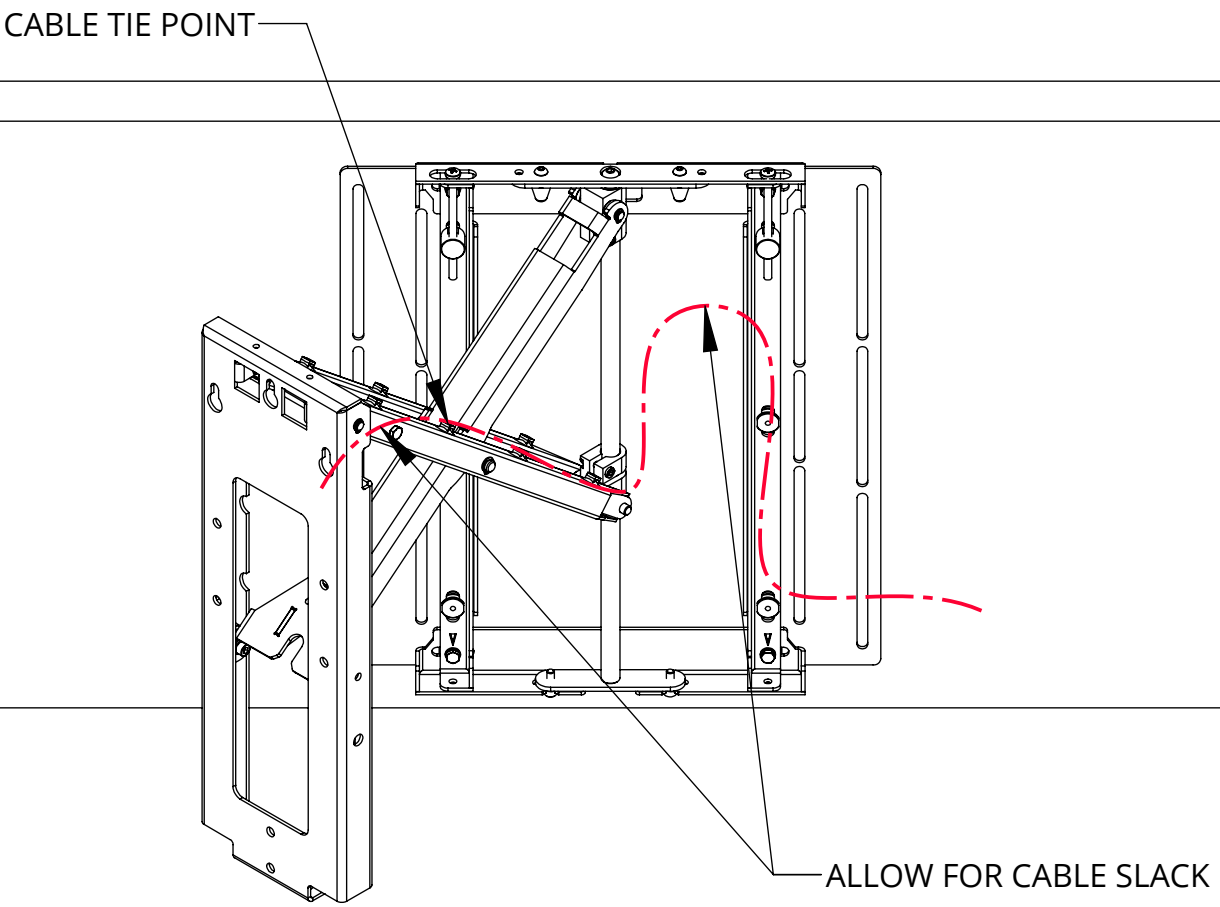

SOCKETS SHOULD BE PLACED OUTSIDE OF THE MECHANISM FOOTPRINT  
FOR EASIER CABLE ROUTING.

# PS40-MO

## MARINE OUTDOOR PULL & SWIVEL BRACKET



future automation

### MOUNT PLATE DIMENSIONS

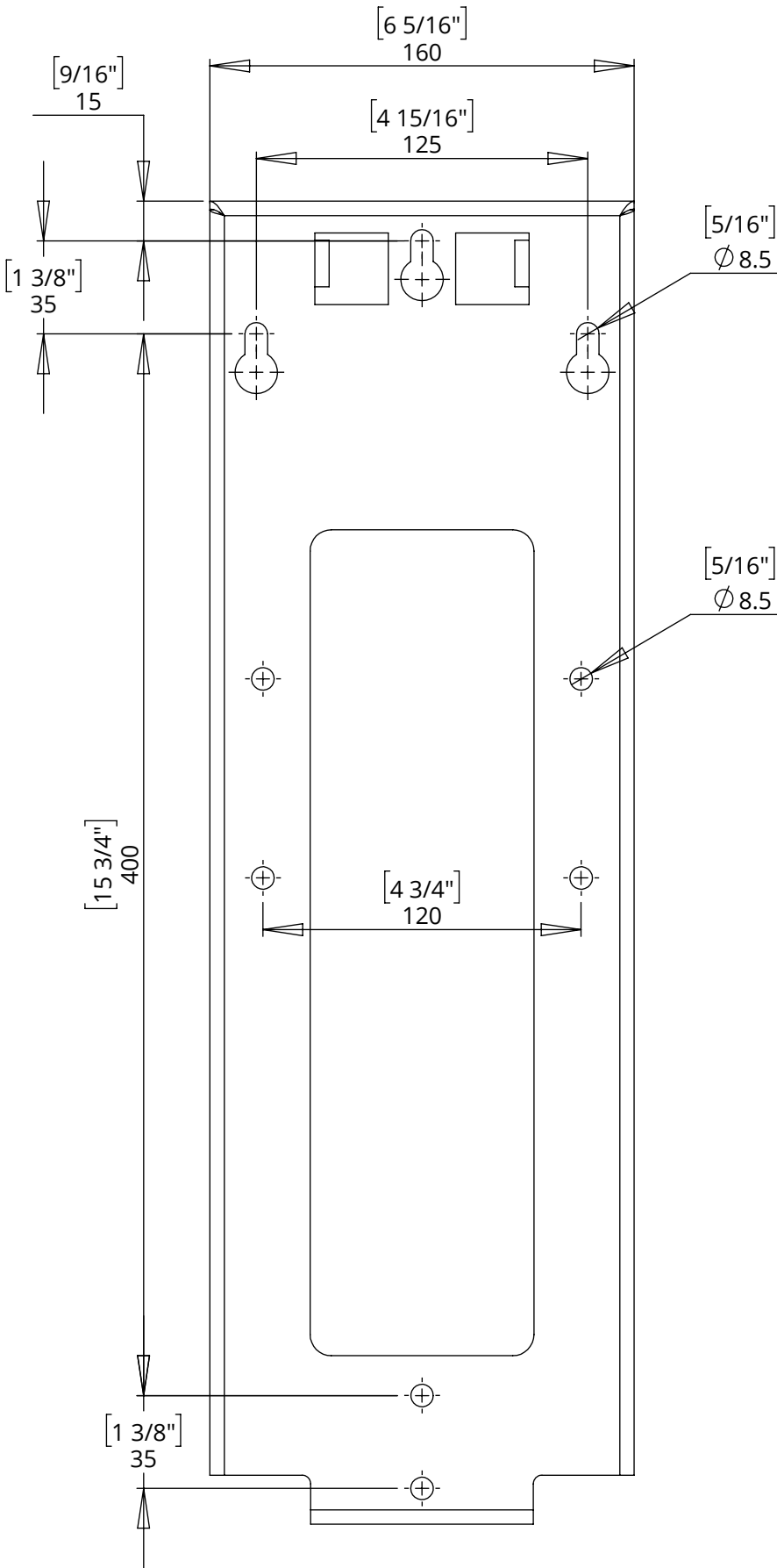

# PS40-MO

## MARINE OUTDOOR PULL & SWIVEL BRACKET



future automation

MARINE LOCK

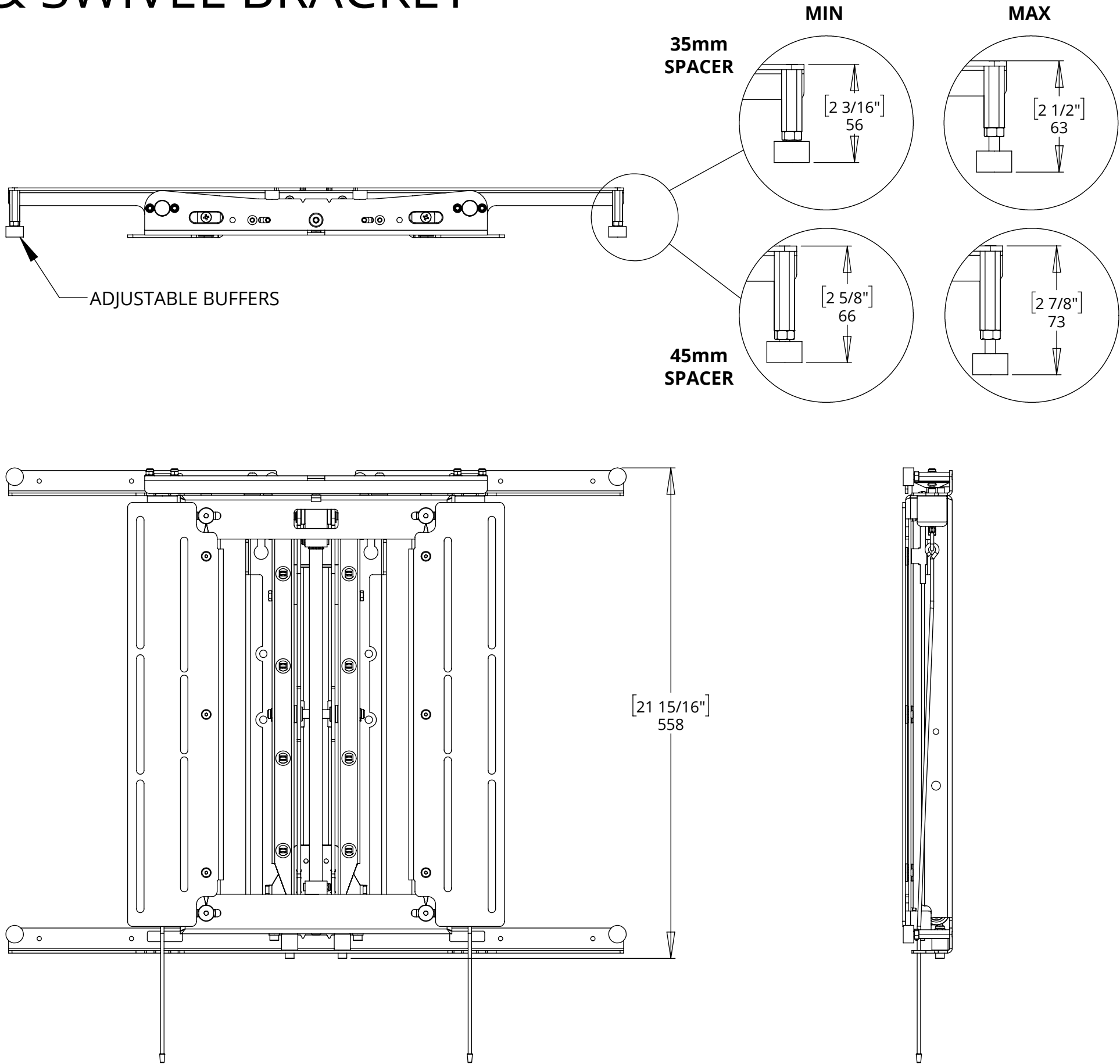
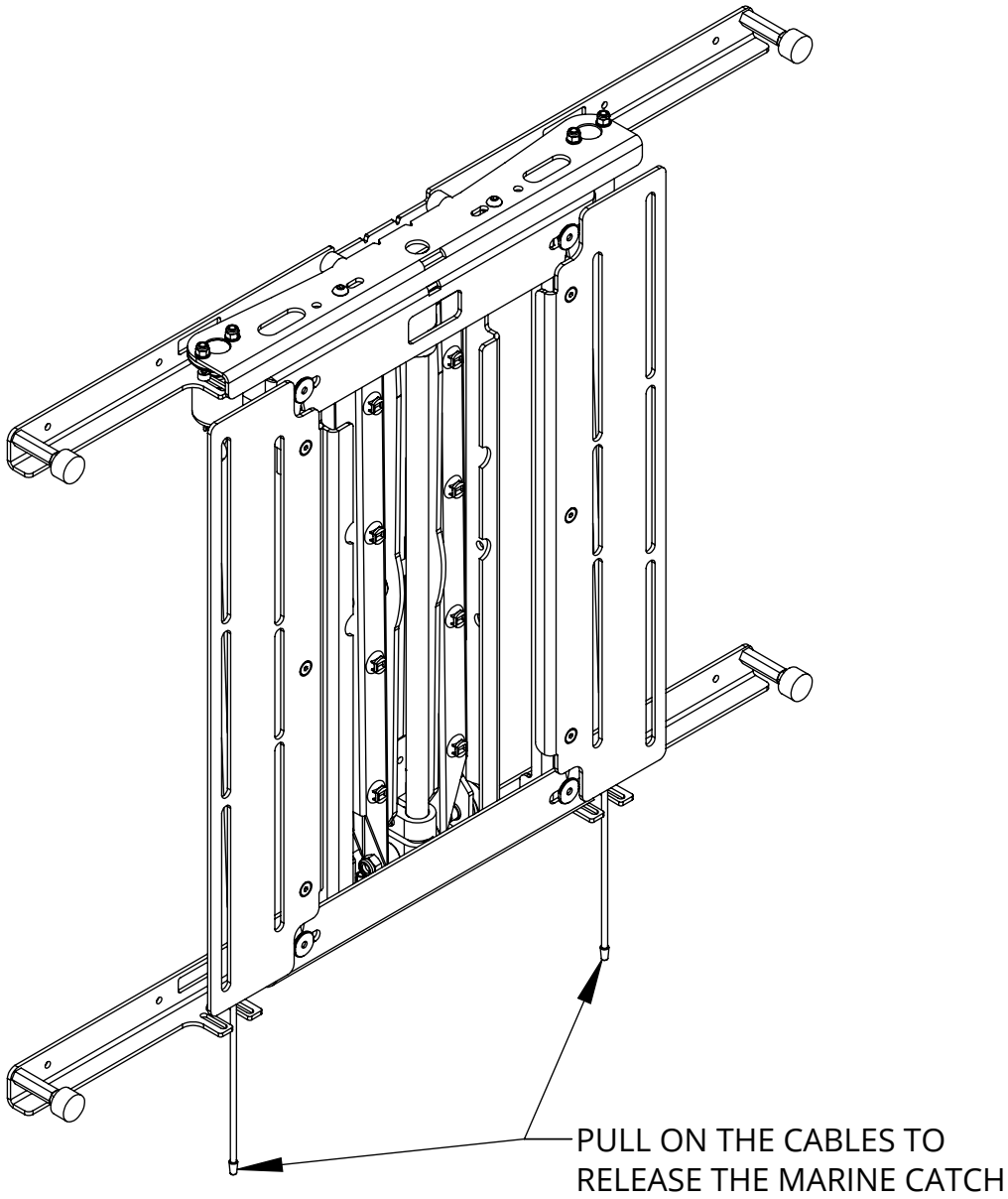

# PS40-MO

## MARINE OUTDOOR PULL & SWIVEL BRACKET



future automation

### SCREEN ADJUSTMENT

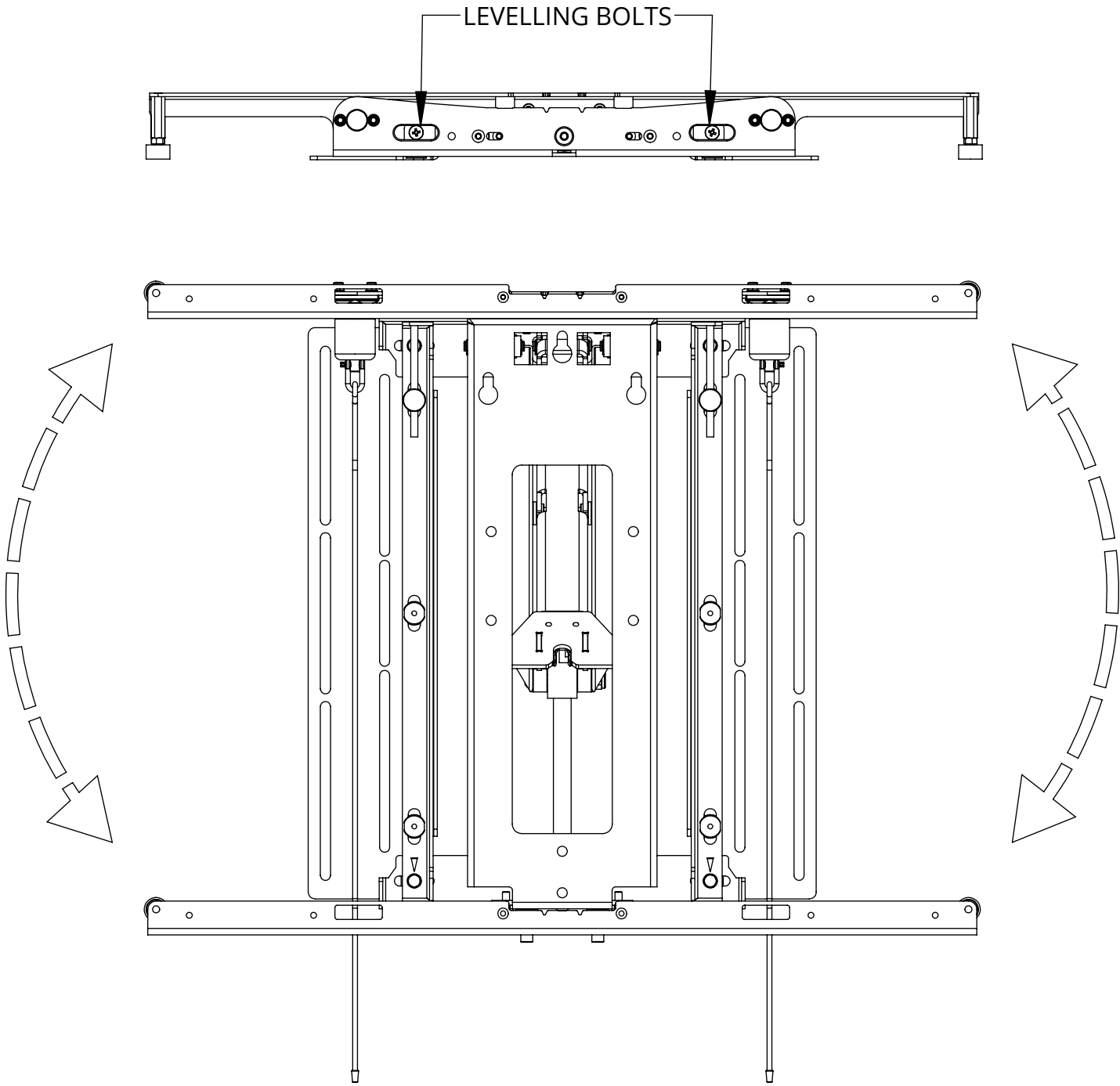

TILT THE PS BRACKET BY ADJUSTING THE LEVELLING BOLTS

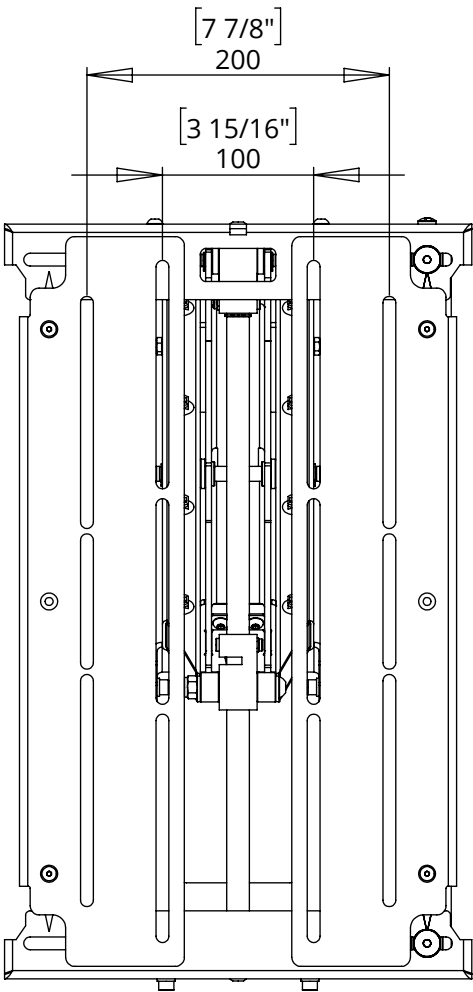
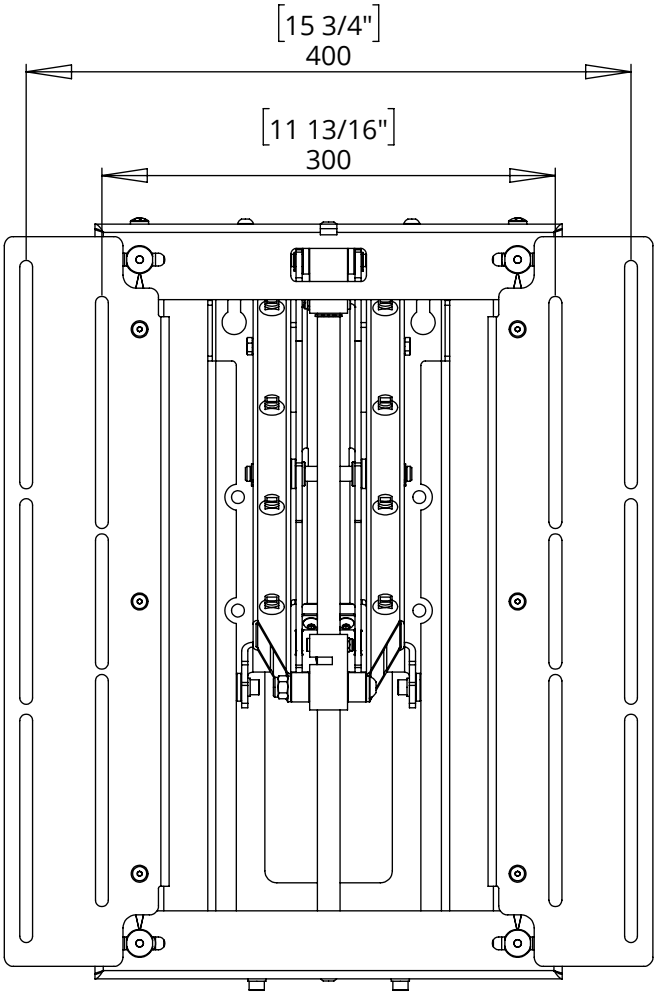

**NOTE:** UPRIGHTS CAN BE REVERSED TO ALLOW FOR SMALLER VESA PATTERNS



# PS40-MO

## MARINE OUTDOOR PULL & SWIVEL BRACKET



future automation

### MARINE CATCH CABLE ROUTING

CABLE ROUTING BOSSES PROVIDED TO ROUTE MARINE CATCH CABLES.

4 x CABLE ROUTING BOSS

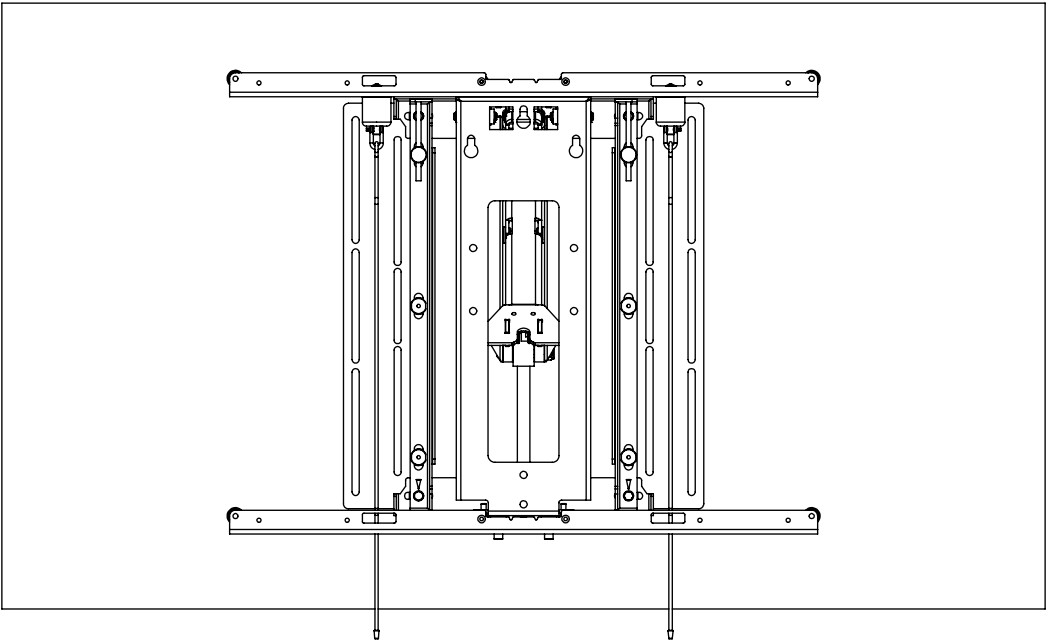
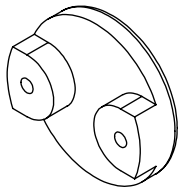

WITHOUT BOSSES: CABLES HANG BELOW THE SCREEN

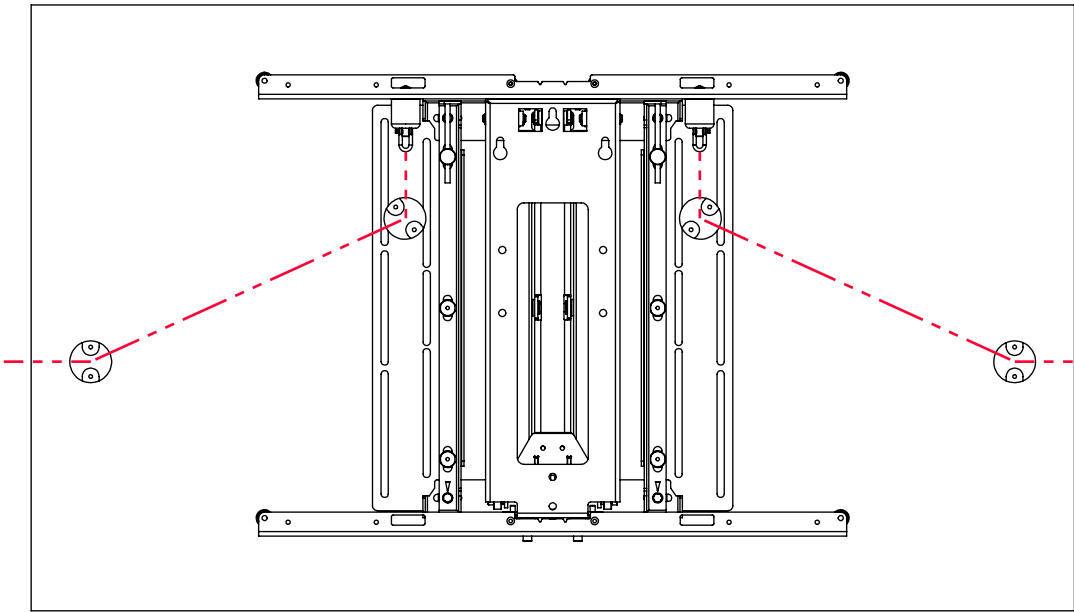
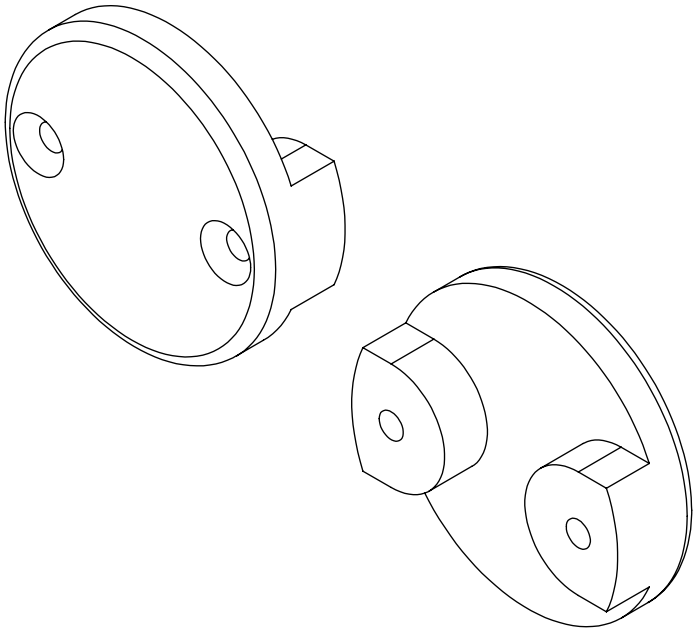

WITH BOSSES: CABLE ROUTING TO THE SIDES OF THE SCREEN

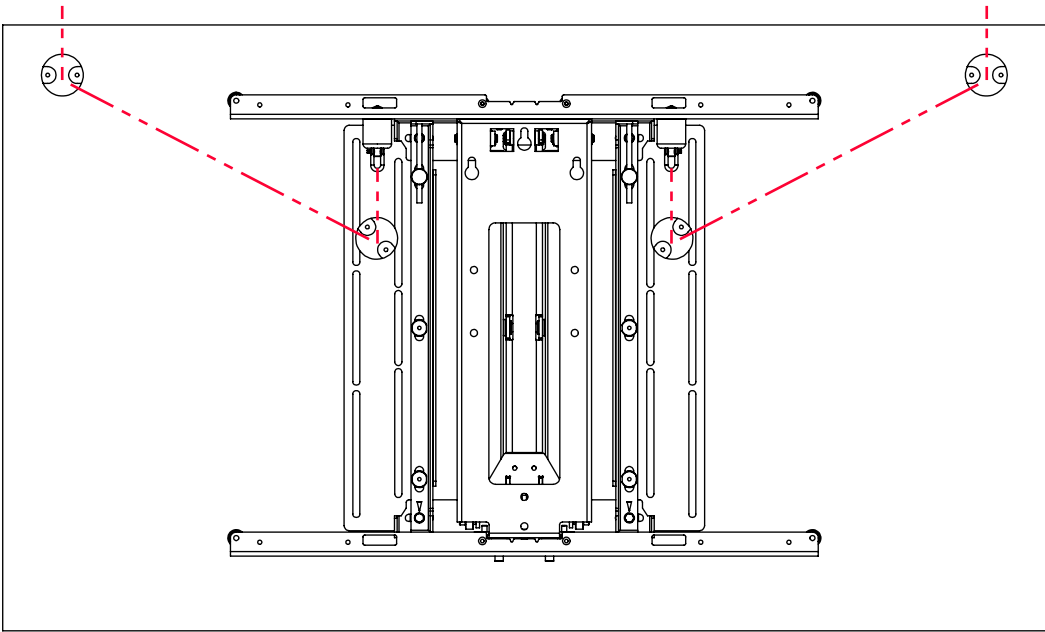

WITH BOSSES: CABLE ROUTING TO THE TOP OF THE SCREEN

NOTE: THIS ORIENTATION WILL INCREASE PULLING FORCE REQUIRED TO RELEASE MARINE CATCHES

# PS40-MO

## MARINE OUTDOOR PULL & SWIVEL BRACKET



future automation

### FRICTION ADJUSTMENT

ADJUST THE STIFFNESS OF BOTH THE PULL-OUT AND SWIVEL FUNCTION.

TOP FRICTION  
ADJUSTMENT BOLT

ADJUST THE TOP FRICTION BOLT TO  
CHANGE THE STIFFNESS OF THE  
PULL-OUT FUNCTION.

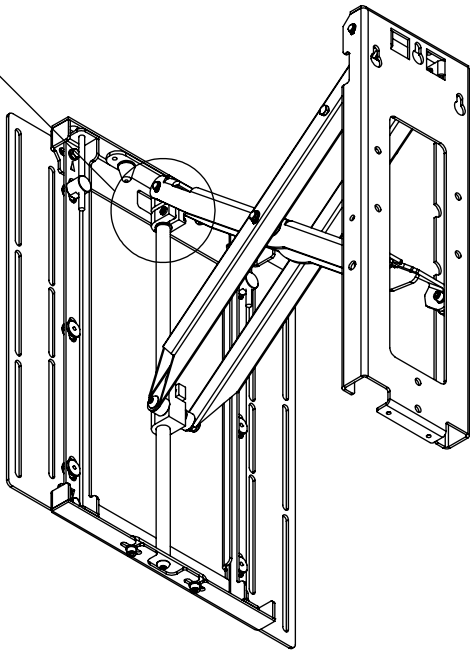
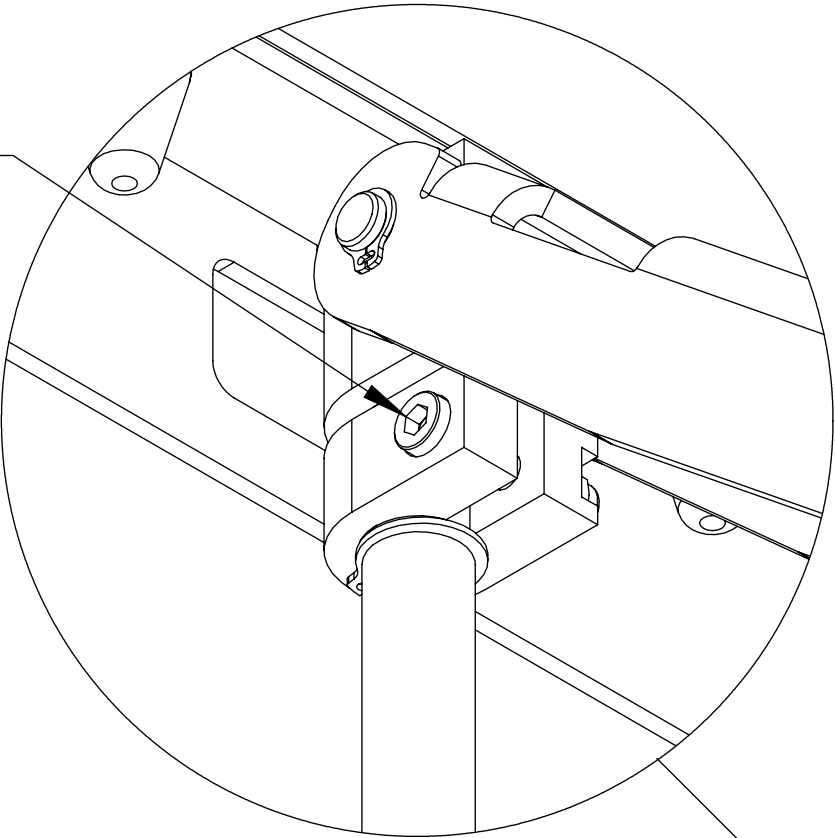
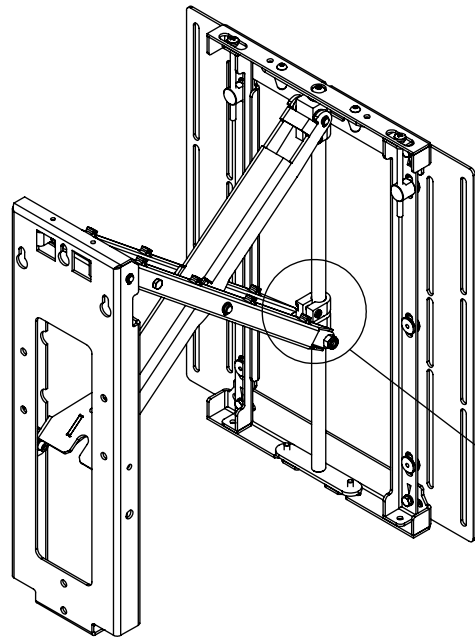

ADJUST THE BOTTOM FRICTION  
BOLT TO CHANGE THE STIFFNESS  
OF THE SWIVEL FUNCTION.

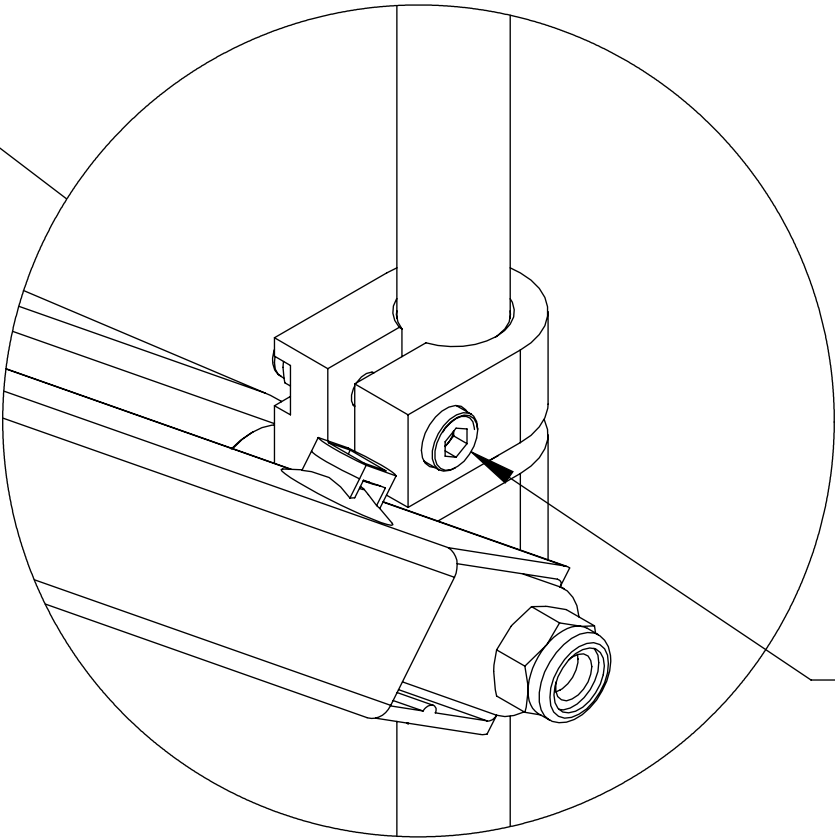

BOTTOM FRICTION  
ADJUSTMENT BOLT

# PS40-MO

## MARINE OUTDOOR PULL & SWIVEL BRACKET

### MARINE CATCH CABLE ROUTING

#### CABLE ROUTING BOSS KIT

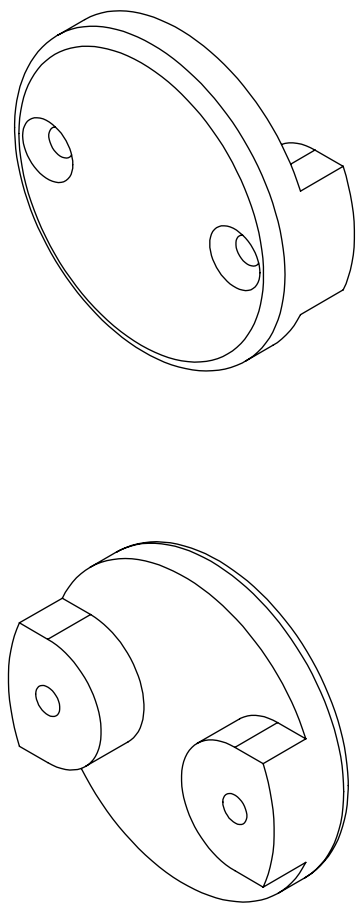

4 x CABLE ROUTING BOSSES ARE **PROVIDED** AS STANDARD WITH THE MARINE PS BRACKET.

ADDITIONAL SETS CAN BE PURCHASED WITH CODE **CRB-PS-M**

#### BALL & SOCKET KIT

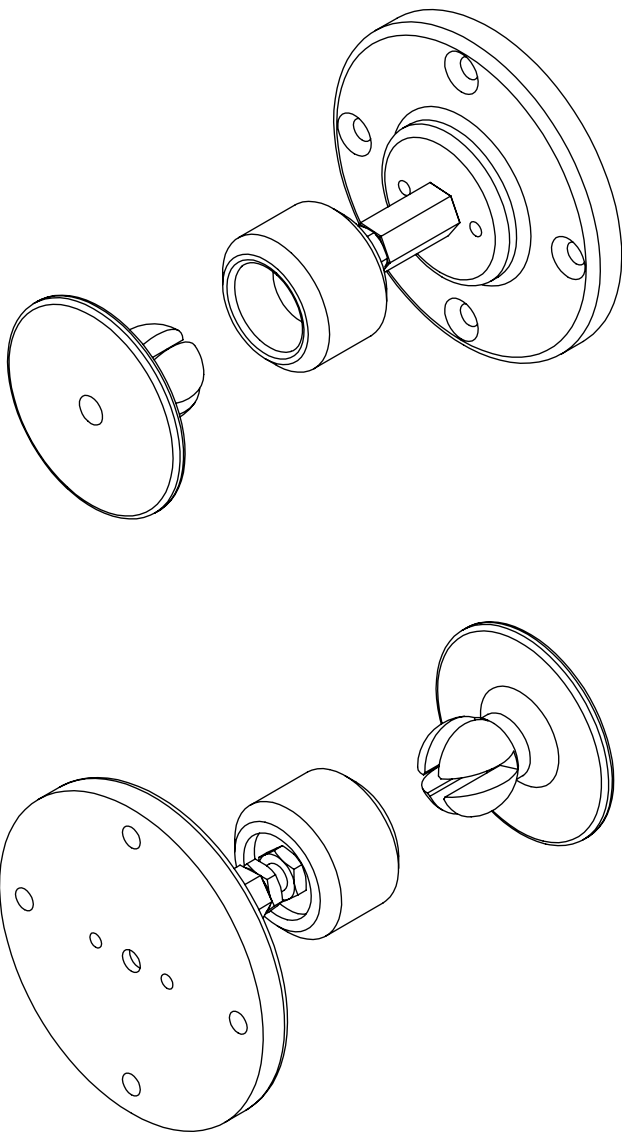

SETS OF 4 x BALL AND SOCKET CATCES TO BE USED WITH THE MARINE PS BRACKET TO RETAIN AND STABLISE THE SCREEN EDGES.

FOR FULL DETAILS, REFER TO **BS-PS-M** TECHNICAL SHEET.

#### RUBBER POST KIT

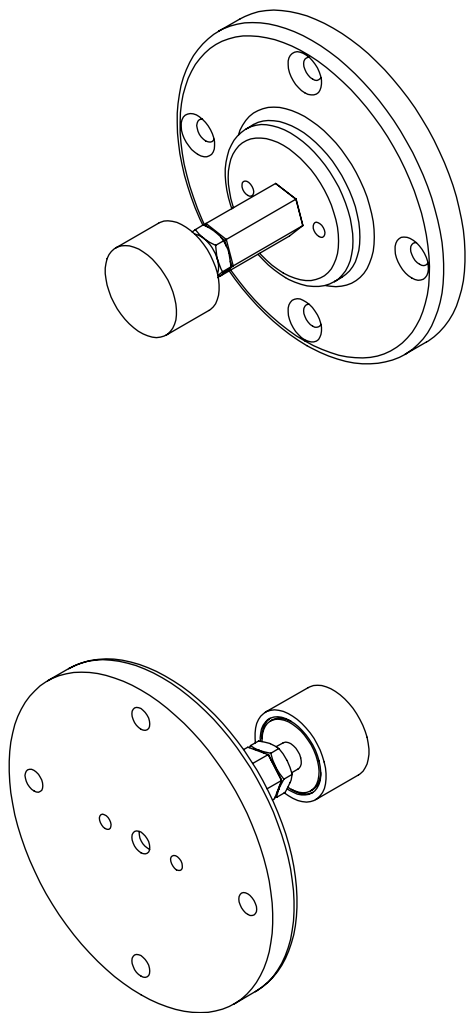

SETS OF 4 x RUBBER SCREEN POSTS TO BE USED WITH THE MARINE PS BRACKET TO STABLISE THE SCREEN EDGES.

FOR FULL DETAILS, REFER TO **RP-PS-M** TECHNICAL SHEET.