

PS55-MO

MARINE OUTDOOR PULL & SWIVEL BRACKET

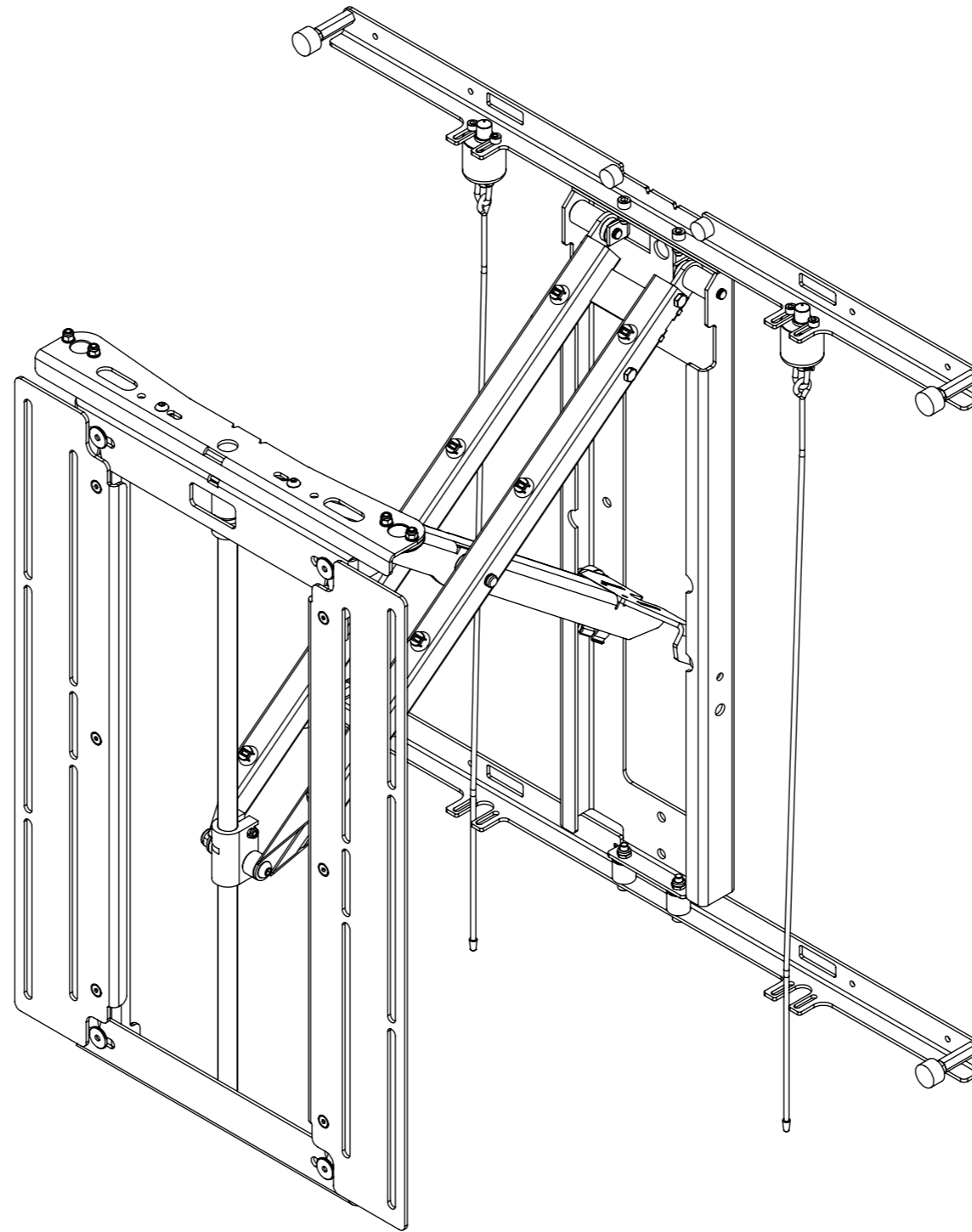

future automation



PS55-MO

MARINE OUTDOOR PULL & SWIVEL BRACKET



future automation

SPECIFICATION	MEASUREMENTS
Product Dimensions	677mm (26 5/8") x 700mm (27 9/16") x 56mm (2 3/16")
Screen Sizes	55" - 75"
Maximum Weight Capacity	60Kg (132lb)
Maximum Extension From Wall	500mm (19 11/16")
Depth From Wall	56mm (2 3/16")
Product Weight	13.5Kg (29.8 lb)
Packaging Dimensions	TBC
Shipping Weight	TBC
Maximum Rotation	50° - bi-directional with 55" screen - 42° with 65" - 35° with 75"
Movement Type	Manual
Mounting Patterns Supported	VESA 400, 300, 200 W x 400, 300, 200, 100 H
Product Options / Features	Specific B&O and Loewe mounts / adapters, Custom RAL paint finishes, Marine suitable version
Package Contents	Mechanism, cable routing bosses
Marine Suitable	Yes
Outdoor Suitable	Yes

PS55-MO

MARINE OUTDOOR PULL & SWIVEL BRACKET

SCREEN ANGLES

THE VIEWS BELOW SHOW THE APPROPRIATE MAXIMUM SWIVEL ANGLES ACHIEVABLE FOR VARYING SCREEN SIZES.

NOTE: THE MAXIMUM SWIVEL ANGLE ACHIEVABLE IS 50° REGARDLESS OF THE SCREEN SIZE.

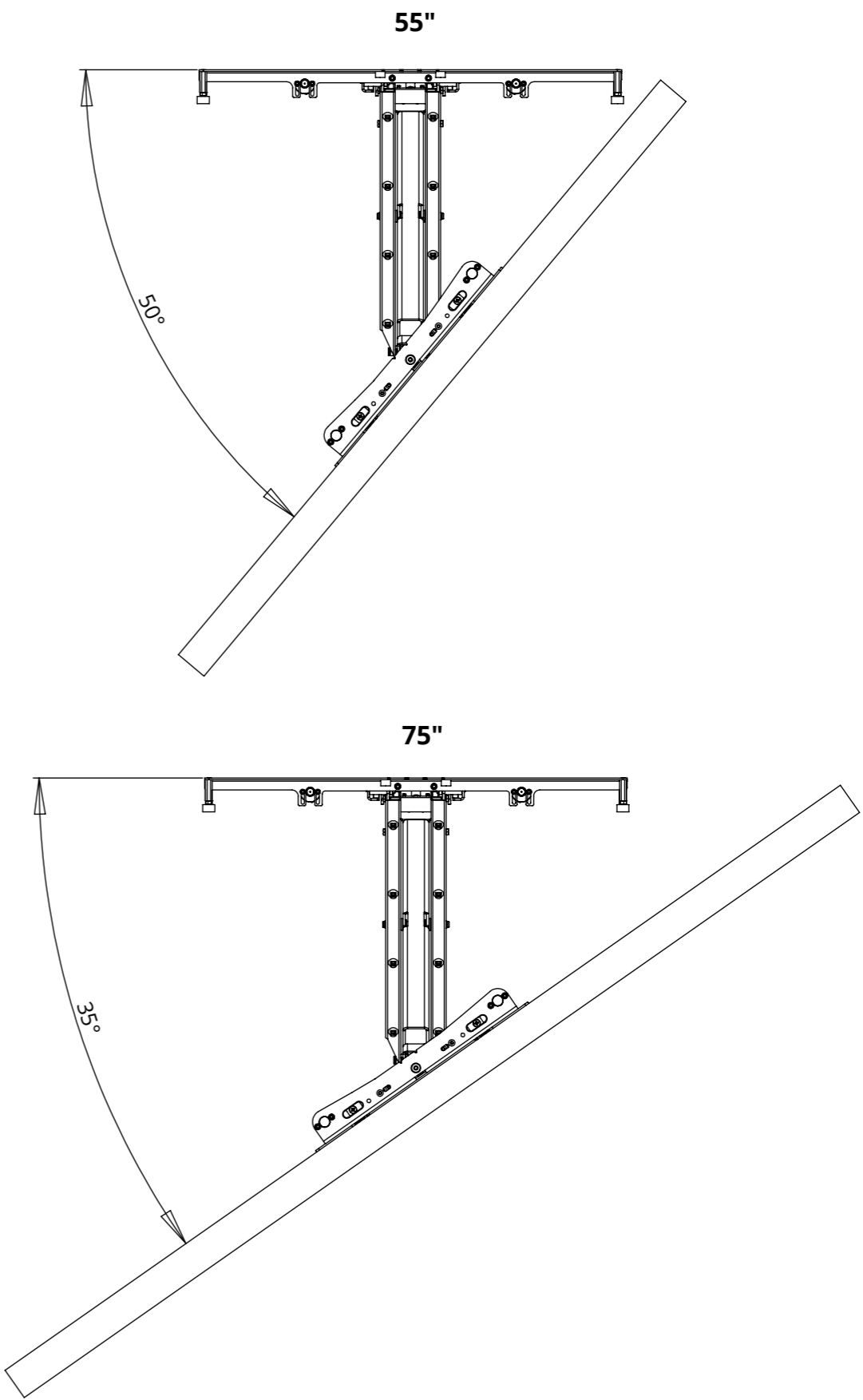
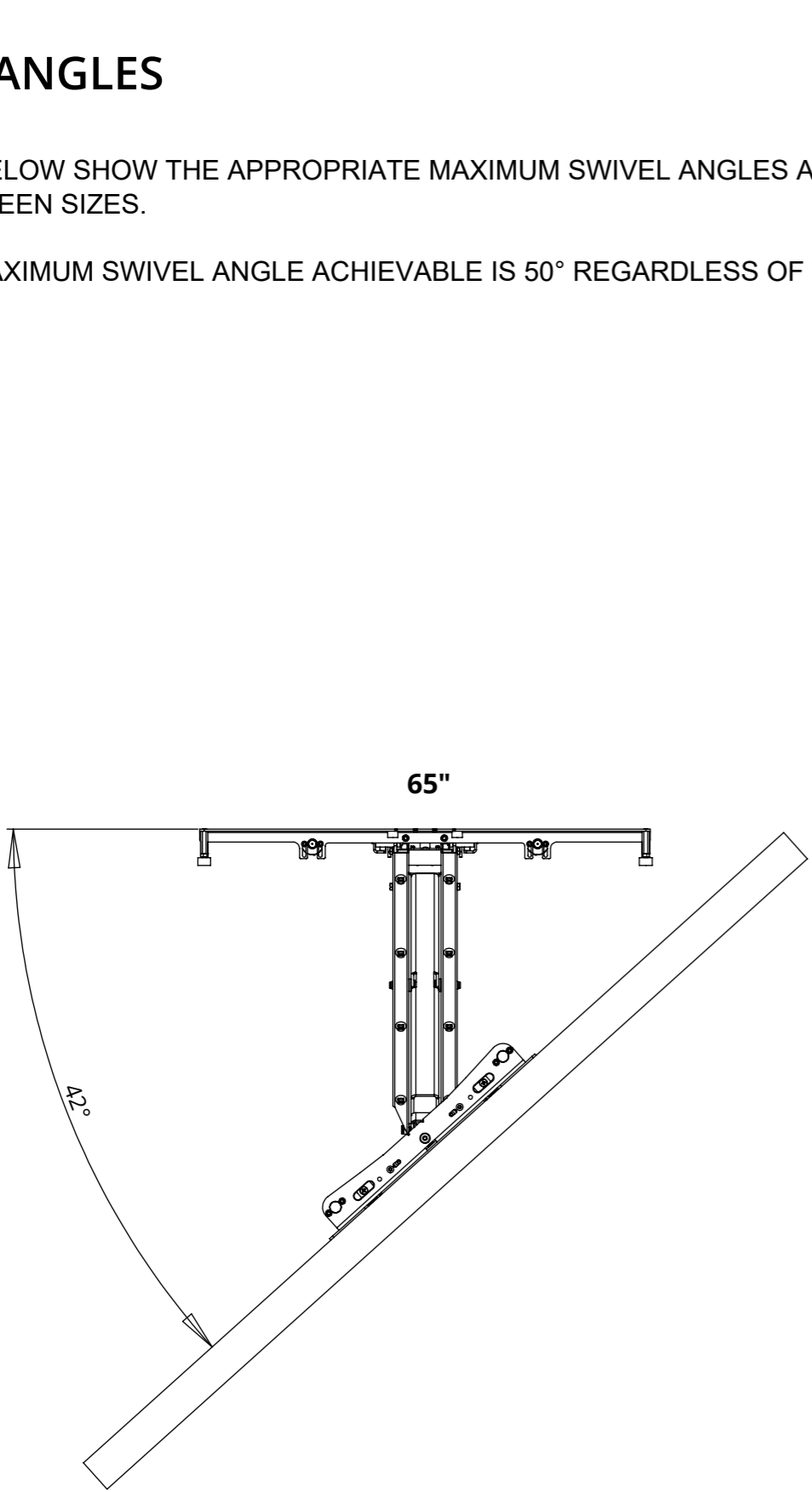

PS55-MO

MARINE OUTDOOR PULL & SWIVEL BRACKET



future automation

GENERAL DIMENSIONS

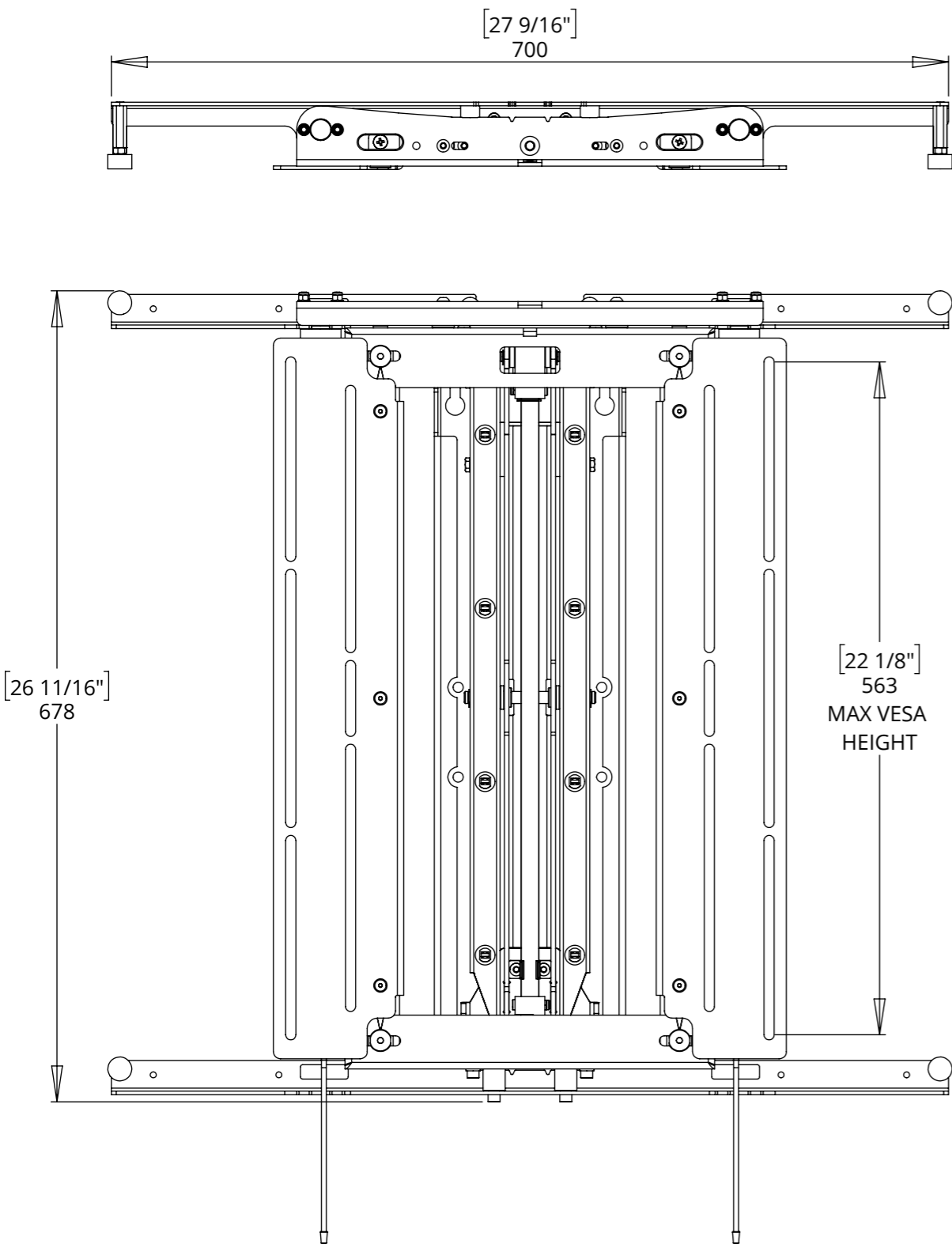

CLOSED POSITION

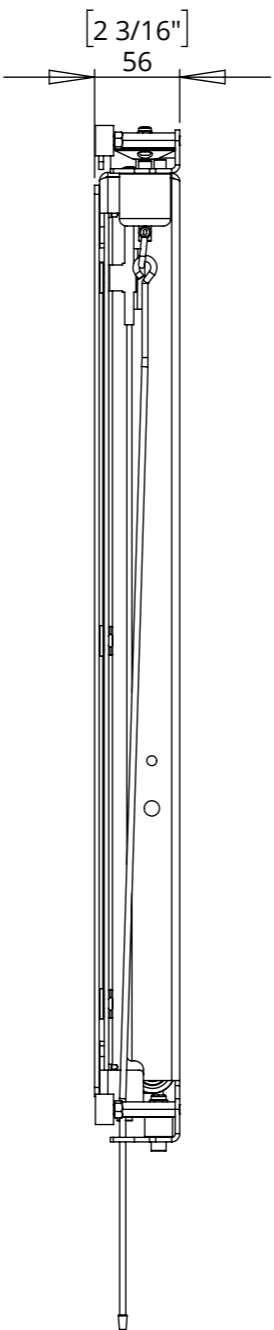

FULL EXTENSION

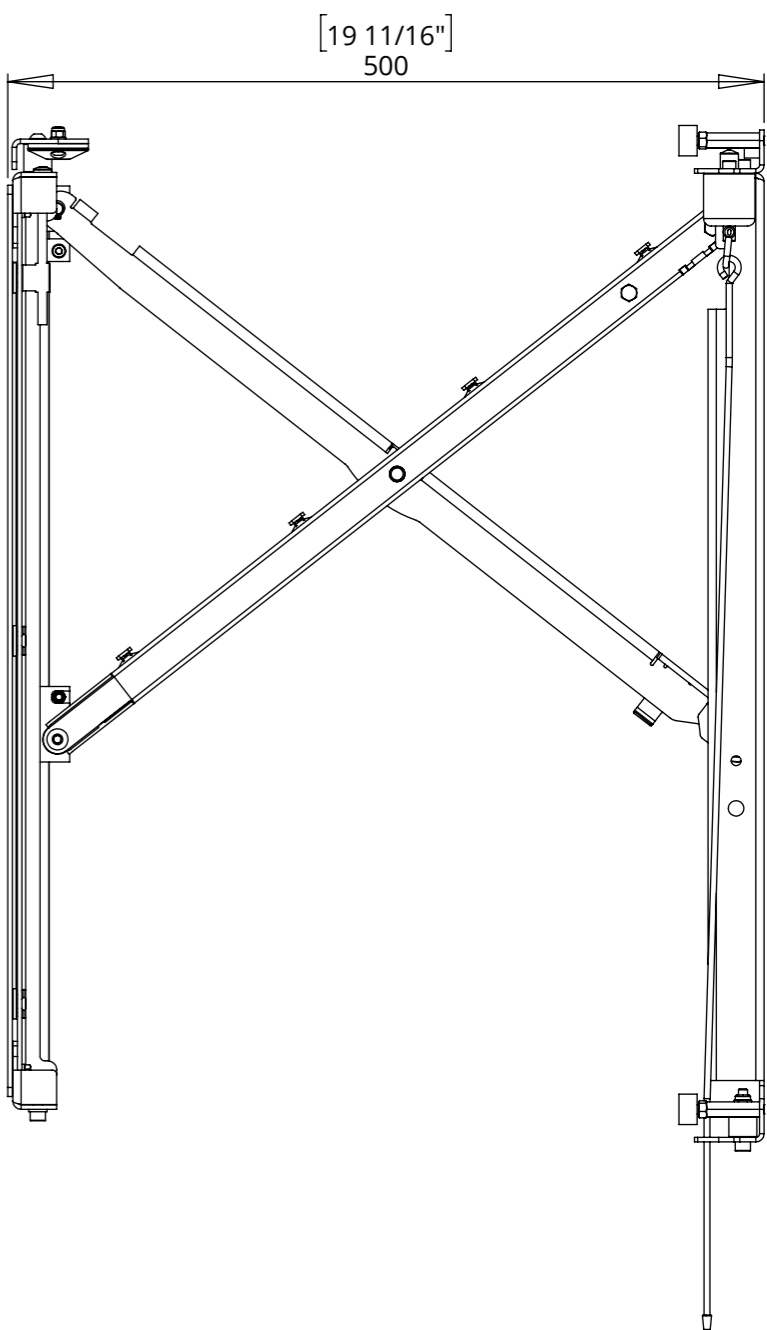

PS55-MO

MARINE OUTDOOR PULL & SWIVEL BRACKET

CABLE ROUTING

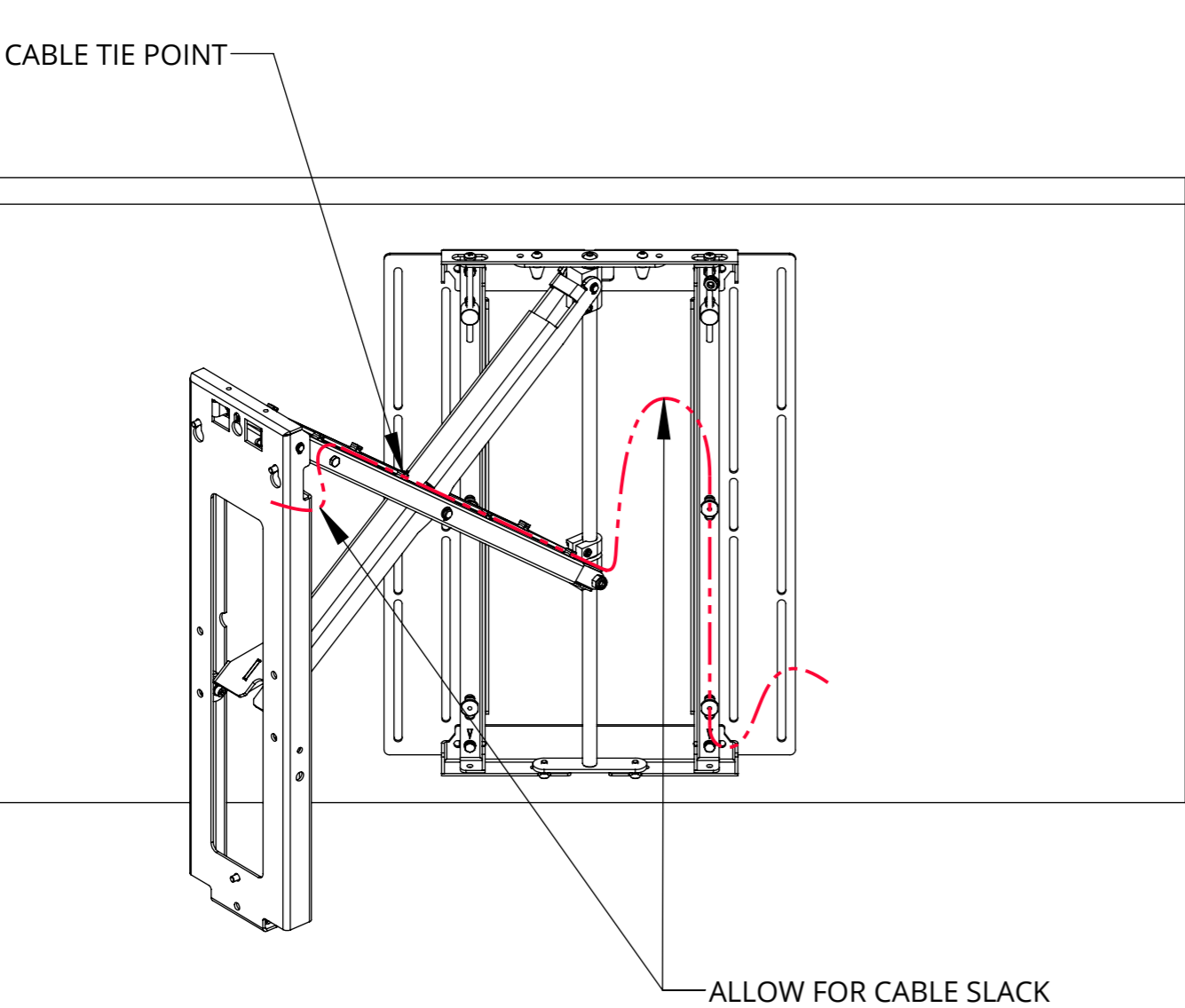

NOTE: MARINE CATCH HIDDEN

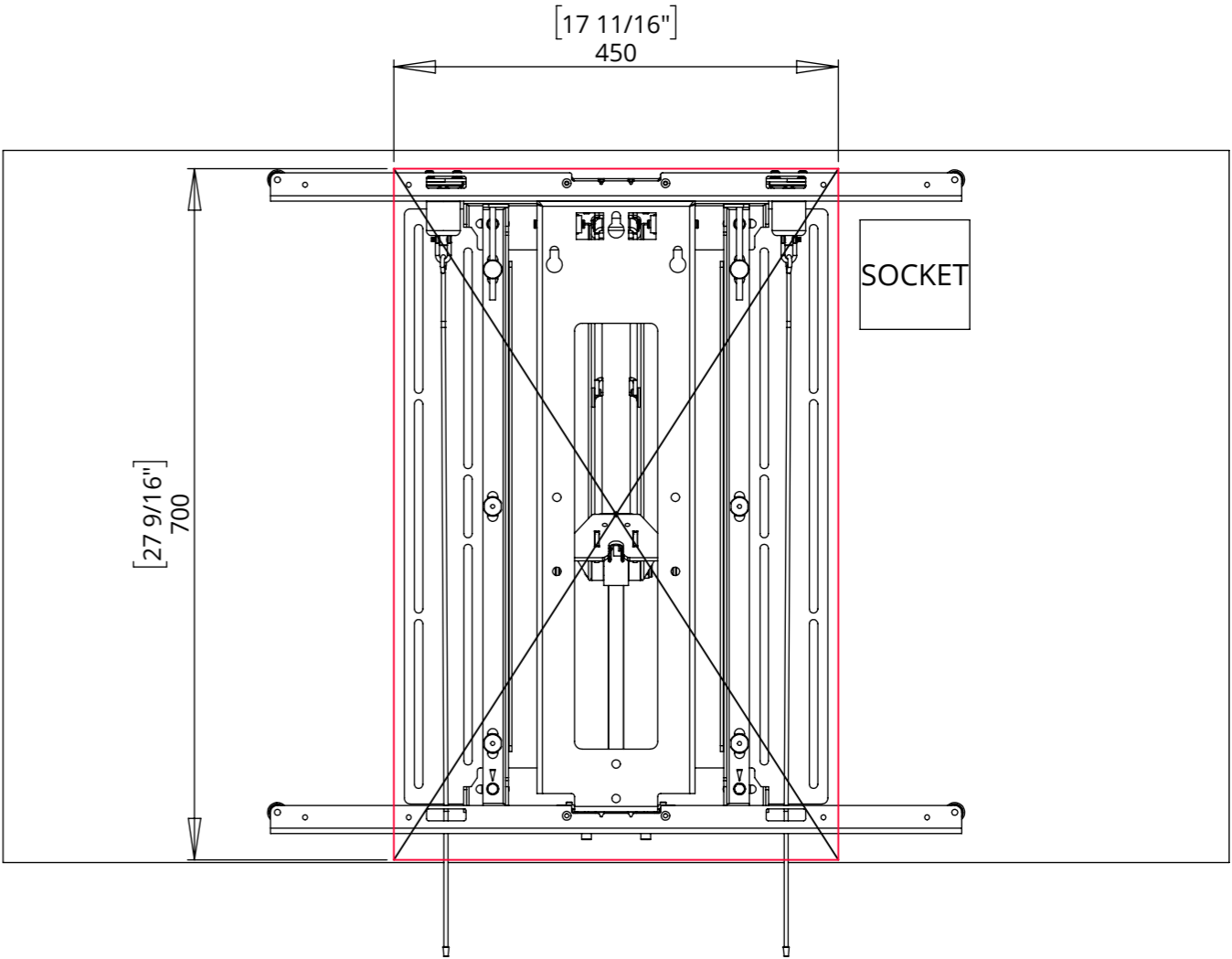

SOCKETS SHOULD BE PLACED OUTSIDE OF THE MECHANISM FOOTPRINT
FOR EASIER CABLE ROUTING.

PS55-MO

MARINE OUTDOOR PULL & SWIVEL BRACKET



future automation

MOUNT PLATE DIMENSIONS

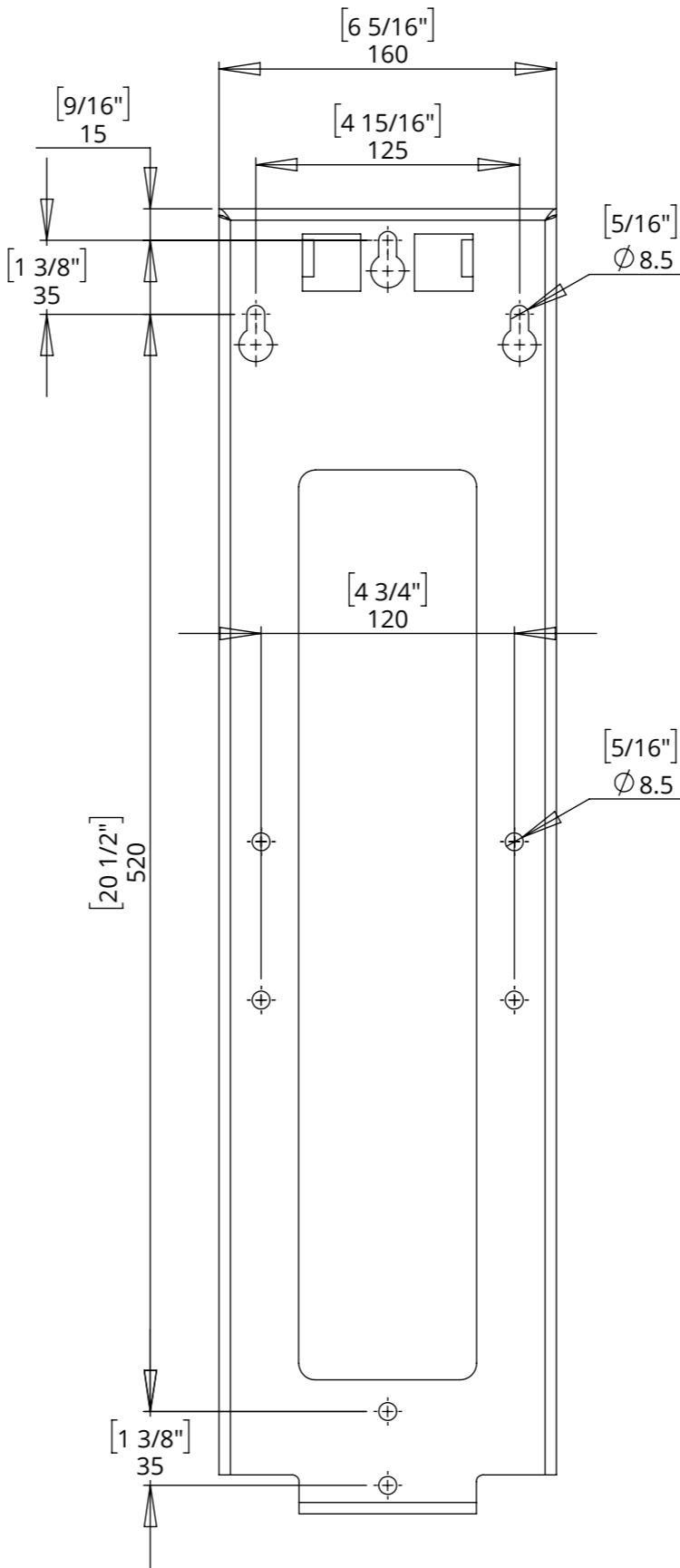

PS55-MO

MARINE OUTDOOR PULL & SWIVEL BRACKET



future automation

MARINE LOCK

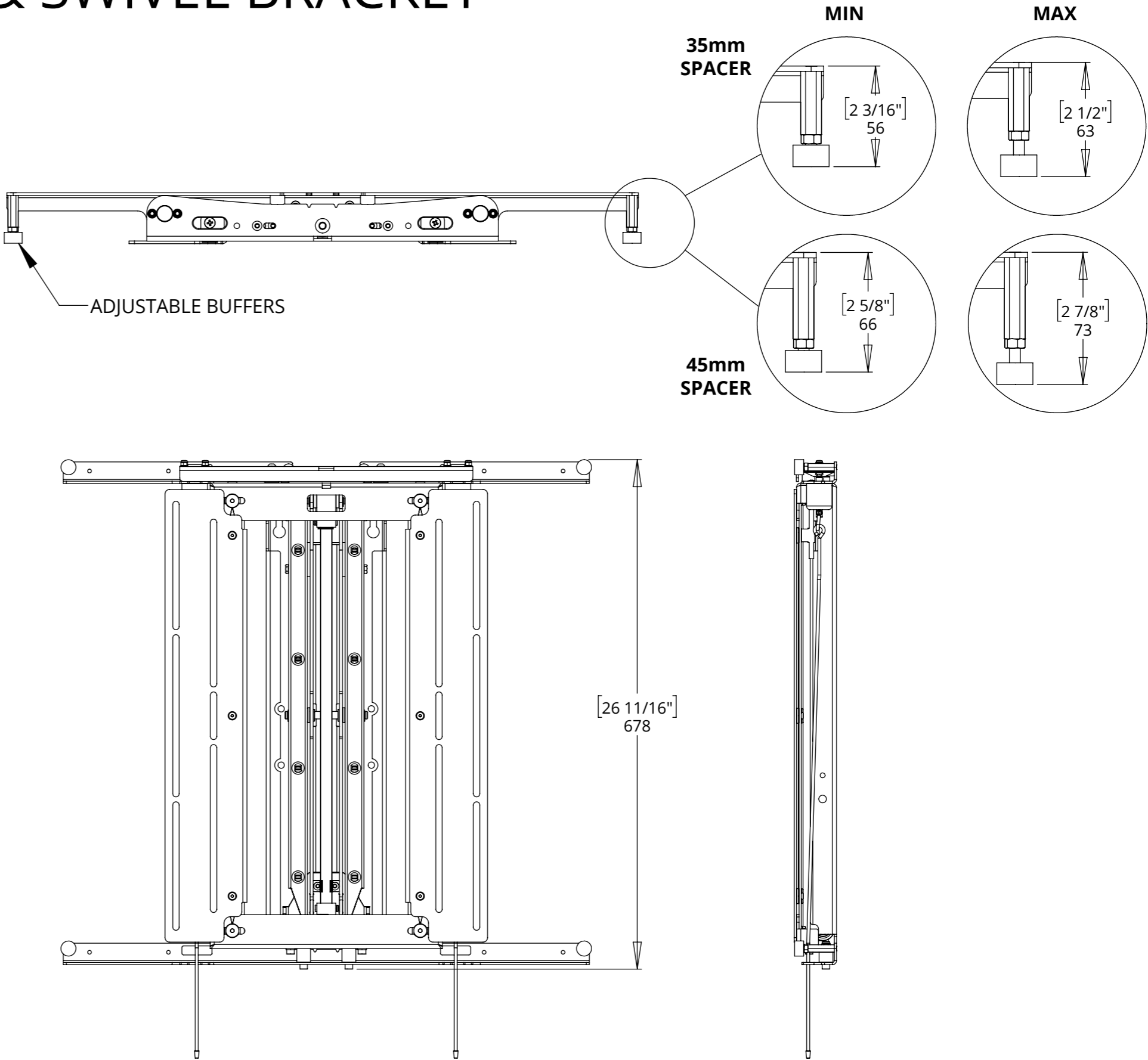
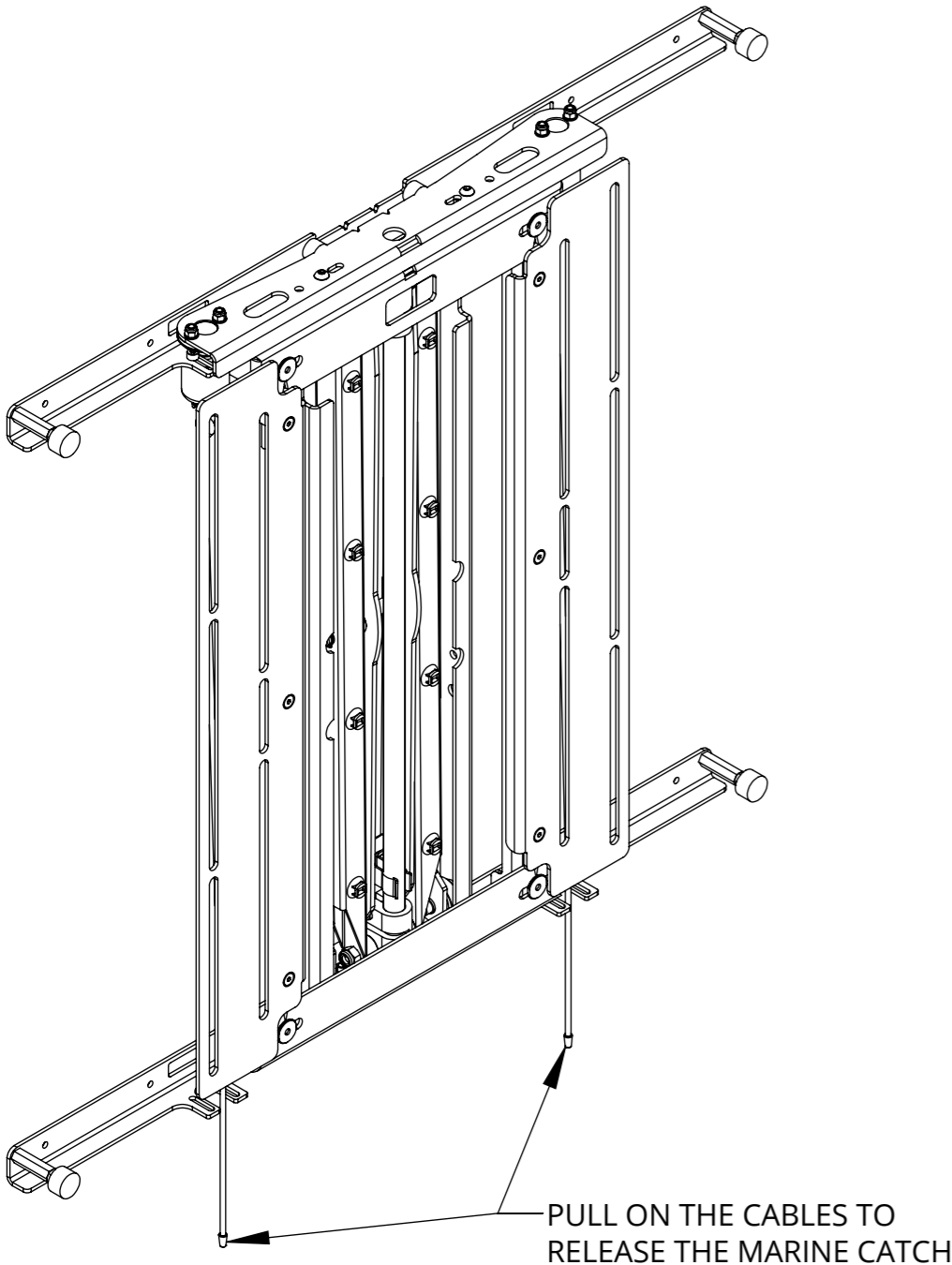

PS55-MO

MARINE OUTDOOR PULL & SWIVEL BRACKET



future automation

SCREEN ADJUSTMENT

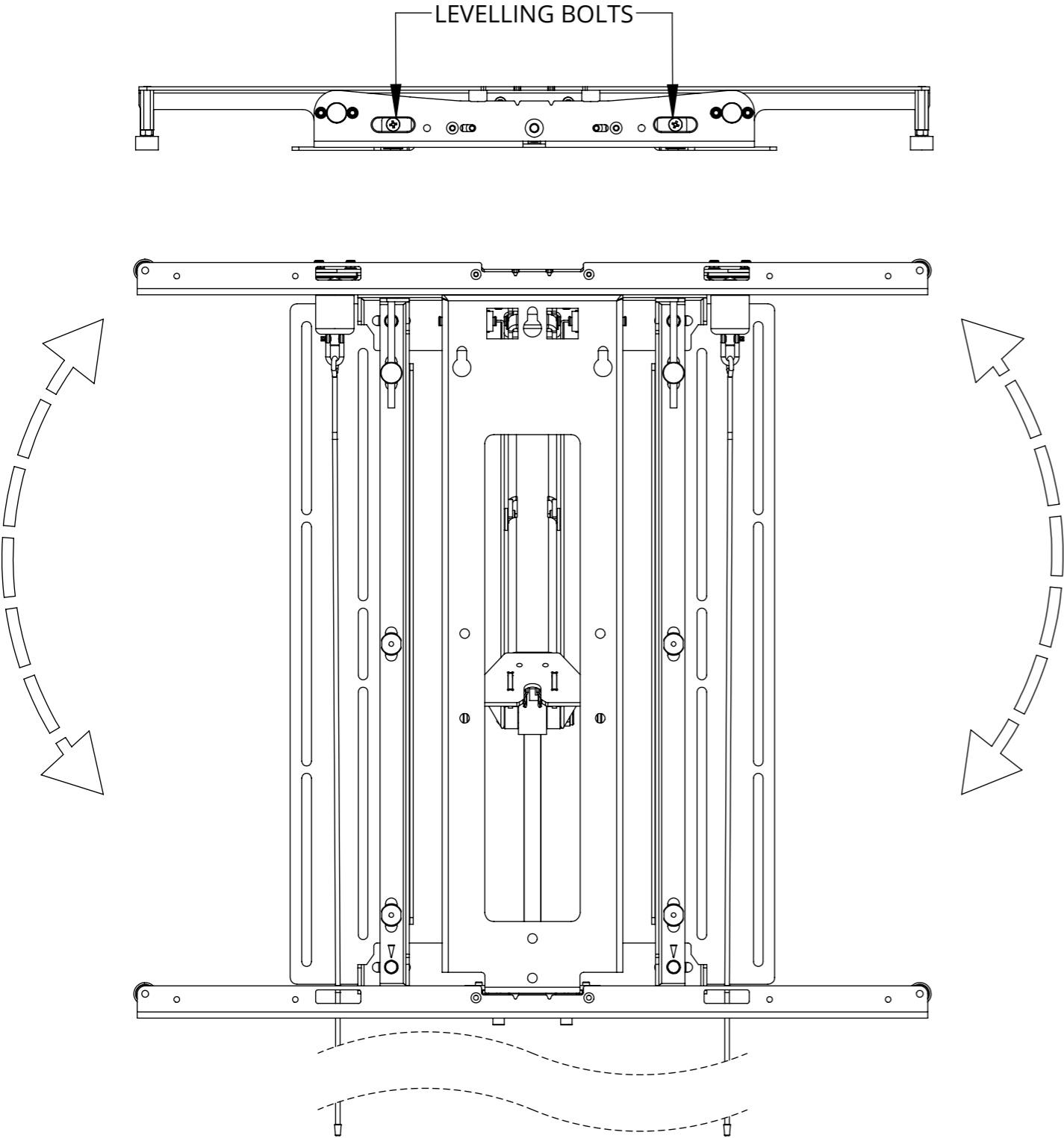

TILT THE PS BRACKET BY ADJUSTING THE LEVELLING BOLTS

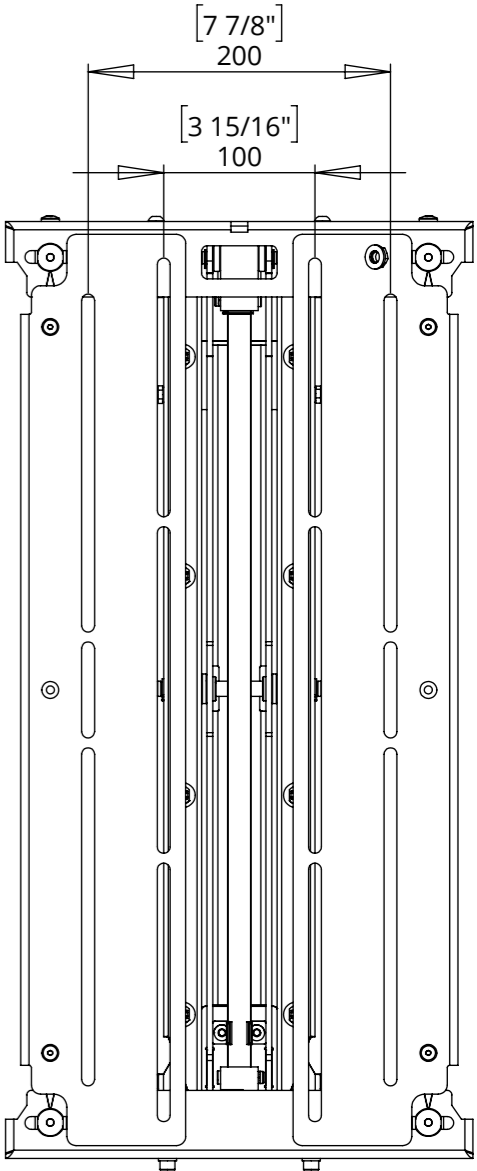
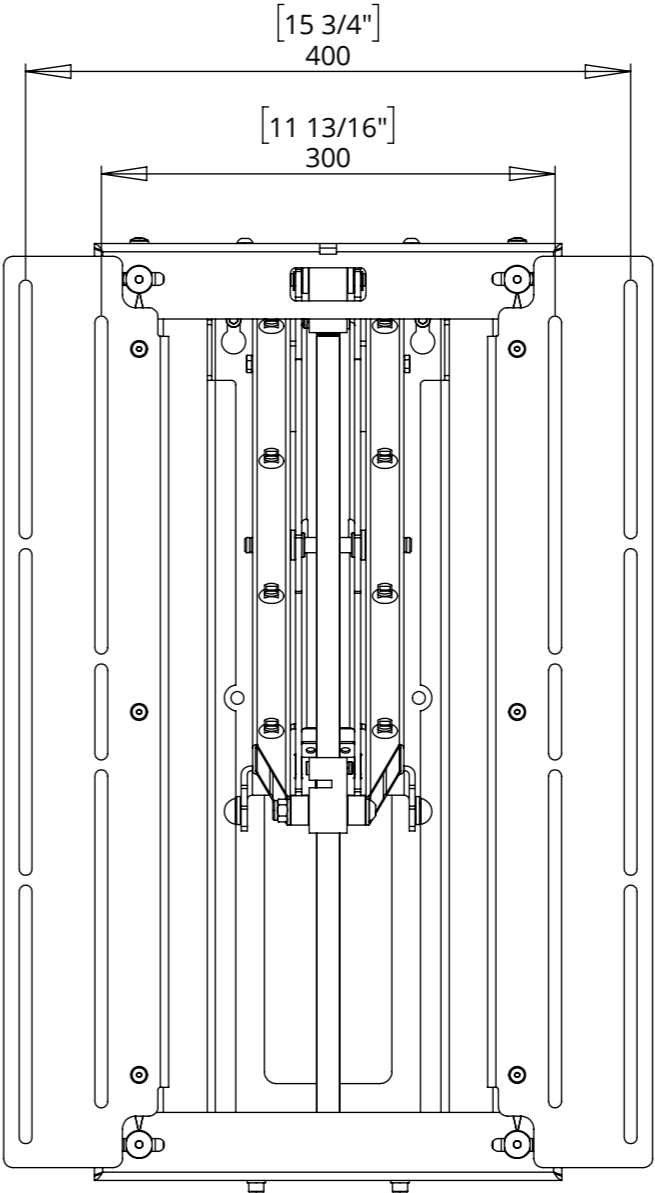

NOTE: UPRIGHTS CAN BE REVERSED TO ALLOW FOR SMALLER VESA PATTERNS

PS55-MO

MARINE OUTDOOR PULL & SWIVEL BRACKET



future automation

MARINE CATCH CABLE ROUTING

CABLE ROUTING BOSSES PROVIDED TO ROUTE MARINE CATCH CABLES.

4 x CABLE ROUTING BOSS

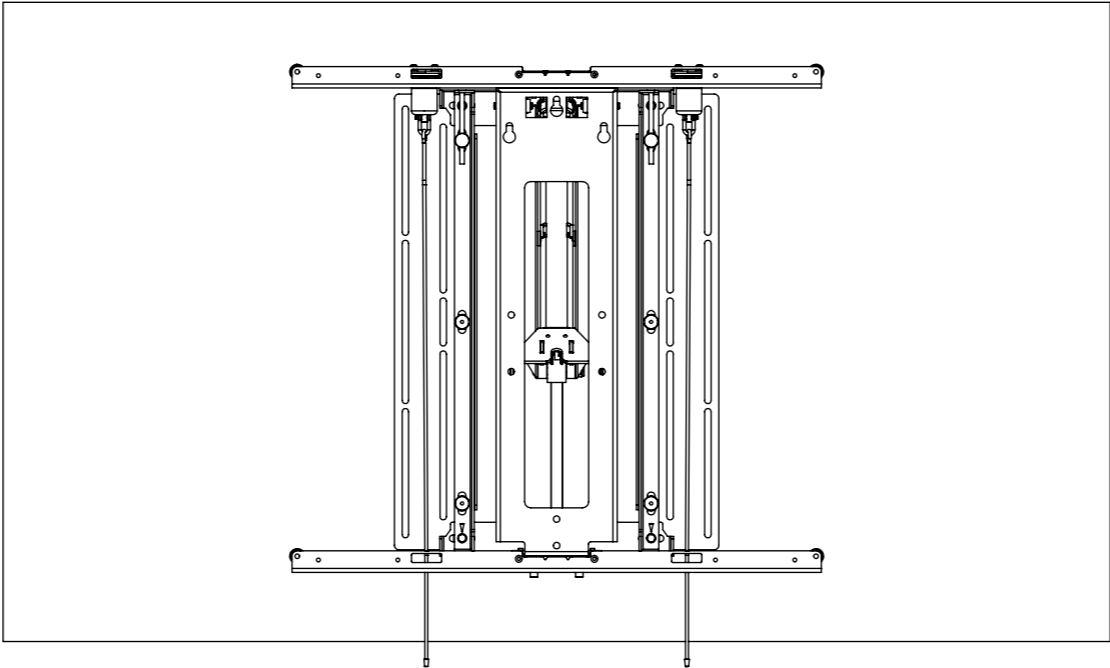
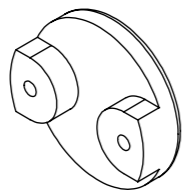

WITHOUT BOSSES: CABLES HANG BELOW THE SCREEN

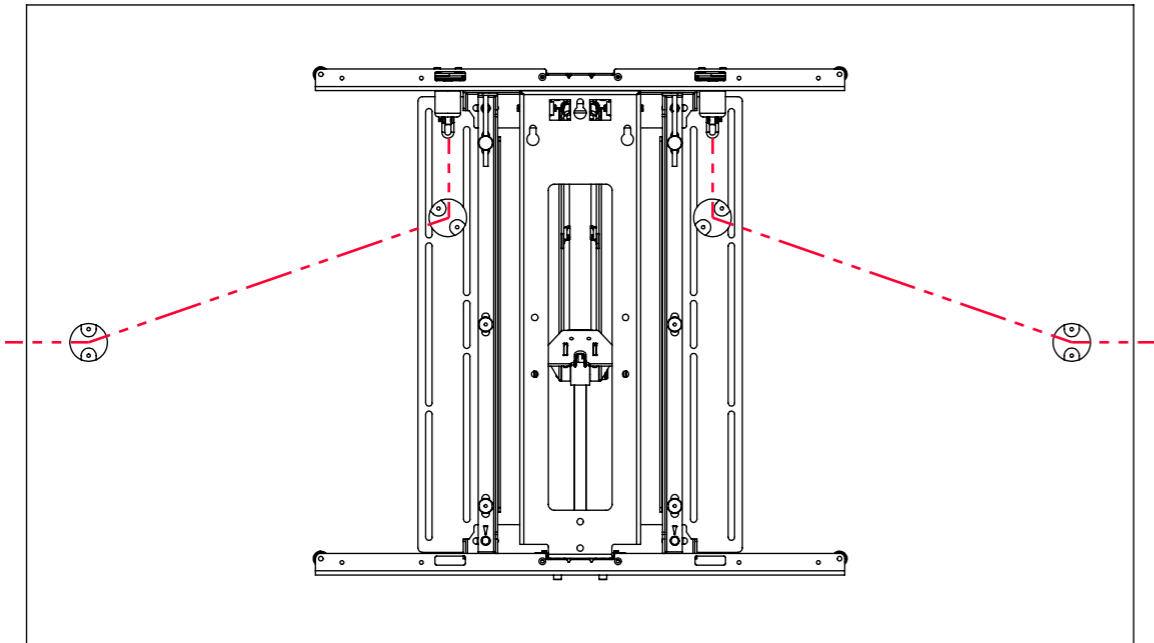
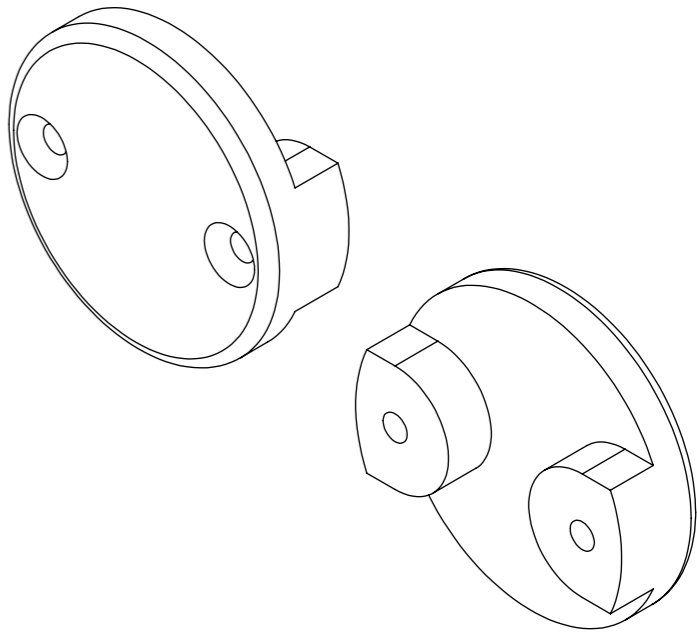

WITH BOSSES: CABLE ROUTING TO THE SIDES OF THE SCREEN

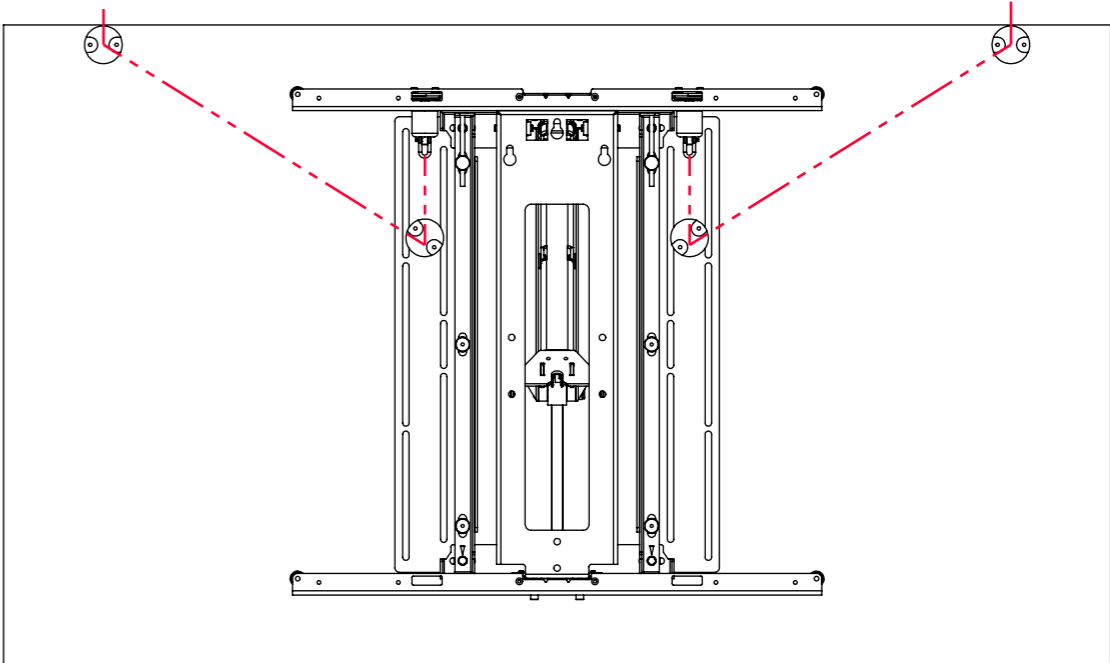

WITH BOSSES: CABLE ROUTING TO THE TOP OF THE SCREEN

NOTE: THIS ORIENTATION WILL INCREASE PULLING FORCE REQUIRED TO RELEASE MARINE CATCHES

PS55-MO

MARINE OUTDOOR PULL & SWIVEL BRACKET



future automation

FRICTION ADJUSTMENT

ADJUST THE STIFFNESS OF BOTH THE PULL-OUT AND SWIVEL FUNCTION.

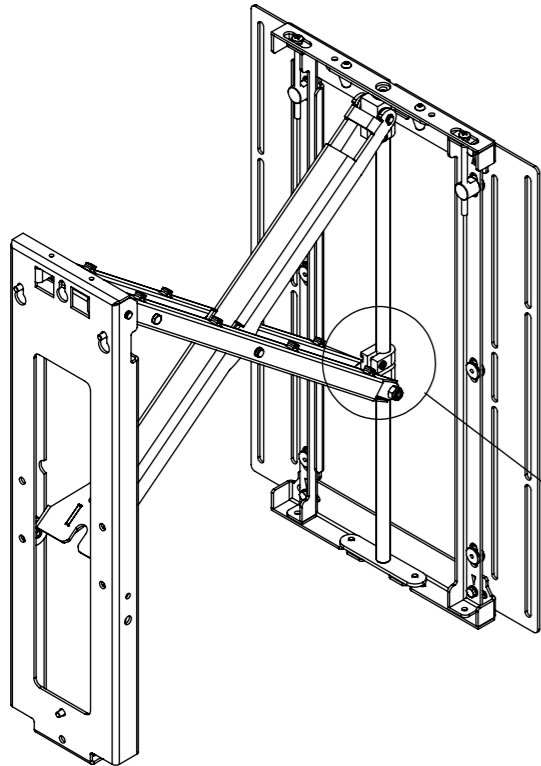

TOP FRICTION
ADJUSTMENT BOLT

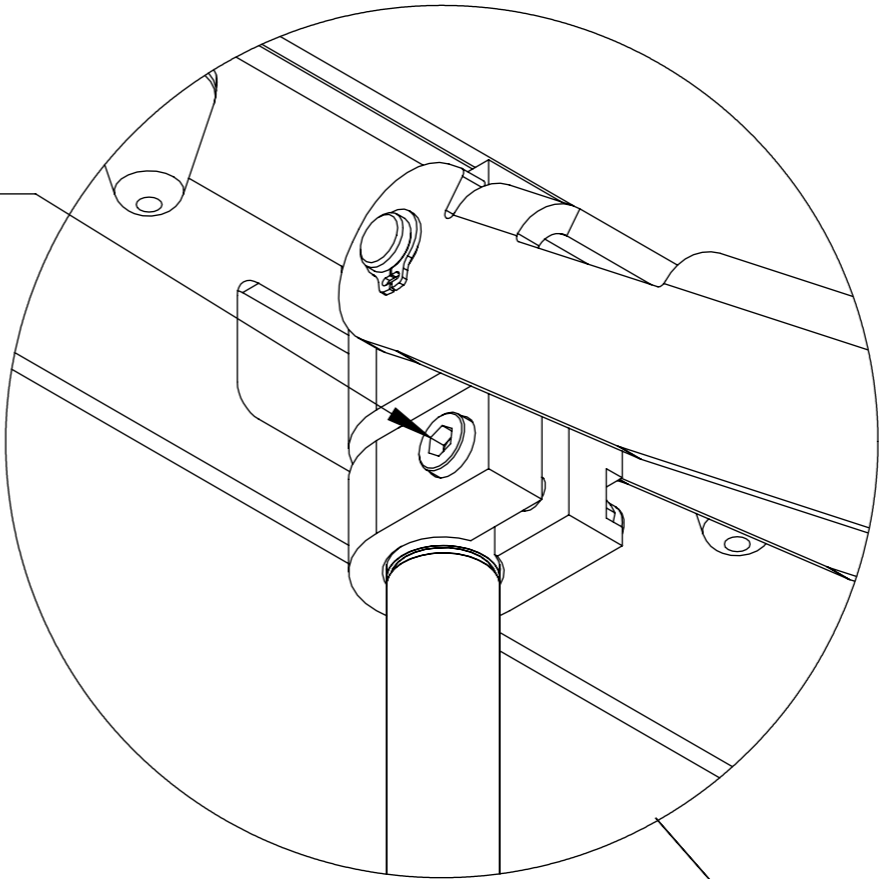

ADJUST THE TOP FRICTION BOLT TO
CHANGE THE STIFFNESS OF THE
PULL-OUT FUNCTION.

ADJUST THE BOTTOM FRICTION
BOLT TO CHANGE THE STIFFNESS
OF THE SWIVEL FUNCTION.

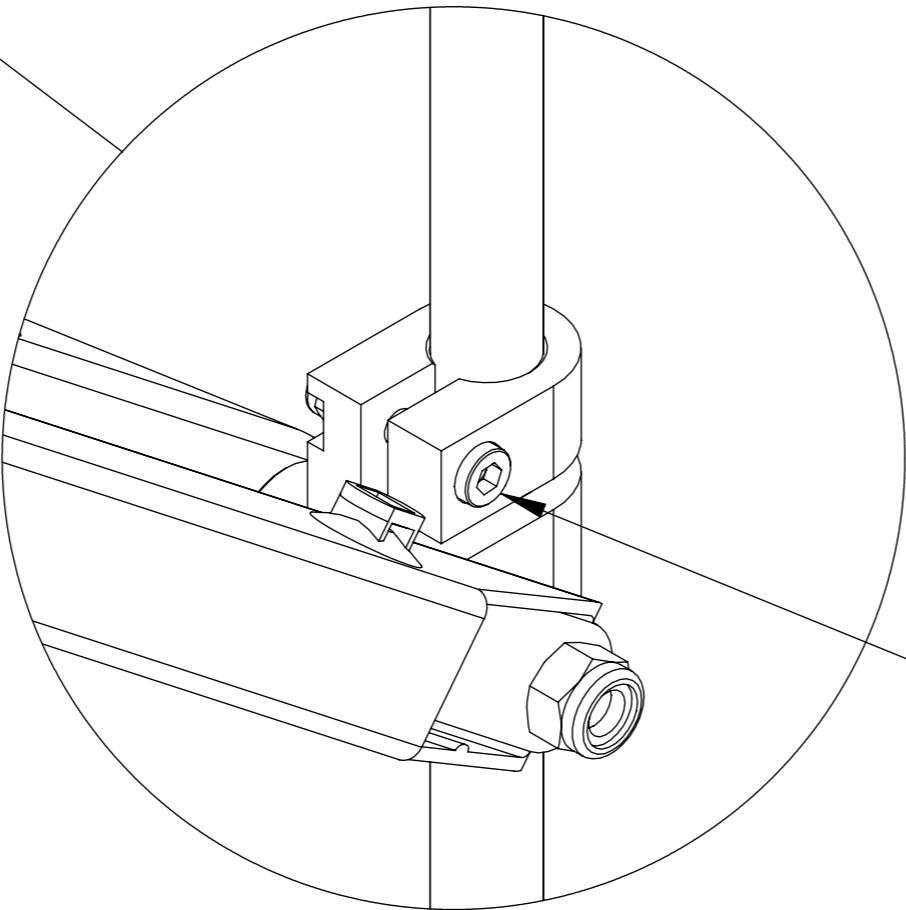

BOTTOM FRICTION
ADJUSTMENT BOLT

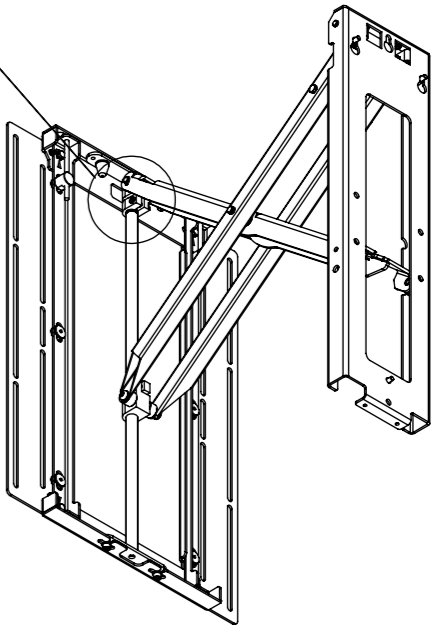

PS55-MO

MARINE OUTDOOR PULL & SWIVEL BRACKET

MARINE CATCH CABLE ROUTING

CABLE ROUTING BOSS KIT

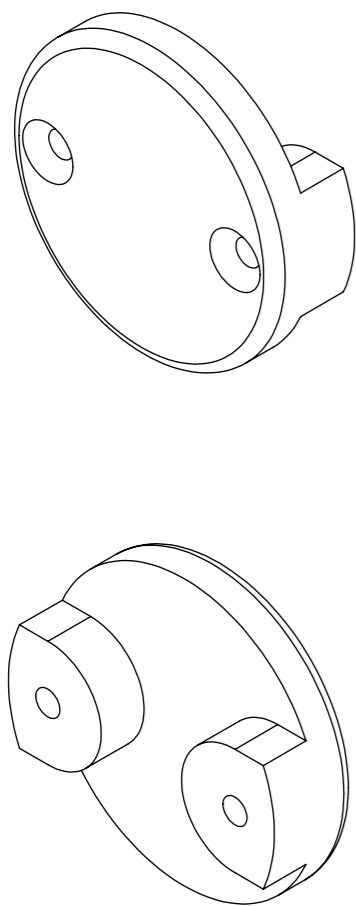

4 x CABLE ROUTING BOSSES ARE **PROVIDED** AS STANDARD WITH THE MARINE PS BRACKET.

ADDITIONAL SETS CAN BE PURCHASED WITH CODE **CRB-PS-M**

BALL & SOCKET KIT

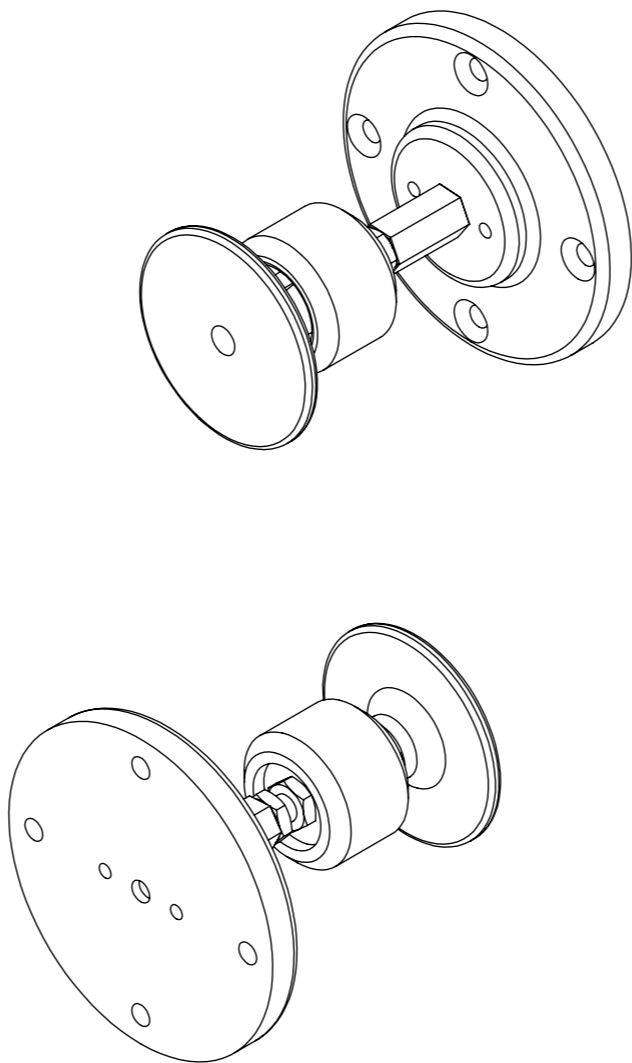

SETS OF 4 x BALL AND SOCKET CATCES TO BE USED WITH THE MARINE PS BRACKET TO RETAIN AND STABLISE THE SCREEN EDGES.

FOR FULL DETAILS, REFER TO **BS-PS-M** TECHNICAL SHEET.

RUBBER POST KIT

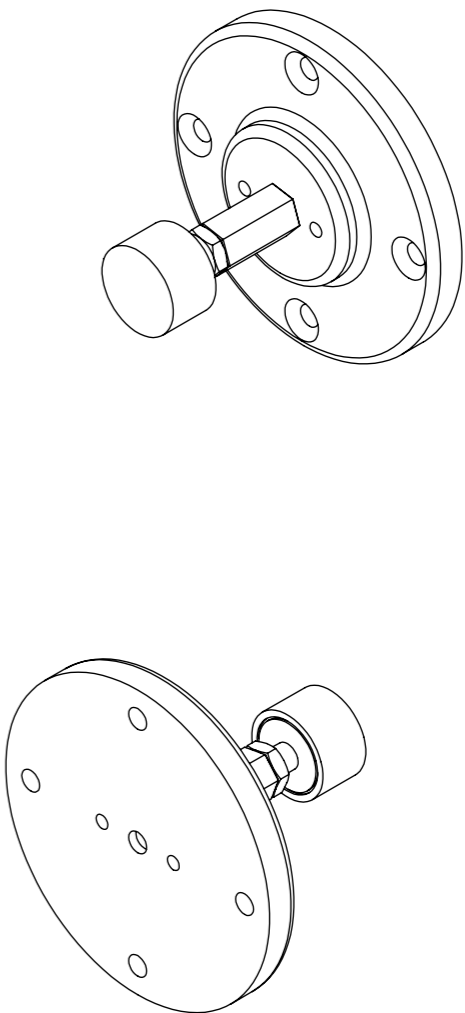

SETS OF 4 x RUBBER SCREEN POSTS TO BE USED WITH THE MARINE PS BRACKET TO STABLISE THE SCREEN EDGES.

FOR FULL DETAILS, REFER TO **RP-PS-M** TECHNICAL SHEET.