

# UB-JBA

## JUNCTION BOX ASSEMBLY

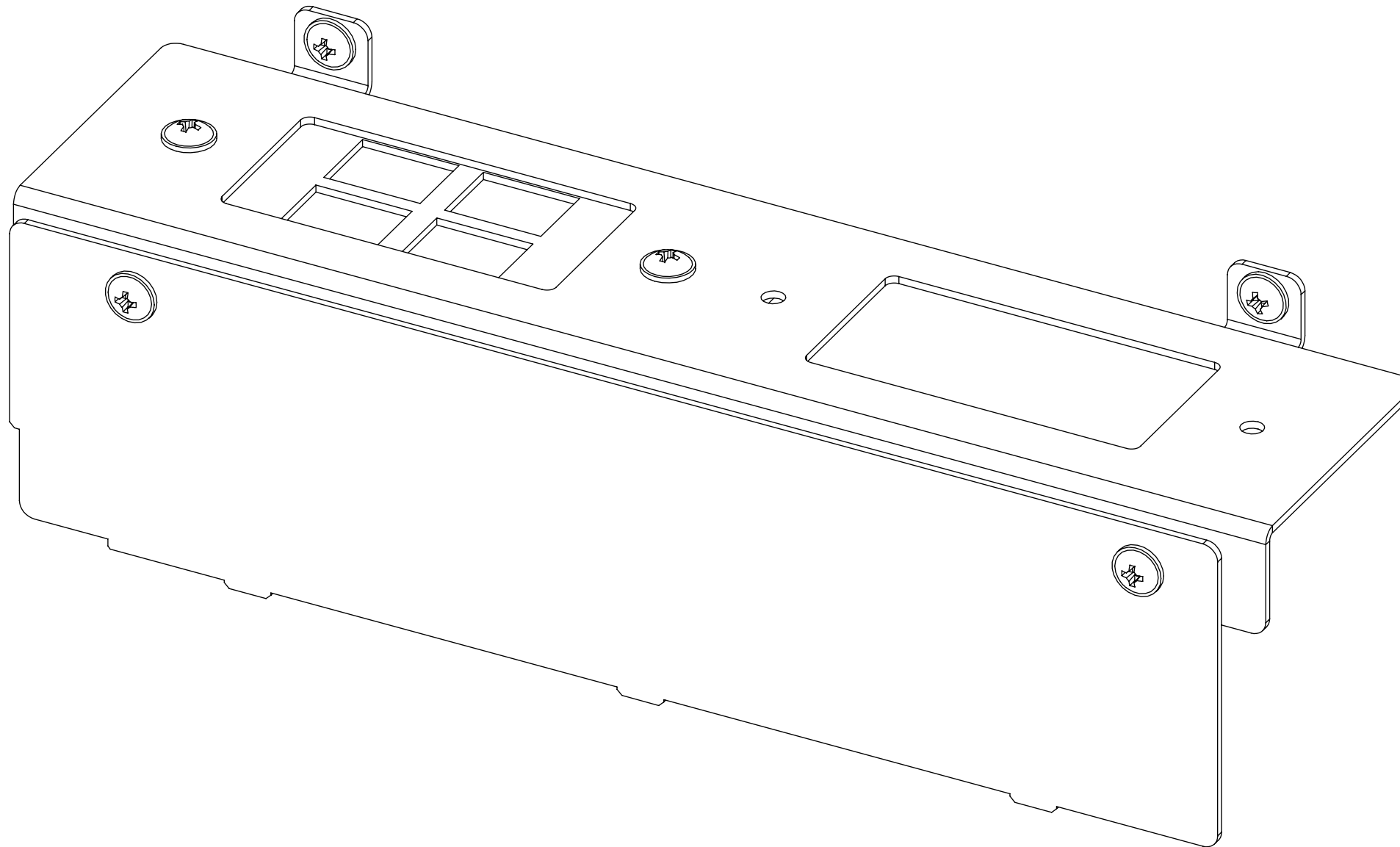

future automation



# UB-JBA

## JUNCTION BOX ASSEMBLY

SPECIFICATION	MEASUREMENTS
Product Dimensions	255mm (10") x 84mm (3 5/16") x 80mm (3 1/8")
Product Weight	0.5Kg (1.1lb)
Packaging Dimensions	300mm (11 13/16") x 100mm (4") x 100mm (4")
Shipping Weight	0.75Kg (1.75lb)
Package Contents	Junction Box Assembly Kit, Fixings

# UB-JBA

## JUNCTION BOX ASSEMBLY



future automation

### JUNCTION BOX FITTING

UB-JBA CAN BE FITTED IN SIMPLE STAGES IN TO THE WALL BOX.

CENTRAL DIVIDER PLATE CAN BE FITTED OR OMITTED AS REQUIRED.

UB-JBA CAN BE FITTED TO TOP, BOTTOM OR BOTH SIDES OF THE WALL BOX.

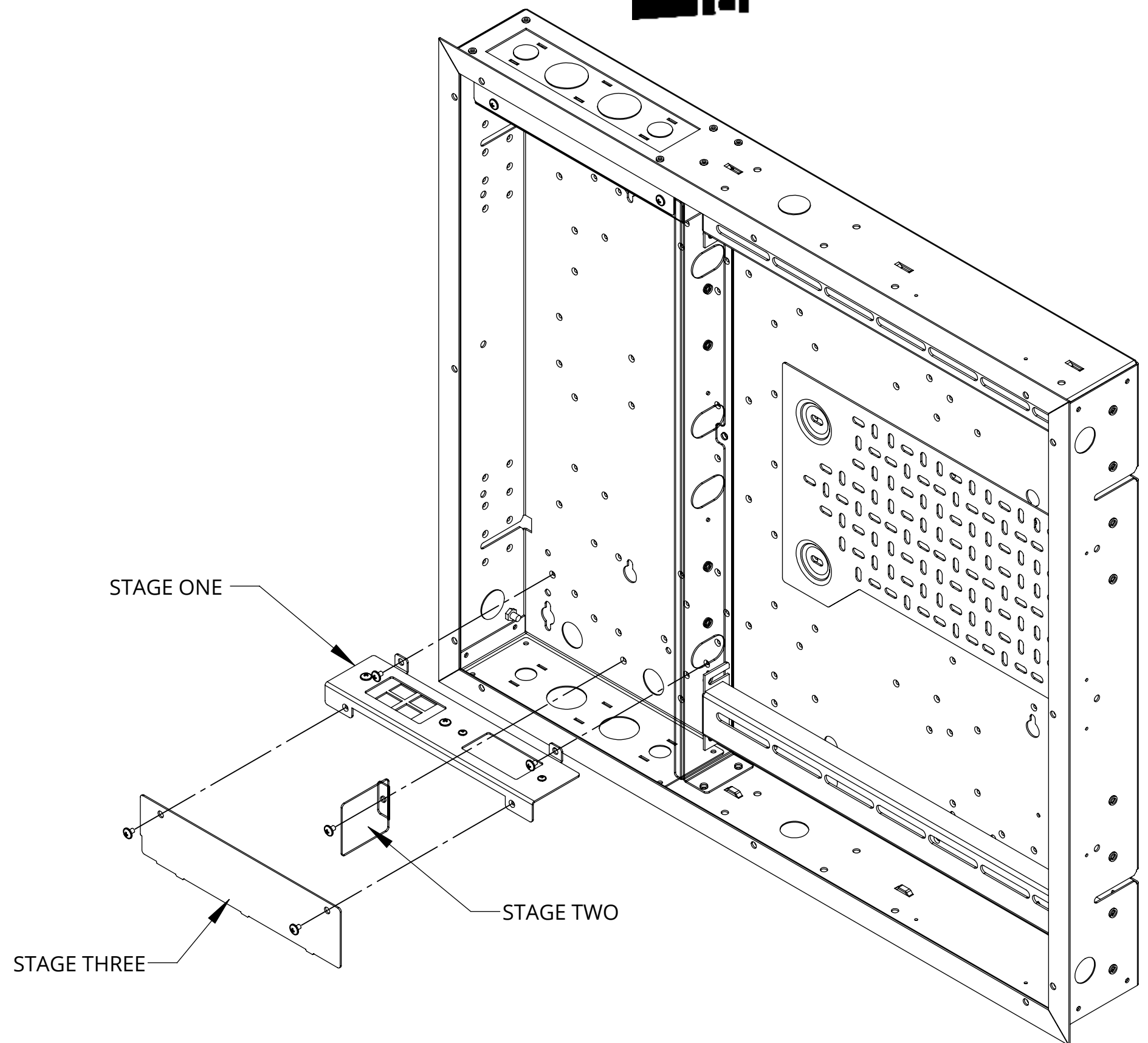
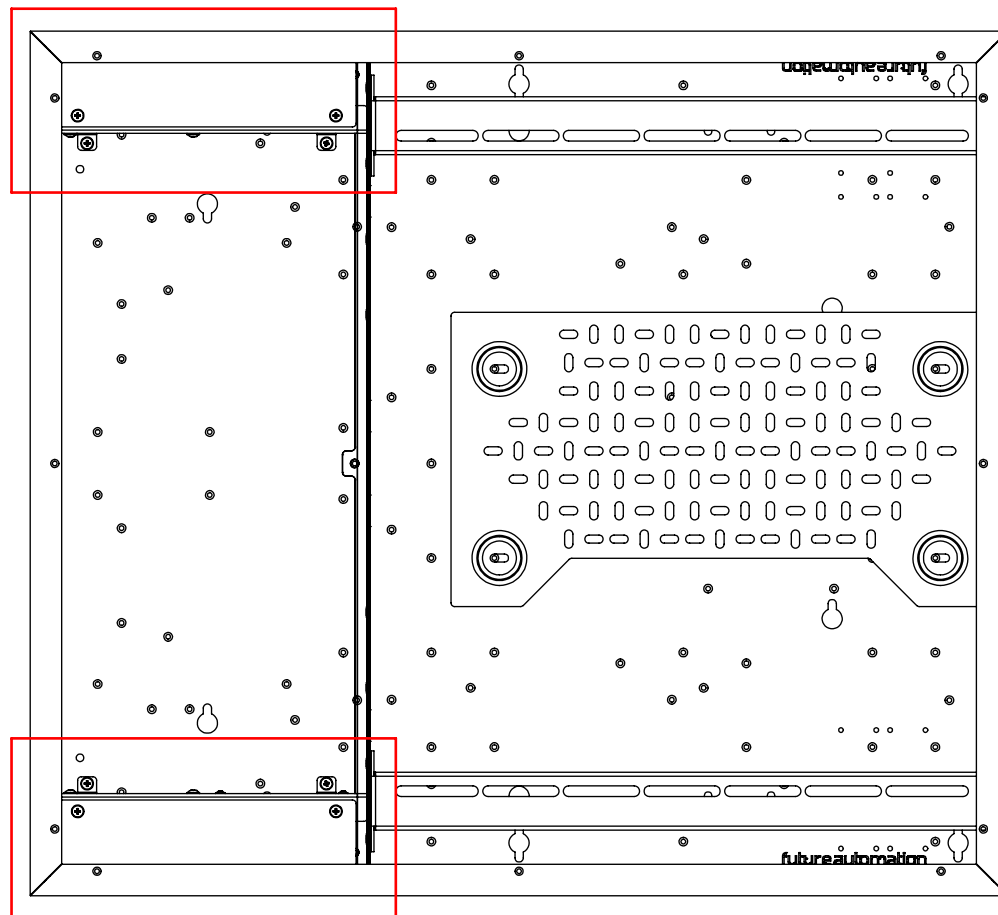

# UB-JBA

## JUNCTION BOX ASSEMBLY

### CONTENTS

Included with this kit are:

- 1x Top Plate
- 1x Central Divider Plate
- 1x Keystone Plate - 4 Port
- 1x Front Cover Plate

All fixings needed to fit parts to standard UB Wall Box.

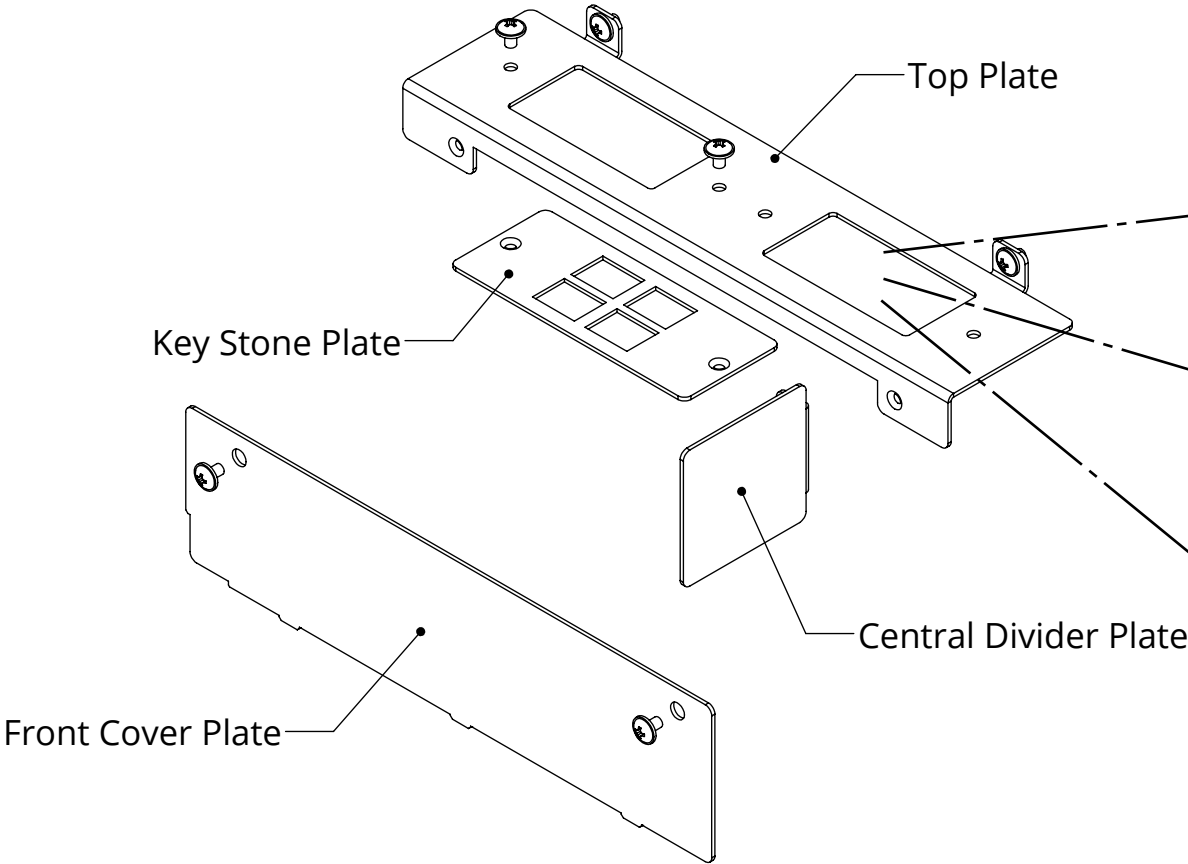

### ORDER SEPARATE:

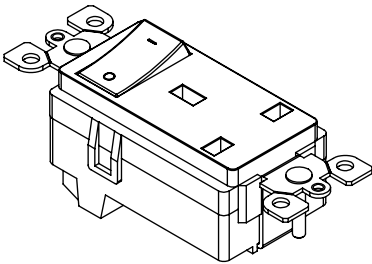

MPO-UK:  
UK Plug Outlet

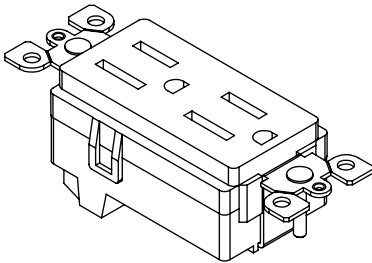

MPO-US:  
US Plug Outlet

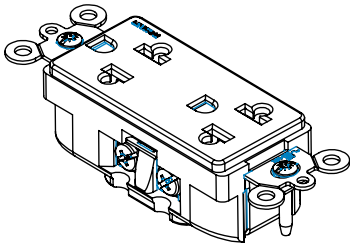

MPO-EU:  
EU Plug Outlet

### ALTERNATE CONFIGURATIONS

DUAL KEYSTONES

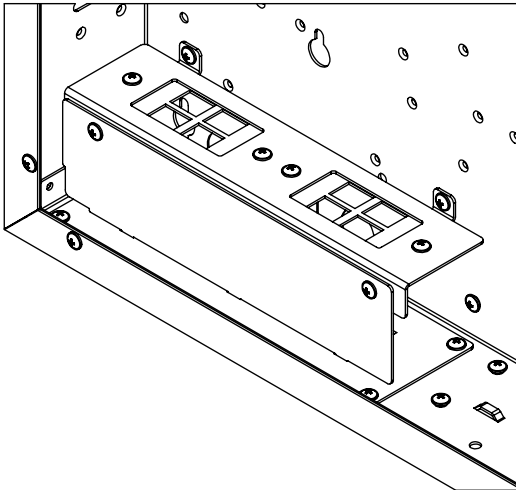

DUAL MPO OUTLETS

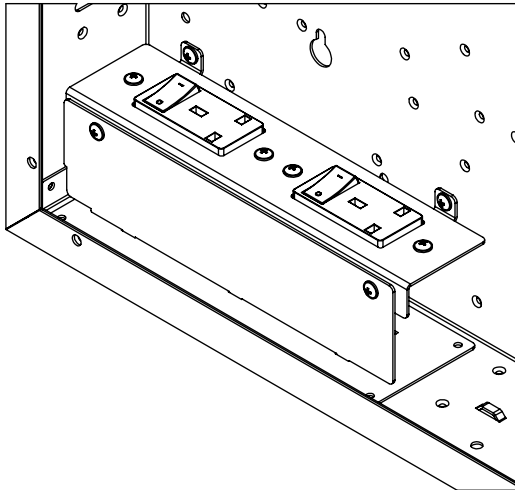

SWITCHED MPO AND KEYSTONE

