

DRAPER

EN

Original Instructions
Version 2 – March 2026

GRAVITY

AIR PAINT SPRAY GUN

28358



1. Preface

These are the original product instructions. Read the instruction manual in full and retain for future reference.

Please visit drapertools.com/manuals for the latest version of this manual and the associated parts list, if applicable.

1.1 Product Reference

User Manual for: Gravity Air Paint Spray Gun

Stock No: 28358

Part No: DAT-GASG500

1.2 Revisions

Version 1: June 2022

First release

Version 2: March 2026

1.3 Understanding the Safety Content of This Manual



WARNING! – Situations or actions that may result in personal injury or death.



CAUTION! – Situations or actions that may result in damage to the product or surroundings.

Important: – Information or instructions of particular importance.

2. Contents

1. Preface	2	7. Operating Instructions	10
1.1 Product Reference	2	7.1 The Fluid Control Dial	10
1.2 Revisions	2	7.2 The Spray Control Dial	10
1.3 Understanding the Safety Content of This Manual	2	7.3 The Air Cap	10
2. Contents	2	7.4 The Trigger	10
3. Product Introduction	3	7.5 Notes on Use	11
3.1 Intended Use	3	8. Maintenance and Troubleshooting	12
3.2 Specification	3	8.1 General Maintenance	12
4. Health and Safety Information	3	8.2 Cleaning the Spray Gun	12
4.1 General Health and Safety Precautions	3	8.3 Storing the Product	12
4.2 Additional Safety Instructions for Air Tools	4	8.4 Troubleshooting	13
5. Identification and Unpacking	5	9. Spares, Returns and Disposal	14
5.1 Product Overview.	5	10. Warranty	14
5.2 What's in the Box?	6	11. Explanation of Symbols	15
5.3 Packaging	6		
6. Preparation Instructions	7		
6.1 Preparing the Air Supply for Use	7		
6.2 Cleaning the Product and Accessories Before First Use	8		
6.3 Setting the Nozzle Size	8		
6.4 Assembly, Filling and Connection to the Air Supply	9		

3.1 Intended Use

This product is a gravity-feed spray paint gun for use with compressed air systems and is suitable for use with all types of paint, including water-based paints. Part of our core range, this product is suitable for regular use by enthusiasts and tradespersons alike.

Read this manual in full before attempting to assemble, operate or maintain the product, and retain it for later use.

3.2 Specification

Stock No.	28358
Part No.	DAT-GASG500
Nozzle size	1.4/1.8mm
Cup capacity	500ml
Operating air pressure	50psi (3.5bar)
Air inlet	1/4" BSP
Net weight	0.4kg

4. Health and Safety Information

Important: Read all Health and Safety instructions before attempting to operate, maintain or repair this product. Failure to follow these instructions may result in injury or damage to the user or the product.

4.1 General Health and Safety Precautions

- Only authorised personnel who have carefully read and understood this manual may operate, adjust and repair this product.
- Observe all standard safety precautions and good practices when working with air tools.
- **ALWAYS** wear adequate eye protection and a face mask when using this product.
 - Some products suitable for use with this product may contain chemicals or toxic components.
 - Avoid inhalation or contact with materials used with this product.
 - If contact occurs, seek medical advice as soon as possible.
- Wear ear defenders and protective gloves while using this product.
- Keep your work environment clear and well-lit, with bystanders at a safe distance.
- Use this product **ONLY** in well-ventilated areas to avoid the build-up of fumes and allow paint particles to disperse.

- Keep out of reach of children.
- Before every use, inspect the tools for missing, broken, loose or corroded parts.
- **Important: DO NOT** use this product if it is damaged in any way. Contact Draper Tools to discuss repair and replacement options.
- Ensure that all accessories and attachments are securely tightened before use.
- Use the product only in the manner instructed in this manual.
- **DO NOT** modify this product in any way.
- **ONLY** use spare parts supplied by Draper Tools.
- Stay alert at all times; **DO NOT** use this product while tired or under the influence of alcohol, drugs or other medication.

4. Health and Safety Information

4.2 Additional Safety Instructions for Air Tools

- Compressed air can cause severe injury.
 - **ALWAYS** turn off and disconnect the air supply before making any adjustments to the product or leaving it unattended.
 - **NEVER** direct this product towards yourself or others.
 - Ensure that compressed air is not blocked by or in contact with any part of your body.
- **ONLY** use clean, dry and regulated compressed air.



WARNING! NEVER use oxygen, combustible gases or other bottled gasses as a supply for this product. Use of these substances may cause the product to explode.

- Use of a whip hose between the tool and the air supply is recommended to reduce vibration.



CAUTION! Whipping hoses can cause severe injury. ALWAYS check for and replace damaged or loose hoses and fittings.

- Ensure that the product is compatible with the air supply before use.
- Ensure all connections are securely tightened.
- **DO NOT** exceed the maximum stated air pressure.
 - The pressure of the connected air supply **MUST NOT** exceed more than 10% of the rated pressure of the product.
- **DO NOT** obstruct the ability of the trigger to release once depressed.
- **NEVER** carry the tool by the hose.
- Some parts of the spray gun may become hot during use.
 - Allow the nozzle and paint cup to cool after use before handling or adjusting them.
- **NEVER** spray flammable substances near open flames or sources of heat and ignition.
 - **DO NOT** smoke in the vicinity of this product.
- **DO NOT** use this tool in temperatures that do not fall within 0–40°C.



WARNING! The use of solvents that contain halogenated hydrocarbons in pressurised systems with aluminium or galvanised parts may cause chemical reactions that result in an explosion. This product contains components that will be affected by the presence of halogenated hydrocarbons.

DO NOT use halogenated hydrocarbons with this product. Many halogenated hydrocarbons can be identified by the presence of reductions of fluorine (e.g. fluoro-), bromine (e.g. bromo-), chlorine (e.g. chloro-) or iodine (e.g. iodo-).

5.1 Product Overview.

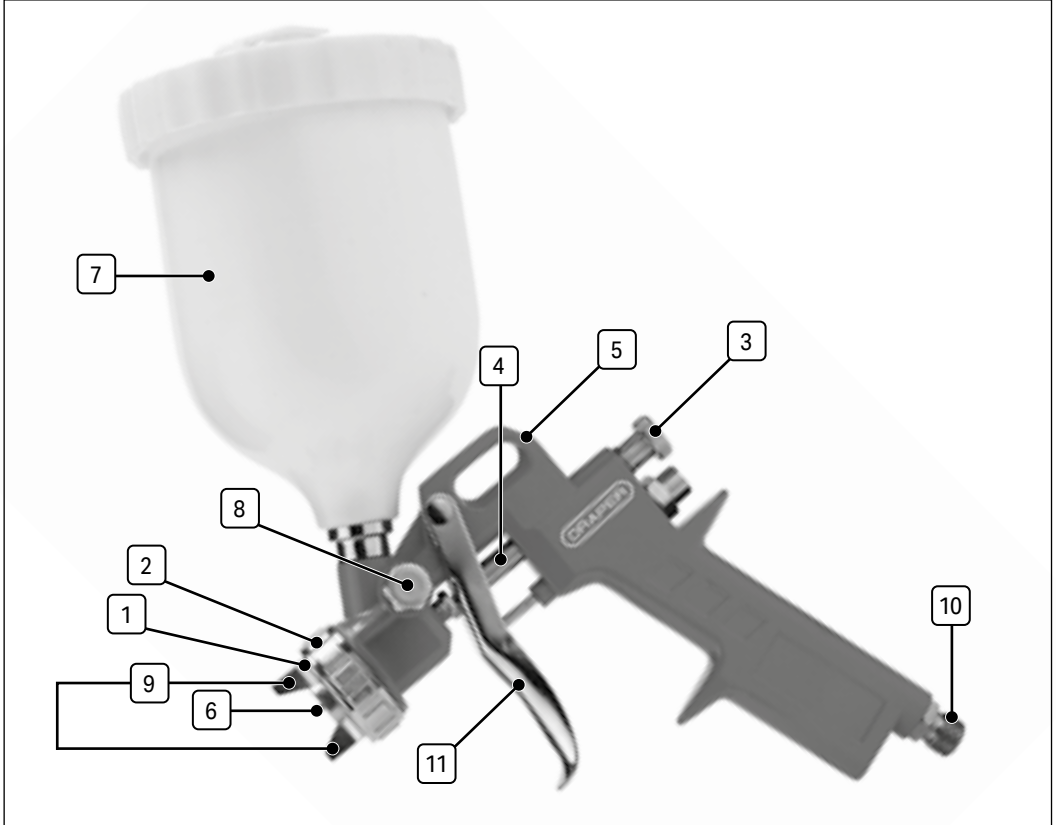

- | | | | |
|---|--------------------|----|--------------------------|
| 1 | Air cap | 7 | Paint cup |
| 2 | Air cap lock ring | 8 | Spray control dial |
| 3 | Fluid control dial | 9 | Spray direction control |
| 4 | Fluid needle | 10 | Spray gun air line inlet |
| 5 | Hanging loop | 11 | Trigger |
| 6 | Nozzle | | |

5. Identification and Unpacking

5.2 What's in the Box?

Carefully remove the product from the packaging and examine it for any signs of damage that may have occurred during shipment.

Before assembling the product, lay the contents out and check them against the parts shown below. If any part is damaged or missing, **DO NOT** attempt to use the product. Please contact the Draper Helpline; contact details can be found at the back of this manual.

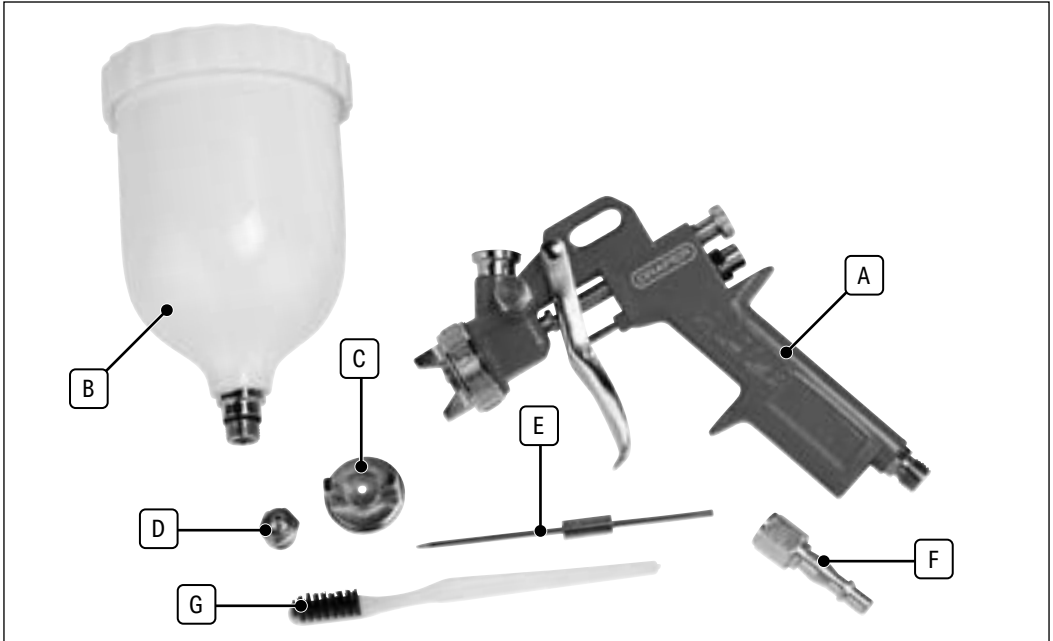

- | | | | |
|----------|--------------------------------|----------|---------------------------------|
| A | 1 × Spray gun body | E | 2 × Fluid needles (1.4*, 1.8mm) |
| B | 2 × 500ml paint cup | F | 1 × 1/4" BSP air line coupler |
| C | 2 × Air caps (1.4*, 1.8mm) | G | 1 × Brush |
| D | 2 × Nozzle heads (1.4*, 1.8mm) | | |

5.3 Packaging

Keep the product packaging for the duration of the warranty period for reference should the product need to be returned for repair.

WARNING! Keep packaging materials out of reach of children. Dispose of packaging correctly and responsibly and in accordance with local regulations.

Please visit drapertools.com for our full range of accessories and consumables.

*Pre-installed before shipment.

6. Preparation Instructions

Important: Before using this product, read and understand all the safety instructions listed in this manual.

6.1 Preparing the Air Supply for Use

This air tool operates at a maximum pressure of 3.5bar (50psi).

The compressed air system must be controlled by a combination pressure regulator and moisture filter; this will ensure a constant supply of dry air at all times, provided it is properly maintained.

IMPORTANT: ALWAYS check the machine operating pressure before use.

Water in the compressor tank may cause considerable corrosion to air tools; the compressor should be drained daily to avoid excessive water in the air supply. Dirty or wet air can significantly shorten the lifespan of the product.

When using an air tool with a hose over 25ft long, increasing the bore of the hose to the next largest available size is recommended (i.e. increase 3/8" to 1/2"). This will ensure adequate pressure and volume of air to power the tool.

⚠ CAUTION! DO NOT lubricate the air line when using paint spray guns. Ensure that any oil device has been removed and any residual oil purged from the system before connecting the spray gun.

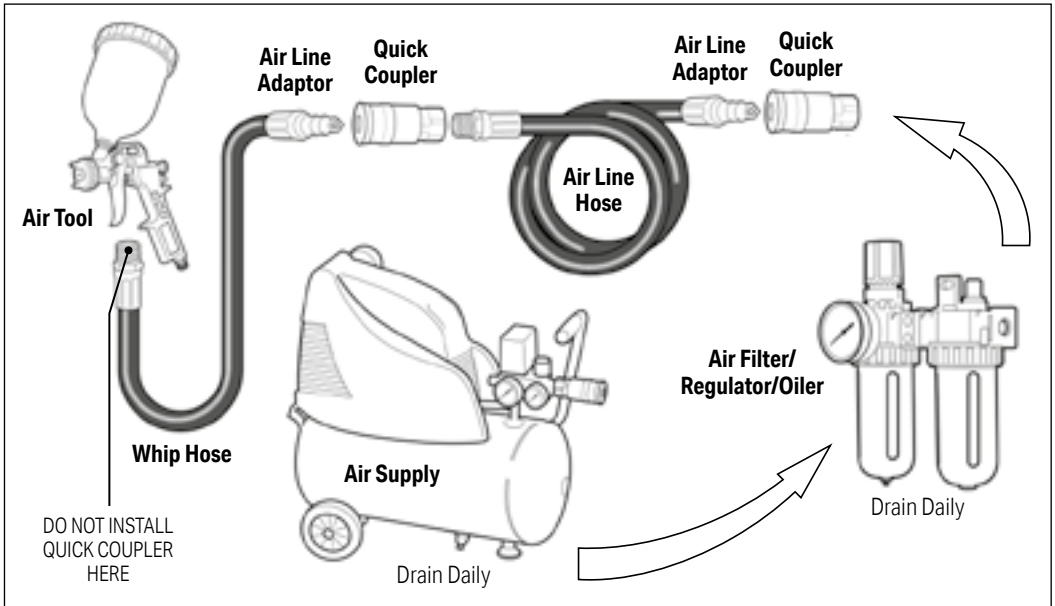

Fig. 1

6. Preparation Instructions

6.2 Cleaning the Product and Accessories Before First Use

Before first use, the spray gun must be cleaned thoroughly to remove any oil, grease, and the protective film applied before shipment.

1. Disassemble the spray gun and immerse all parts and accessories in spray gun cleaning fluid.
2. Soak the parts for a few minutes.
3. Allow the parts to dry and then wipe them clean with a damp cloth.
4. Assemble the spray gun (see 6.4) and half-fill the paint cup (7) with thinners.
5. **Important: DO NOT** connect the spray gun to the regulator or air line at this time.
6. Squeeze the trigger (11) to flush the thinners through the spray gun until the paint cup is empty.
7. Immerse and soak the assembled spray gun in the cleaning fluid for a few more minutes.
8. Allow the parts to dry, then wipe them clean.

6.3 Setting the Nozzle Size

The spray gun is supplied with two nozzle sizes. To change the nozzle, the installed nozzle assembly must be removed and replaced with the appropriate parts.

Important: ALWAYS ensure that the matching air cap, nozzle head and fluid needle are used. **DO NOT** mix sizes.

1. Unscrew the air cap lock ring (2) and remove the lock ring, air cap (1) and gasket (12) (Fig. 2).

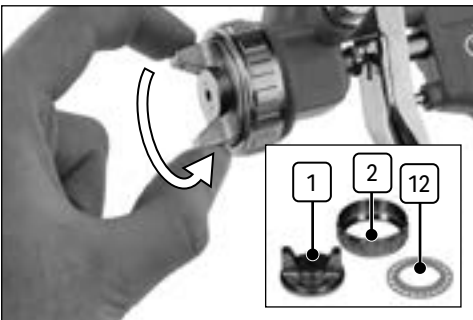

Fig. 2

2. Unscrew and remove the nozzle head (13) (Fig. 3).

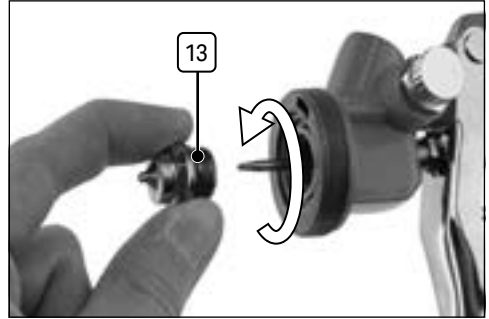

Fig. 3

3. Rotate the fluid control dial (3) anticlockwise until it comes away from the spray gun body (Fig. 4).

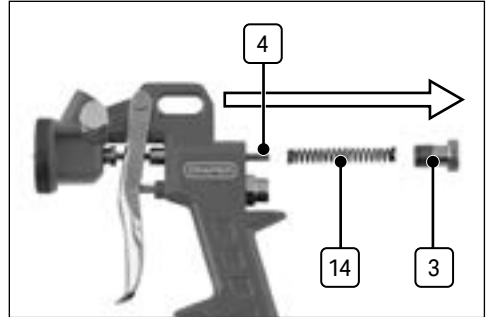

Fig. 4

4. Remove the spring (14) and fluid needle (4) from the chamber via the back of the spray gun.
5. Screw the new nozzle head onto the front of the spray gun.
6. Ensure that the new fluid needle (4) is free from debris and insert it point-first into the needle chamber through the back of the spray gun body (Fig. 5).



6. Preparation Instructions

7. Pass the spring onto the flat end of the fluid needle and screw the fluid control dial back into place.
8. Pass the new air cap through the back of the air cap lock ring.
9. Insert the gasket into the air cap lock ring with the lip on the inner edge facing away from the air cap.
10. Screw the air cap assembly onto the spray gun body.
11. Test the trigger to ensure smooth operation.

6.4 Assembly, Filling and Connection to the Air Supply

Important: It is recommended to use a 1/4" BSP thread whip hose to connect the spray gun to an air line in order to reduce vibration.

1. Attach the paint cup **B** to the threaded socket at the top of the spray gun body (Fig. 6).

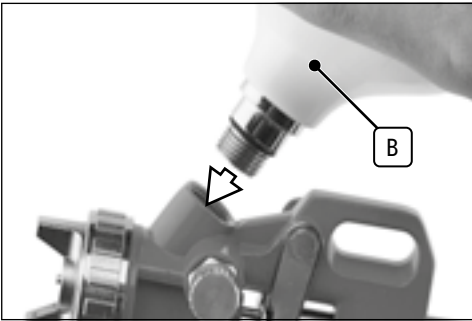

Fig. 6

2. Rotate the fluid control dial **3** clockwise as far as possible to close the fluid valve (Fig. 7).

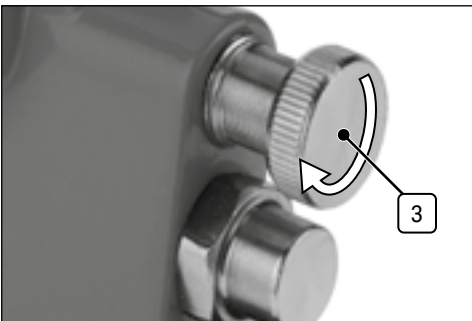

Fig. 7

3. Wrap a length of PTFE tape around the spray gun air line inlet **10** (Fig. 8).

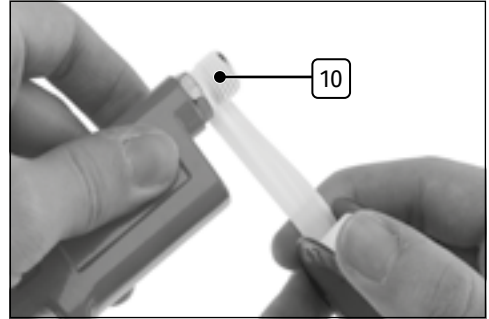

Fig. 8

Important: For a more secure seal, the PTFE tape should be wrapped in the opposite direction to the thread.

If using a whip hose, wrap a length of PTFE tape around the whip hose inlet and attach it to the air line.

4. Screw the 1/4" air line coupler **F** onto the spray gun air inlet (Fig. 9).

If using a whip hose, attach a parallel union nut instead of the air line coupling.

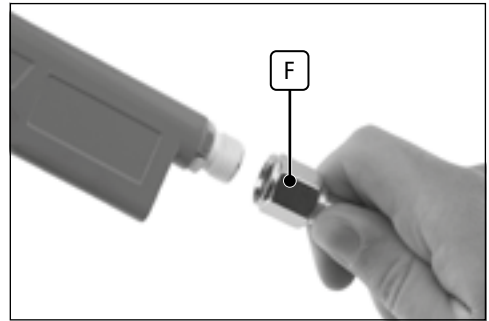

Fig. 9

5. Connect the air line to the air line coupling.
6. Unscrew the paint cup lid and pour in the required quantity of paint.

Important: ALWAYS ensure that the paint is mixed and thinned to the manufacturer's recommendations.

7. Pressurise the air line when you are ready to begin.

7. Operating Instructions

Important: Before using this product, read and understand all the safety instructions listed in this manual. **DO NOT** make any adjustments to the spray gun while the trigger is depressed.

7.1 The Fluid Control Dial

The fluid control dial (3) adjusts the amount of paint that is released into the air flow and the density of the spray when the trigger is fully depressed (Fig. 10):

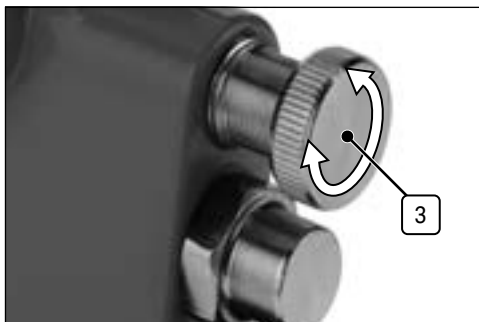

Fig. 10

- **To increase the paint quantity and density:**
Rotate the nozzle regulator anticlockwise.
 - The paint quantity should be increased when the spray gun is positioned further from the surface or when the paint mixture has a higher viscosity.
- **To decrease the paint quantity and density:**
Rotate the nozzle regulator clockwise.
 - The paint quantity should be decreased when the spray gun is positioned closer to the surface or when the paint mixture has a lower viscosity.

7.2 The Spray Control Dial

The spray control dial (8) adjusts the shape of the paint jet released from the nozzle. The spray control dial can be rotated more than 360° (Fig. 11).

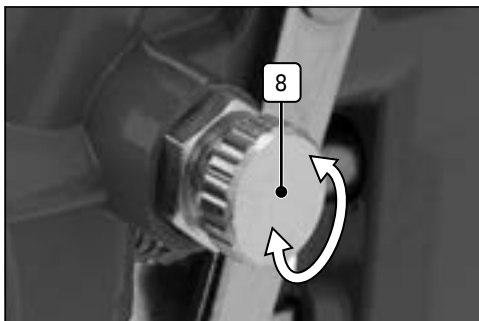

Fig. 11

- **Fuller, flatter pattern:** Rotate the dial clockwise.
- **Narrower, rounder pattern:** Rotate the dial anticlockwise.

7.3 The Air Cap

The air cap (1) has three types of opening that affect the pattern of the fluid spray (Fig. 12):

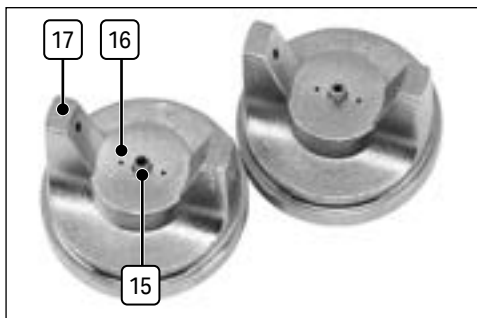

Fig. 12

- A hole for the nozzle head from which the fluid is dispersed (15).
- Atomising air holes (16) that break the fluid into a fine spray.
- Air horn holes (17) that shape the spray pattern as required.

Once the spray pattern has been set using the control dial, rotate the air cap to change the orientation of the jet.

Important: ALWAYS ensure that the air cap remains tightly secured after adjusting its orientation.

7.4 The Trigger

Paint is released from the spray gun by squeezing the trigger (11) (Fig. 13):

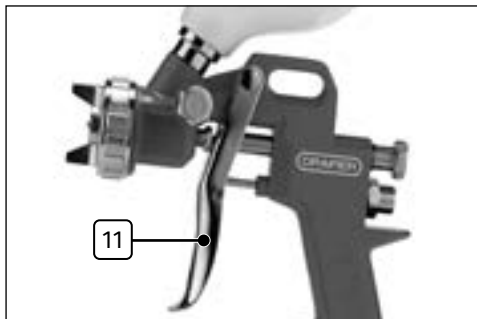

Fig. 13

1. First, squeeze the trigger until resistance is met; this opens the air valve.
2. Squeeze the trigger the rest of the way to draw the fluid pin back and release paint from the nozzle.

Important: Draper Tools recommends that you test the spray output on an area of scrap material before working on the actual surface. Adjust the control dials to produce an even flow in the desired pattern. **ALWAYS** release the trigger before making any adjustment to the spray gun.

7.5 Notes on Use

- Keep the spray gun 6–8" away from the surface during operation.
- Start moving the spray gun **BEFORE** squeezing the trigger to prevent a build-up of paint at the starting point.

- Move the spray gun with a smooth motion, keeping it perpendicular to and at a constant distance from the surface at all times (Fig. 14).
- **DO NOT** rock or pivot the spray gun as this will deliver uneven coverage of the surface.
- **DO NOT** hold the spray gun in a static position while the trigger is depressed as this will deliver uneven coverage.
- Slightly overlap the movements of the spray gun to ensure an even distribution at the edges of each stroke.
- Use a piece of scrap material at the edges of the area to prevent overspray and protect other surfaces.
- Alter the speed of the movement, the distance from the surface and the fluid control dial setting to adjust the thickness of the paint applied to the surface.
- Release the trigger **BEFORE** completing the spray gun movement at the end of the final stroke to prevent a build-up of paint at the finishing point.

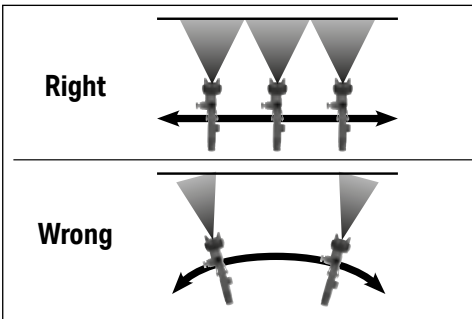

Fig. 14

8. Maintenance and Troubleshooting

Important: Read all the Health and Safety information in this manual before attempting to maintain this product. All maintenance should be carried out **ONLY** by authorised and suitably qualified personnel.

 **WARNING! ALWAYS ensure that the tools are disconnected from the air supply and that the air supply is switched off before attempting to adjust or maintain this product.**

8.1 General Maintenance

- Keep the spray guns clean and dry when not in use.

 **CAUTION! NEVER lubricate the spray gun or its accessories with oil, grease, or any silicone-based product.**



8.2 Cleaning the Spray Gun

Important: ALWAYS ensure that the brush is clean before using it on any part of the spray gun. **DO NOT** use sharp objects to clean any openings on the spray gun as this may damage the internal parts.

 **CAUTION! DO NOT soak parts in solvents or cleaning fluids for too long as prolonged exposure may cause damage to the seals and other components.**

1. Use compressed air to clean inside the air line inlet.
2. Clean the paint cup and fluid chamber:
 - a. Remove the paint cup lid and pour any remaining fluid into a suitable container.
 - b. Half-fill the paint cup with an appropriate thinners and replace the lid.
 - c. Squeeze the trigger and spray all the liquid through the tool.

Important: ALWAYS spray the cleaning fluid safely into a suitable container.

- d. Repeat this process if the cleaning fluid is not completely clean when discharged.
- e. Wipe the paint cup clean. Clean the air cap and nozzle head:
 - a. Remove the air cap  and nozzle head  (see **6.3 Setting the Nozzle Size**).
 - b. Soak the parts in a solvent to clear clogged holes or openings, then rinse clean.
 - c. Clean the inside and outside of the air cap and nozzle head using the brush .

 **CAUTION! Take great care to avoid damaging the openings in the air cap and nozzle head during cleaning as this will affect the spray pattern.**

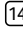
3. Clean the fluid needle and chamber:
 - a. Remove the fluid needle  and spring  (see **6.3 Setting the Nozzle Size**).
 - b. Soak the parts in the solvent and rinse clean.
 - c. Clean all parts of the fluid needle using the brush.
4. Soak the spray gun body in the solvent, then rinse it clean and brush it with the brush.
5. Reassemble the spray gun (see **6.3 Setting the Nozzle Size**).
6. Test the trigger to ensure smooth operation.

8.3 Storing the Product

When the spray guns and their accessories are not in use:

- Switch off and disconnect the air line from the tool.
- Clean the tool thoroughly before storage.
- Store the tool in a clean and dry location, out of the reach of children.

8.4 Troubleshooting

Problem	Possible Cause	Remedy
Paint leaks from the nozzle when not in use.	Dust or dirt around the nozzle opening or fluid needle is preventing an airtight seal with the paint cup.	Clean the fluid needle and nozzle head (see 8.2).
	The nozzle head or fluid needle is damaged.	Replace the nozzle head or fluid needle as appropriate. Contact Draper Tools for repair and replacement options.
The spray gun delivers a curved or one-sided spray pattern.	The openings in the air cap or nozzle are clogged or damaged.	Clean the air cap (see 8.2) and nozzle or replace the parts if necessary. Contact Draper Tools for repair and replacement options.
The spray pattern is too thick.	The fluid viscosity is too high.	Thin the fluid as appropriate.
	The air pressure at the nozzle is too low.	Increase the air pressure and check the tool for leaks or blockages.
	The fluid needle or nozzle head has become worn and the separation between them has increased.	Replace the nozzle head or fluid needle as appropriate. Contact Draper Tools for repair and replacement options.
The spray pattern is too thin.	The fluid viscosity is too low.	Thicken the fluid as appropriate.
	The air pressure at the nozzle is too high.	Decrease the air pressure and check the tool for blockages.
The spray output splutters or is inconsistent.	The fluid level in the paint cup is too low.	Top up the fluid in the paint cup.
	Air is mixing with the fluid due to a leak or broken seal.	Check the tightness of the paint cup and the fluid needle bolt beside the trigger.
	The fluid needle does not create a seal against the inside of the nozzle head when the trigger is released.	Clean or replace the fluid needle and nozzle head as necessary.
The fluid in the paint cup bubbles or boils.	The paint cup is not sealed or is not tightly attached to the spray gun.	Clean, tighten or replace the paint cup as appropriate.
	The spray gun is being held at an ineffective angle.	Hold the spray gun in a more upright position.
	The openings in the air cap are clogged or damaged.	Clean the air cap (see 8.2) or replace the part if necessary. Contact Draper Tools for repair and replacement options.

8. Maintenance and Troubleshooting

8.4 Troubleshooting *(continued)*

Problem	Possible Cause	Remedy
The centre of the spray pattern is too narrow or the whole pattern is not wide enough.	The fluid viscosity is not appropriate for the spray gun and must be adjusted.	Increase the fluid viscosity for a thicker centre; decrease the fluid viscosity for a broader pattern.
Air is leaking from the air cap.	The air valve is sticking or bent.	Clean the air valve and replace it if it is bent or damaged. Contact Draper Tools for repair and replacement options.
	The air valve seal or spring is broken.	Replace the parts as necessary. Contact Draper Tools for repair and replacement options.
The tool does not spray the fluid.	The air pressure at the spray gun is too low.	Check and regulate the air pressure accordingly.
	The fluid control dial setting is too low.	Rotate the fluid control dial clockwise to increase the flow.
	The fluid is too viscous.	Thin the fluid as appropriate.
	The fluid level in the paint cup is too low.	Top up the fluid in the paint cup.

9. Spares, Returns and Disposal

For spare parts, servicing, and repair and replacement options, please contact the Draper Tools Product Helpline for details of your nearest authorised agent.

Draper Tools will endeavour to hold any spare parts, if applicable, for seven years from the date that it sells the final matching stock item.

Any servicing or repairs carried out by unauthorised personnel or installation of spare parts not supplied by Draper Tools will invalidate your warranty.

Important: For safety, **ALWAYS** drain and clean the product of any oil, fuel, chemicals or other substances before returning it to Draper Tools or its authorised

agent. Store these materials in suitable containers and dispose of them in accordance with local regulations. Draper Tools and its agents cannot be responsible for the disposal of these substances.

At the end of its working life, dispose of the product responsibly and in line with local regulations. Recycle where possible.

DO NOT dispose of this product with domestic waste; most local authorities provide appropriate recycling facilities.



10. Warranty

6 months from date of purchase – Visit drapertools.com/warranty for more information.

However, if the tools are hired out, the warranty period is reduced to 90 days from the date of purchase.

This warranty does not cover consumable parts, normal wear & tear, damage, misuse, careless or unsafe handling.

Draper Tools Limited

11. Explanation of Symbols



Read the instruction manual



Warning!



DO NOT abandon in the environment



Wear suitable eye protection and breathing apparatus



Wear ear defenders



Wear protective gloves



Air inlet



Max. operating air pressure



Max. fluid capacity



Supplied air cap sizes

Contact Details

Draper Tools Limited

Hursley Road
Chandler's Ford
Eastleigh
Hampshire
SO53 1YF
UK

Website: drapertools.com

Email: sales@drapertools.com

Product Helpline: +44 (0) 23 8049 4344

Telephone Sales Desk: +44 (0) 23 8049 4333

General Enquiries: +44 (0) 23 8026 6355

Draper Tools Europe B.V.

Oude Graaf 8
6002 NL
Weert
Netherlands

Please contact the Draper Tools Product Helpline for repair and servicing enquiries.