



**EN**

Original Instructions  
Version 1  
December 2025

18V BRUSHLESS  
**PRUNER  
SAW**

**31872**



These are the original product instructions.  
Read the instruction manual in full and retain  
for future reference.

Please visit [drapertools.com/manuals](https://www.drapertools.com/manuals) for the latest  
version of this manual and the associated parts list,  
if applicable.



# 1. Preface

## 1.1 Product Reference

**User Manual for:** 18V Brushless Pruner Saw

**Stock No:** 31872

**Part No. :** DXGC01

## 1.2 Revisions

**Version 1:** December 2025

First release

As our manuals are continually updated, always ensure that the latest version is used.

Please visit [drapertools.com/manuals](http://drapertools.com/manuals) for the latest version of this manual and the associated parts list, if applicable.

## 1.3 Understanding the Safety Content of This Manual

 **WARNING!** – Situations or actions that may result in personal injury or death.

 **CAUTION!** – Situations or actions that may result in damage to the product or surroundings.

**Important:** – Information or instructions of particular importance.

## 1.4 Copyright © Notice

Copyright © Draper Tools Limited.

Permission is granted to reproduce this manual for personal and educational use **ONLY**. Commercial copying, redistribution, hiring or lending is strictly prohibited.

No part of this manual may be stored in a retrieval system or transmitted in any other form or means without written permission from Draper Tools Limited.

In all cases, this copyright notice must remain intact.

# 2. Contents

1. Preface	2
1.1 Product Reference	2
1.2 Revisions	2
1.3 Understanding the Safety Content of This Manual	2
1.4 Copyright © Notice	2
2. Contents	2
3. Product Introduction	3
3.1 Intended Use	3
3.2 Specification	3
4. Health and Safety Information	4-9
4.1 General Power Garden Tool Safety Warnings	4
4.2 General Safety Instructions for Pruner Saws	6
4.3 Causes and Operator Prevention of Kickback	6
4.4 Additional Safety Warnings for Pruner Saws	7
4.5 Safety instructions for Main Powered Chargers & Battery Packs	8
4.6 Connection to the Power Supply (Charger)	9
4.7 Residual Risk	9
5. Identification and Unpacking	10
6. Assembly instructions	11-13
6.1 Attaching/Adjusting the Guide Bar and Chain	11
6.2 Tensioning the Saw Chain	12
6.3 Checking and Topping up the Chain Lubricating Oil	12
6.4 Run in Time for new Saw Chains	12
6.5 Charging the Battery	13
6.6 Battery Pack Charge Status	13
6.7 Tool Battery Fitting	13
7. Operating the Pruner Saw	14
7.1 Stating/Stopping the Pruner Saw	14
7.2 Basic operation	14
8. Maintenance and Storage	14-15
9. Disposal	15
10. Warranty	15
11. Explanation of Symbols	15

# 3. Product Introduction

## 3.1 Intended Use

This multi-functional tool is designed for cutting grass, weeds and edge trimming and for the removal of weeds and moss from between paving stones, patios and other paved surfaces.

Any other application beyond the conditions established for use will be considered misuse. Draper Tools accepts no responsibility for improper use of this product.

This product is intended for domestic and infrequent light-duty trade use.

## 3.2 Specification

<b>Stock No.</b>	<b>31872</b>
<b>Part No.</b>	<b>DXGC01</b>
Rated Voltage	18V
Chain Speed (no load)	5,000rpm
Maximum cutting depth	145mm
Oil tank capacity	50ml
<b>Noise Emissions</b>	
Sound pressure level	80.95dB(A)
Sound power level	88.95dB (A)
Uncertainty (K)	3dB (A)
<b>Vibration level</b>	
Uncertainty (K)	1.5m/s <sup>2</sup>
Net Weight (without battery)	1.27kg
Run time with 4Ah battery (no load)	approx. 60mins

### 4.0Ah Battery Pack

Type	Li-ion
Rating	4000mAh/72Wh
Rated voltage	18V

### 4.5A Charger

Rated Input	230V/50Hz
Rated output	81W

### Rated DC Output

Voltage	18V
Current	4.5A
Construction	Class II
Charging temperature	5 to 30°C
Charging time (approx.)	60mins (4Ah battery)

**Important:** The declared vibration total values and noise emissions values have been measured in accordance with a standard test method and may be used for comparing one tool with another. These values may also be used in a preliminary assessment of exposure.



**WARNING!** The vibration and noise emissions during actual use of the product can differ from the declared values depending on the type of work and the area upon which it is used. Before each use, estimate the likely exposure resulting from the actual conditions of use. Take into account **all** parts of the operation cycle in order to identify any safety measures required to protect the operator.

## 4. Health and Safety Information

---

### 4.1 General Power Garden Tool Safety Warnings



**WARNING!** Read all safety warnings, instructions, illustrations and specifications provided with this garden power tool. Failure to follow all instructions listed below may result in electric shock, fire and/or serious injury.

Save all warnings and instructions for future reference.

The term 'power tool' in the warnings refers to your mains-operated (corded) garden power tool or battery-operated (cordless) garden power tool.

#### Work Area Safety

- **Keep work area clean and well lit.**
  - Cluttered or dark areas invite accidents.
- **DO NOT operate power tools in explosive atmospheres, such as in the presence of flammable liquids, gases or dust.**
  - Power tools create sparks which may ignite the dust or fumes.
- **Keep children and bystanders away while operating a power tool.**
  - Distractions can cause you to lose control.

#### Electrical Safety

- **Power tool plugs must match the outlet. NEVER modify the plug in any way. DO NOT use any adapter plugs with earthed (grounded) power tools.**
  - Unmodified plugs and matching outlets will reduce risk of electric shock.
- **Avoid body contact with earthed or grounded surfaces, such as pipes, radiators, ranges and refrigerators.**
  - There is an increased risk of electric shock if your body is earthed or grounded.
- **DO NOT expose power tools to rain or wet conditions.**
  - Water entering a power tool will increase the risk of electric shock.
- **DO NOT abuse the cord. NEVER use the cord for carrying, pulling or unplugging the power tool. Keep cord away from heat, oil, sharp edges or moving parts.**
  - Damaged or entangled cords increase the risk of electric shock.
- **When operating a power tool outdoors, use an extension cord suitable for outdoor use.**
  - Use of a cord suitable for outdoor use reduces the risk of electric shock.

- **If operating a power tool in a damp location is unavoidable, use a residual current device (RCD) protected supply.**
  - Use of an RCD reduces the risk of electric shock.

#### Personal Safety

- **Stay alert, watch what you are doing and use common sense when operating a power tool. DO NOT use a power tool while you are tired or under the influence of drugs, alcohol or medication.**
  - A moment of inattention while operating power tools may result in serious personal injury.
- **Use personal protective equipment. Always wear eye protection.**
  - Protective equipment such as a dust mask, non-skid safety shoes, hard hat or hearing protection used for appropriate conditions will reduce personal injuries.
- **Prevent unintentional starting. Ensure the switch is in the 'OFF' position before connecting to power source, picking up or carrying the tool.**
  - Carrying power tools with your finger on the switch or energising power tools that have the switch on invites accidents.
- **Remove any adjusting key or wrench before turning the power tool on.**
  - A wrench or a key left attached to a rotating part of the power tool may result in personal injury.
- **DO NOT overreach. Keep proper footing and balance at all times.**
  - This enables better control of the power tool in unexpected situations.
- **Dress properly. DO NOT wear loose clothing or jewellery. Keep your hair, clothing and gloves away from moving parts.**
  - Loose clothes, jewellery or long hair can be caught in moving parts.
- **If devices are provided for the connection of dust extraction and collection facilities, ensure these are connected and properly used.**
  - Use of dust collection can reduce dust-related hazards.
- **DO NOT let familiarity gained from frequent use of tools allow you to become complacent and ignore tool safety principles.**
  - A careless action can cause severe injury within a fraction of a second.

## Power Tool Use and Care

- **DO NOT force the power tool. Use the correct power tool for your application.**
  - The correct power tool will do the job better and safer at the rate for which it was designed.
- **DO NOT use the power tool if the switch does not turn it on and off.**
  - Any power tool that cannot be controlled with the switch is dangerous and must be repaired.
- **Disconnect the plug from the power source and/or remove the battery pack, if detachable, from the power tool, before making any adjustments, changing accessories or storing power tools.**
  - Such preventive safety measures reduce the risk of starting the power tool accidentally.
- **Store idle power tools out of the reach of children and DO NOT allow persons unfamiliar with the power tool or these instructions to operate the power tool.**
  - Power tools are dangerous in the hands of untrained users.
- **Maintain power tools and accessories. Check for misalignment or binding of moving parts, breakage of parts and any other condition that may affect the power tool's operation. If damaged, have the power tool repaired before use.**
  - Many accidents are caused by poorly maintained power tools.
- **Keep cutting tools sharp and clean.**
  - Properly maintained cutting tools with sharp cutting edges are less likely to bind and are easier to control.
- **Use the power tool, accessories and tool bits etc. in accordance with these instructions, taking into account the working conditions and the work to be performed.**
  - Use of the power tool for operations different from those intended could result in a hazardous situation.
- **Keep handles and grasping surfaces dry, clean and free from oil and grease.**
  - Slippery handles and grasping surfaces **DO NOT** allow for safe handling and control of the tool in unexpected situations.

## Service

- **Have your power tool serviced by a qualified repair person using only identical replacement parts.**
  - This will ensure that the safety of the power tool is maintained.
- **NEVER service damaged battery packs. Service of battery packs should only be performed by the manufacturer or authorised service providers.**

## Battery Tool Use and Care

- **Recharge only with the charger specified by the manufacturer.**
  - A charger that is suitable for one type of battery pack may create a risk of fire when used with another battery pack.
- **Use power tools only with specifically designated battery packs.**
  - Use of any other battery packs may create a risk of injury and fire.
- **When battery pack is not in use, keep it away from other metal objects, like paper clips, coins, keys, nails, screws or other small metal objects, that can make a connection from one terminal to another.**
  - Shorting the battery terminals together may cause burns or a fire.
- **ALWAYS switch off the tool and remove the battery before changing accessories or adjusting the tool.**
- **DO NOT use a battery pack or tool that is damaged or modified.**
  - Damaged or modified batteries may exhibit unpredictable behaviour resulting in fire, explosion or risk of injury.
- **DO NOT expose a battery pack or tool to fire or excessive temperature.**
  - Exposure to fire or temperature above 130 °C may cause explosion.
- **Follow all charging instructions and DO NOT charge the battery pack or tool outside the temperature range specified in the instructions.**
  - Charging improperly or at temperatures outside the specified range may damage the battery and increase the risk of fire.
- **If the tool is operated continuously until the battery pack has discharged, allow the tool to rest for 15 minutes before continuing with a fresh battery.**

---

## 4.2 General Safety Instructions for Pruner Saws

- **Keep all parts of the body away from the saw chain when the pruner saw is operating. Before you start the saw ensure the saw chain is not contacting anything.**
  - A moment of inattention while operating saws may cause entanglement of your clothing or body with the saw chain.
- **Hold the pruner saw by insulated gripping surfaces only, because the saw chain may contact hidden wiring or its own cord.**
  - Saw chains contacting a 'live' wire may make exposed metal parts of the pruner saw 'live' and could give the operator an electric shock.
- **Wear eye protection. Further equipment for hearing, head, hands, legs and feet is recommended.**
  - Adequate protective equipment will reduce personal injury from flying debris or accidental contact with the saw chain.
- **DO NOT operate a pruner saw in a tree, on a ladder, from a rooftop, or any unstable support.**
  - Operating of a pruner saw in this manner could result in serious personal injury.
- **ALWAYS keep proper footing and operate the saw only when standing on fixed, secure and level surface.**
  - Slippery or unstable surfaces may cause a loss of balance or control of the saw.
- **When cutting a branch that is under tension, be alert for spring back.**
  - When the tension in the wood fibres is released, the spring-loaded branch may strike the operator and/or throw the saw out of control.
- **Use extreme caution when cutting brush and saplings.**
  - The slender material may catch the saw chain and be whipped toward you or pull you off balance.
- **Carry the saw by the handle with the saw switched off and away from your body. When transporting or storing the saw, ALWAYS fit the guide bar cover.**
  - Proper handling of the saw will reduce the likelihood of accidental contact with the moving saw chain.

- **Follow instructions for lubricating, chain tensioning and changing the bar and chain.**
  - Improperly tensioned or lubricated chain may either break or increase the chance of kickback.
- **Cut wood only. DO NOT use the saw for purposes not intended. For example: DO NOT use saw for cutting metal, plastic, masonry or non-wood building materials.**
  - Use of the pruner saw for operations different than intended could result in serious injury to the operator or bystanders.
- **This pruner saw is not intended for tree felling.**
- **Follow all instructions when clearing jammed material, storing or servicing the pruner saw. Ensure the switch is off and the battery pack is removed.**
  - Unexpected actuation of the pruner saw while clearing jammed material or servicing may result in serious personal injury.

## 4.3 Causes and Operator Prevention of Kickback

- Kickback may occur when the nose or tip of the guide bar touches an object, or when the wood closes in and pinches the saw chain in the cut.
- Tip contact in some cases may cause a sudden reverse reaction, kicking the guide bar up and back towards the operator.
- Pinching the saw chain along the top of the guide bar may push the guide bar rapidly back towards the operator.
  - Either of these reactions may cause you to lose control of the saw which could result in serious personal injury. **DO NOT** rely exclusively upon the safety devices built into your saw. As a pruner saw user, you should take several steps to keep your cutting jobs free from accident or injury.

**Kickback is the result of saw misuse and/or incorrect operating procedure or conditions and can be avoided by taking proper precautions as given below:**

- **Maintain a firm grip, with thumbs and fingers encircling the saw handle with both hands on the pruner saw and position your body and arm to allow you to resist kickback forces.**
  - Kickback forces can be controlled by the operator, if proper precautions are taken. **DO NOT** let go of the saw.

- **DO NOT overreach and DO NOT cut above shoulder height.**

- This helps prevent unintended tip contact and enables better control of the saw in unexpected situations.

- **Only use replacement guide bars and saw chains specified by Draper Tools.**

- Incorrect replacement guide bars and saw chains may cause chain breakage and/or kickback.

- **Follow the instructions supplied for sharpening and maintenance of the saw chain.**

- Decreasing the depth gauge height can lead to increased kickback.

#### 4.4 Additional Safety Warnings for Pruner Saws

- The saw is designed for cutting branches. **ONLY** use the saw for wood as recommended in these instructions. The saw is not designed for continuous professional use.
- This appliance is not intended for use by persons (including children) with reduced physical, sensory or mental capabilities, or lack of experience and knowledge, unless they have been given supervision or instructions concerning use of the appliance by a person responsible for their safety. Cleaning and user maintenance shall not be made by children.
- Children should be supervised to ensure they **DO NOT** play with the tool.
- Observe the safety warning symbols marked on the saw. Failure to do so could result in serious injury.
- The saw must be used only by used by one person at a time.
- **NEVER** operate the saw while people, especially children, or pets are nearby.
- Before each use visually inspect the saw for missing or damaged parts, in particular the guide bar and saw chain. Check for signs of wear or damage and replace parts if necessary.
- **ALWAYS keep proper footing and operate the saw only when standing on fixed, secure and level surface. Slippery or unstable surfaces may cause a loss of balance or control of the saw.**
- Hold the saw firmly and securely by the handle when switching on.
- Ensure the guide bar and chain run freely when switched on and must not come in to contact with the wood to be cut.
- Keep your hands away from the sawing area. **DO NOT** reach under the workpiece to avoid contact with the saw chain.
- Guide the saw onto the workpiece only after it is switched on. There is a risk of kickback if the saw chain becomes caught in the workpiece.
- When sawing the base plate must **ALWAYS** rest against the workpiece. The saw chain can become jammed, leading to loss of control of the saw.
- **To avoid kickback, ONLY** remove the saw chain out of the cut when the saw is switched off and has come to a complete stop.
- **DO NOT** support the workpiece with your hand or foot.
- **ALWAYS** use a saw stand/horse when sawing thin or small branches.
- When working on sloping ground, ensure to work facing upwards.
- Take extra care when cutting splintered wood, as the wood can be torn by the saw chain.
- Remove foreign objects such as nails, screw and metal parts to prevent damage or wear to the chain and guide bar.
- A blunt saw can cause overheating and damage to the motor.
- The operator is responsible for accidents causing injury to other people or damage to property.
- Wear appropriate PPE (personal protective equipment) including hearing and eye protection.
  - **ALWAYS** wear substantial footwear and long trousers while operating the tool.
  - **DO NOT** operate the machine when barefoot or wearing open sandals.
- **ONLY** use the machine in daylight or good artificial light.
- Only use replacement parts and accessories recommended by Draper Tools.
- Keep the ventilation openings clear of debris.
- The pruner saw should only be serviced and repaired by an authorised repairer.

---

## 4.5 Safety instructions for Main Powered Chargers & Battery Packs

- Before using the battery pack or charger, read all instructions and cautionary markings on the battery, charger and the product using the battery.

### Chargers

- The charger is for indoor use only. **DO NOT** expose to rain.
- Prior to plugging the charger in to the supply, check that the plug, cord and charger casing are in good condition. If any are damaged, have the defective part(s) replaced immediately by a suitably qualified person.
- **ONLY** use a correctly rated mains outlet to provide power, **DO NOT** plug into site generators, attach to engine generators or D.C. sources. **DO NOT** use a mains socket outlet that is not switched.
- Use the correct Draper charger in conjunction with its corresponding battery pack (Visit [drapertools.com](http://drapertools.com) for more information).
- The charger must be disconnected from the power supply before removing the battery.
- **DO NOT** charge any other batteries with Draper chargers. Any other application is considered misuse.
- **DO NOT** attempt to charge non-rechargeable batteries.
- **DO NOT** attempt to charge battery packs that are too hot (over 30°C) or too cold (under 5°C), if these conditions apply set the battery pack aside to 'normalise' before proceeding with the charging operation.
- Set up the charger and cord in a safe place where they will not be knocked, tripped over, stepped on, etc. and where it is well ventilated. Ensure the ventilation slots in the charger case are not obstructed.
- Switch the charger on and check that the correct indicators illuminate, allow the battery pack to charge. Once charging is complete, switch the charger off, disconnect from power supply, remove the battery pack and store.

### Battery Packs

- **ONLY** use Draper recommended battery packs with this tool.
- Inspect the battery pack for damage, if it is undamaged, plug it into the charger, ensuring the correct orientation.
- **DO NOT** short the battery pack:
  - **DO NOT** touch the terminals with any conductive material.
  - Avoid storing battery pack in a container with other metal objects such as nails, coins, etc.
  - **DO NOT** expose battery pack to water or rain.
- The battery must be removed from the tool before it is recycled.
- The battery is to be disposed of in-line with local authority procedures.
- **DO NOT** crush, open or burn the battery. Exposure to potentially harmful materials may occur.
- In case of fire use CO2 or dry chemical extinguisher.
- **DO NOT** expose to high temperatures >50°C. The battery may degrade at high temperatures.
- Charge battery in conditions between 5°C to 30°C with the designated charger for the battery.
- **DO NOT** use battery if it has been stored at 5°C or less. Allow it to 'normalise' at room temperature before usage/charging.



### **WARNING!** Leaking battery packs

- The electrolyte in battery packs is corrosive. Avoid contact with the skin.
- If contact is made, flush the area with clean water, pat dry and seek medical attention at the earliest opportunity.

## 4.6 Connection to the Power Supply (Charger)



### CAUTION!

Risk of electric shock. **DO NOT** open.

This appliance is supplied with an approved plug and cord for your safety.

This appliance is Class II and is designed for connection to a power supply matching that detailed on the rating label and compatible with the plug fitted.

If the power supply cord is damaged, it must be replaced by Draper Tools, an authorised service agent or similarly qualified personnel in order to avoid a hazard.

The damaged or incomplete plug, when cut from the cord, shall be disabled to prevent connection to a live electrical outlet.

The value of the fuse fitted is marked on the pin face of the plug. Should the fuse need replacing, use a small plain-slot screwdriver to remove the fuse cover. Ensure the substitute is of the correct rating, approved to BS 1362 and ASTA or BS Kite marked. This should only be performed by suitably qualified personnel.

ASTA  BSI 

**Important:** If an extension lead is required, use an approved and compatible lead rated for this appliance.

Unwind the entire cable and follow all the instructions supplied with the extension lead.

†Double insulated : This product requires no earth connection as supplementary insulation is applied to the basic insulation to protect against electric shock in the event of failure of the basic insulation.

## 4.7 Residual Risks

The safety instructions in this manual cannot account for all possible conditions and situations that may occur. Exercise common sense and caution when using this product and protect against any additional conceivable risks.

# 5. Identification and Unpacking

Carefully remove the product from the packaging and examine it for any signs of damage that may have occurred during shipment. If any part is damaged or missing, do not attempt to use the product. Please contact the Draper Helpline; contact details can be found at the back of this manual.

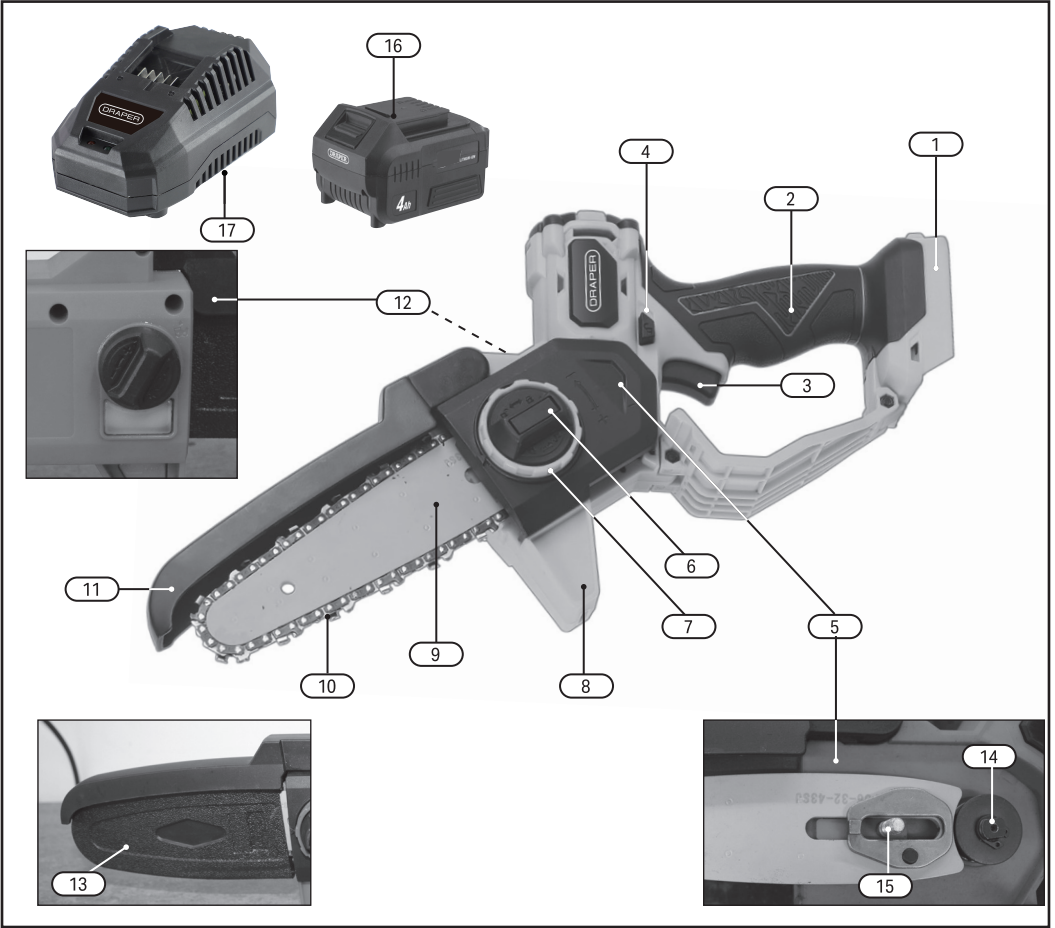

- |                                |                          |                            |
|--------------------------------|--------------------------|----------------------------|
| 1. Battery compartment         | 7. Chain adjustment ring | 13. Guide bar cover        |
| 2. Handle grip                 | 8. Base plate            | 14. Sprocket               |
| 3. <b>ON/OFF</b> speed trigger | 9. Guide bar             | 15. Guide bar location pin |
| 4. Trigger safety lock switch  | 10. Saw chain            |                            |
| 5. Sprocket cover              | 11. Guide bar guard      |                            |
| 6. Sprocket cover lock         | 12. Chain oil cap        |                            |

Please visit [drapertools.com](http://drapertools.com) for our full range of batteries, chargers, accessories and consumables. This cordless product is also compatible with the D20 range of batteries and chargers.

## 6. Assembly instructions

**Important:** Before preparing or adjusting this product, read and understand all the safety instructions listed in this manual.



### WARNING!

- **ALWAYS** switch off and unplug before fitting or removing any parts.
- **DO NOT** start the pruner saw before fitting and correctly adjusting the guide bar (9) and chain (10).
- **NEVER** put a new saw chain on a worn guide bar.

**Attention:** the saw chain is extremely sharp – **ALWAYS** wear gloves when handling.

### 6.1 Attaching/Adjusting the Guide Bar and Chain

1. Place the pruner saw on a flat level surface.

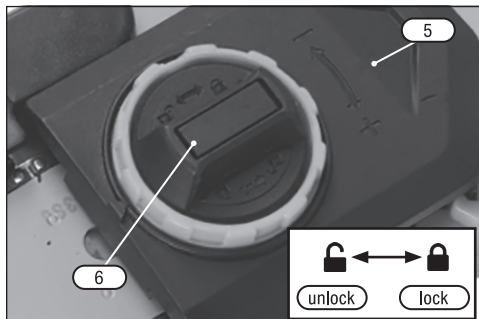



Fig. 1

2. Turn the sprocket cover (5) anticlockwise to  to unlock and remove the sprocket cover. Then remove the guide bar (9).

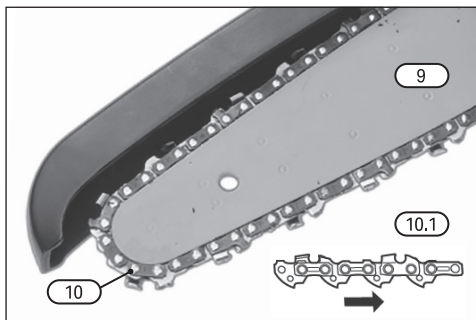

Fig. 2

3. Spread the chain (10) out with the cutting edges (10.1) running clockwise.

**Important:** when attaching the saw chain, observe the correct operating direction.

4. Slot the chain (10) links into the bar guide groove.

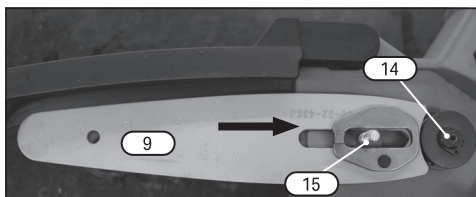

Fig. 3

5. Then fit the guide bar (9) over the location pin (15) and locate against the sprocket (14).

6. Fit the chain links onto the sprocket.

**Note:** It is normal for the chain to be slack at this stage.

7. Refit the sprocket cover and lightly tighten the lock to allow the saw chain to be tensioned.
8. Tighten the cover fully once chain tension adjusted correctly.

## 6.2 Tensioning the Saw Chain



**WARNING!** Risk of injury if the chain is not tensioned correctly.

- **DO NOT** over tighten the saw chain. Excessively high tension may cause the saw chain to break or wear and may break the sprocket.
- A chain that is too loose can jump off the guide bar.
- The saw chain may loosen with use. Check the tension before each use.

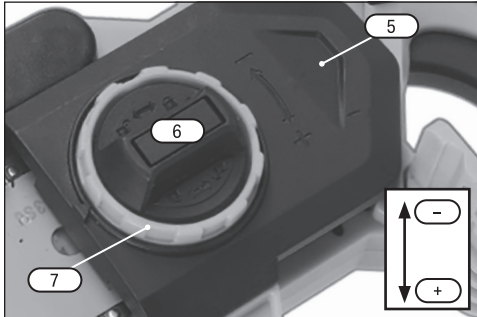

Fig. 4

1. Fit the sprocket cover (5) and lightly tighten the lock (6) to allow the saw chain to be tensioned.
    - **To tighten the chain** – turn the chain adjustment ring (7) in a clockwise (+) direction. Tighten the chain so the gap between the centre of the lower side of the bar and the chain is approximately 3 – 4mm.
    - **To loosen the chain tension** – turn the chain adjustment ring (7) in an anticlockwise (-) direction.
  2. Tighten the cover once the chain is adjusted.
  3. Check the tension of the chain before operating.
  4. Readjust the tension as required.
- The saw chain is correctly tensioned if it can be moved by hand (wear protective gloves) without sagging.
  - During operation the chain will heat up, and re-tensioning may be required.
  - Loosen the chain slightly after use so that not overtight when next used.
  - **DO NOT** retighten the chain if hot. Allow to cool before re-tensioning.

## 6.3 Checking and Topping up the Chain Lubricating Oil

1. Check the oil level in the tank before each use.
- **DO NOT** use the chainsaw without sufficient lubricating oil.
2. Place the chainsaw on a flat level surface.

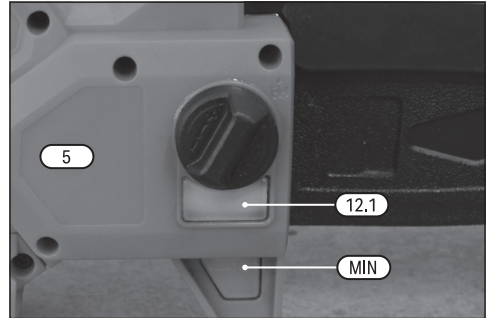

Fig. 5

3. Remove the oil filler cap (12) and carefully fill with oil – check the oil level window (12.1) and ensure the oil is above the 'MIN' level.
  4. Refit and tighten the cap by hand.
  - Wipe up any spillages.
- ## 6.4 Run in Time for new Saw Chains
1. Remove the battery pack and adjust the chain tension – see section 6.2.
  2. Switch the saw on (see section 7.1) and allow to run at idle speed for approximately 5 minutes.
  3. Remove the battery and check the chain tension. Adjust if required.
  4. For the first 30minutes only make light easy cuts.

## 6.5 Charging the Battery

**Important: ONLY** use Draper designated battery packs and chargers with this product. Use of any other third-party battery packs/chargers is considered misuse and will invalidate the warranty. Once connected to the mains supply, recharging of the battery can be left generally unsupervised.

**WARNING!** Check the condition of the charger and battery prior to each charge. **DO NOT** use if there is any sign of damage. The battery pack must be charged before initial use.

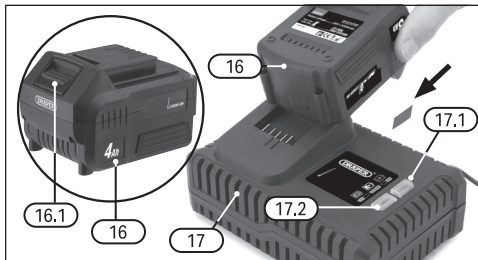

Fig. 6

1. Remove the battery (16) from the tool before charging by pressing the release button (16.1). Then slide the battery pack from the battery compartment (1).
2. Plug the battery charger (17) into a suitable mains power supply socket.
3. Slide the battery (16) into the charger (the battery is designed to fit into the charger only one way). Ensure the battery is fully inserted correctly into the charger.

Status	Indicator Lights	
	Green (17.2)	Red (17.1)
Charger plugged in	OFF	ON
Battery charging	Flashing	ON
Battery fully charged	ON	OFF
Foreign object in charger's battery slot/Faulty	-	Flickering

4. Once fully charged, unplug the charger and remove the battery from the charger by pressing the release button (16.1).
- Always unplug the charger after use.

**CAUTION!**

- **DO NOT** pull the plug out of the power outlet by the cord.
- If the battery charger has been in continuous use it will be hot. Once charging is completed, leave the charger to cool for at least 15 minutes. Only charge cooled batteries.

## 6.6 Battery Pack Charge Status

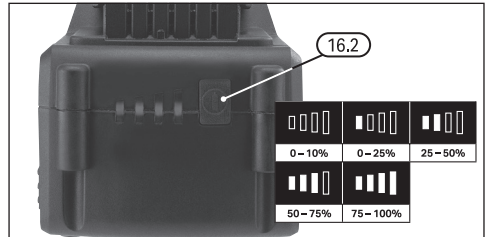

Fig. 7

- To check the battery (16) charge status press the charge level indicator button (16.2).

## 6.7 Tool Battery Fitting

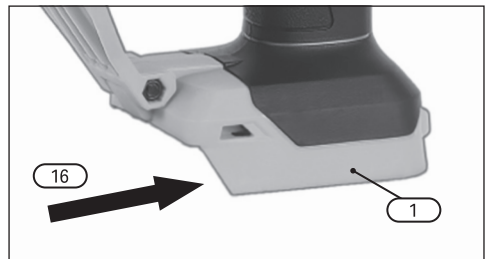

Fig. 8

- Slide the battery pack (16) into the battery compartment (1) on the base of the handle.

## To release the battery pack



Fig. 9

- Press the battery release button (16.1) and slide the battery pack off.

## 7. Operating the Pruner Saw

**Important:** Before operating this product, read and understand all the safety instructions listed in this manual. Ensure that the product is fully assembled, the battery is fitted and you are wearing the correct PPE.

**Important:** When first operating a saw stop and check the tension after a few minutes work. This is necessary to allow an initial stretch to be taken up in the chain links.

 **WARNING! A loose saw chain is dangerous and could result in a serious accident.**

### 7.1 Stating/Stopping the Pruner Saw

- **DO NOT** use without lubrication the chain with oil.



Fig. 10

1. Hold the saw firmly and securely by the handle grip (2).
2. Push the safety lock (4) in first, then squeeze the **ON/OFF** trigger (3).
3. When the saw chain is running, place the base plate (8) on the surface of the workpiece. Apply light pressure and allow the saw to cut on its own.
4. To switch off release the **ON/OFF** trigger.

### 7.2 Basic operation

- **ONLY** use a sharp saw chain. A blunt saw will jam more easily.
- Check the oil level before each use and top up if below the minimum level.
- Check the chain tension regularly when using a new saw chain as the chain will stretch more when new. Check before each use.
- To avoid injury, **NEVER** reach over the guide bar protective guard (11) or under the base plate (8).
- **DO NOT** start cutting if the saw chain is in contact with the workpiece or may heat up an object.
- Clamp loose workpieces before cutting. Check and remove any foreign objects such as nails, screws, etc.
- When cutting a branch that is under tension be alert for the branch springing back and striking the operator and/or causing the saw to go out of control.

- Take extra care when cutting brush and saplings as the thin material may catch the saw chain and may be whipped towards you or pull you off balance.

### Kickbacks

- The bar protective guard (11) is designed to prevent the risk of kickback.
- **NEVER** remove or use the saw without the guard fitted.

## 8. Maintenance and Storage

**Important: ALWAYS** ensure the pruner saw is switched off and the battery pack is removed before carrying out any cleaning, servicing or maintenance.

**DO NOT** carry out any repairs to this pruner saw unless you are qualified to do so, apart from the items listed in this section. Have damaged parts replaced by an authorised service agent before using this product.

**DANGER! DO NOT** make any changes or modifications to this pruner saw. In case of repairs use genuine spare parts recommended by Draper Tools.



### 8.1 General Maintenance

- Maintain the pruner saw in good working order and regularly serviced by an authorised service agent. Ensure the handle remain clean and free from oil, fuel and moisture.
- Regularly check external nuts and fixings to ensure vibrations during normal operation has not loosen them.
- Clean the plastic surfaces after each use with a damp cloth. **DO NOT** use aggressive cleaning agents.
- Periodically remove any shavings or sawdust from the visible parts of the chain mechanism.
- Remove the saw chain and clean and remove any dirt from the groove in the guide bar – refer to section 6.1 for fitting and removing the chain.
- Re-tension the saw chain – refer to section 6.2.
- **ALWAYS** fit the chain/bar cover when the pruner saw is not in use.
- **DO NOT** allow liquid to enter the saw.
- Store the pruner saw in a safe, dry area out of the reach of children.
- **ALWAYS** remove the battery pack for long term storage and when replacing or changing the saw chain or guide bar.

## 8.2 Troubleshooting Guide

Problem	Possible Cause	Remedy
Pruner saw will not operate	Battery discharged.	Recharge battery - refer to 6.5.
	Battery not fitted.	Insert battery into handle battery compartment.
	<b>ON/OFF</b> switch or motor defective.	Contact Draper Tools for advice.
Poor cutting performance.	Saw chain worn or damaged	Replace chain - refer to 6.1.
	Saw chain clogged with sawdust/debris	Clean the chain with a brush
	Insufficient battery charge.	Recharge battery - refer to 6.5.

## 9. Disposal

- At the end of its working life, dispose of the product responsibly and in line with local regulations. Recycle where possible.
- DO NOT** dispose of this product with domestic waste; most local authorities provide appropriate recycling facilities.   **Li-ion**
- DO NOT** incinerate. 
- DO NOT** burn or mutilate batteries; this may release toxic or corrosive substances.
- DO NOT** short circuit cells, may cause burns.
- The battery pack must be removed from the tool before it is scrapped and disposed of safely.
- DO NOT** dispose of batteries in a charged condition.
- Expired batteries must be recycled/disposed of in accordance with the appropriate regulation or legislation. They should be returned to your local warranty agent/stockist.

## 10. Warranty

12 months from date of purchase.  
 Visit [drapertools.com/warranty](http://drapertools.com/warranty) for more information.



Read the instruction manual.



Wear ear defenders and safety glasses.



Wear protective footwear.



Wear protective gloves.



Keep out of the reach of children.



**DO NOT** incinerate or throw onto fire.



**Warning!**



**Warning!** Risk of electric shock.



**DO NOT** operate the machine indoors.



**DO NOT** expose to rain or wet conditions.



Class II construction (Double insulated).



Rated Voltage.



Maximum cutting depth.



Oil tank capacity



Speed (no load).



WEEE - Waste Electrical & Electronic Equipment.  
**DO NOT** dispose of this product with domestic waste



UK Conformity Assessed.



European conformity.

## Contact Details

### **Draper Tools**

Draper Tools Limited  
Hursley Road  
Chandler's Ford  
Eastleigh  
Hampshire  
SO53 1YF  
UK

**Website:** [drapertools.com](http://drapertools.com)

**Email:** [sales@drapertools.com](mailto:sales@drapertools.com)

**Product Helpline:** +44 (0) 23 8049 4344

**Telephone Sales Desk:** +44 (0) 23 8049 4333

**General Enquiries:** +44 (0) 23 8026 6355

### **Draper Tools Europe B.V.**

Oude Graaf 8  
6002 NL  
Weert  
Netherlands

Please contact the Draper Tools Product Helpline for repair and servicing enquiries.