



DOUBLE CYLINDER FOOT PUMP

25996

1. Scope

This foot pump is designed for inflating vehicle, motorcycle and bicycle tyres with Schrader- and Woods-type valves as well as sports balls and other inflatables. It may be used with either single- or dual-pump functionality. Any other application beyond the conditions established for use will be considered misuse.

Important: This product is intended as a guide **ONLY**. **ALWAYS** double-check tyre pressure against a BS 4613-compliant tyre pressure gauge after use.

Operating pressure: 0–100psi (0–7bar)

Gauge accuracy: ± 3 psi

Hose length: 600mm

2. Health and Safety Information

Important: Read all the Health and Safety instructions before attempting to use this product. Non-compliance with these instructions may result in injury or damage to the user or product.

- Observe all standard safety precautions and good practices when in a workshop environment.
- **DO NOT** modify this product in any way.
- **DO NOT** over-extend the hose.
- **ALWAYS** ensure that the valve and adaptor connections are tight and secure.
- **DO NOT** place hands, feet or other objects beneath the footplate during use.
- **DO NOT** inflate the item beyond the recommended pressure.
- **DO NOT** exceed the maximum pressure of the pump.
- Maintain good balance and do not overexert yourself.

3. Product Overview

- | | |
|--------------|--------------------------|
| 1. Connector | 5. Hose |
| 2. Cylinders | 6. Mode adjustment screw |
| 3. Footplate | 7. Plate clip |
| 4. Gauge | |

4. What's in the Box?

- A. 1 x Foot pump
B. 1 x Woods valve adaptor
C. 1 x Plastic adaptor
D. 1 x Needle valve

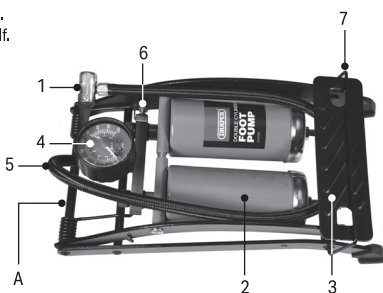

5. Operation

1. Place the pump on a firm and level surface to reduce twisting in the frame.
 2. Use the mode adjustment screw to alter the force applied by the second cylinder:
 - **Screw fully tightened:** Single-pump mode; best for high-pressure items.
 - **Screw partially tightened:** Some additional force applied by the second cylinder.
 - **Screw fully loosened:** Dual-pump mode; best for low-pressure items.
- Important:** Increasing the force applied by the second cylinder requires additional force when pumping the footplate.
3. Attach the appropriate connector to the item valve; see **6. Valve Connections**.
 4. The gauge cover can be rotated to mark the target pressure, if required.
 5. Unhook the plate clip and pump the footplate to inflate the item until the gauge needle indicates the required pressure.

Important: For greater efficiency, ensure your foot is positioned centrally on the footplate and use full strokes.

Ensure that the air hose is not kinked or stretched.
 6. Once the item is inflated, lift the thumb lock, then quickly remove the connector and adaptors from the valve and replace the tyre valve cap.

6. Valve Connections

6.1 Schrader-Type Valves

This valve type applies to most vehicle, motorcycle and some bicycle tyres.

1. Remove the tyre valve cap.
2. Push the hose connector firmly onto the valve.
3. Push the thumb lock down to secure the connection.

6.2 Woods-Type Valves

This valve type applies to most bicycle tyres.

1. Remove the valve tyre cap.
2. Screw the wider end of the Woods valve adaptor firmly onto the valve.
3. Push the hose connector onto the adaptor.
4. Press the thumb lock down to secure the connection.

6.3 Inflatables and Sports Balls

This applies to blow-up toys, sports equipment and other apparatus.

1. Insert the grip of the plastic adaptor or needle valve into the hose connector as appropriate.
2. Press the thumb lock down to secure the connection.
3. Insert the adaptor into the valve opening.

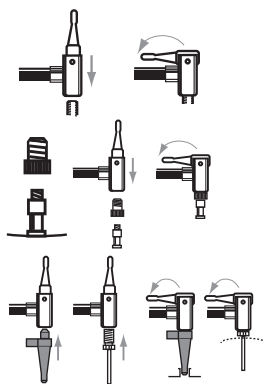

7. Product Care and Disposal

- **ALWAYS** apply the plate clip when storing the product.
- Store the product in a clean and dry environment, out of direct sunlight and out of reach of children.
 - Take particular care when storing the product in vehicles.
- Lubricate the pump every three months with light oil to ensure smooth movement:
 - Lubricate all pivot points.
 - Add a few drops into the holes at the bottom of each cylinder and pump the footplate several times to distribute the oil.

At the end of its working life, dispose of the product responsibly and in line with local regulations. Recycle where possible.

Dispose of oil separately and in accordance with local regulations; **DO NOT** abandon it in the environment.



8. Explanation of Symbols



Read the instruction manual



Do not abandon in the environment



Accurate to ± 3 psi



Hose length