



## MasterCross-Laser XPG Pro

Perfectly visible cross line laser with plumb line function, lateral laser points, clamp/wall mount with lateral fine adjustment - including two HighCapacityPacks and L-Boxx

Its bright laser cross makes this cross-line laser with green laser technology the laser of choice for precise alignment of horizontals, verticals and slopes. It also projects two side points and two plumb points that are characterised by an especially high degree of visibility and that are at a 90° angle to each other. This enables efficient plumb lining, even in very high rooms. Markings can be easily transferred from wall to wall with the side laser points, for example, when painting, aligning wooden panels or installing electrics. The clamping and wall bracket allows the laser to be hung up or attached to metallic surfaces or ceiling profiles. The vernier adjustment mechanism enables precise vertical adjustment of the laser lines to edges.

- Accurate horizontal and vertical alignment of objects
- Good visibility through green laser technology
- 4 Point Projection: Laser points top, bottom and at the side in 90° configuration for exact marking transfer from wall to wall
- Plumb function for synchronous working on floor and ceiling

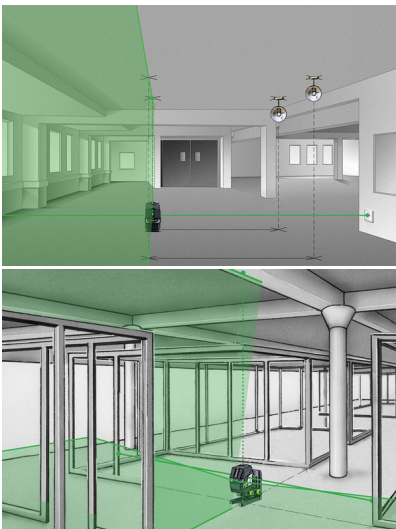

### TECHNICAL DATA

Self-levelling Range	± 2.5°
Accuracy	± 0.2 mm / m
Levelling	automatic
Visibility (Typical)*	55 m
Laser Wavelength	515 nm
Laser Class	2 / < 1 mW (EN 60825-1:2014 / A11:2021 / EN 50689:2021)
Length of Receiver Unit	0 mm
Power Supply	Li-ion battery pack 7.4V / 2.6Ah / 19.24Wh
Operating Time	approx. 8 hours
Operating Conditions	0°C ... 50°C, max. humidity 80% rH, no condensation, max. working altitude 4000 m above sea level
Storage Conditions	-10°C ... 70°C, max. humidity 80% rH
Dimensions (W x H x D)	128 mm x 110 mm x 67 mm x #
Weight	588 g (incl. battery pack)



### SCOPE OF DELIVERY



Item No. 031.430L

GTIN (EAN) 4021563736478

SU 1