

**EN**

Original Instructions  
Version 3 - February 2026

**DRAPER**<sup>®</sup>

230V 3000W GARDEN VACUUM

# **BLOWER & MULCHER**

94794



UK  
CA **CE**

# 1. Preface

These are the original product instructions. This document is part of the product; retain it for the life of the product, passing it on to subsequent holders. Read this manual in full before attempting to assemble, operate or maintain this product.

This Draper Tools manual describes the purpose of the product and contains all the necessary information to ensure its correct and safe use. Following all the instructions and guidance in this manual will ensure the safety of both the product and the operator and increase the lifespan of the product.

All photographs and drawings within this manual are supplied by Draper Tools to help illustrate correct operation of the product.

Every effort has been made to ensure the information contained in this manual is accurate. However, Draper Tools reserves the right to amend this document without prior warning. Always use the latest version of the product manual.

## 1.1 Product Reference

**User Manual for:** 230V 3000W Garden Vacuum, Blower & Mulcher

**Stock No:** 94794

**Part No:** BV3000/B

## 1.2 Revisions

**Version 1:** April 2021  
First release

**Version 2:** February 2025

**Version 3:** February 2026

As our manuals are continually updated, always ensure that the latest version is used.

Please visit [drapertools.com/manuals](http://drapertools.com/manuals) for the latest version of this manual and the associated parts list, if applicable.

## 1.3 Understanding the Safety Content of This Manual



**WARNING!** – Situations or actions that may result in personal injury or death.



**CAUTION!** – Situations or actions that may result in damage to the product or surroundings.

**Important:** – Information or instructions of particular importance.

## 1.4 Copyright © Notice

Copyright © Draper Tools Limited.

Permission is granted to reproduce this manual for personal and educational use **ONLY**. Commercial copying, redistribution, hiring or lending is strictly prohibited.

No part of this manual may be stored in a retrieval system or transmitted in any other form or means without written permission from Draper Tools Limited.

In all cases, this copyright notice must remain intact.

---

1. Preface	2
1.1 Product Reference	2
1.2 Revisions	2
1.3 Understanding the Safety Content of This Manual	2
1.4 Copyright © Notice	2
2. Contents	3
3. Product Introduction	4
3.1 Intended Use	4
3.2 Specification	4
4. Health and Safety Information	5
4.1 Health and Safety Warnings for Garden Tool Use	5
4.2 Connection to the Power Supply	6
4.3 Residual Risk	6
5. Identification and Unpacking	7
5.1 Product Overview	7
5.2 Packaging	7
6. Preparation Instructions	8
6.1 Assemble the Chute	8
6.2 Fitting the Collection Bag	9
6.3 Fitting the Shoulder Strap	9
7. Operating Instructions	10
7.1 ON/OFF Switch Operation	10
7.2 Blower/Vacuum Function	10
7.3 Variable Speed	10
7.4 Basic Operation	11
7.5 Collection Bag	11
8. Maintenance and Troubleshooting	12
8.1 Troubleshooting	12
9. Spares, Returns and Disposal	13
10. Explanation of Symbols	14

## 3. Product Introduction

---

### 3.1 Intended Use

This product is designed to blow, vacuum and mulch leaves and other light garden debris. Any other application beyond the conditions established for use will be considered misuse.

Draper Tools accepts no responsibility for improper use of this product.

**WARNING! This product is not a toy and must be respected.**

This product is intended for domestic and infrequent light-duty trade use. Read this manual in full before attempting to assemble, operate or maintain the product and retain it for later use.

### 3.2 Specification

Stock No.	94794
Part No.	BV3000/B
Rated voltage	230V/50Hz
Rated input	3000W
Max. air flow speed (blowing)	270km/h
Max. air volume	13.2M3/min
Mulching ratio	Up to 10:1
Collection bag capacity	35L
<b>Noise emissions</b>	
Sound pressure level	85.1dB (A)
Sound power level	100.1dB (A)
LwA	102dB (A)
<b>Vibration level</b>	
Net weight (machine only)	3kg

**Important:** The declared vibration total values and noise emissions values have been measured in accordance with a standard test method and may be used for comparing one tool with another. These values may also be used in a preliminary assessment of exposure.



**WARNING! The vibration and noise emissions during actual use of the product can differ from the declared values depending on the type of work and the area upon which it is used. Before each use, estimate the likely exposure resulting from the actual conditions of use. Take into account all parts of the operation cycle in order to identify any safety measures required to protect the operator.**

**Important:** Read all Health and Safety instructions before attempting to operate, maintain or repair this product. Failure to follow these instructions may result in injury or damage to the user or the product.

### 4.1 Health and Safety Warnings for Garden Tool Use



**WARNING! DO NOT start the leaf blower without assembling the two suction chutes (1).**

- Keep children and bystanders away while operating the tool. **NEVER** operate the machine while people, especially children, or pets are nearby.
- The operator or user is responsible for accidents or hazards occurring to other people or their property.
- **DO NOT** expose to rain or wet conditions.
- **DO NOT** modify this product. Only use for its intended purpose.
- Use appropriate personal protective equipment (PPE). **ALWAYS** wear eye protection.
  - The wearing of ear defenders and a face mask are recommended.
- Switch off and disconnect the plug from the power source:
  - Whenever the machine is left by the user.
  - Before making any adjustments, cleaning or carrying out any maintenance.
  - Before clearing a blockage.
  - After striking a foreign object to inspect the machine for damage.
  - If the machine starts to vibrate abnormally, check immediately.
- **NEVER** allow children and persons with reduced physical, sensory or mental capabilities, or lack of experience and knowledge or people unfamiliar with these instructions to use this machine. Local regulations may restrict the age of the operator.
- Children should be supervised to ensure that they do not play with the machine.
- **NEVER** operate the machine with defective **guards** or shields, or without safety devices such as the collection bag in place.
- Before use check the supply and extension cord for signs of damage or wear. If the cord becomes damaged during use, disconnect the cord from the power supply immediately. **DO NOT TOUCH THE CORD BEFORE DISCONNECTING THE SUPPLY. DO NOT** use the machine if the cord is damaged or worn.
- **DO NOT** abuse the cord. **NEVER** use the cord for carrying, pulling or unplugging the machine. Keep the cord away from heat, oil, sharp edges and moving parts. Damaged or entangled cords increase the risk of electric shock.
- Always direct the cord to the rear away from the machine.
- **DO NOT** overreach keep proper footing and balance at all times. Always be sure of the footing on slopes and walk, never run.
- While operating the machine, always wear substantial footwear and long trousers.
- **DO NOT** operate the machine when barefoot or wearing open-toed sandals.
- Keep hands and feet out of the opening and away from the rotating blades while the machine is operating.
- Operate the machine only in daylight or in good artificial light.
- Keep all cooling air inlets clear of debris.
- Never blow debris in the direction of bystanders.
- Prevent unintentional starting. Ensure the switch is in the off position before connecting to power supply, picking up or carrying the machine.
- Have your machine serviced by a qualified repair person using only identical replacement parts. This will ensure that the safety of the machine is maintained.

## 4. Health and Safety Information

---

### 4.2 Connection to the Power Supply

- This appliance is supplied with an approved plug and cord for your safety.
- If the power supply cord is damaged, it must be replaced by Draper Tools, an authorised service agent or similarly qualified personnel in order to avoid a hazard.
- The damaged or incomplete plug, when cut from the cord, shall be disabled to prevent connection to a live electrical outlet.
- This product is a Class II† appliance and is designed for connection to a power supply matching that detailed on the rating label and compatible with the plug fitted.
- The value of the fuse fitted is marked on the pin face of the plug. Should the fuse need replacing, use a small plain-slot screwdriver to remove the fuse cover. Ensure the substitute is of the correct rating, approved to BS 1363/A and ASTA or BS Kite marked.

ASTA 

BSI 

This should only be performed by suitably qualified personnel.

- If an extension lead is required, use an approved and compatible lead rated for this appliance and for outdoor use.
- Follow all the instructions supplied with the extension lead.
- **Important:** Always follow the extension lead instructions regarding maximum load while the cable is wound. If in doubt, unwind the entire cable. A coiled extension lead generates heat which could melt the lead and cause a fire.
- It is recommended that this product is used with a residual current device (RCD) with a tripping current of not more than 30mA to reduce the risk of electrical shocks.
- †**Double insulated** : This product is double insulated and does not require an earth connection to protect against electric shock from accessible conductive parts in the event of failure of the basic insulation.

### 4.3 Residual Risk

The safety instructions in this manual cannot account for all possible conditions and situations that may occur. Exercise common sense and caution when using this product and protect against any additional conceivable risks.

# 5. Identification and Unpacking

## 5.1 Product Overview

Carefully remove the product from the packaging and examine it for any signs of damage that may have occurred during shipment.

If any part is damaged or missing, do not attempt to use the product. Please contact the Draper Helpline; contact details can be found at the back of this manual.



- (1) Chute (two sections)
- (2) Shoulder strap
- (3) Rear handle
- (4) ON/OFF trigger
- (5) Cord and plug
- (6) Blower/vacuum function lever
- (7) Collection bag
- (8) Support wheels
- (9) Blower tube
- (10) Leaf comb
- (11) Variable speed control

## 5.2 Packaging

Keep the product packaging for the duration of the warranty period for reference should the product need to be returned for repair.

**WARNING! Keep packaging materials out of reach of children. Dispose of packaging correctly and responsibly and in accordance with local regulations.**

Please visit [drapertools.com](http://drapertools.com) for our full range of accessories and consumables.

## 6. Preparation Instructions

Important: Before preparing or adjusting this product, read and understand all the safety instructions listed in this manual. Unplug from the power supply before carrying out any adjustment or assembling.

**Important: Remove the label from the front of the impeller and assemble and fit the chute BEFORE operating this blower/vacuum.**

### 6.1 Assemble the Chute (Fig.1 - Fig.4)

1. Connect the two sections of the chute (1) together and secure using the screw supplied.
2. Then fit the assembled chute to the motor housing using the other screw.
3. Attach the support wheels (8) and leaf comb (10).

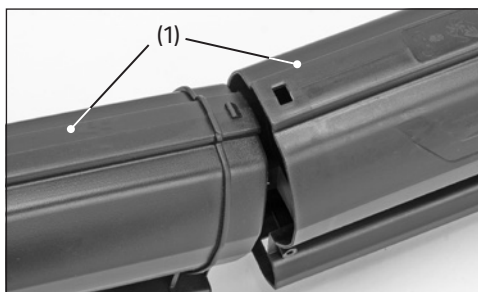

Fig. 1



Fig. 2

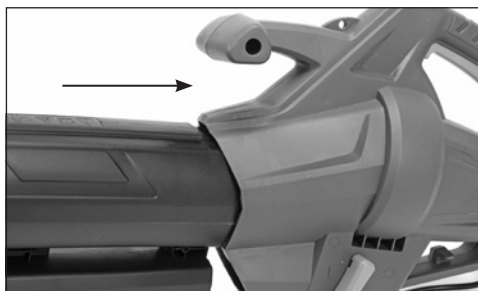

Fig. 3

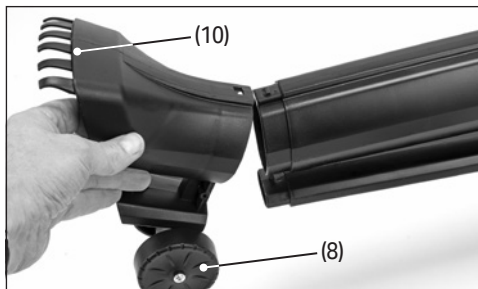

Fig. 4

### 6.2 Fitting the Collection Bag (Fig.5 - Fig.6)

1. Push the two side lugs into the slots in the housing until they click into place.
2. Ensure the collection bag is fitted securely and the bag is clipped to the chute.



Fig. 5



Fig. 6

### 6.3 Fitting the Shoulder Strap (Fig.7)

To assist with manoeuvrability and weight distribution, an adjustable shoulder strap is supplied.

1. Connect the strap to the pivot point.
2. Then adjust the strap length to the desired height.



Fig. 7

## 7. Operating Instructions

**Important:** Before operating this product, read and understand all the safety instructions listed in this manual. Ensure that the product is fully assembled and correctly prepared for use.

### 7.1 ON/OFF Switch Operation (Fig.8)

- To activate – fully press and hold the trigger (4).
- To deactivate - release the trigger.

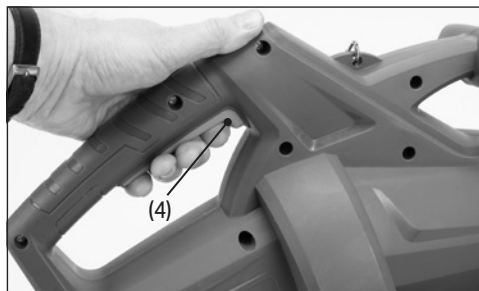



Fig. 8

### 7.2 Blower/Vacuum Function (Fig.9)

- To change between the blower and vacuum function:

Function	Adjustment Control Lever (6) Position	Symbol
Blower	Lower	
Vacuum	Raise	

- NOTE: Mulching action is automatic when vacuum mode is selected. Leaf volume can be reduced up to 10:1.
- When switching from vacuum to blower mode, wait for the debris to exit the chute and enter the collection bag before changing. This will prevent debris being blown down the blower tube or jamming the function selector switch.

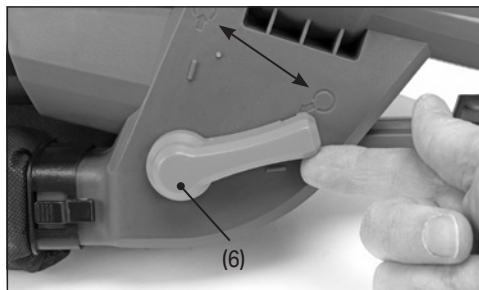

Fig. 9

### 7.3 Variable Speed (Fig.10)

- Rotate the speed control dial (11) to adjust the speed.



Fig. 10

## 7.4 Basic Operation

- When using blower mode, it is important to keep the chute further from the ground, as air is sucked up the chute before being blown out through the blower tube. Allowing the chute to be near the ground could cause debris to enter the chute and be blown out through the blower tube or cause the machine to block.



**WARNING!** Damage and blockages caused by operating the blower vacuum function control lever (6) while the motor is running are considered misuse and are not covered by the warranty.



**CAUTION!** Avoid sucking up gravel and stones. These can permanently damage the blower/vacuum internal components. Any resulting damage is not covered by the warranty.

## 7.5 Collection Bag

- As the organic material is vacuumed up the chute it passes through an impellor which in turn reduces the volume as it mulches the matter.
- When the collection bag is nearing capacity, stop the machine and disconnect the power supply.
- Press the two release tabs inwards and pull the plastic collar forwards to remove the bag from the machine.  
**Refer to section 6.2 fitting the collection bag.**
- With the bag removed the collected organic material can be emptied for compost/recycling by opening the zip. Ensure the zip is completely closed prior to refitting the collection bag.

### **Important: Extra care should be taken with wet leaves**

- Wet leaves will not mulch as easily as dry leaves.
- When vacuuming, pay extra attention as they can reduce the performance and may clog or block the impellor. If a problem is noticed, turn off, unplug and clear the impellor.
- Excessive leaves sucked up too quickly or very wet leaves could cause the machine to block. If this occurs turn off, unplug the machine and clear the blockage.
- Avoid sucking up hard items such as stones and gravel as this will cause blockages and damage to the machine.

## 8. Maintenance and Troubleshooting

---

**Important:** Unplug from the power socket before carrying out any adjustment, servicing or maintenance.

- Regular inspection and cleaning will reduce the necessity for maintenance operations and will keep your machine in good working condition.
- The motor must be correctly ventilated during operation. For this reason, avoid blocking the air inlets.
- Keep all nuts, bolts and screws tight to be sure the appliance is in safe working condition.
- Check the debris collector frequently.
- Replace worn or damaged parts. Use only genuine replacement parts and accessories.
- Store the machine in a dry secure place.

### 8.1 Troubleshooting

Problem	Possible Cause	Remedy
Machine not operating	Not plugged in	Plug in and press the trigger
	Fuse blown	Replace fuse in plug
	RCD tripped	Reset RCD. If problem occurs again, unplug the machine and have the machine checked by a qualified person
	Cord damaged	<b>DO NOT</b> use until the cord has been replaced
Poor suction, mulching or collection	Collection bag full	Unplug and empty the bag
	Collection chute blocked	Unplug the machine and unblock the chute
	Very wet leaves clogging impeller	Unplug the machine and clear the impeller
	Impeller damaged	Have the impeller replaced by a qualified service agent
	Collection bag missing or open	Close bag correctly. Refit or replace collection bag
Reduced blower air flow	Blower tube blocked	Unplug the machine and check/clear blockage

- For spare parts, servicing, and repair and replacement options, please contact the Draper Tools Product Helpline for details of your nearest authorised agent.
- Draper Tools will endeavour to hold any spare parts, if applicable, for seven years from the date that it sells the final matching stock item.
- Any servicing or repairs carried out by unauthorised personnel or installation of spare parts not supplied by Draper Tools will invalidate your warranty.
- At the end of its working life, dispose of the product responsibly and in line with local regulations. Recycle where possible.

**DO NOT** dispose of this product with domestic waste; most local authorities provide appropriate recycling facilities.



# 10. Explanation of Symbols



Read the instruction manual



**Warning!**



Wear suitable eye and face protection



Wear ear defenders



Wear protective footwear



Keep out of reach of children



Class II construction  
(Double insulated)



WEEE –  
Waste Electrical & Electronic Equipment  
Do not dispose of Waste Electrical & Electronic Equipment  
in with domestic rubbish



UK Conformity Assessed



European conformity



Continuous A-weighted sound power level



Pay attention that bystanders are not injured through foreign objects thrown from the machine.

**WARNING!** Keep a safe distance from the machine when operating



Switch off and unplug from the power socket before adjusting, cleaning or carrying out maintenance, or if the cord is entangled, cut or damaged and before leaving the machine unattended



Rotating fan

Keep hands and feet out of the opening while the machine is running.



**Warning!**

Do not start the leaf blower without mounting the two suction/blowing tubes!

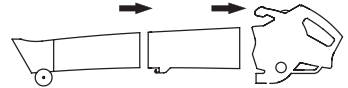

**DO NOT** use in wet conditions - not weatherproof



## Contact Details

### **Draper Tools**

Draper Tools Limited  
Hursley Road  
Chandler's Ford  
Eastleigh  
Hampshire  
SO53 1YF  
UK

**Website:** [drapertools.com](http://drapertools.com)

**Email:** [sales@drapertools.com](mailto:sales@drapertools.com)

**Product Helpline:** +44 (0) 23 8049 4344

**Telephone Sales Desk:** +44 (0) 23 8049 4333

**General Enquiries:** +44 (0) 23 8026 6355

### **Draper Tools Europe B.V.**

Oude Graaf 8  
6002 NL  
Weert  
Netherlands

Please contact the Draper Tools Product Helpline for repair and servicing enquiries.