

**DRAPER**

**EN**

Original Instructions  
Version 4  
May 2026

AIR  
**BELT SANDER**

**84123**



**UK  
CA** **CE**

# 1. Preface

These are the original product instructions. Read the instruction manual in full and retain for future reference.

Please visit [drapertools.com/manuals](http://drapertools.com/manuals) for the latest version of this manual and the associated parts list, if applicable.

## 1.1 Product Reference

User Manual for: Air Belt Sander

Stock No: 84123

Part No: DAT-ABS

## 1.2 Revisions

Version 1: October 2017

First release

Version 2: May 2023

Version 3: July 2023

Version 4: February 2026

## 1.3 Understanding the Safety Content of This Manual



**WARNING!** – Situations or actions that may result in personal injury or death.



**CAUTION!** – Situations or actions that may result in damage to the product or surroundings.

**Important:** – Information or instructions of particular importance.

# 2. Contents

<b>1. Preface</b>	<b>2</b>	<b>6. Preparation Instructions</b>	<b>8</b>
1.1 Product Reference	2	6.1 Preparing the Air Supply for Use (Fig.1)	8
1.2 Revisions	2	6.2 Connection to the air Supply	9
1.3 Understanding the Safety Content of This Manual	2	<b>7. Operating Instructions</b>	<b>9</b>
<b>2. Contents</b>	<b>2</b>	7.1 Fitting & Replacing the Sanding Belt (Fig.2 – Fig.3)	9
<b>3. Product Introduction</b>	<b>3</b>	7.2 Arm Angle Adjustment (Fig.4)	10
3.1 Intended Use	3	<b>8. Maintenance and Troubleshooting</b>	<b>10</b>
3.2 Specification	3	8.1 Every-Day Maintenance Checks	10
<b>4. Health and Safety Information</b>	<b>4</b>	8.2 After Use Maintenance Checks	10
4.1 General Health and Safety Precautions	4	8.3 Troubleshooting	10
4.2 Additional Safety Instructions for Air Tools	6	<b>9. Spares, Returns and Disposal</b>	<b>11</b>
4.3 Residual Risk	6	<b>10. Warranty</b>	<b>11</b>
<b>5. Identification and Unpacking</b>	<b>7</b>	<b>11. Explanation of Symbols</b>	<b>11</b>
5.1 Product Overview	7		
5.2 Packaging	8		

# 3. Product Introduction

## 3.1 Intended Use

This air tool is designed to be used with sanding belts and ideal for jobs in narrow spaces and recessed corners.

Any other application beyond the conditions established for use will be considered misuse. Draper Tools accepts no responsibility for improper use of this product.

This product is intended for domestic and infrequent light-duty trade use.

Read this manual in full before attempting to assemble, operate or maintain the product, and retain it for later use.

## 3.2 Specification

<b>Stock No.</b>	<b>84123</b>
<b>Part No.</b>	<b>DAT-ABS</b>
<b>Belt width</b>	10mm
<b>Belt length</b>	330mm
<b>Speed (no load)</b>	18,000rpm
<b>Maximum operating air pressure</b>	90psi (6.2bar)
<b>Average air consumption</b>	170L/min (6.0cfm)
<b>Minimum air line inner diameter</b>	3/8" (10mm)
<b>Noise emissions</b>	
Sound pressure level	93dB (A)
Sound power level	104dB (A)
<b>Vibration level</b>	4.8m/s <sup>2</sup>
<b>Net weight</b>	780g

**Important:** The declared vibration total values and noise emissions values have been measured in accordance with a standard test method and may be used for comparing one tool with another. These values may also be used in a preliminary assessment of exposure.



**WARNING!** The vibration and noise emissions during actual use of the product can differ from the declared values depending on the type of work and the area upon which it is used. Before each use, estimate the likely exposure resulting from the actual conditions of use. Take into account all parts of the operation cycle in order to identify any safety measures required to protect the operator.

## 4. Health and Safety Information

---

**Important:** These instructions are intended as a guide to the safe use of this product. Additional or specific risks associated with each operation and workpiece material must be undertaken before each operation. **DO NOT** operate this tool if you are unfamiliar with the risks associated with its use.

### 4.1 General Health and Safety Precautions



**WARNING! Read and understand the safety instructions before installing, operating, repairing, maintaining, replacing accessories, or working near the sander. Failure to do so can result in serious bodily injury.**

#### General Safety Instructions

- **ONLY** trained and authorised personnel may install, adjust or operate the sander.
- **DO NOT** modify this sander. Modifications can reduce the effectiveness of safety measures and increase the risk of injury.
- Retain these instructions for the life of the product and pass them on with the tool to any future operators.
- **DO NOT** use this sander if it shows any evidence of damage or disrepair.
- Regularly inspect the sander to ensure that all safety markings remain legible. Contact Draper Tools if the safety markings need to be replaced and **DO NOT** use the tool.

#### Projectile Hazards

- Be aware that failure of the workpiece, accessories or tool itself may generate high-velocity projectiles.
- **ALWAYS** wear impact-resistant eye protection during operation of the sander and assess the grade of protection required with each use.
- When working overhead, **ALWAYS** wear a safety helmet.
- Carefully assess the risk to others before every operation and ensure that all bystanders are clear of the work area or equipped with suitable protective equipment.
  - Keep this product out of reach of children at all times.
- **ALWAYS** ensure that the workpiece is firmly gripped by a clamp or vice; **NEVER** hold the workpiece by hand.

#### Entanglement Hazards

- Keep loose clothing, gloves, hair and jewellery well away from the sander at all times.
- Entanglement in the spinning pad can cause significant injury.

#### Operating Hazards

- Wear suitable protective gloves to guard against injury from cuts, abrasion and heat.
- If the workpiece becomes hot during operation, stop the tool and allow the material to cool before continuing.
- Hold the tool correctly and firmly and brace yourself against sudden movements, keeping both hands available.
- Maintain good balance and secure footing at all times while operating the tool.
- Release the trigger lever immediately if the air supply is interrupted.
- **ONLY** use lubricants recommended by Draper Tools.
- **ALWAYS** wear protective safety glasses while using this tool.
  - Draper Tools also recommends wearing protective gloves and other protective clothing appropriate to the specific conditions of the operation.
- Inspect the backing plate for signs of damage before **EVERY** use.
  - **DO NOT** use the sander if the tension arm is broken or cracked or the tool has been dropped.
- **NEVER** touch the sanding belt while the tool is in operation.
  - **ALWAYS** allow the tool to come to a complete stop and disconnect the air supply before handling or adjusting the sanding belt or tension arm.
- **NEVER** use the tool without a suitable sanding belt attached.
- Use on plastic or other non-conductive materials increases the risk of electrostatic discharge.
- Dust and fumes caused by sanding operations may create potentially explosive environments.
  - **ALWAYS** ensure that dust extraction or suppression systems are used with this tool and are suitable for use with the workpiece materials.

## Repetitive Motion Hazards

- When operating a sander frequently or for extended periods, the operator may experience discomfort in the hands, arms, shoulders, neck and other parts of the body.
- While using the sander, adopt a comfortable posture while maintaining secure footing and avoiding awkward or off-balance positions.
- Change posture and operating positions regularly during extended use to help avoid discomfort and fatigue.
- **DO NOT** ignore symptoms such as persistent or recurring discomfort, pain, throbbing, aching, tingling, numbness or burning sensations. If these symptoms occur, stop using the tool and consult a qualified health professional.

## Accessory Hazards

- **ALWAYS** disconnect the sander from the air supply before fitting or changing accessories.
- Avoid direct contact with the sanding pad and backing plate during and immediately after operation as it may become hot during use.
- **ONLY** use accessory types and sizes recommended by Draper Tools.
- **DO NOT** attach grinding wheels or cutting-off accessories to this tool and do not use it for these purposes.

## Workplace Hazards

- Stay alert for surfaces that may become slippery as a result of use of this tool and for trip hazards caused by the air line.
- This sander is not suitable for use in potentially explosive atmospheres and is not insulated against contact with electric power.
- Ensure that there are no electrical cables, gas pipes, etc. present in the workpiece that may cause a hazard if damaged by the tool.

## Dust and Fume Hazards

- Dust and fumes generated by sanding operations can cause ill health (e.g., cancer, birth defects, asthma and/or dermatitis).
- Perform a risk assessment and implement any appropriate controls for identified hazards before performing any operation.
  - Any risk assessment performed must include dust created by use of the tool and disturbance of any existing dust.

- Operate and maintain the sander appropriately to minimise the dust or fume emissions.
- Direct the exhaust so as to minimise disturbance of existing dust in dusty environments.
- Where dust or fumes are created, priority must be given to controlling them at the point of emission.
- All integral features and accessories for the collection, extraction or suppression of airborne dust or fumes must be correctly used and maintained in accordance with the manufacturer's instructions.
- Select, maintain and replace the sanding belts as recommended in the manual to prevent any unnecessary increase in the emission of dust or fumes.
- Use appropriate respiratory protection in accordance with local occupational health and safety regulations.

## Noise Hazards

- Exposure to high noise levels can cause permanent hearing loss and other problems.
  - Perform a risk assessment and implement any appropriate controls for identified hazards before performing any operation.
- Implement appropriate controls, such as dampening materials, to prevent the workpiece from "ringing" during operation.
- Use appropriate hearing protection in accordance with local occupational health and safety regulations.
- Operate and maintain the sander appropriately to prevent unnecessary increase in noise emissions.

## Vibration Hazards

- Exposure to vibration can cause disabling damage to the nerves and blood supply of the hands and arms.
- Wear warm clothing when working in cold conditions and keep your hands warm and dry.
- If you experience numbness, tingling, pain or whitening of the skin in your fingers or hands, stop using the sander and consult a qualified health professional.
- Operate and maintain the sander appropriately to prevent unnecessary increase in vibration emissions.
- The risks from vibration hazards are increased when grip force on the tool is higher. Hold the sander with a light but safe grip, keeping in mind that your grip may need to be altered to react to unexpected forces.

## 4. Health and Safety Information

---

### 4.2 Additional Safety Instructions for Air Tools



**WARNING! Compressed air can cause severe injury.**

- **ALWAYS** turn off and disconnect the air supply before making any adjustments or repairs to the product or leaving it unattended.
- **NEVER** direct compressed air towards yourself or others.
- Ensure that compressed air is not blocked by or in contact with any part of your body.
- **ONLY** use clean, dry and regulated compressed air.



**WARNING! NEVER use oxygen, combustible gases or other bottled gases as a supply for this product. Use of these substances may cause the product to explode.**

- The use of a whip hose between the tool and the air supply is recommended to reduce vibration.



**WARNING! Whipping hoses can cause severe injury. Always check for and replace damaged or loose hoses and fittings.**

- Ensure that the product is compatible with the air supply before use.
- Ensure all connections are securely tightened.
- Where universal twist couplings (claw couplings) are used, lock pins must be installed and whip check safety cables must be used to safeguard against possible hose-to-tool or hose-to-hose failure.
- **DO NOT** exceed the maximum stated air pressure.
- **DO NOT** obstruct the ability of the trigger to release once depressed.
- **NEVER** carry the tool by the air line.

### 4.3 Residual Risk

The safety instructions in this manual cannot account for all possible conditions and situations that may occur. Exercise common sense and caution when using this product and protect against any additional conceivable risks.

# 5. Identification and Unpacking

Carefully remove the product from the packaging and examine it for any signs of damage that may have occurred during shipment. If any part is damaged or missing, **DO NOT** attempt to use the product. Please contact the Draper Helpline; contact details can be found at the back of this manual.

## 5.1 Product Overview



- 1 Belt tension arm (360° rotation)
- 2 Body
- 3 **ON/OFF** Trigger
- 4 Low vibration soft grip handle
- 5 1/4" BSP (female air inlet)
- 6 Exhaust
- 7 Drive wheel

- 8 Belt changing catch
- 9 Angle locking grub screw
- 10 Airline coupling screw adaptor
- 11 Hex key
- 12 3 × Sanding belts  
(1 × 60 grit, 1 × 80 grit, 1 × 20 grit)

# 5. Identification and Unpacking

## 5.2 Packaging

Keep the product packaging for the duration of the warranty period for reference should the product need to be returned for repair.



**WARNING! Keep packaging materials out of reach of children. Dispose of packaging correctly and responsibly and in accordance with local regulations.**

Please visit [drapertools.com](http://drapertools.com) for our full range of accessories and consumables.

# 6. Preparation Instructions

**Important:** Before preparing or adjusting this product, read and understand all the safety instructions listed in this manual.

## 6.1 Preparing the Air Supply for Use (Fig.1)

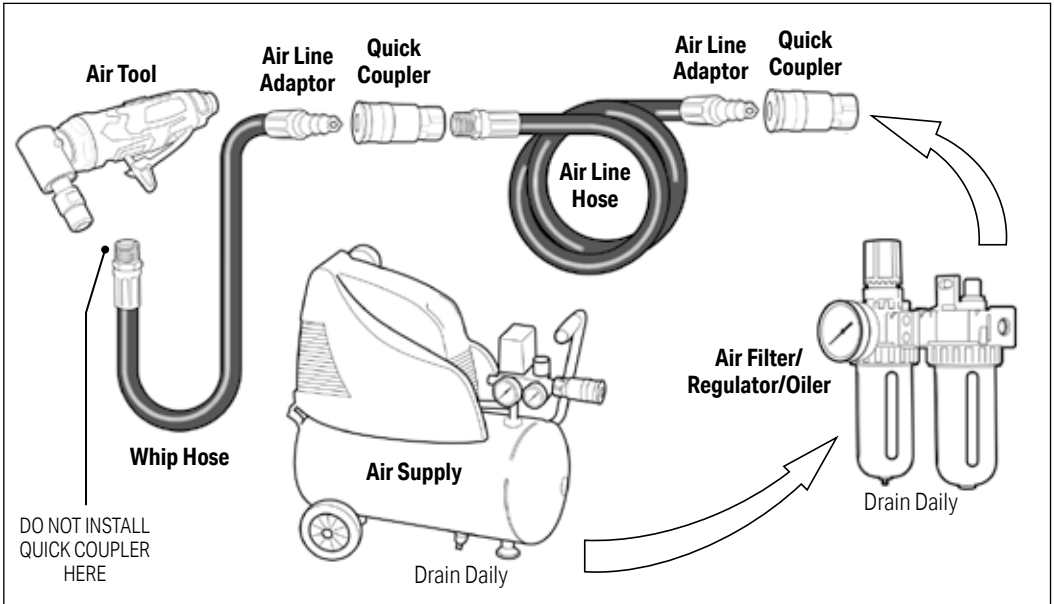

Fig. 1

- This air tool operates at a max. pressure of 6.2bar (90psi).
- ISO grade 22–32 (SAE grade 5W–15W) monograde oil should be used in this air tool.
- During use, the oil must be constantly supplied to the equipment to ensure complete lubrication and optimum performance.
- The compressed air system must be controlled by a combination pressure regulator, in-line lubricator and moisture filter. This will ensure a constant supply of dry air at all times, provided it is properly maintained.

**Important:** Always check the machine operating pressure before use.

# 6. Preparation Instructions

- Water in the compressor tank may cause considerable corrosion to air tools; the compressor should be drained daily to avoid excessive water in the air supply. Dirty or wet air can significantly shorten the lifespan of the product.
- When using an air tool with a hose over 25ft long, Draper Tools recommends increasing the bore of the hose to the next largest available size (i.e. increase 3/8" to 1/2"). This will ensure adequate pressure and volume of air to power the tool.

## 6.2 Connection to the air Supply

**Important: ALWAYS** disconnect from the air supply before assembling, carrying out adjustments, servicing or maintenance.

- To connect the air tool to an air line, a 1/4" BSP male thread whip hose will be required.
- Wind a length of PTFE tape around the thread of the whip hose before securing the hose in place.
- Remove the bung from the air inlet **5** and attach the hose via the 1/4" BSP air inlet. The connection must be tight for an airtight union.

# 7. Operating Instructions

**Important:** Before operating this product, read and understand all the safety instructions listed in this manual. Ensure that the product is fully assembled and correctly prepared for use.

**Note:**

- Before connecting the tool to the air supply reduce the line pressure according to the specification.
- Before tool operation and work commences, ensure the compressor reservoir is drained of condensate along with all connected air lines.
- Check and drain the air line regulator's water trap and fill up the lubrication reservoir.

## 7.1 Fitting & Replacing the Sanding Belt (Fig.2 – Fig.3)

The sander is supplied with the 120 grit sanding belt fitted.

**To remove or fit a new sanding belt:**

1. Push the end of the belt tension arm **1** until it locks in the retracted position with an audible click.

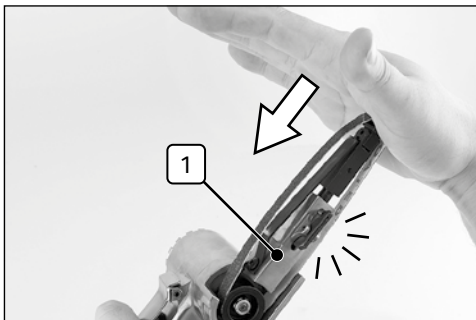

Fig. 2

2. Remove the belt if fitted from the driver wheel.
3. Loop the new sanding belt around the drive wheel and the end of the tension arm.

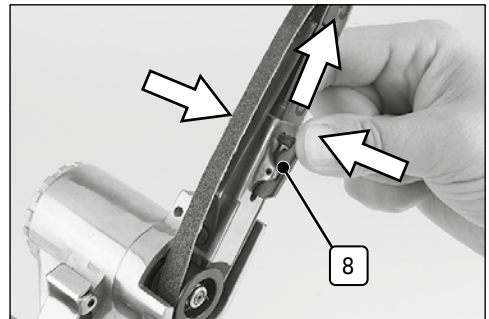

Fig. 3

4. Then push the belt changing catch **8** and the sprung loaded arm will extend outwards to hold the belt in tension.

# 7. Operating Instructions

## 7.2 Arm Angle Adjustment (Fig.4)

The belt tension arm can be rotated and adjusted to any working angle.

- To adjust insert the supplied hex.key (11) into the grub screw (9) and loosen.
- Adjust the arm to the required angle, then retighten the grub screw.

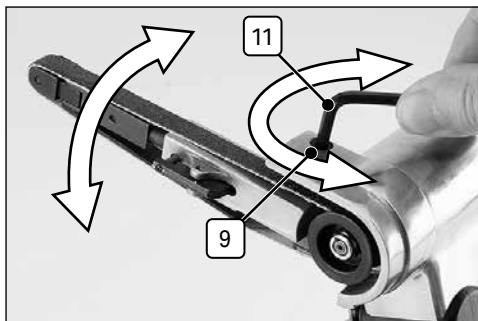

Fig. 4

# 8. Maintenance and Troubleshooting

**WARNING!** Disconnect from the air supply before carrying out any adjustments, servicing or maintenance.

## 8.1 Every-Day Maintenance Checks

**Before connection to the air supply:**

- Drain the compressor reservoir of condensate.
- Drain the air line of condensate.
- Drain the combined separator filter, regulator, water trap.

- Fill up the combined separator filter, regulator, lubricant reservoir.
- Check the line pressure is correct for the tool.

## 8.2 After Use Maintenance Checks

- Repeat the above procedures.
- Lubricate the tool with approximately 1.5ml of oil directly down the air inlet.
- When not in use store in a dry clean place out of the reach of children.

## 8.3 Troubleshooting

Problem	Possible cause	Remedy
Tool will not operate	<ul style="list-style-type: none"><li>• Motor or throttle seized with dirt.</li></ul>	<ul style="list-style-type: none"><li>• Check for dirt in air inlet.</li><li>• Pour air tool lubricating oil into air inlet.</li><li>• Operate trigger in short bursts.</li><li>• Disconnect air line supply, then turn rotating drive by hand. Reconnect air supply.</li><li>• If motor fails to turn, contact the Draper Tools product helpline for advice.</li></ul>
Tool runs slowly	<ul style="list-style-type: none"><li>• Motor parts jammed with dirt.</li><li>• Air flow blocked.</li></ul>	<ul style="list-style-type: none"><li>• Check air inlet filter for blockages.</li><li>• Pour air tool lubricating oil into air inlet.</li><li>• Operate trigger in short bursts.</li></ul>

## 9. Spares, Returns and Disposal

EN

For spare parts, servicing, and repair and replacement options, please contact the Draper Tools Product Helpline for details of your nearest authorised agent.

Draper Tools will endeavour to hold any spare parts, if applicable, for seven years from the date that it sells the final matching stock item.

Any servicing or repairs carried out by unauthorised personnel or installation of spare parts not supplied by Draper Tools will invalidate your warranty.

At the end of its working life, dispose of the product responsibly and in line with local regulations. Recycle where possible.

## 10. Warranty

6 months from date of purchase – Visit [drapertools.com/warranty](http://drapertools.com/warranty) for more information.

## 11. Explanation of Symbols



General Mandatory action required



Maximum operating air pressure (psi)



European conformity



Read the instruction manual



Maximum operating air pressure (bar)



UK Conformity Assessed



Wear face mask and safety glasses



Average air consumption (cfm)



Wear ear defenders



Average air consumption (Litres per minute)



Warning! / Caution / Danger



Airline inner diameter



Sanding belt width



British Standard Pipe gauge thread



Revolution per minute



Net product weight

## Contact Details

### **Draper Tools Limited**

Hursley Road  
Chandler's Ford  
Eastleigh  
Hampshire  
SO53 1YF  
UK

**Website:** [drapertools.com](http://drapertools.com)

**Email:** [sales@drapertools.com](mailto:sales@drapertools.com)

**Product Helpline:** +44 (0) 23 8049 4344

**Telephone Sales Desk:** +44 (0) 23 8049 4333

**General Enquiries:** +44 (0) 23 8026 6355

### **Draper Tools Europe B.V.**

Oude Graaf 8  
6002 NL  
Weert  
Netherlands

Please contact the Draper Tools Product Helpline for repair and servicing enquiries.