

Instruction Manual

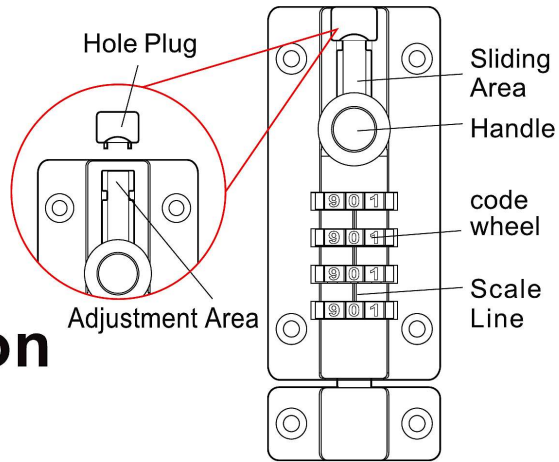

Reset Password

Please set your own password for the first use!

The unified original password of the factory products is "0-0-0-0".

1. Use the tool to remove the **Hole Plug** from the **Adjustment Area**. Turn the code wheel to 0-0-0-0, then pull the **Handle** outward and lift it up to the **Adjustment Area**.

(Note: pull the **Handle** outwards first and then lift it upwards)

2. Turn the password wheel in turn to the position of the password that needs to be set, and align with the **Scale Line**.

3. Pull the **Handle** outwards and move it down from the **Adjustment Area** to the **Sliding Area**, and the password setting is now complete.

(Remember to put the hole plug back)

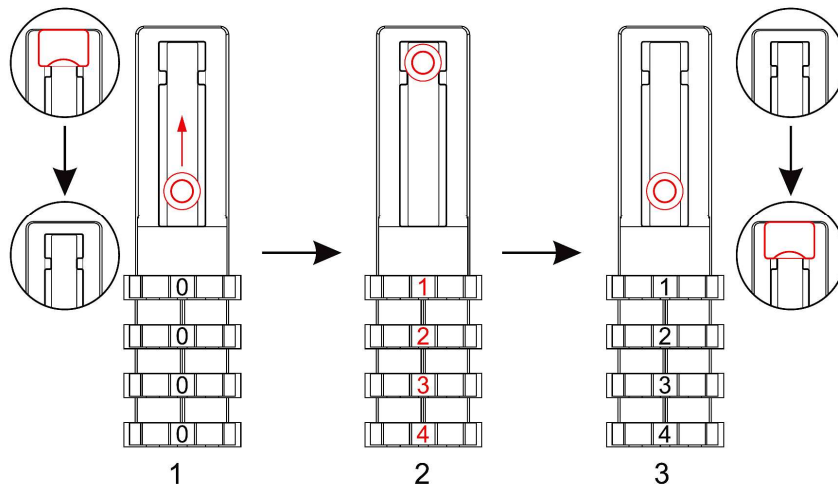

How to use

Unlock: Align the corresponding numeric passwords to the scale line, then pull the handle.

Lock: Keeping the code wheel in the correct position, insert the bolt into the keyhole, then disrupt the code wheel.

Dimension

