

## EXITGUARD 100 Series

The EX100 series provides a simple to operate solution for 24-hour protection of fire exits and other doors. Several options are available for set up at the installation stage.

Basic Chime repeating at 15 sec intervals [1]	15 sec Delay before alarm without pre-warning [5]	Tamper omit if T1 & T2 linked	Double bleep for set, single bleep for un-set
Auto Reset adjustable 1 sec to 90 secs [2]	15 sec Delay before alarm with pre-warning [6]	Battery fault test when the key is used & at 5 mins intervals	Pass through / safe set facility
Keyswitch Reset [3]	Low level tamper once acknowledged every 5 mins	Hi & Lo level alarm tones	Isolate alarm by turning Keyswitch to off position
Instant Alarm [4]	Reduced alarm after 2 minutes if not reset	LED status indicator	Auxiliary relay available for remote signalling

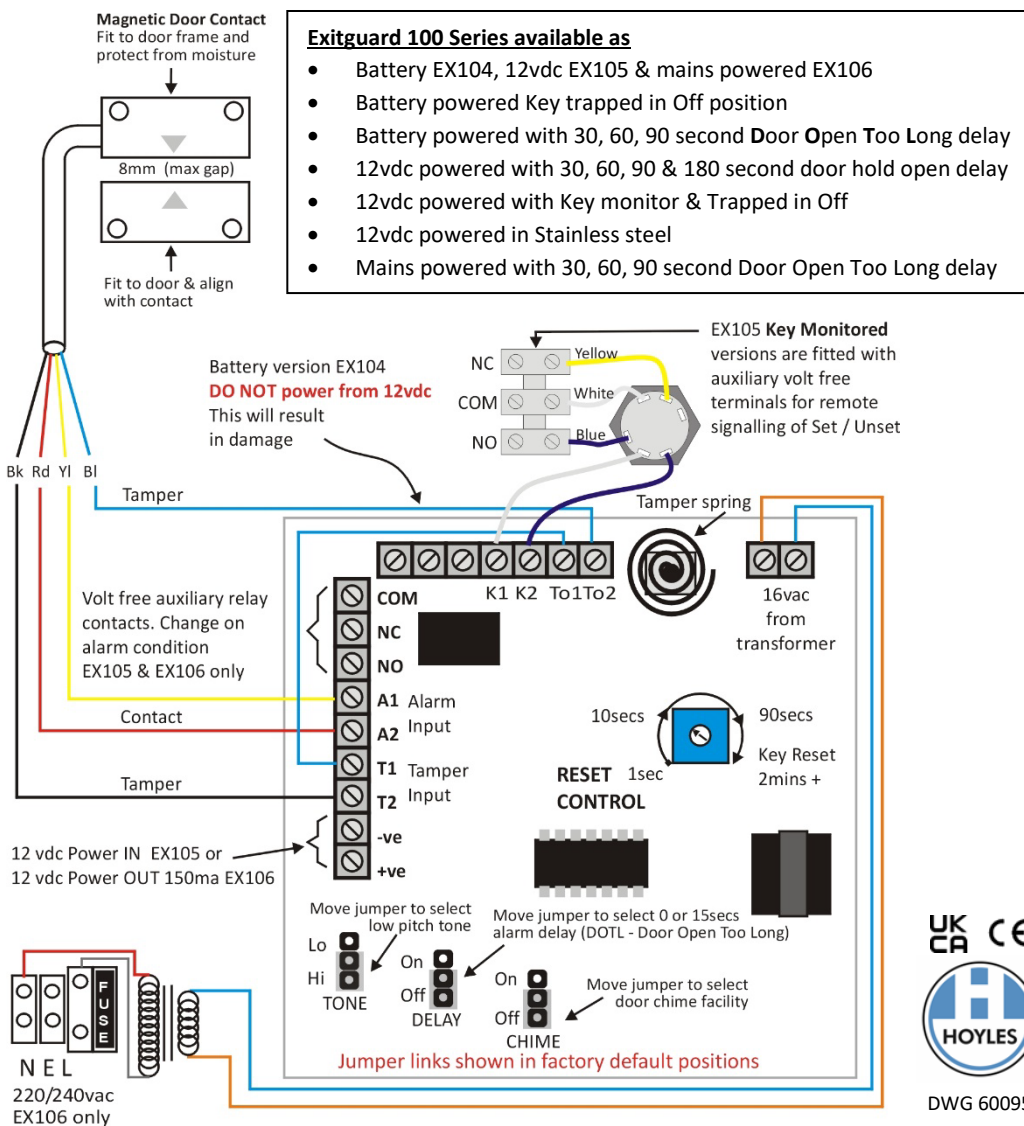

## EXITGUARD 100 Series

The EX100 series provides a simple to operate solution for 24-hour protection of fire exits and other doors. Several options are available for set up at the installation stage.

Basic Chime repeating at 15 sec intervals [1]	15 sec Delay before alarm without pre-warning [5]	Tamper omit if T1 & T2 linked	Double bleep for set, single bleep for un-set
Auto Reset adjustable 1 sec to 90 secs [2]	15 sec Delay before alarm with pre-warning [6]	Battery fault test when the key is used & at 5 mins intervals	Pass through / safe set facility
Keyswitch Reset [3]	Low level tamper once acknowledged every 5 mins	Hi & Lo level alarm tones	Isolate alarm by turning Keyswitch to off position
Instant Alarm [4]	Reduced alarm after 2 minutes if not reset	LED status indicator	Auxiliary relay available for remote signalling

