



#### Product features:

- Metal construction throughout
- Custom designed for lower range pressures
- Luscious European quality chromium plate finish
- Fixed spout to prevent accidental water damage
- Traditional European styling

#### Packaged properties:

Box length (mm): 255

Box depth(mm): 95

Box width(mm): 200

Boxed weight (Kg): 1.6

Includes pop up waste?: No

Additional comments:

#### Product dimensions:

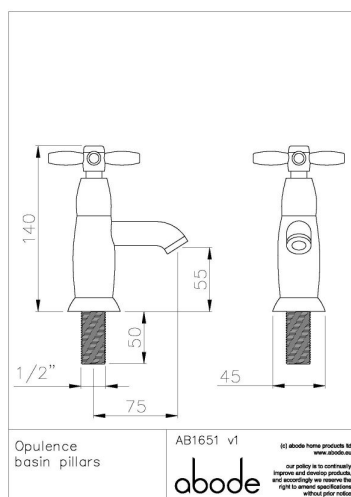

- Product mounted where: Surface
- Recommended hole size: 35 mm
- Overall Height / projection: 140 mm
- Exit reach: 75 mm
- Exit height: 55 mm
- Base size: 45 mm
- Inlet centre distance(s): n/a mm

- Min. fitting depth required: N/A mm
- Max. surface depth: 40 mm

#### Product flow characteristics:

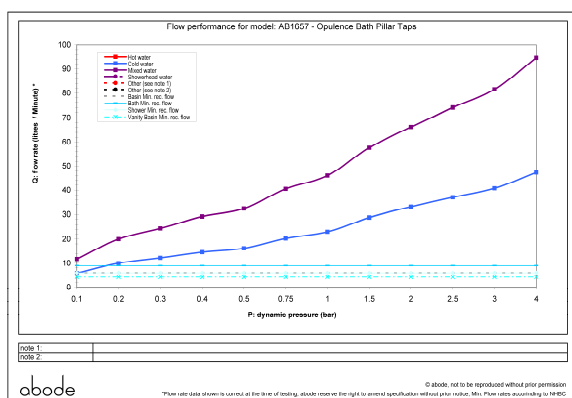

- Min / Max water pressure (bar): 0.10\* / 5.5
- Part G max. mixed flow rate at 3 bar (l/m): 81.5
- Inlet connection type / length: Fixed / 50 mm
- Inlet (plumbing connection) / outlet size: 1/2" M / n/a
- Product flow characteristics: Single flow
- Non return valve(s) supplied or position: n/a
- Aerator type: Flow straightener
- Control valve type: 1/2" QT CD (8-20)
- Includes output diverter?: N/A
- Inlet meshed particle filters included: n/a
- Shower hose type / length: N/a / n/a

#### Warranty Summary (full details available on request):

- Materials and workmanship defects warranted for 5 years
- Valves and working parts warranted for 5 years
- Surface warranty defects warranted for 1 year
- O-rings, hoses & gaskets warranted for 1 year

#### Care instructions:

- Clean the mixers and showers regularly as required, using soap, do not use any other cleaners.
- Regular cleaning will prevent the build up of lime scale and dirt
- After cleaning rinse thoroughly with clean water to remove any cleaner residue
- Residues of liquid soaps, shampoos and shower foams can also cause damage, so rinse with clean water after using, avoid contact with any abrasives