



#### Product features:

- Luscious European quality chromium plate finish
- Thermostatic valve for safety & comfort
- 2 exit alternate control for output to 2 x shower or 1 x shower & 1 x bath
- Freshly designed contemporary blend
- 5 year limited warranty

#### Packaged properties:

Box length (mm): 250      Box depth(mm): 195  
Box width(mm): 165      Boxed weight (Kg): 0.00

Includes pop up waste?: N/a

#### Additional comments:

N/a

#### Product dimensions:

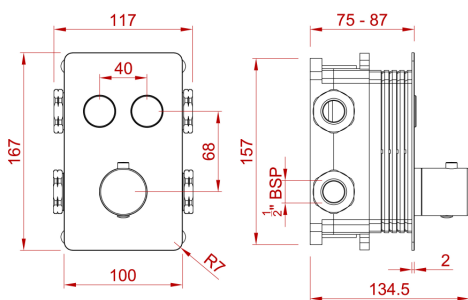

Uno Concealed Push Button Shower (2 Exit)

abode

our policy is to continually improve and develop products, and accordingly we reserve the right to amend specifications without prior notice

- Product mounted where: 0 mm
- Recommended hole size: 0 mm
- Overall Height / projection: 134.5 mm
- Exit reach: 0 mm
- Exit height: 0 mm
- Base size: 100 x 167 mm
- Inlet centre distance(s): n/a mm

- Min. fitting depth required: 87 mm
- Max. surface depth: 75

#### Product flow characteristics:

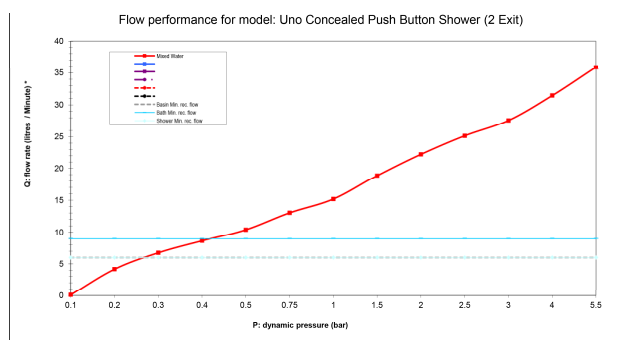

- Min / Max water pressure (bar): 0.50\* / 5
- \*Detailed minimum pressure requirements for this product: Bath n/a, Shower n/a (bar)

- Part G max. mixed flow rate at 3 bar (l/m): 27.59
- Inlet connection type / length: Fixed / 0 mm
- Inlet (plumbing connection) / outlet size: 1/2" F / 1/2" F
- Product flow characteristics: N/a
- Non return valve(s) supplied or position: H&C Inlet
- Aerator type: N/a
- Control valve type: ( )
- Includes output diverter?: N/A
- Inlet meshed particle filters included: 0.60 mm
- Shower hose type / length: N/a / n/a

#### Warranty Summary (full details available on request):

- Materials and workmanship defects warranted for 5 years
- Valves and working parts warranted for 5 years
- Surface warranty defects warranted for 1 year
- O-rings, hoses & gaskets warranted for 1 year

#### Care instructions:

- Clean the mixers and showers regularly as required, using soap, do not use any other cleaners.
- Regular cleaning will prevent the build-up of lime scale and dirt
- After cleaning rinse thoroughly with clean water to remove any cleaner residue
- Residues of liquid soaps, shampoos and shower foams can also cause damage, so rinse with clean water after using, avoid contact with any abrasives