

SYN-PIR

Key Features

- Input Voltage (Min/Max): 12V – 24V
- Colour Control Type: Single colour
- Mounting Type: Recessed
- IP Rating: 20
- Warranty: 3 Year(s)



12V-24V

IP20

Mechanical Data

Body Colour	Black
Cut Out Diameter	12 mm
Product Weight	17 g
Product Dimensions	18x14x12 mm

Dimensions

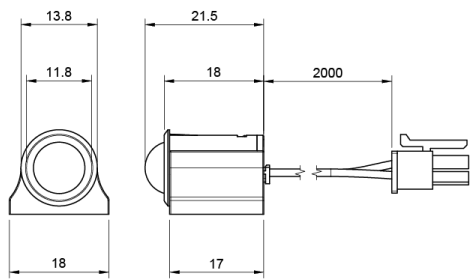

Input

Input Current	0.05 A
Input Current Max ·	0.05 A
Input Current Type	DC
Input Voltage	12 -24 V

Output

No · of Control Channels	1
Output Current Type	DC
Output Current Max · @12V	0.05 A
Output Current Max · @24V	0.05 A
Output Current	0.05 A
Output Voltage	12 - 24 V

Control

Colour Control Type	Single colour
Control Distance (barrier-free)	3 m
Control Input Resolution	16 Bit
Control Signal Input	PWM
Default PWM Frequency	0 Hz
Interface Type	uart
No. of Programmes	1
Manual Override	Yes
Sensor Type	PIR Sensor
Detection Distance	1 - 3 m

Electrical Data

Constant Voltage / Constant Current	CV
-------------------------------------	----

Protection

Electrical Safety Class	II
Reverse Polarity Protection	Yes

Environment

Application Environment	Interior
Body Material	Plastic
Ingress Protection (IP)	IP20
Interior or Exterior Use	Interior
Mounting Type	Recessed

Efficiency

No-Load Power Consumption	0.2 W
---------------------------	-------

Rated Life	500000 Hours
Standby Power Max ·	0.001 W
Standby Power Typ ·	0.0003
Startup Time	1 Secs

Packaging & Shipping

Fixings Included	Yes
------------------	-----