

SYN-PLSWITCH



Key Features

- Input Voltage (Min/Max): 12V – 24V
- Colour Control Type: Single colour
- Mounting Type: Recessed
- IP Rating: 20
- Warranty: 3 Year(s)

12V-24V

IP20

Mechanical Data

Body Colour	Black
Product Weight	39 g
Product Dimensions	19x19x16 mm

Dimensions

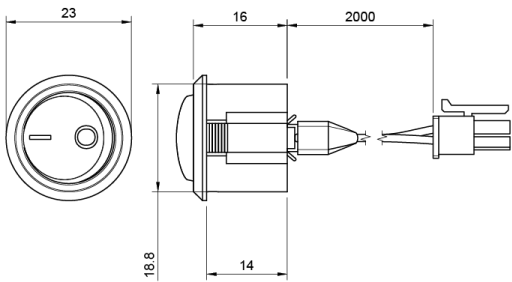

Input

Input Current	0.05 A
Input Current Max ·	0.05 A
Input Current Type	DC
Input Voltage	12 - 24 V

Output

No · of Control Channels	1
Output Current Type	DC
Output Current Max · @12V	0.05 A
Output Current Max · @24V	0.05 A
Output Current	0.05 A
Output Voltage	12 - 24 V

Control

Colour Control Type	Single colour
Default PWM Frequency	0 Hz
Interface Type	uart
No. of Programmes	1
Manual Override	Yes
Sensor Type	mechanical switch
Detection Distance	0 m
LED Switching Load	60 W

Electrical Data

Constant Voltage / Constant Current	CV
-------------------------------------	----

Protection

Electrical Safety Class	II
Reverse Polarity Protection	Yes

Environment

Application Environment	Interior
Body Material	Plastic
Ingress Protection (IP)	IP20
Interior or Exterior Use	Interior
Mounting Type	Recessed

Efficiency

No-Load Power Consumption	0.2 W
Rated Life	500000 Hours
Startup Time	1 Secs

0161 507 9249 | support@ultraleds.co.uk | www.ultraleds.co.uk | Manchester, M17 1SJ Date: 08/07/2025

Ultra LEDs have taken reasonable care to ensure that the information in this datasheet is accurate at time of publication however it should be noted that all specifications are subject to tolerance. Descriptive specifications such as colour are subjective. Ultra LEDs reserve the right to update specifications without notice. The information in the datasheet may only be relied on by customers of Ultra LEDs in accordance with applicable terms and conditions

Packaging & Shipping

Fixings Included	Yes
------------------	-----