

Precautions

Installation Notes

- ▶ Install in accordance with all local wiring regulations and building regulations.
- ▶ This product must be installed by a suitably competent person.

IMPORTANT

- ▶ Please read prior to installation.
- ▶ Please read these instructions carefully before commencing any work.
- ▶ Please retain these instructions for future reference.

Electrical

- ▶ Do not connect to mains electrical supply.
- ▶ Switch the power off at the main supply before installing or maintaining this fitting.
- ▶ Ensure others cannot restore the electrical power supply without your knowledge.
- ▶ A 5x20mm fuse must be used with this product.
- ▶ Ensure that the fuse does not exceed 6.3A per output.
- ▶ Connect the input and output wires with correct polarity. The positive wire (+) should be connected to the positive feed on the connector block. The negative wire (-) should be connected to the negative feed on the connector block.
- ▶ Ensure that the input power does not exceed 48V.
- ▶ Do not use a cable gauge less than 24AWG/0.2mm² or more than 14AWG/2.0mm².
- ▶ Ensure that all solder points do not come into contact with metal.

Mechanical

- ▶ When snapping the module, use a hard surface and make sure to score the PCB along the dashed line.
- ▶ The module should be fixed to a surface and raised in order to stop solder points coming into contact with metal surfaces.
- ▶ Do not twist the module as this may cause damage to soldered components.
- ▶ Protect the module from mechanical damage. Take care not to dislodge any components during installation. Ensure that wires connected to the connector blocks cannot be pulled.

Environmental

- ▶ The product should only be used in an environment with an ambient temperature between -20°C to +40°C.
- ▶ This product is not waterproof and can only be installed indoors.
- ▶ Install in a location where no chemicals, solvents, salts, acids are present.
- ▶ Install in a well ventilated area and leave a clear space around the module to help with airflow and cooling.

Product Warranty

1. A warranty period is provided for products in normal use. For any faults arising during the period that are confirmed to be quality related by inspection by the company, a product of the same specification will be replaced for free.
2. The warranty does not cover any of the following:
 - (1) Any product damage due to usage not allowed in the instructions.
 - (2) Any product damage due to disassembling or wrong operation by the user.
 - (3) Severe appearance damage or deformation of the product.

Wiring Accessories & Tools

▶ Fused Distribution Module 12 Way

tagra®

User Manual

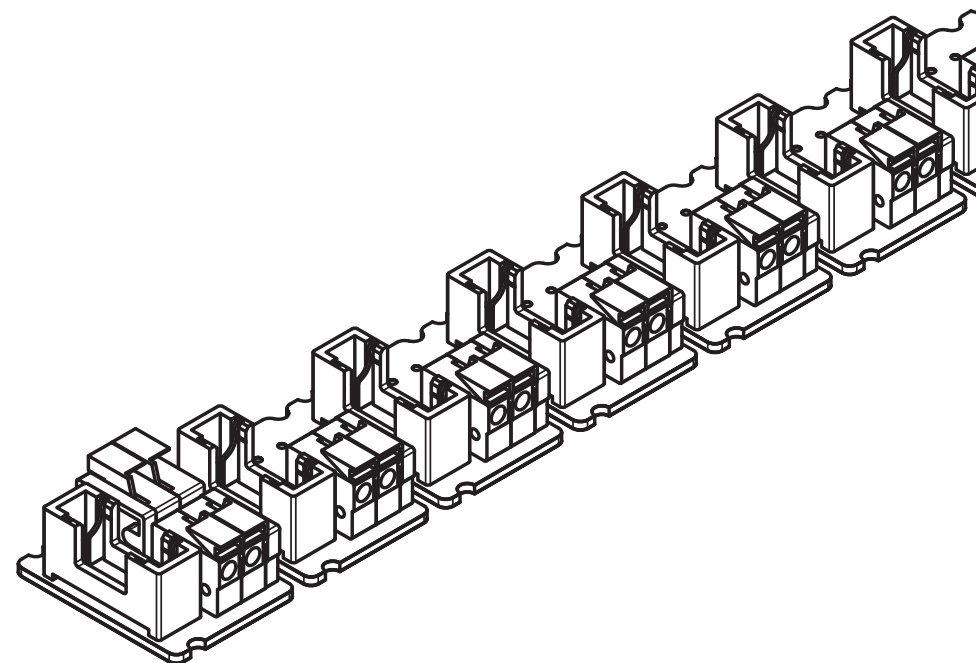

Fitting a fuse

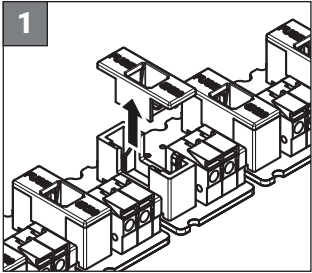

1. Lift away the fuse carrier from the fuse block.

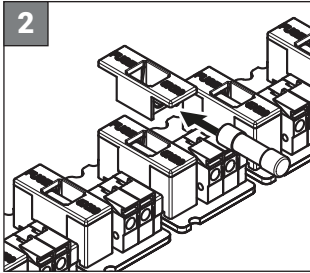

2. Place the fuse (max. 6.3A) into the carrier.

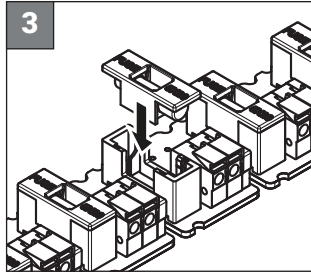

3. Connect the fuse carrier back onto the fuse block. Should hear a small click.

Connecting Cables

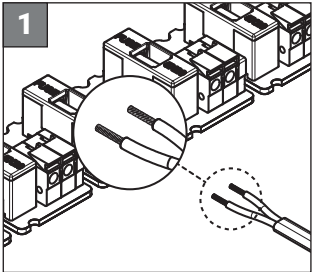

1. Strip the cable, removing 9mm of insulation.

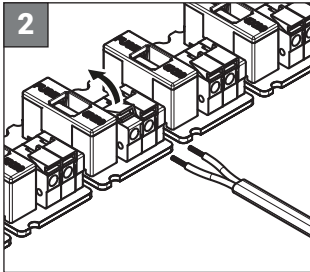

2. Pull back the orange lever on the top of the connector.

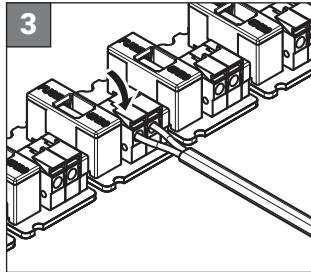

3. Insert the cable, then release the orange lever.

WARNING: This product must be installed by a suitably competent person. Check polarity (+/-) is correct before turning on as incorrect polarity can cause damage to products.



Soldering Connections

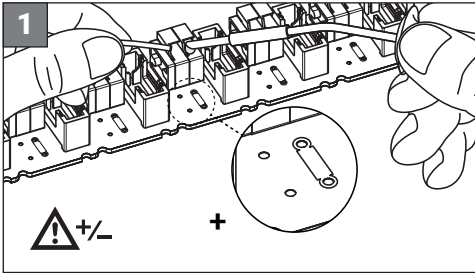

1. Solder pad locations on top of board.

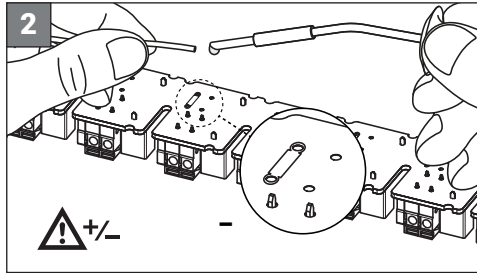

2. Solder pad locations on bottom of board.

WARNING: for more information on the soldering process and safety precautions please follow the soldering iron manufacturer's instructions.



Wiring Options

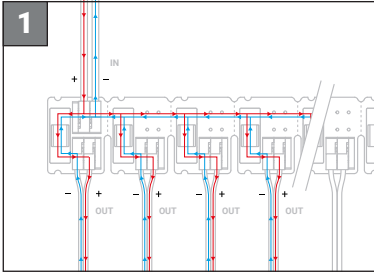

1. Diagram shows how current flows from cable input to multiple cable outputs.

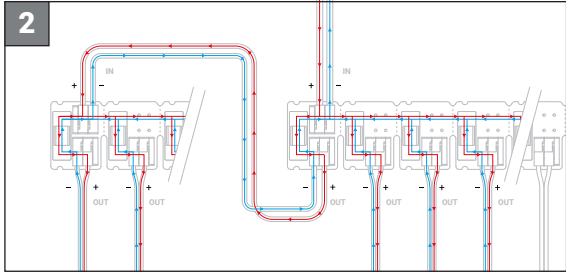

2. Diagram shows how current flows when an additional distribution module is linked to an existing module .

Snapping the Board

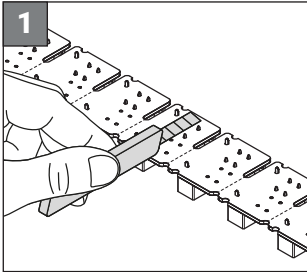

1. Score the bottom of the board along the dashed line.

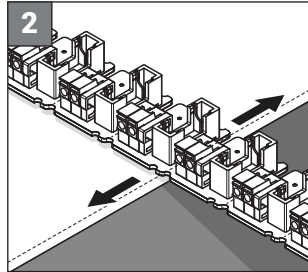

2. Place on a flat surface with break point lined up with the edge of the surface.

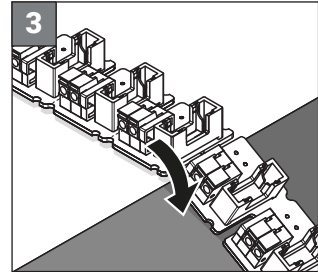

3. Apply quick strong pressure on the side you are breaking off.