

# User Manual

tagra®

NEON360 Series

Disc Wall Mounted Accessories

V1.0

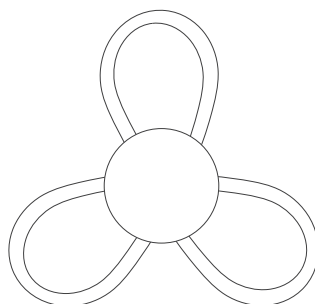

△ Single Use

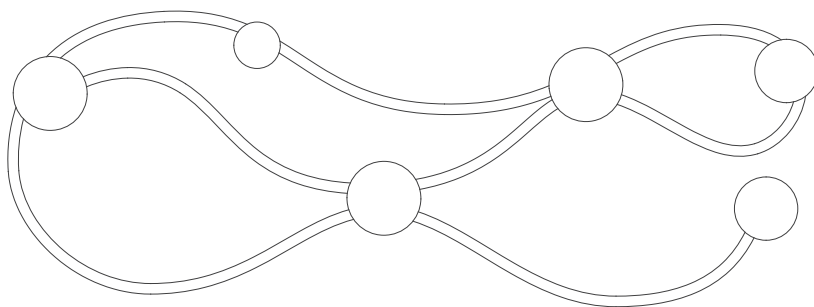

△ Combined Use

Please read this manual carefully before installation, and use it correctly.  
This manual also contains instructions of accessories.  
Please keep this manual properly for future reference.

## Prepare materials

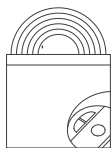

NEON360



User manual

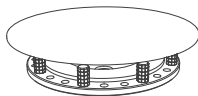

Round plate kit



Rubber screw

### Round plate options



#### Diameters of plate

110mm / 150mm / 175mm



#### Heights of axis

H 10mm suitable for NEON36013

H 15mm suitable for NEON36018

H 21mm suitable for NEON36025

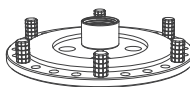

#### Height and quantity of cylinder

H 14mm suitable for NEON36013

H 18mm suitable for NEON36018

H 24mm suitable for NEON36025

#### Diameters of bas

90mm / 120mm / 155mm

Choose the suitable options based on your actual needs.

5000mm

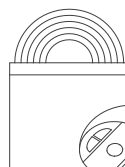

Optimal 5m or other customized length.



## Installation tools



Cross  
screwdriver



Pen

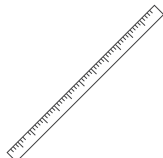

Tape  
Measure



Hammer

Ø6.0mm

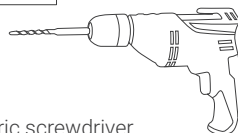

Electric screwdriver  
(Ø6.0mm head)

## Installation steps (single use)

1

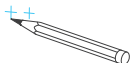

Draw positioning lines on the wall based on actual design and screw hole spacing of round plate.

2

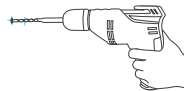

Drill holes on positioning lines

3



Insert rubber plug into every positioning holes

4

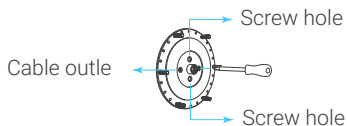

Screw into screw hole of the round plate

5

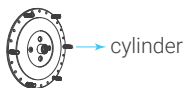

Match cylinders of suitable height and quantity based on actual design and sizes of neon flex

6

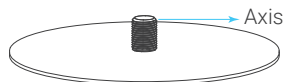

Match axis of suitable height based on sizes of neon flex

7

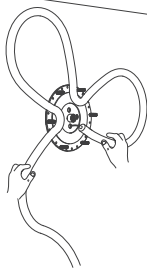

Make styles based on actual design.  
Better to match with invisible accessory  
for positioning

8

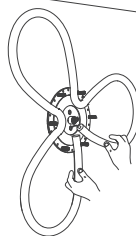

Finish the styling

9

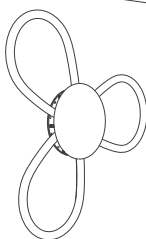

Screw on the round plate when making  
styles. Adjust modestly and then tighten  
the round plate.

10

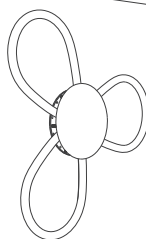

Finish installation

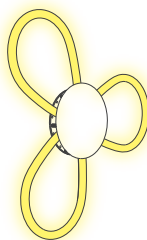

Connect to power supply and light up

## Installation steps (combined use)

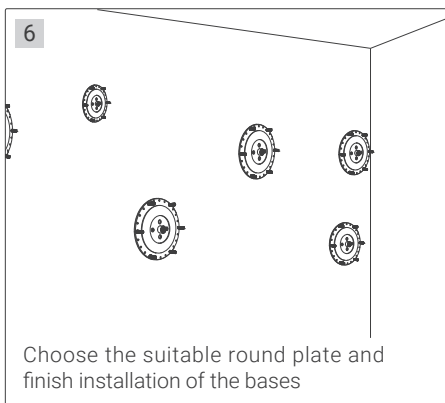
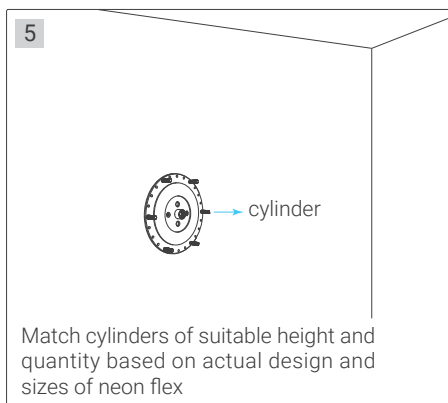
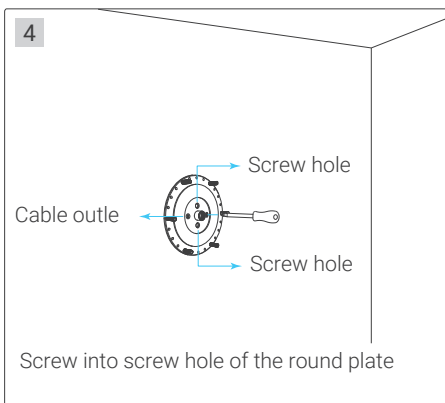
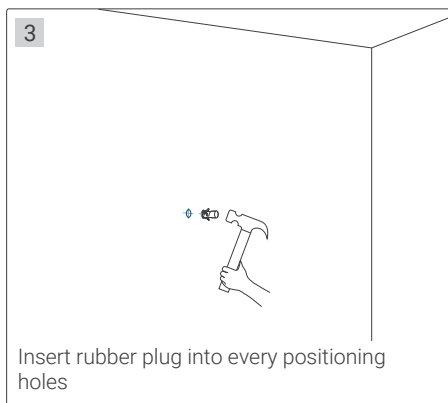
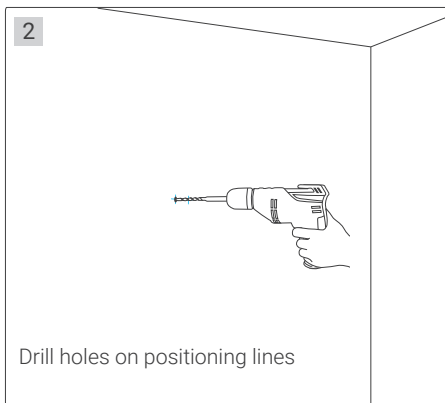
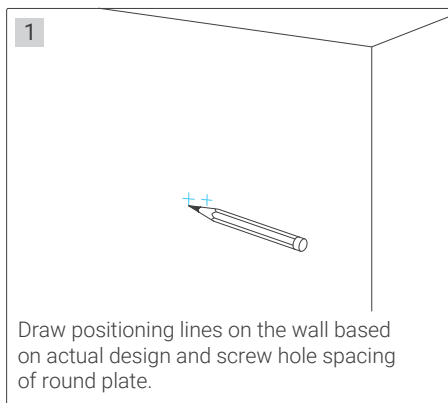

7

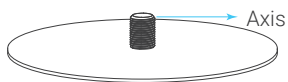

Match axis of suitable height based on sizes of neon flex

8

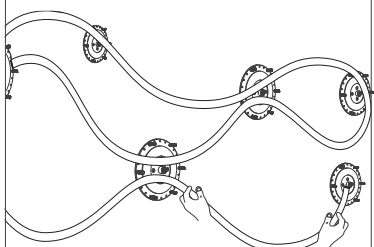

Make styles as per your needs 2-3 persons are recommended to install it. Better to match with invisible accessory for positioning

9

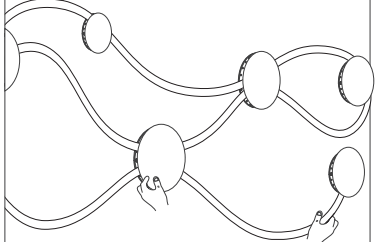

Screw on the round plate when making styles. Adjust modestly and then tighten the round plate.

10

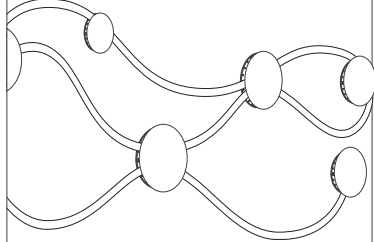

Finish installation

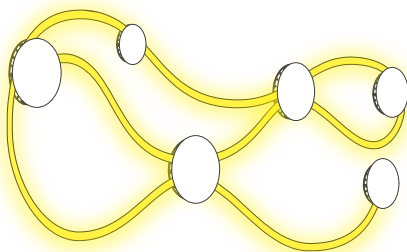

Connect to power supply and light up