

⚠ WARNING

1. To avoid electric shock, disconnect power at source prior to installation.
2. The installation should be performed by qualified electricians or lighting technicians.
3. Before conducting any installation, maintenance, or removal, disable all power.
4. Do not touch the fixture while it is in service.
5. If there is any problem with the fixture, turn off power and DO NOT attempt repair unless you are a qualified technician or the customer service member.

Recessed Installation

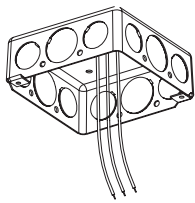

1 Shut off electrical power before fixture installation.

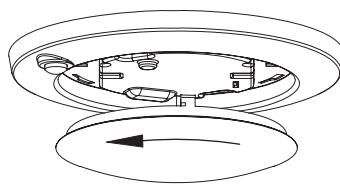

2 Remove lens on fixture by twisting counter clockwise.

Occupancy Timer Operation

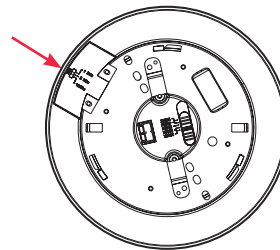

3 Locate the occupancy timer switch on the edge of the disk's backside.

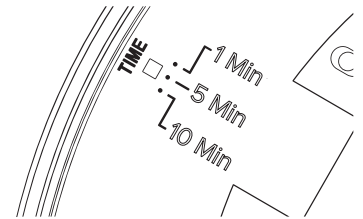

4 Select the desired time the fixture will remain lit after it senses motion.

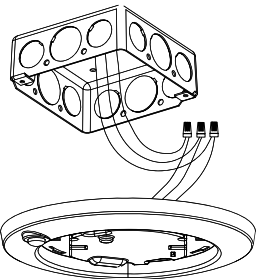

5 Connect color coordinated wires using wire nuts. Ensure the copper ground is secure.

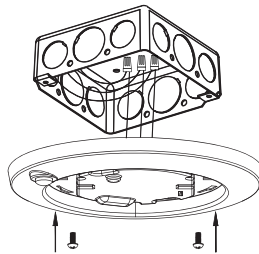

6 Align fixture and J Box holes and attach fixture with provided screws. Do not over-tighten screws.

Selectable Kelvin Operation

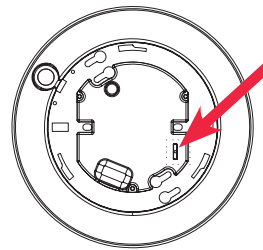

7 Locate kelvin switch on the inside face of disk.

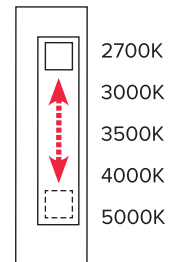

8 Slide switch to the desired kelvin setting. Note: The default setting is 2700K.

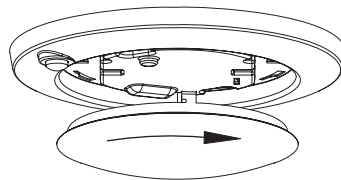

9 Reinstall the lens onto fixture by rotating the lens clockwise until it locks in place.

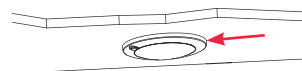

10 Ensure the fixture is tight to the ceiling to complete installation.